

Part Number:

Part Description: TOP RACK X-MAX 300

Installation / Parts List / Bill of Material for Mounting

| NO. | Description | Quantity | Torque*(N-M) | Remarks** |
|-----|-------------------------------------|----------|--------------|--------------------------|
| 1 | Top Rack - X-MAX- 000-W | 1 | | |
| 2 | Top Rack SRC 2021-01 | 1 | | |
| 3 | Top Rack - X-MAX- 05 | 1 | | |
| 4 | Top Rack - X-MAX- 06 | 1 | | |
| 5 | Bush AL OD 20xID9x5 | 4 | | |
| 6 | Bush OD15xID7xL10 | 4 | | |
| 7 | MirrorTop Rack - X-MAX- 06 | 1 | | |
| 8 | MirrorTop Rack - X-MAX- 05 | 1 | | |
| 9 | Socket head cap screw M8x25 | 4 | | Use Liquid Thread Locker |
| 10 | Washer M8 | 4 | | |
| 11 | Socket countersunk head screw M6x30 | 4 | | Use Liquid Thread Locker |
| 12 | Hex flange nut gradea M6 | 4 | | |
| 13 | Countersunk Washer M6 | 4 | | |

SRC Design uses Metric System of Measurement and all dimensions in Millimeters

Recommended to use the Torque specified in the table

Denotes Usage of Liquid Thread Locker in specified Locations

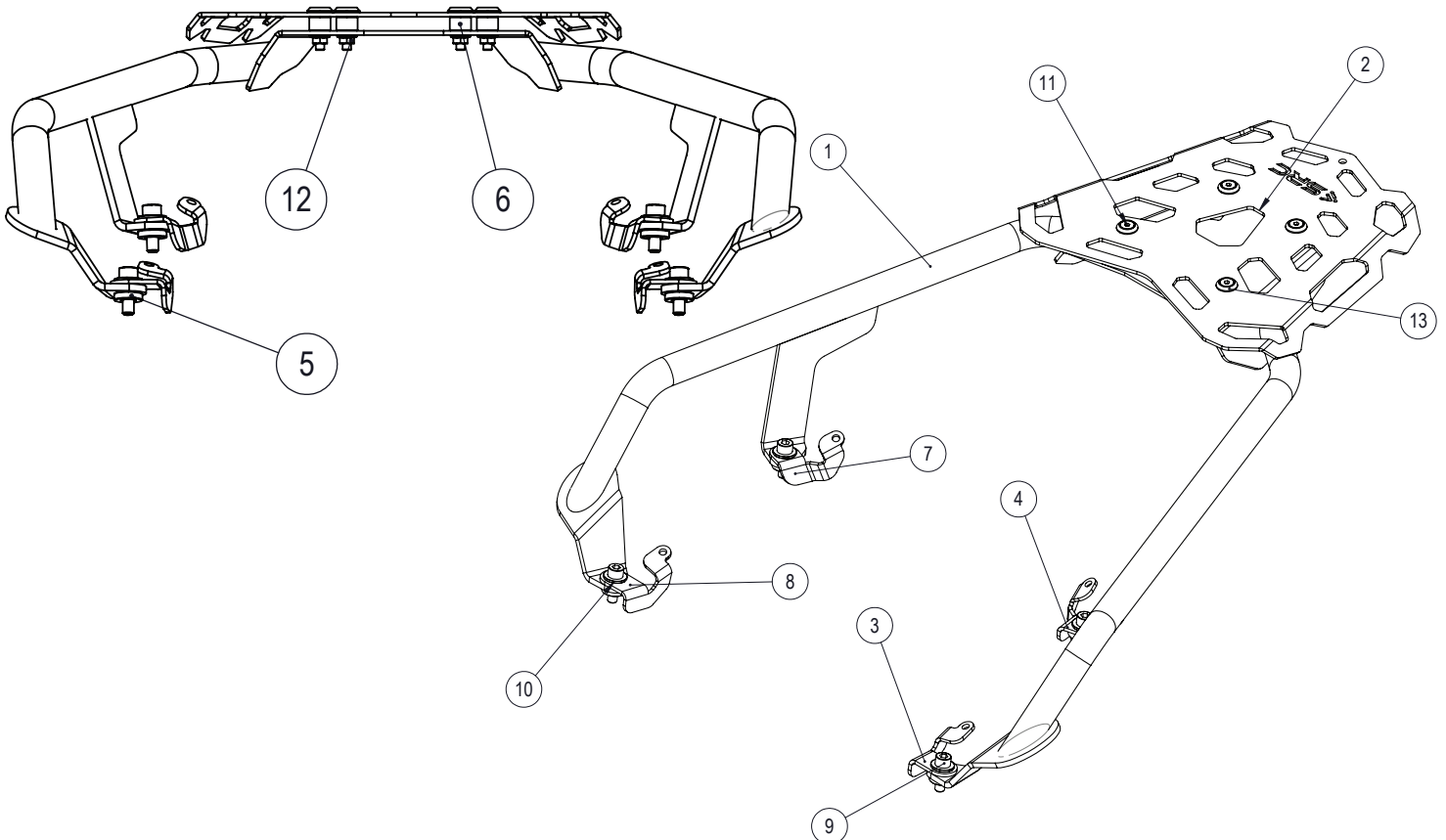

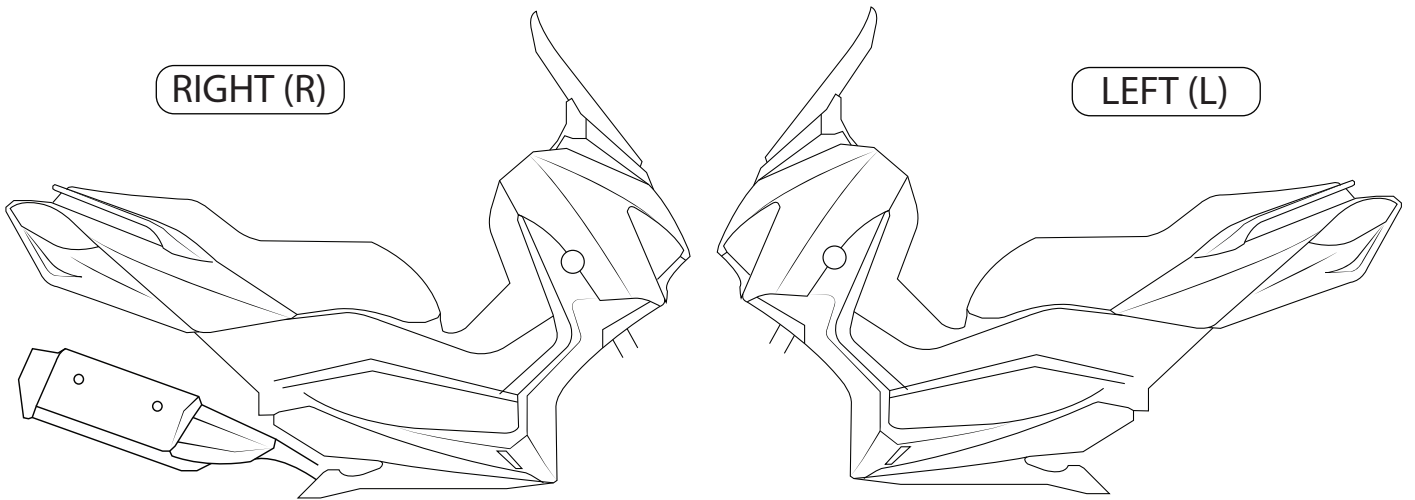

1

Prepare the parts and assemble according to the illustration.

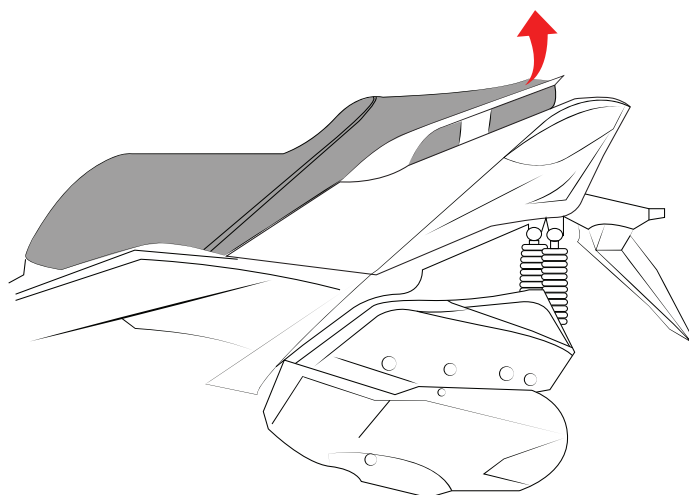
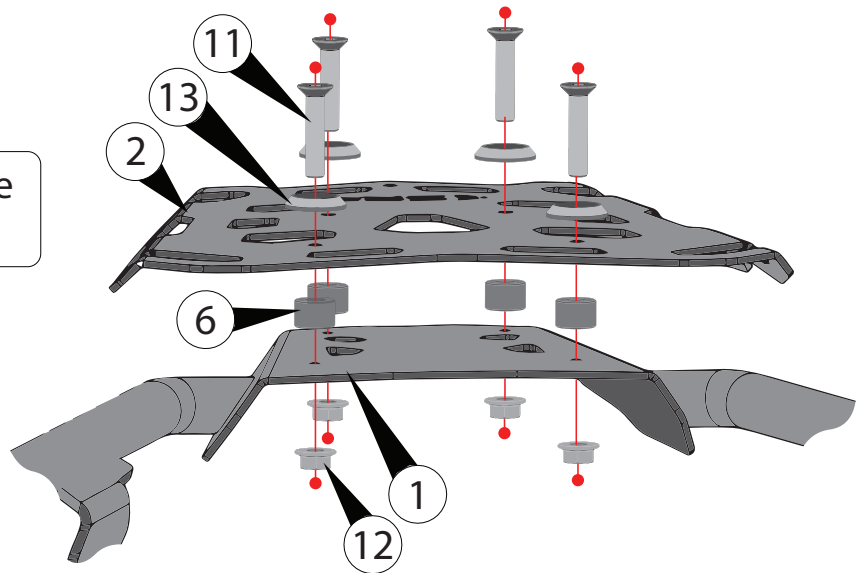

2

Open under the seat

3

Remove the left and right screws., according to the illustratio

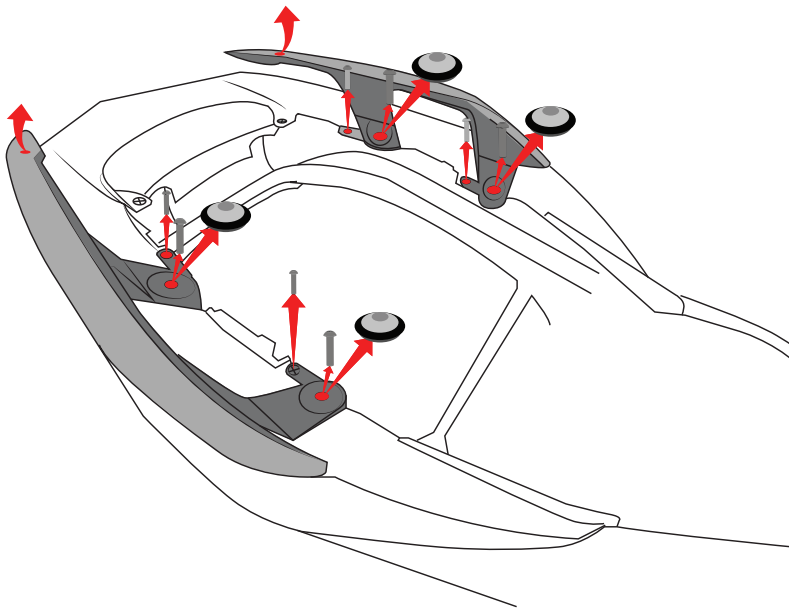
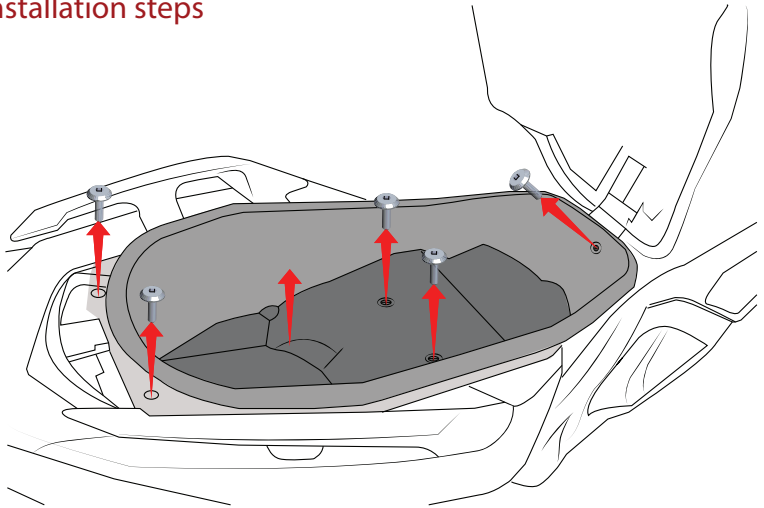

4

Remove screws. , according to the illustratio

5

Insert Bush AL OD 20xID9x5 as illustrated.

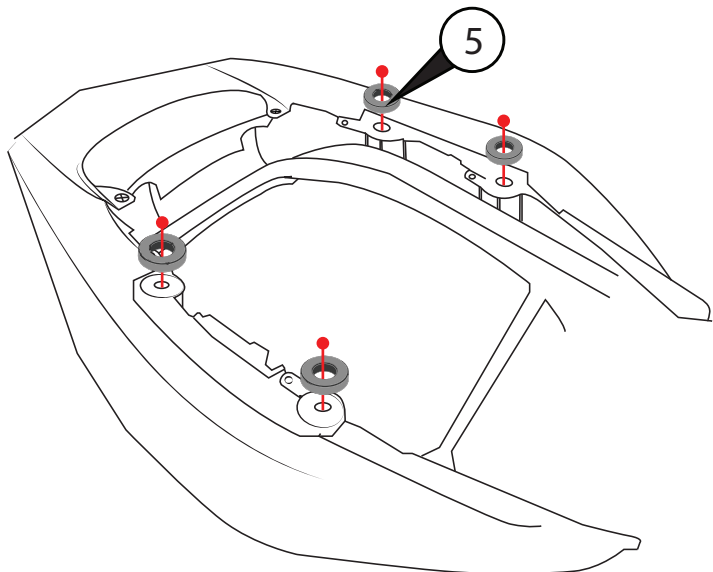

6

Prepare the parts and assemble according to the illustration.

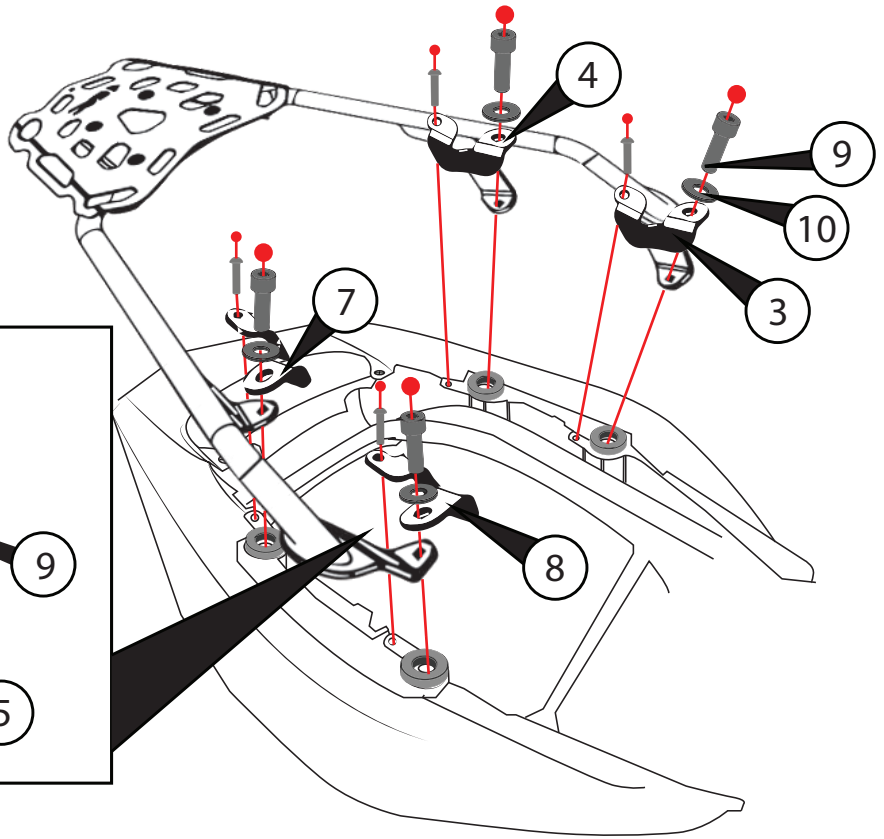
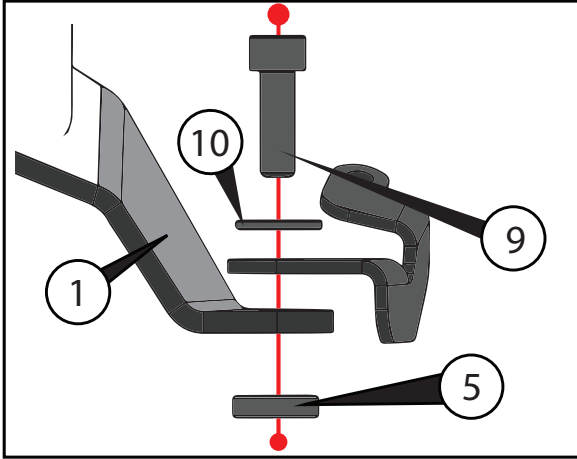

6

Insert SCREWS as illustrated.

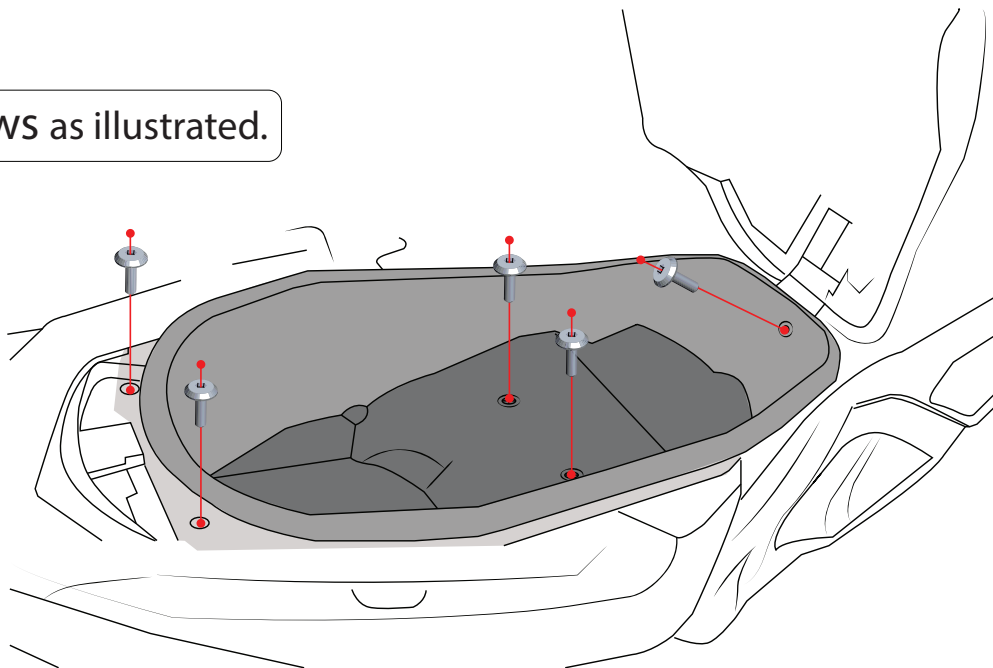

Make sure they are inserted correctly.