

Scope of Supply/Bill of Material & Mounting Drawings

Part Number: Y-T700-19-01-SL / Y-T700-19-02

Part Description: Rear Pump Brake Reservoir Cover – YAMAHA TENERE 700

Installation / Parts List / Bill of Material for Mounting

NO.	Description	Quantity	Torque * (N-M)	Remarks **	Chacklist
1	Rear Pump Brake Reservoir Cover	1			
2	Bush M8 15 x 4 mm	2			
3	Taper Ring M8	2			
4	Countersink Screw M8 X 40	2	22 - 24	Use Liquid Thread Locker	
SRC Design uses Metric System of Measurement and all dimensions in Millimeters					
* Recommended to use the Torque specified in the table					
** Denotes Usage of Liquid Thread Locker in specified Locations					

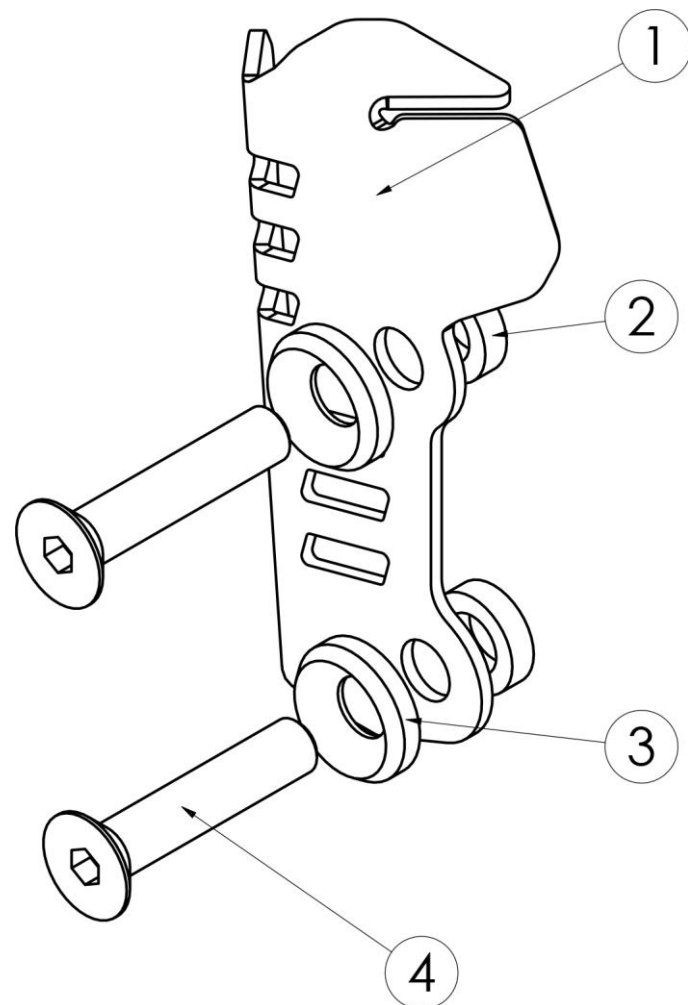
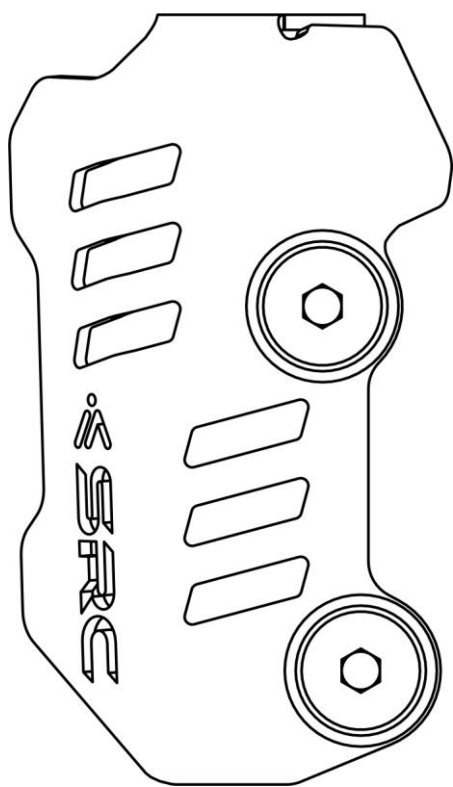

Mounting Drawings

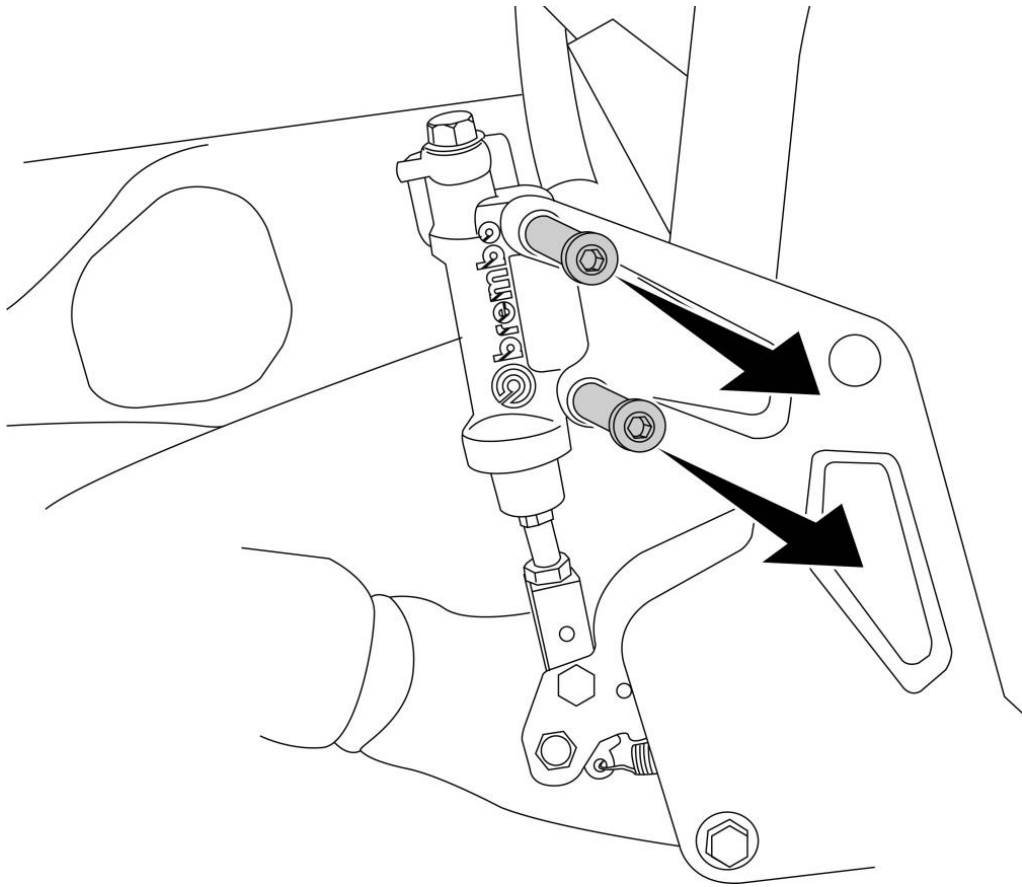

Step 1 :

Before starting to mount the Rear Pump Brake Reservoir Cover , we have to unscrew the Mounting bolts (as shown)

Step 2 :

Orient and align the Rear Pump Brake Reservoir Cover , as shown, in-line with the mounting points shown in red colour, and slip-in the Bush (2) – 2 off, Taper Ring M8 (3) – 2 off and Screw M8x40 (4) – 2 off.

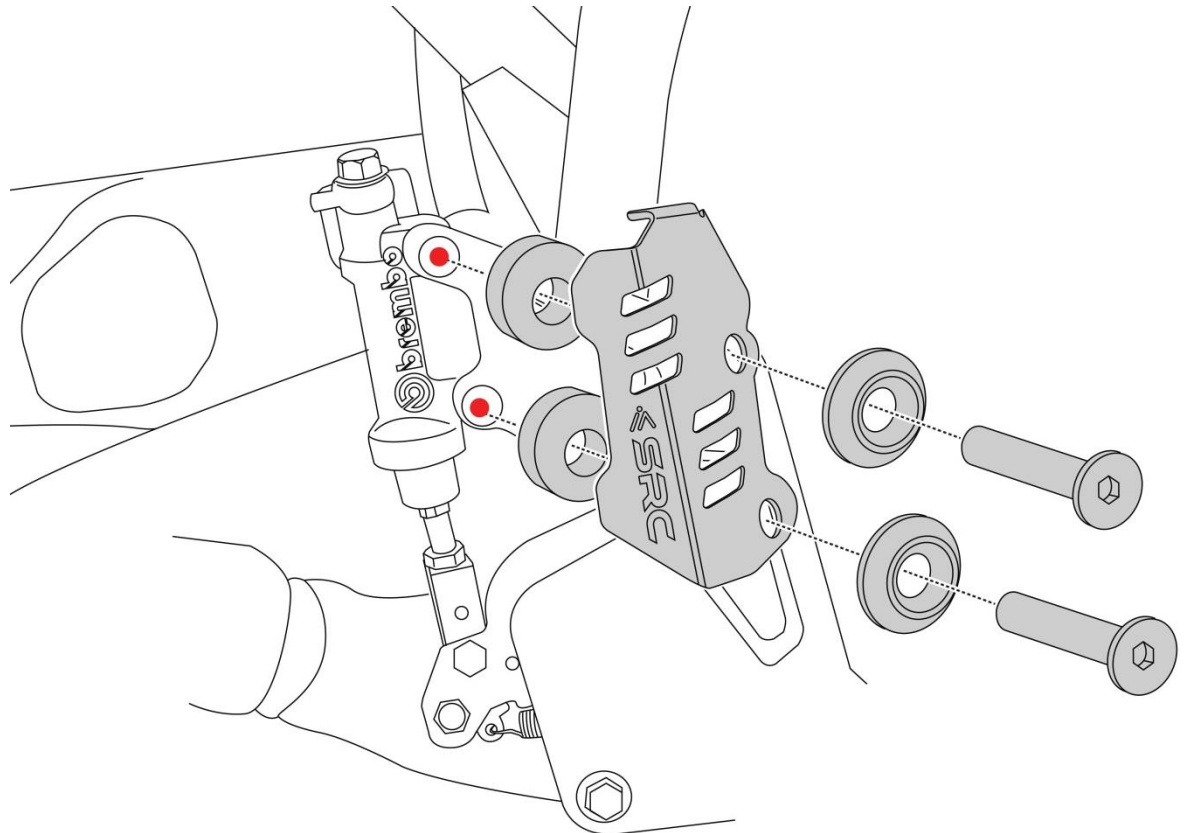

Step 3 :

Secure the threads in the Mounting points and ensure the Inside surfaces of the Pump Cover, is not fouling with the Body of the Rear Brake Pump.

Final mounted condition, is as shown in the drawing on the left-hand side.

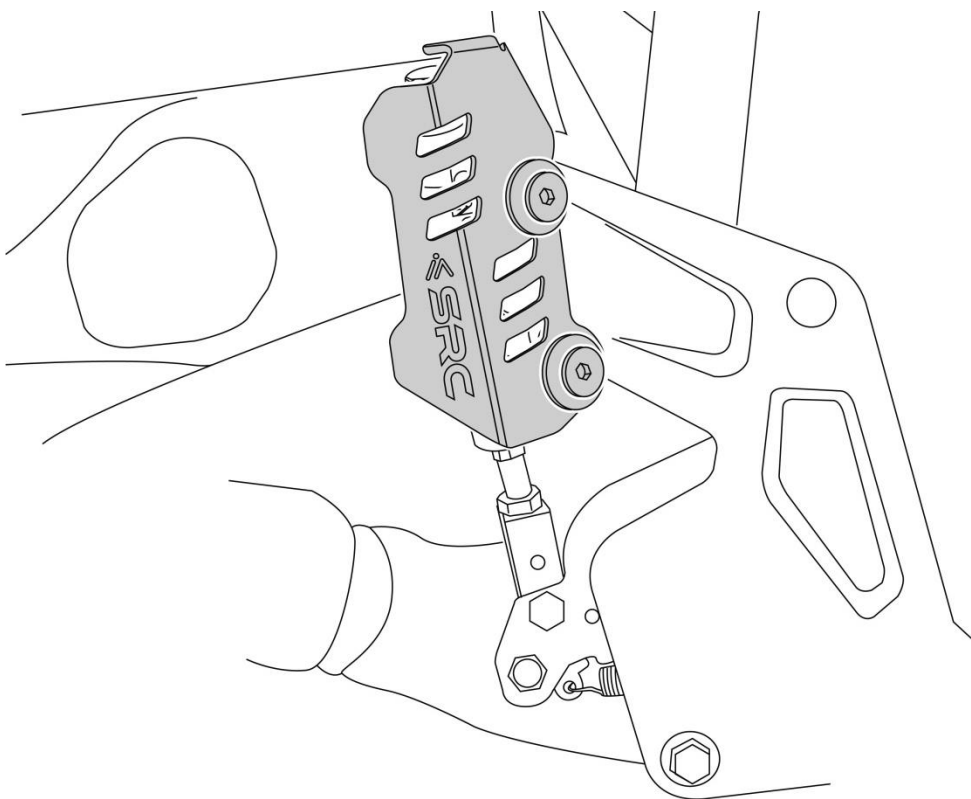



General Instructions

1. We request you to pay attention to the Mounting Instructions in this document and follow the step-by-step procedures.
2. This Mounting Instruction manual is a “Do It Yourself” (DIY) fitment manual of the Accessory part to the Vehicle. We have prepared this based on our experience and knowledge, related to the Vehicle, Part and its functional aspects.
3. SRC cannot guarantee the interchangeability of the parts to any other manufacturer’s accessory part. It is advised to the User, to inspect and ensure the original state of all other Vehicle parts.
4. We request you to bear in mind, that the Installed part can change the driving behaviour and/or the stability during driving or any other dynamic conditions.
5. If you have the appropriate tools and another person to assist you in the mounting, it will help.
6. To the maximum extent possible, our design use the current Mounting/Fitment of the Original Equipment, so that Installation of these accessories will not affect the Payload or Function of the Vehicle or the Part on which it is mounted to protect it
7. If any additional modifications are to be done, prior to the fitment of the accessories, it will be explicitly specified in the instruction sheets