

## Scope of Supply/Bill of Material & Mounting Drawings

Part Number: T-XRX-07-01-SL / T-XRX-07-02

Part Description: GPS BAR – TRIUMPH TIGER800 XRX

Applicable to Finished colour versions of Black and Silver

### Installation / Parts List / Bill of Material for Mounting

| No.  | Description   | Quantity | Torque * (N-m) | Remarks **               |
|--|---------------|----------|----------------|--------------------------|
| 1  | RH Bracket    | 1        |                |                          |
| 2  | End Adaptor   | 2        |                |                          |
| 3  | GPS Bar       | 1        |                |                          |
| 4  | LH Bracket    | 1        |                |                          |
| 5  | Washer M8     | 2        |                |                          |
| 6  | Screw M8 x 16 | 2        | 9 - 10         | Use Liquid Thread Locker |
| SRC Design uses Metric System of Measurement and all dimensions are in Millimeters |               |          |                |                          |
| * Recommended to use the Torque specified in the table                             |               |          |                |                          |
| ** Denotes Usage of Liquid Thread Locker in specified locations                    |               |          |                |                          |

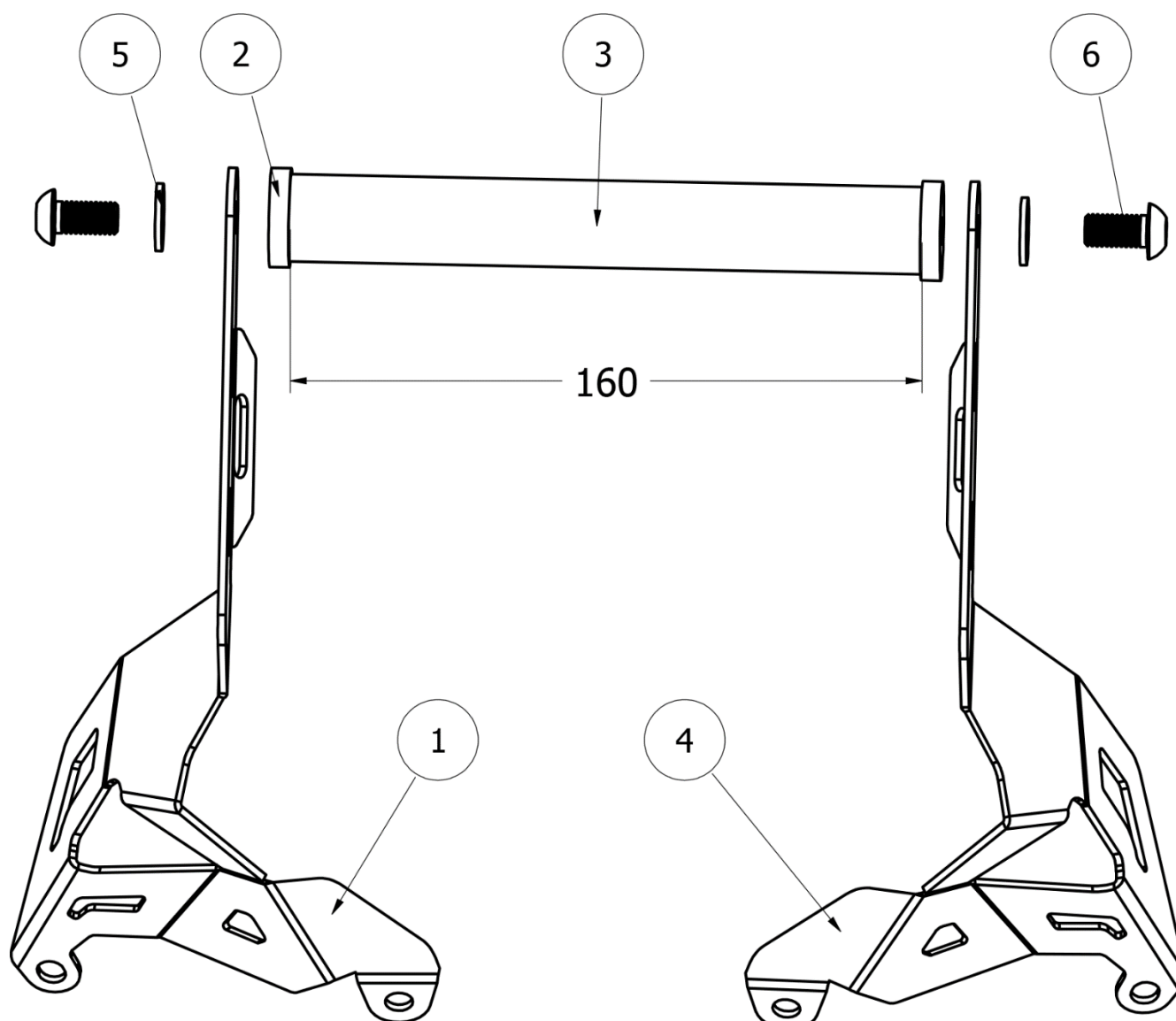

## MOUNTING DRAWINGS

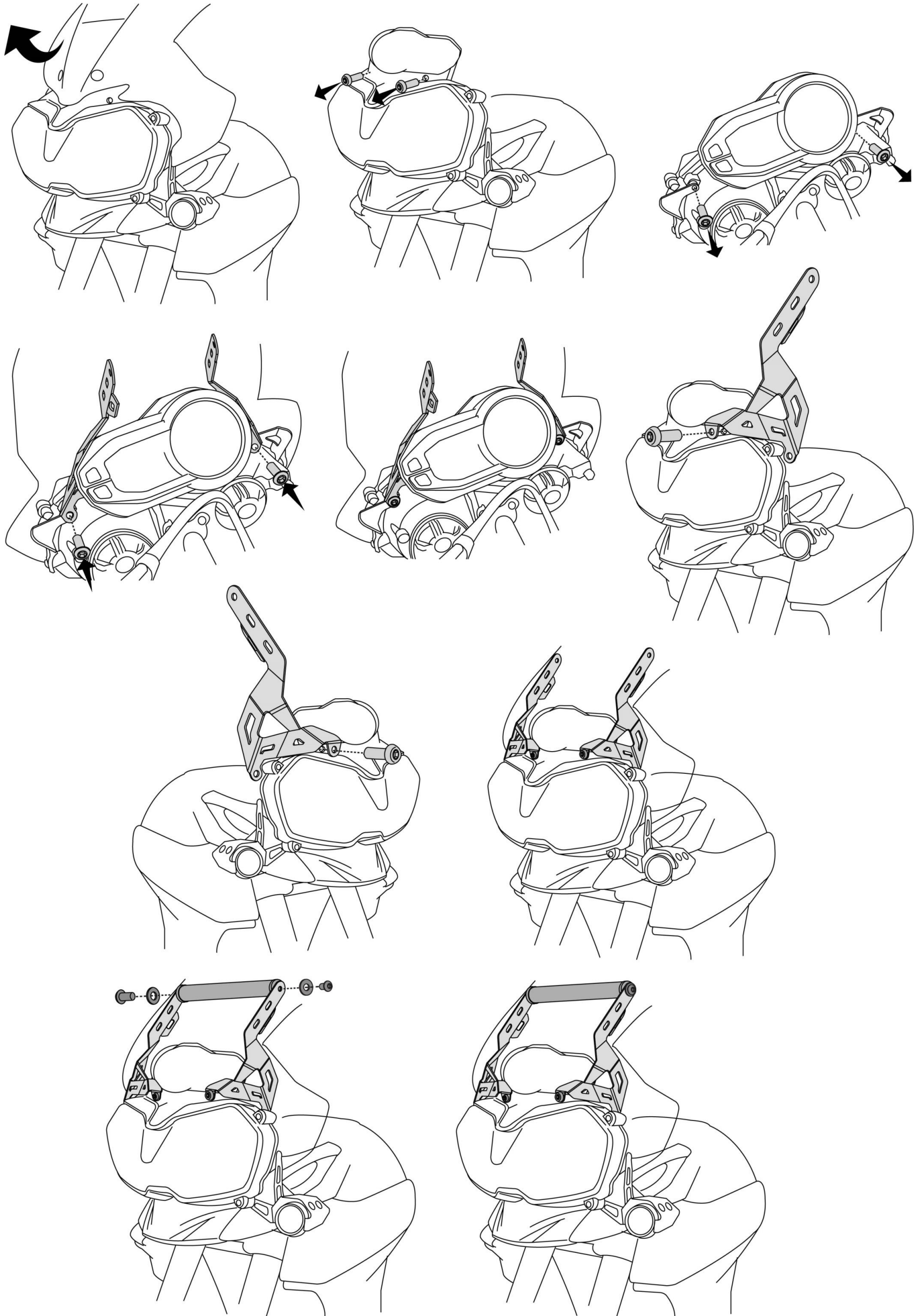

## Mounting Instructions

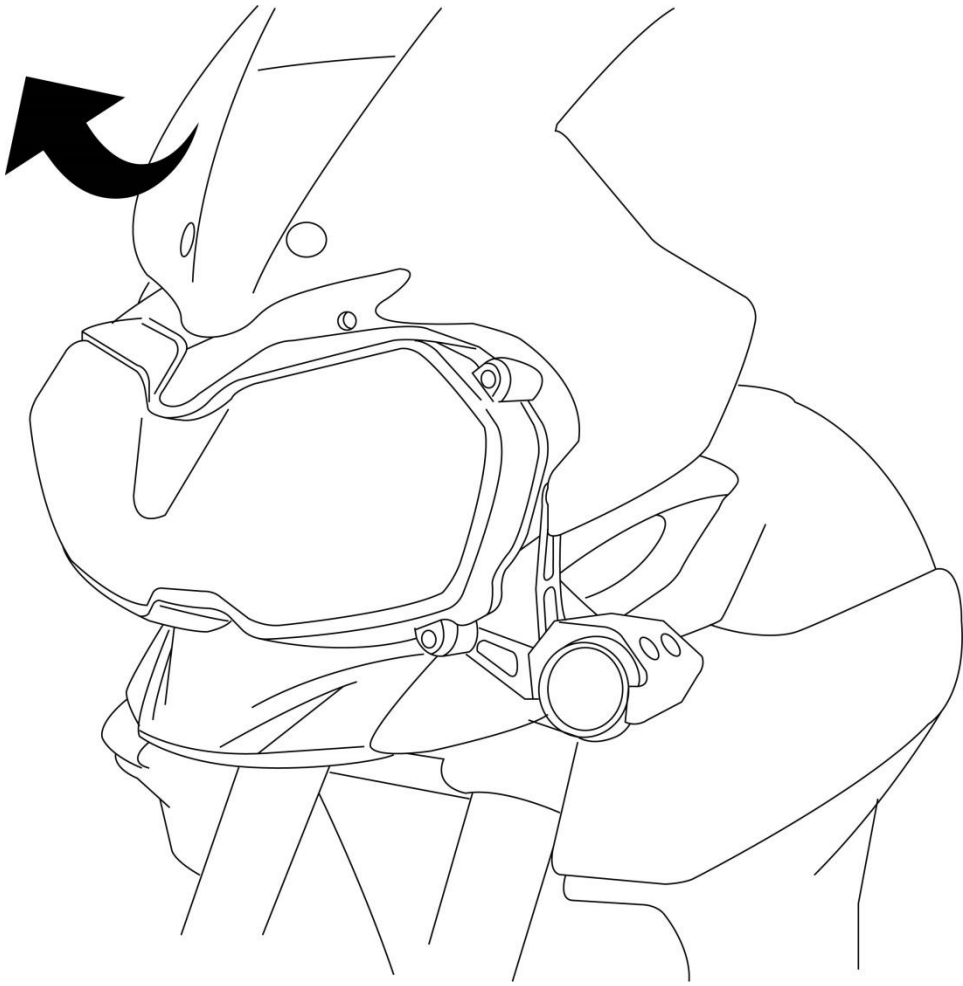

### Step 1:

The Wind shield on the front has to be removed. Unscrew them from its position and keep it aside.

This will facilitate access to the Mounting holes for fitment of GPS Bracketry.

### Step 2:

Unscrew the 2 off Button Head screws, as shown, and keep them aside.

SRC's GPS Bracketry will be mounted/fitted using the above screws.

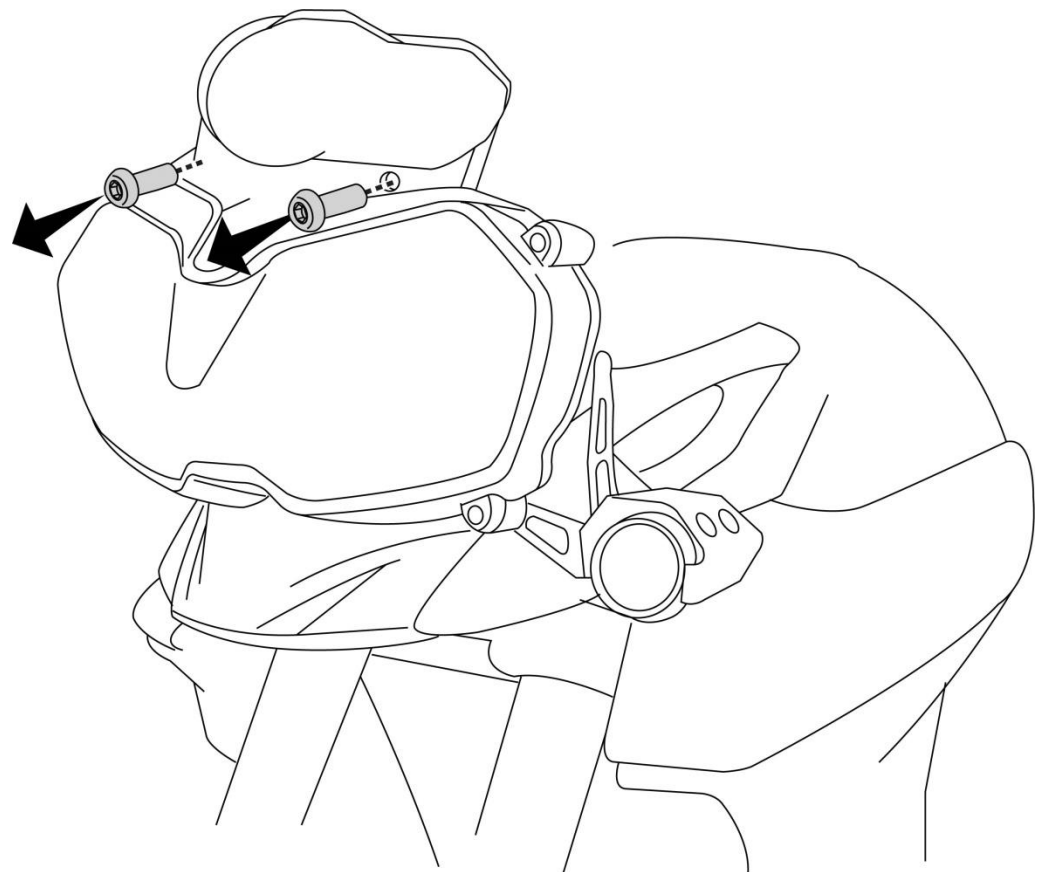

### Step 3:

Under the Speedo console, unscrew the 2 off Button head screws, as shown.

Again, the same hardware will be used for mounting/fitting the GPS Bracketry.

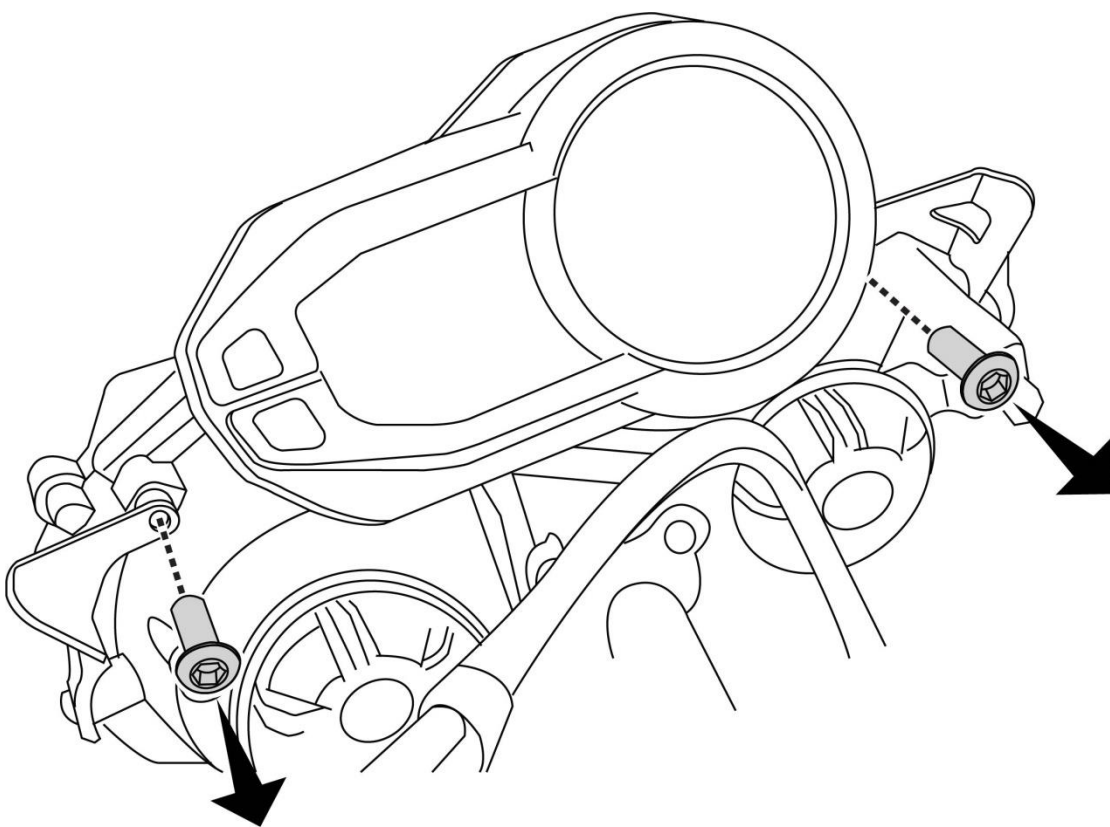



**Step 4:**

**Orient and align the LH Bracket (4), as shown, with its mounting hole in-line with the hole under the Speedo console, on the LH side, as shown above.**

**Slip-in 1 off Button head screw (which was removed in the previous step) and secure the threads.**

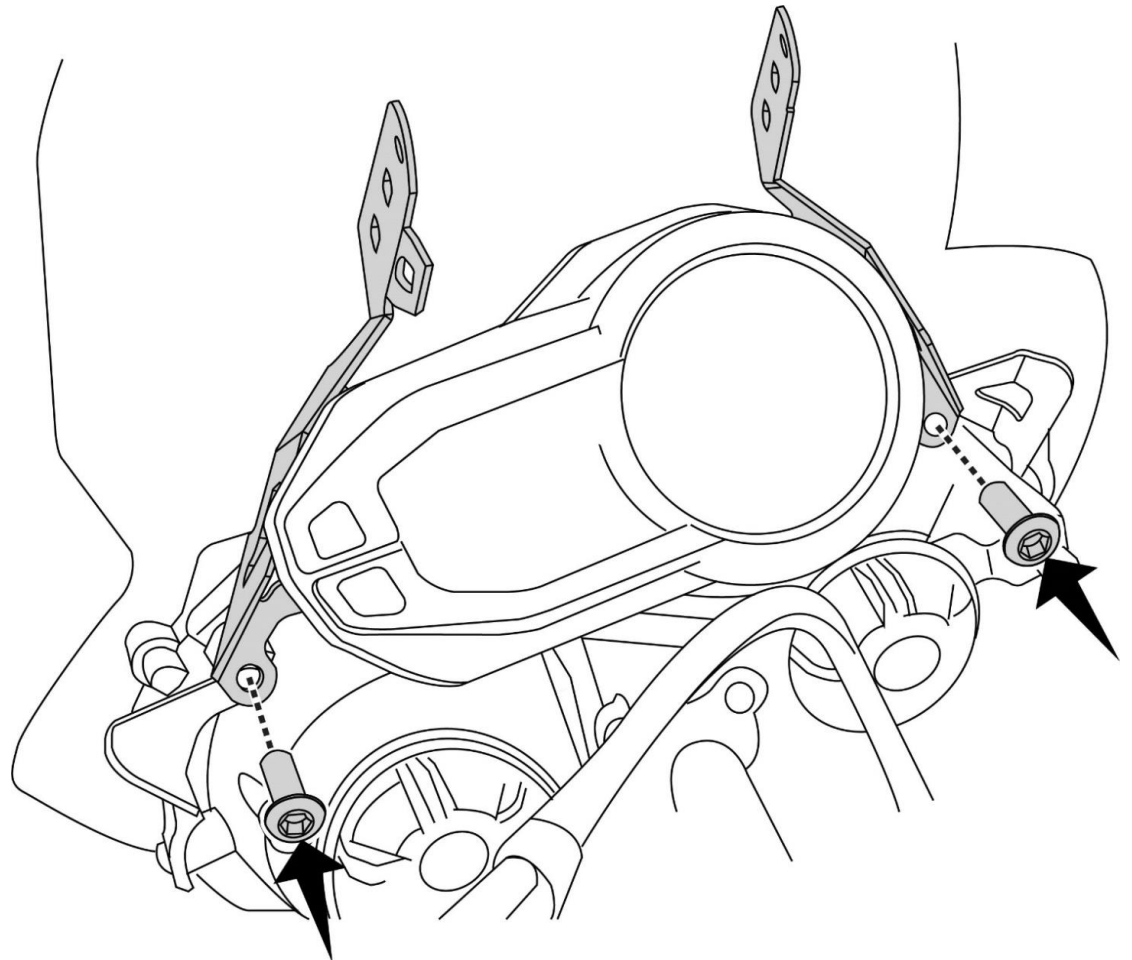

**Step 5:**

**Orient and align the RH Bracket (1), as shown, with its mounting hole in-line with the hole under the Speedo console on the RH side, as shown above.**

**Slip-in 1 off Button head screw and secure the threads.**

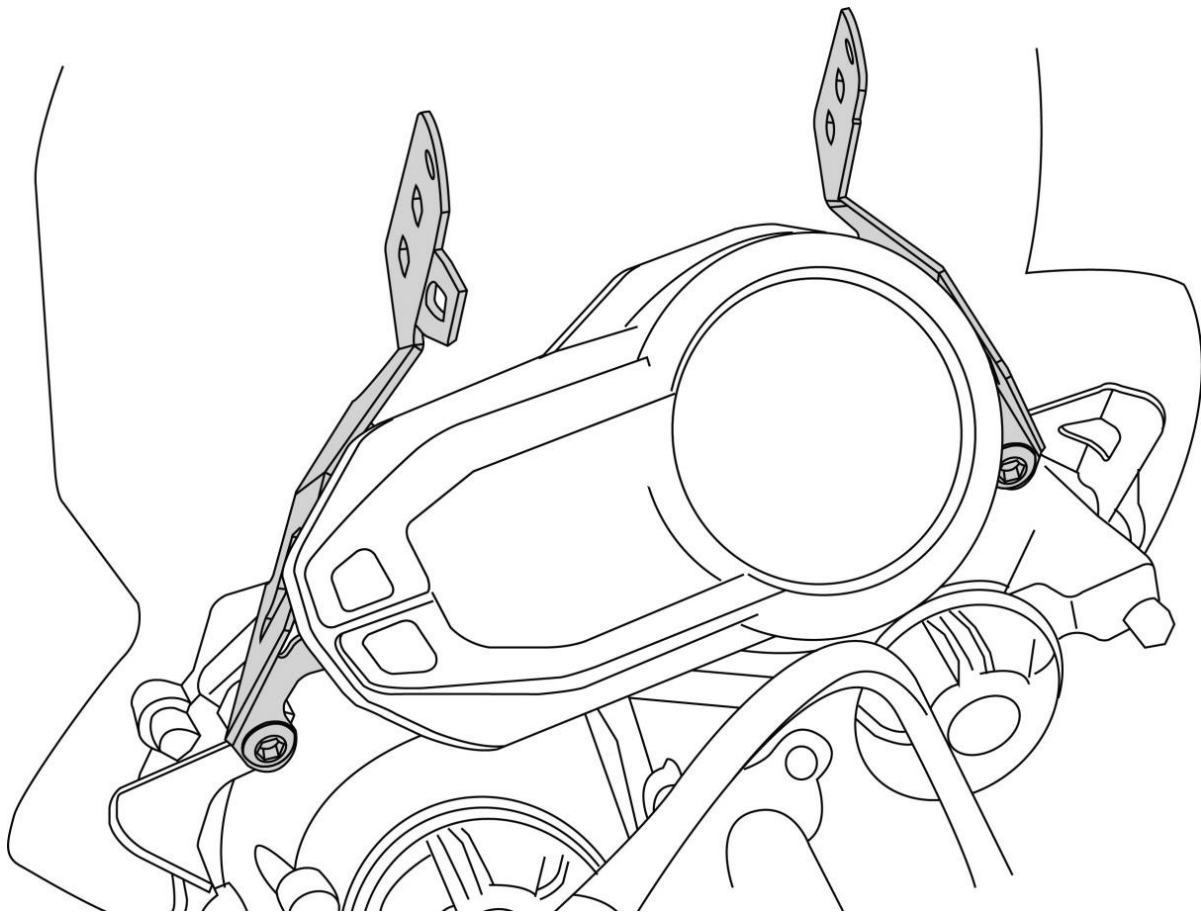

**The LH and RH GPS Brackets in “As is mounted condition” is as shown in the drawing to the right.**

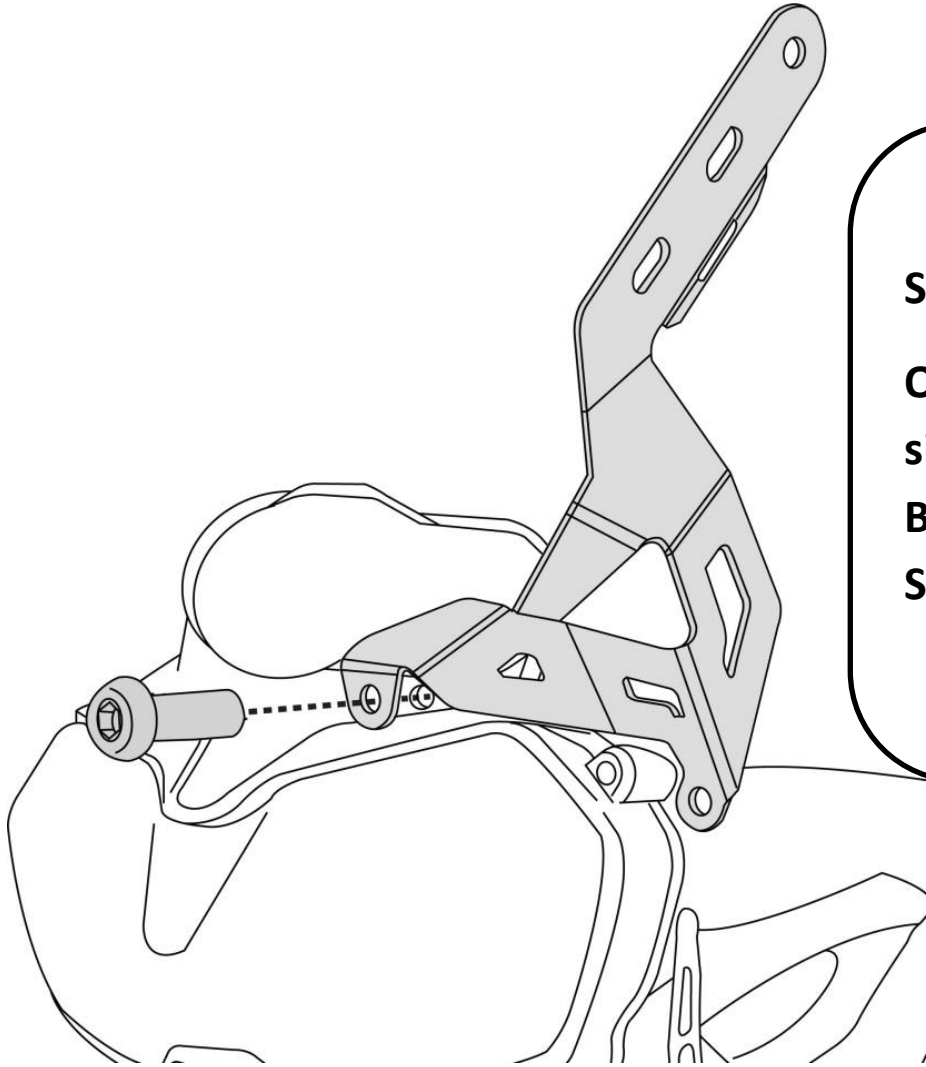

**Step 6:**

**Orient and align the LH Bracket (4) to the front side mounting hole, as shown, and slip-in 1 off Button Head screw (which was removed in Step 2) and secure the threads.**

**Step 7:**

**Follow the step 6, for mounting the RH Bracket and secure the threads**

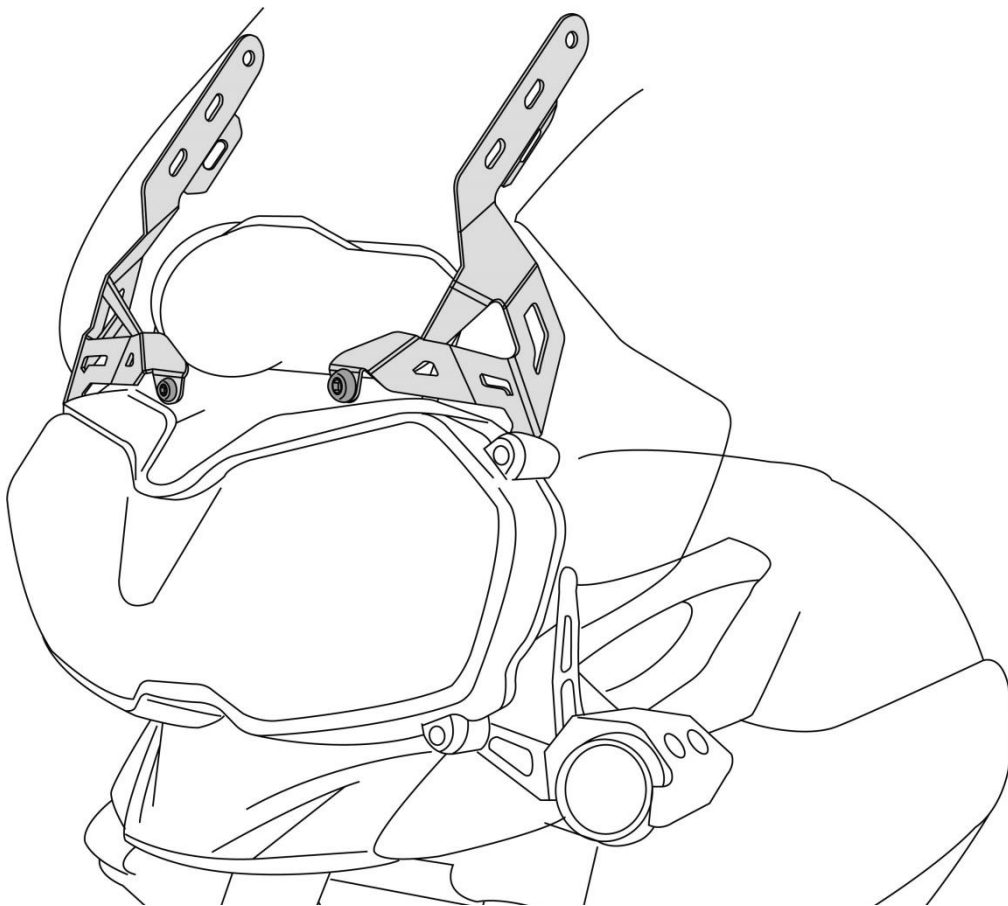
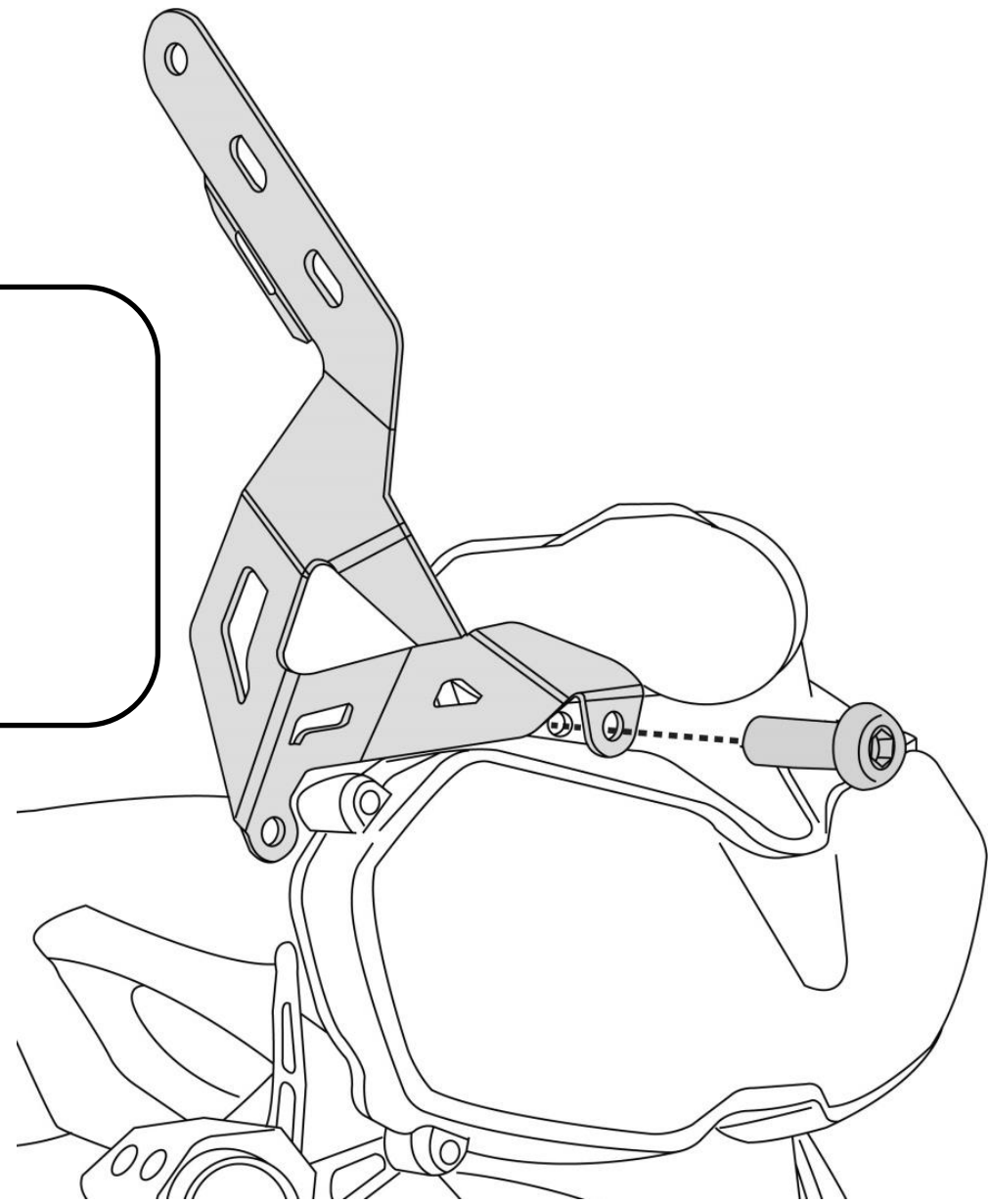

**The LH and RH Brackets, are as shown in the drawing on the left, in “As is mounted condition”.**



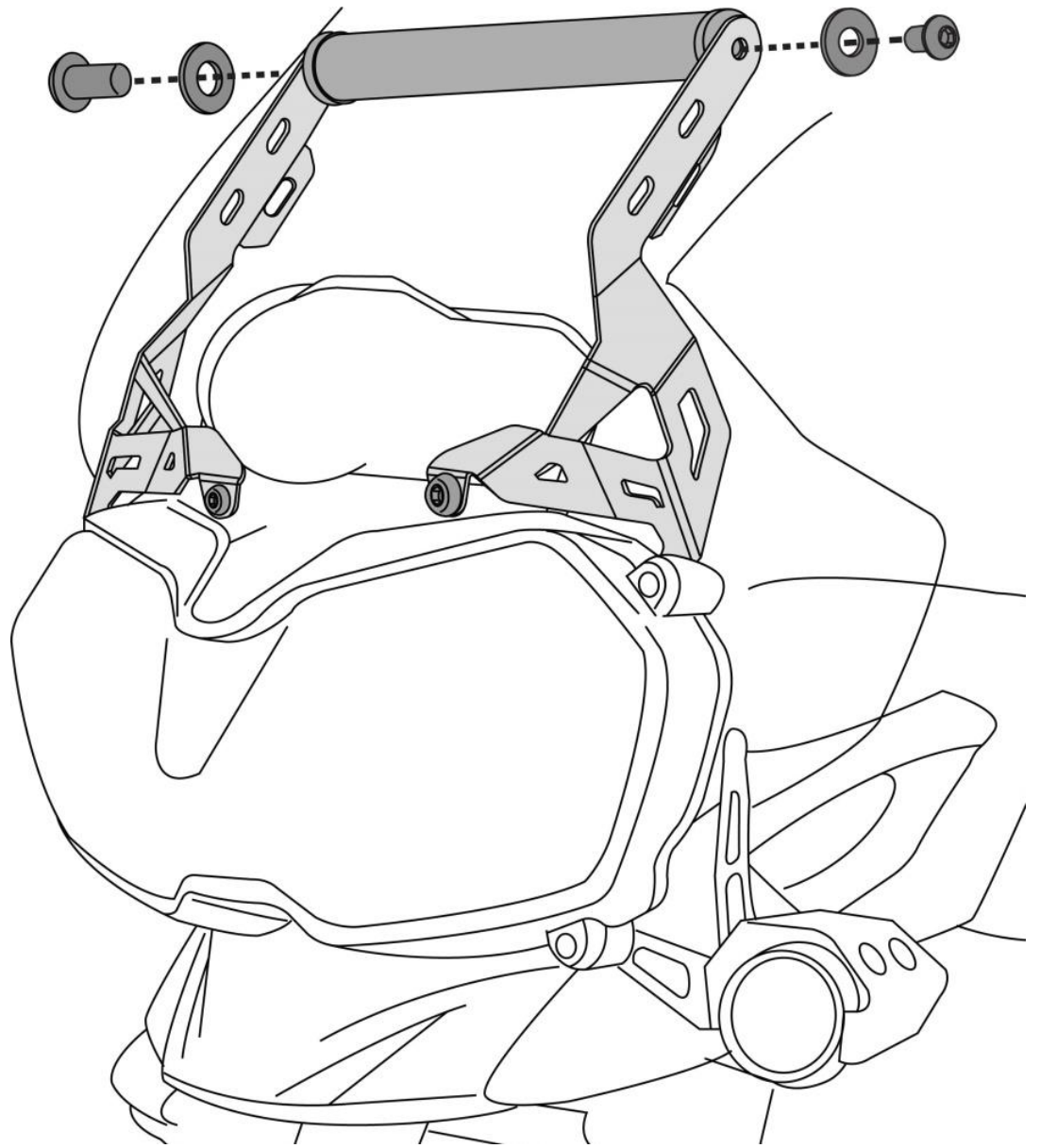

**Step 8:**

The GPS Bar (3), has the End Adaptors, welded together and Orient and align it in-line to the Mounting hole on top of the LH and RH bracket, as shown.

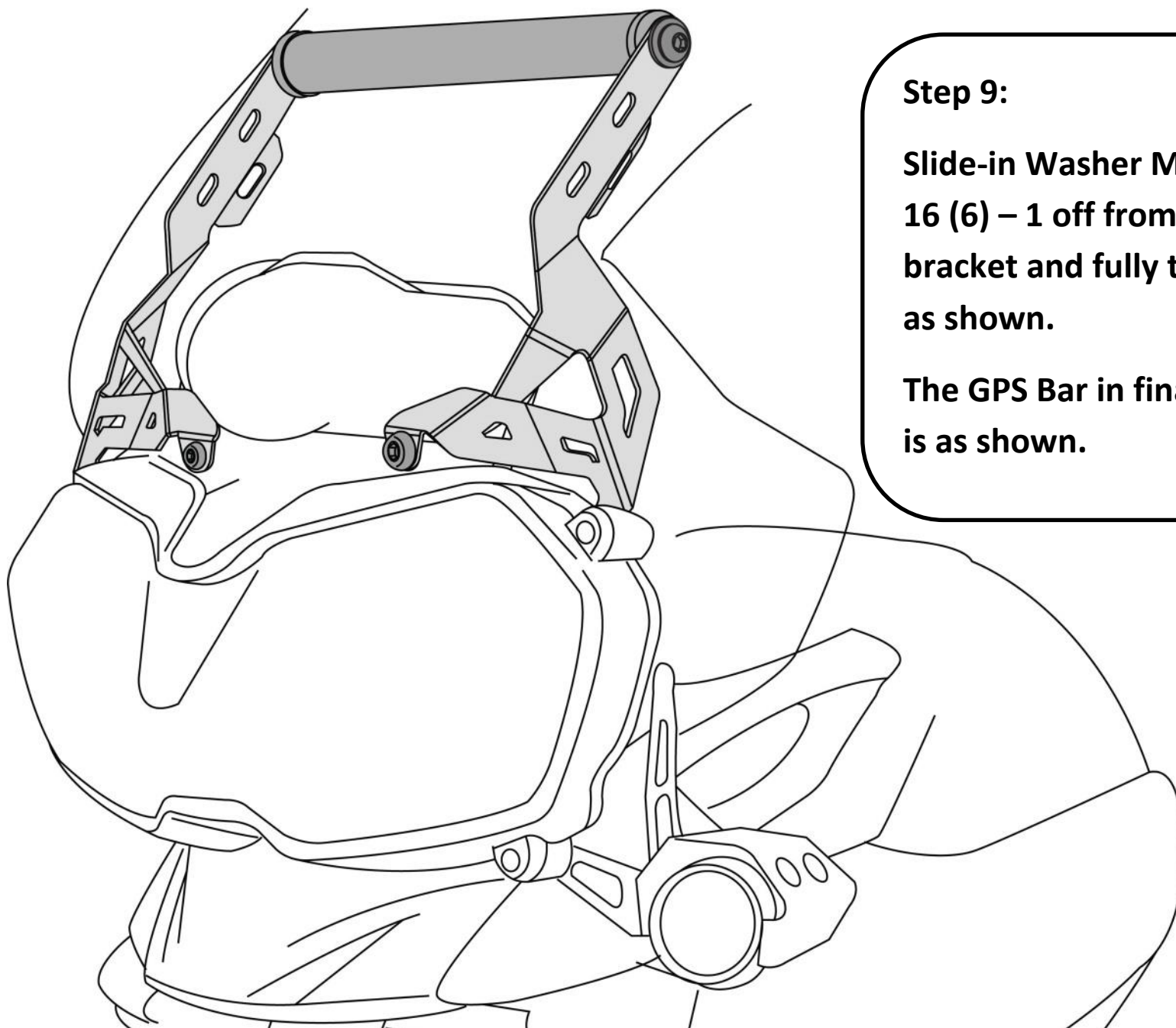

**Step 9:**

Slide-in Washer M8 (5) and Screw M8 x 16 (6) – 1 off from each side of the bracket and fully tighten the GPS bar, as shown.

The GPS Bar in final mounted condition is as shown.



## General Instructions

1. We request you to pay attention to the Mounting Instructions in this document and follow the step-by-step procedures.
2. This Mounting Instruction manual is a “Do It Yourself” (DIY) fitment manual of the Accessory part to the Vehicle. We have prepared this based on our experience and knowledge, related to the Vehicle, Part and its functional aspects.
3. SRC cannot guarantee the interchangeability of the parts to any other manufacturer’s accessory part. It is advised to the User, to inspect and ensure the original state of all other Vehicle parts.
4. We request you to bear in mind, that the Installed part can change the driving behaviour and/or the stability during driving or any other dynamic conditions.
5. If you have the appropriate tools and another person to assist you in the mounting, it will help.
6. After Completion of the Mounting and before taking on a First ride, Ensure and Check all functions of the Vehicle. It is always advised to check loosening of the fasteners after the first 50 kilo meters of ride and at regular intervals.
7. To the maximum extent possible, our design use the current Mounting/Fitment of the Original Equipment, so that Installation of these accessories will not affect the Payload or Function of the Vehicle or the Part on which it is mounted to protect it
8. If any additional modifications are to be done, prior to the fitment of the accessories, it will be explicitly specified in the instruction sheets