

## Scope of Supply/Bill of Material & Mounting Drawings

Part Number: S-VS1050XT-17-01-SL / S-VS1050XT-17-02-SL

Part Description: Crash bar V-STROM1050 XT

Applicable to both Stainless Steel Versions

### Installation / Parts List / Bill of Material for Mounting

NO.	Description	Quantity	Torque * (N-M)	Remarks **
1	Crash Bar Top LH	1		
2	Crash Bar Top RH	1		
3	Crash Bar Lower LH	1		
4	Crash Bar Lower RH	1		
5	Top Bracket	1		
6	Side Bracket LH & RH	2		
7	Pin pipe	2		
8	Bush Top LH 21x11x32	1		
9	Bush Top RH 21x11x29	1		
10	Bush Lower LH 24x13x11	1		
11	Bush Lower RH 24x13x26	1		
12	Slider Guards	4		
13	Socket button head Screw M6x15	4	9-10	Use Liquid Thread Locker
14	Hex flange bolt small M8x30	2	22-24	Use Liquid Thread Locker
15	Hex flange bolt small M8x15	8	22-24	Use Liquid Thread Locker
16	Socket head cap Screw M8x20	2	22-24	Use Liquid Thread Locker
17	Socket head cap Screw M10x1.25 L95	1	44-48	Use Liquid Thread Locker
18	Socket head cap Screw M10x1.25 L115	1	44-48	Use Liquid Thread Locker
19	Washer M6	4		Use Liquid Thread Locker
20	Washer M8	2		Use Liquid Thread Locker
21	Washer M10	2		

SRC Design uses Metric System of Measurement and all dimensions in Millimeters

\* Recommended to use the Torque specified in the table

\*\* Denotes Usage of Liquid Thread Locker in specified Locations

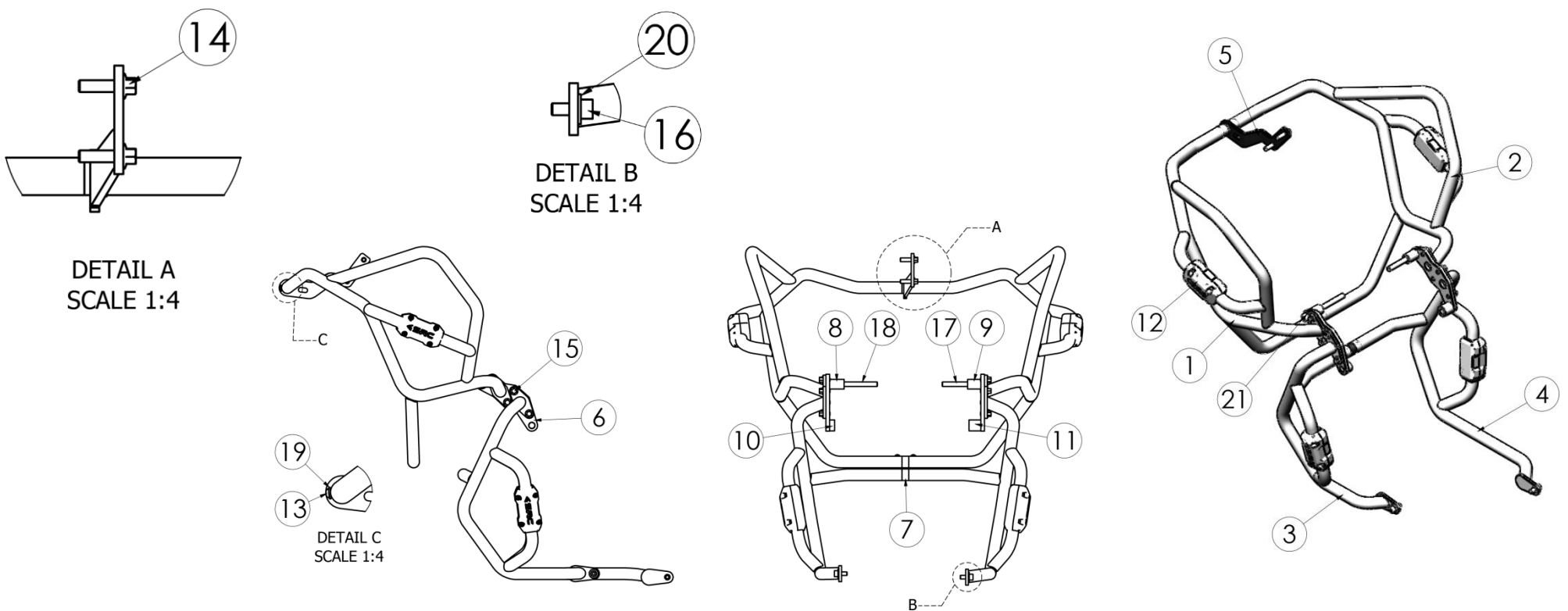

**Before starting to mount the Top Bracket**

**Move 2 off, the original screw in motorbike (as show)**

**As show RH motorbike**

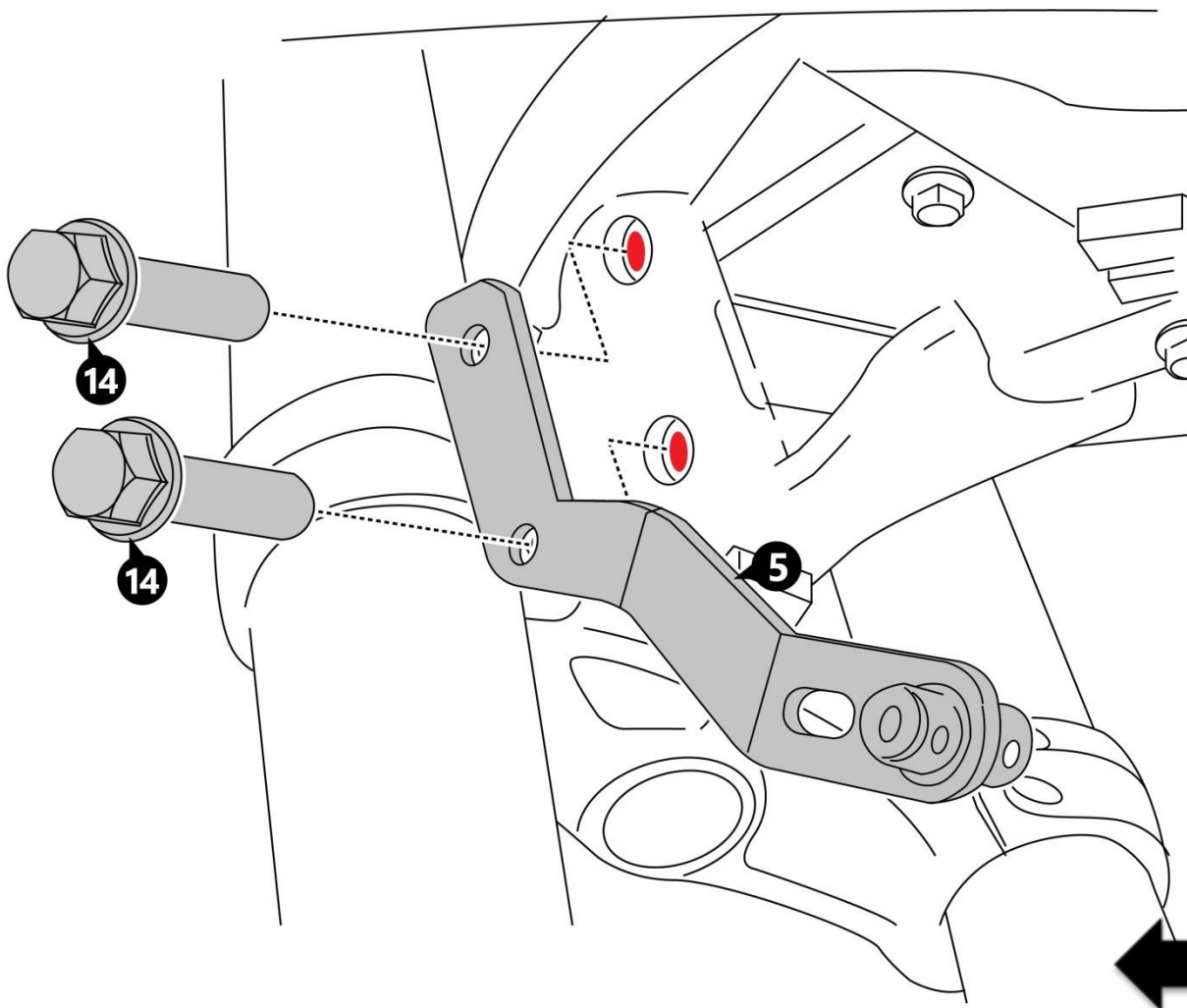
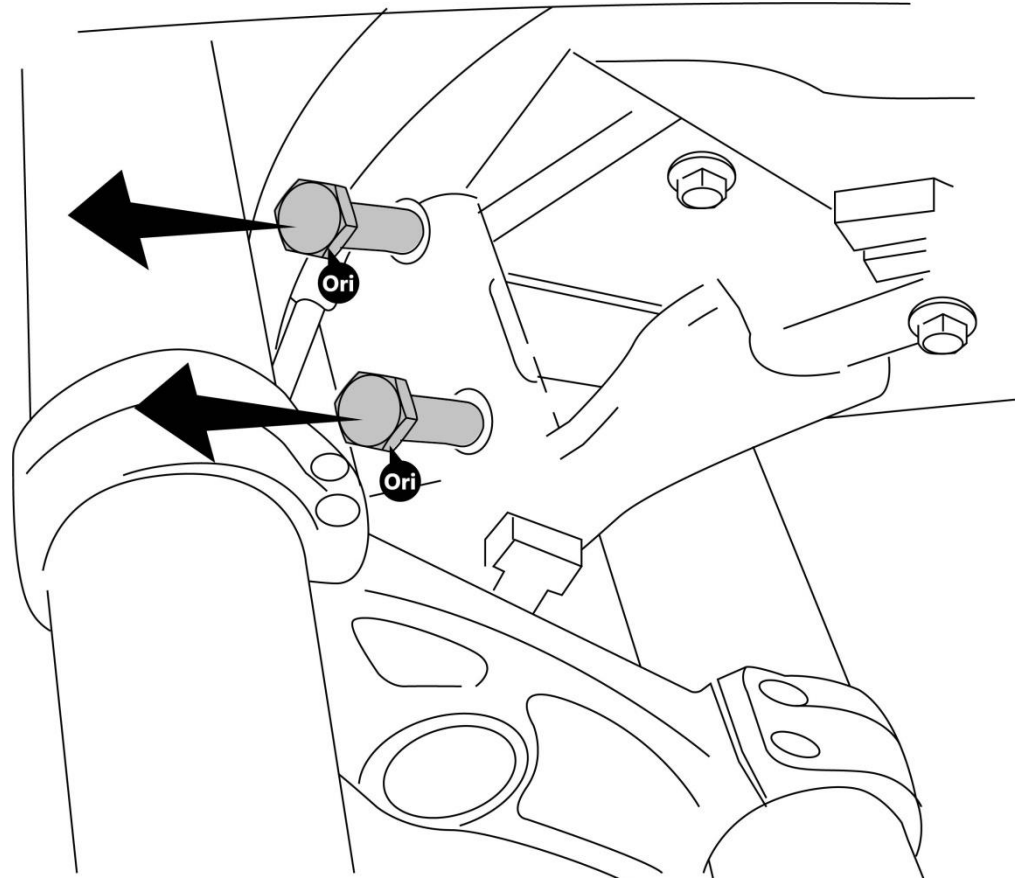

**Step 1:**

**Orient, Mount and Fit the Top Bracket (5) to the Motorbike Chassis frame (as show)**

**Use Bolt Screw M8x30 (14) – 2 off, as shown in the BOM table and the drawing.**

**Do not tighten the screws fully.**

**As show RH motorbike**

**Move 2 off, the original screw in motorbike (as show)**

**As show RH motorbike**

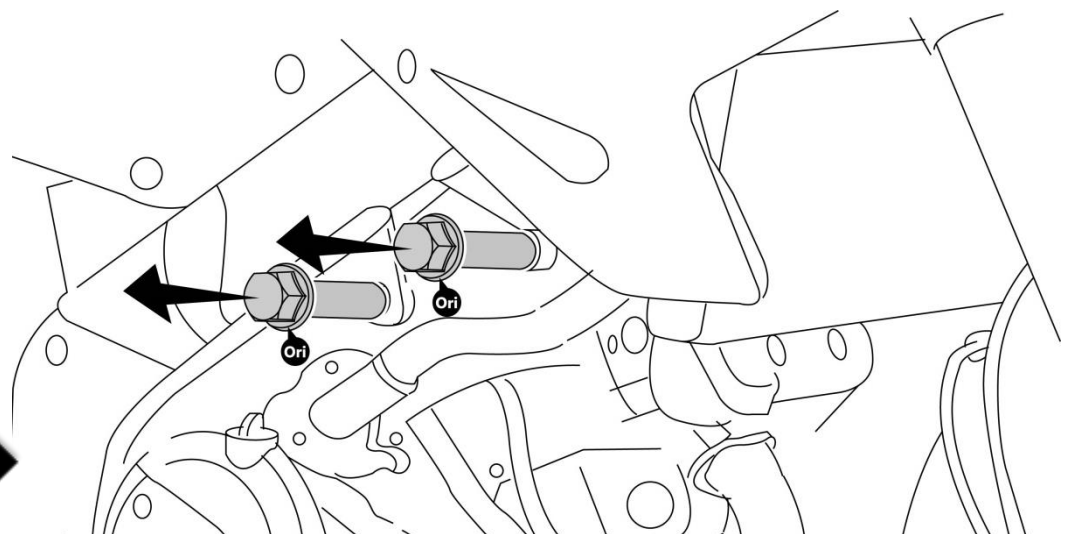



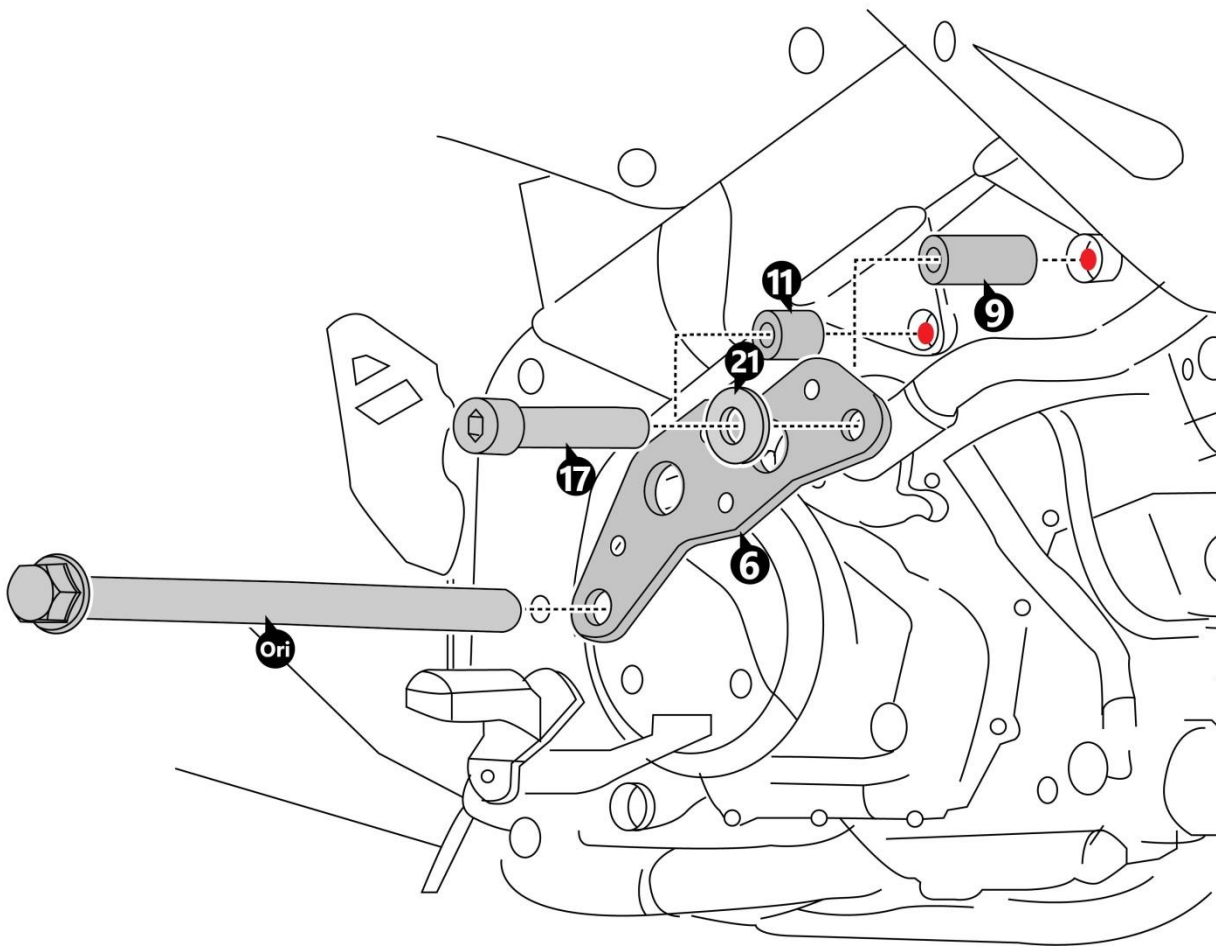

As show RH motorbike

**Step 2:**

**Orient the Bracket RH (6) is to be mounted to the Motorbike Chassis Frame as shown.**

**Slide-in the Bush Top RH (9) -1 off, Bush Lower RH (11) -1 off, washer M10 (21) -1 off, Screw M10x95 (17)-1 off, original screw-1 off, in motorbike and secure the threads in the Motorbike. (As shown)**

**Step 3:**

**Orient the Bracket LH (6) is to be mounted to the Motorbike Chassis Frame as shown.**

**Slide-in the Bush Top RH (8) -1 off, Bush Lower RH (10) -1 off, washer M10 (21) -1 off, Screw M10x115 (18)-1 off, original Nut -1 off, in motorbike and secure the threads in the Motorbike. (As shown)**

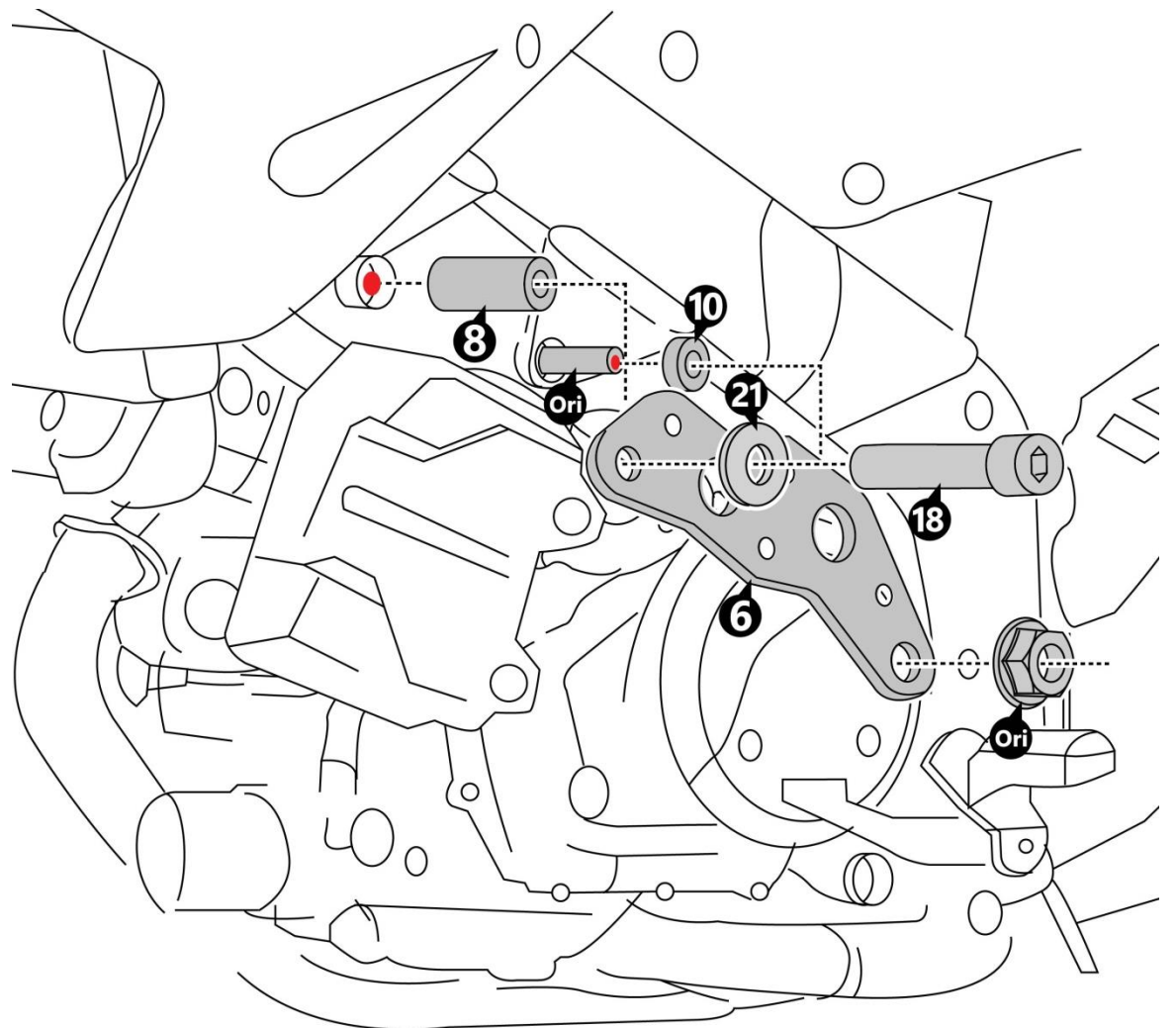

As show LH motorbike

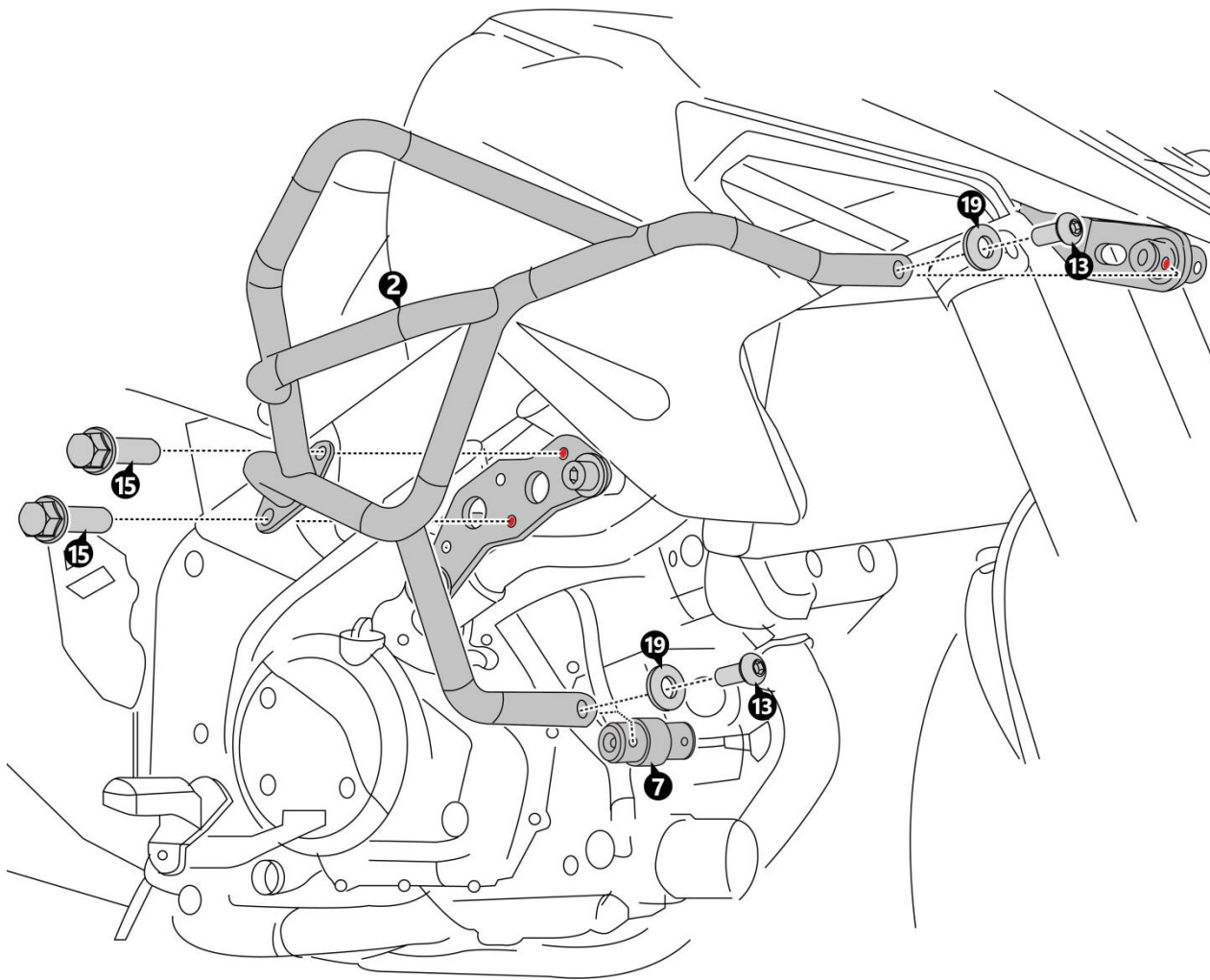

As show RH motorbike

**Step 4:**

**Orient the Crash Bar Top RH (2) is to be mounted to the Bracket RH (6) as shown.**

**Slide-in the Bolt screw M8x15 (15) -2 off,**

**Slide-in the Pin pipe (7) and washer M6 (19) -1 off, screw M6x15 (13) -1 off, and slip-in screw M6x15 - 1 off, washer M6 – 1 off, at Top crash Bar and top bracket and secure the threads in the Motorbike. (As shown)**

**Step 5:**

**Orient the Top End of the Crash Bar LH (1).**

**And Slide-in Screw M6x15 (13) –2 off, and Washer M6 (19) –2 off, to top bracket and Pin pipe, through the Mounting hole in the Crash Bar. Slide-in the Bolt screw M8x15 (15) -2 off, to the Bracket LH. (As shown)**

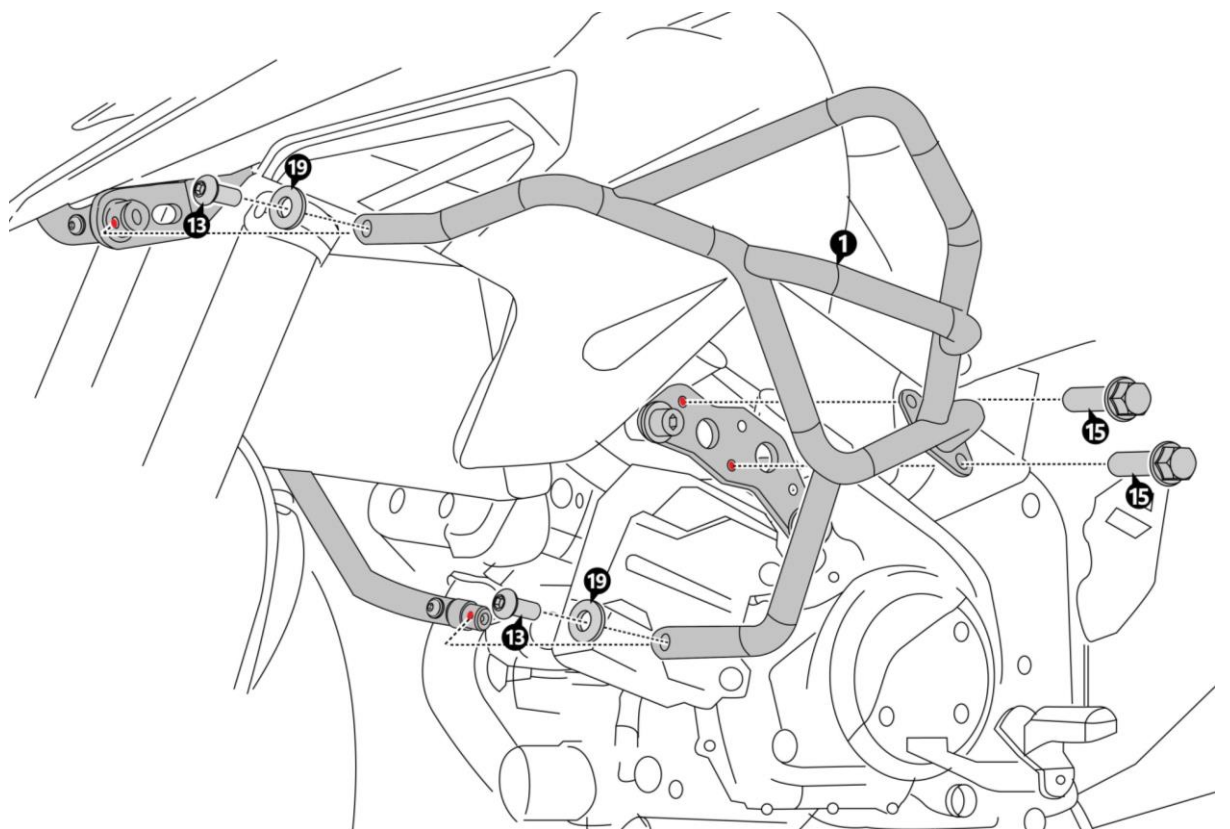

As show LH motorbike



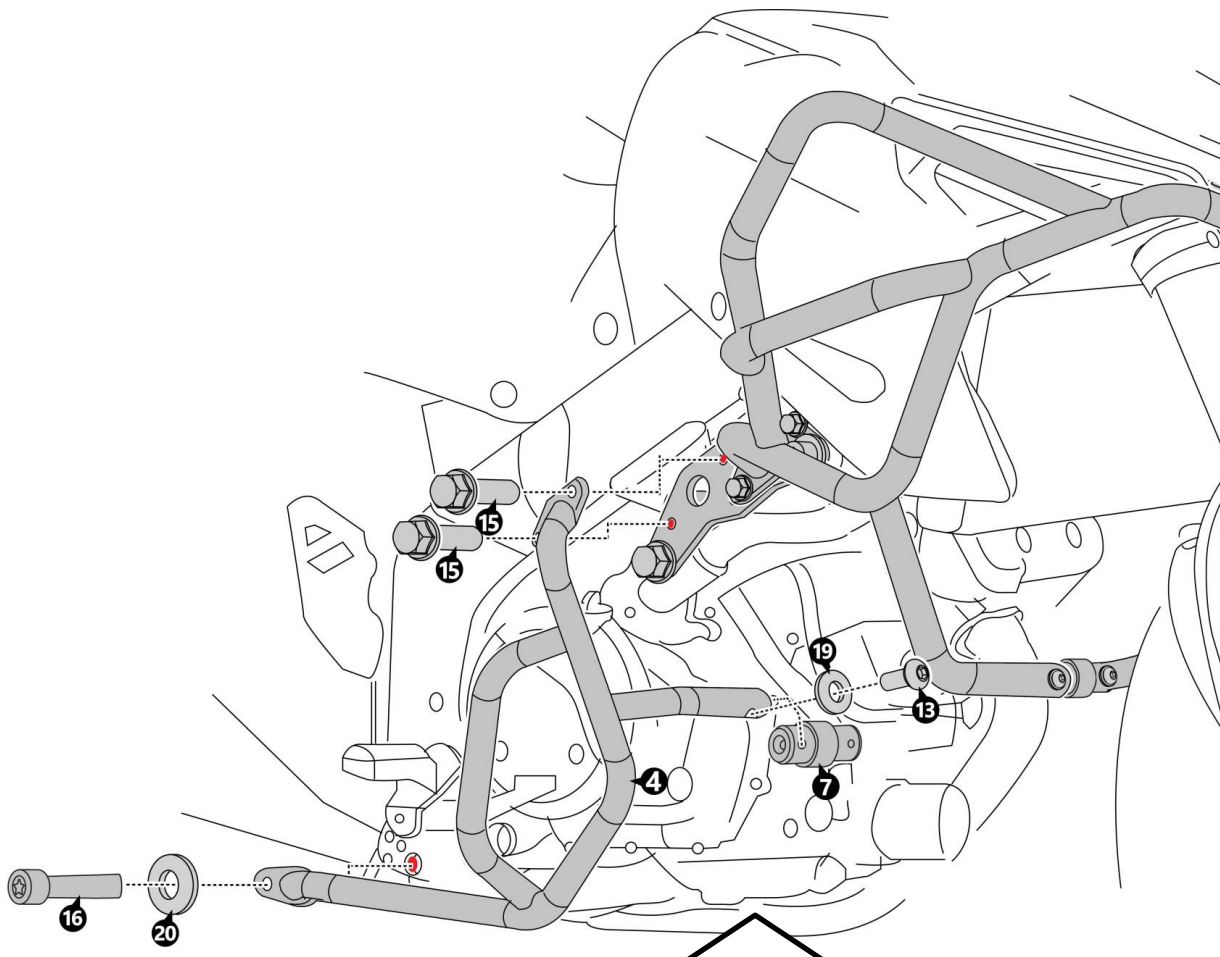

**Step 6:**

**Align the Lower Crash Bar LH&RH, as shown, and slide-in the bold screw M 8x15 (15)- 2 off, at Middle group, the Washer M8 (20) – 2 off, Screw M8 x 20 (16) – 2 off and secure the threads .**

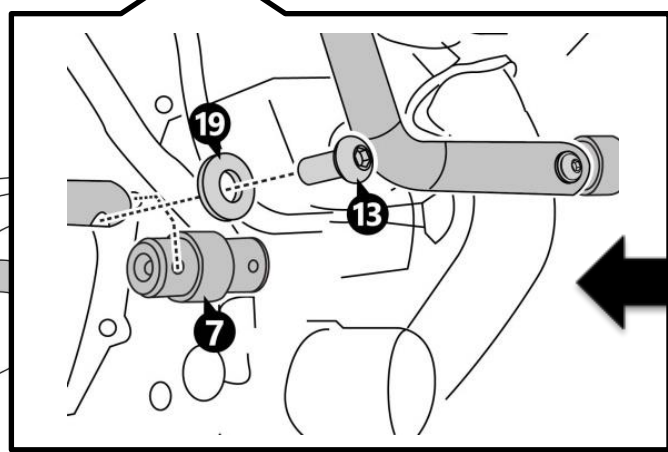

**Slide-in the pin pipe (7) and slide-in the screw M6x15 (13) – 2 off, washer M6 (19) - 2 off, threads in the other end of the Pin pipe (7).**

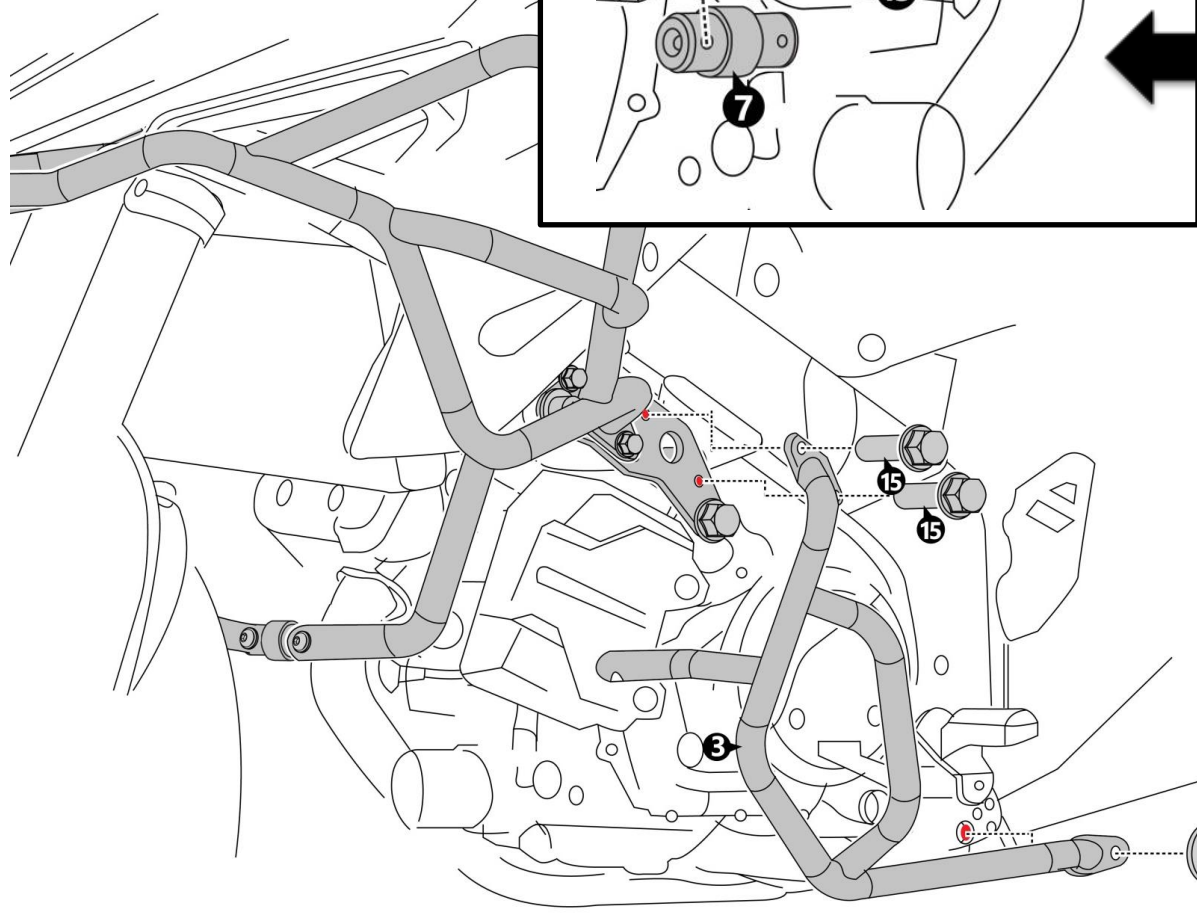

**As show LH & RH**

**Step 7:**

**Assemble the Slider Bar on each of the Crash Bar as shown. Use the Slider Bar as the Virtual Orientation and looking from the front side of the Motorbike, make one final Positioning and Alignment of the Crash bars.**

**Ensure mounting symmetry of the Slider Bars visually (it must not be offset or shifted visually when seen from the front side and back side).**

**All Mounting fasteners can be tightened to the torque, as specified in the BOM table.**

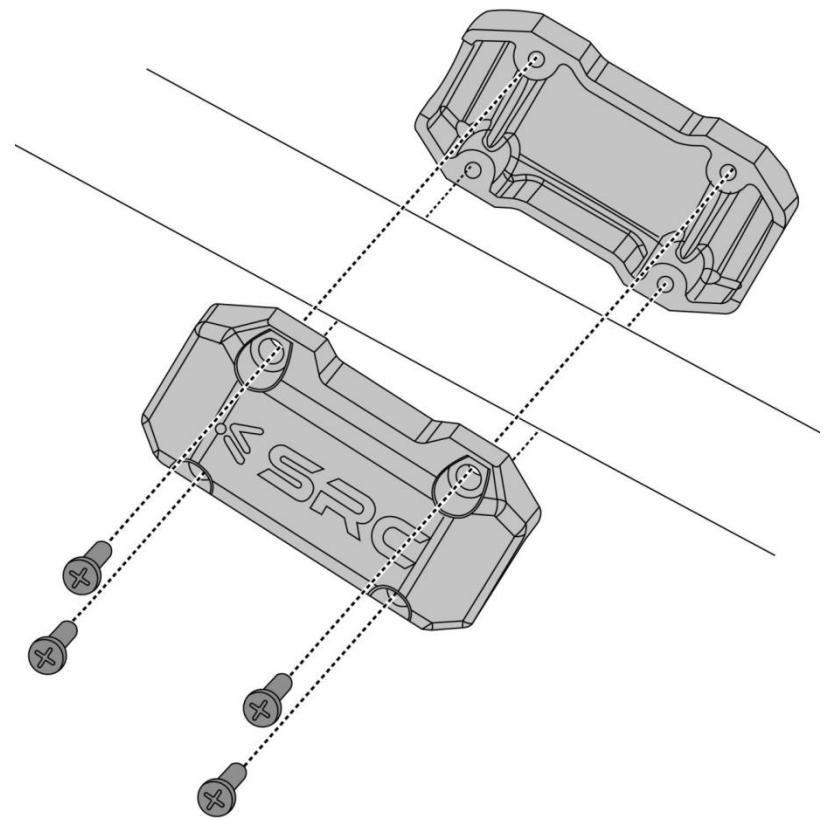



## General Information

1. We request you to pay attention to the Mounting Instructions in this document and follow the step-by-step procedures.
2. This Mounting Instruction manual is a “Do It Yourself” (DIY) fitment manual of the Accessory part to the Vehicle. We have prepared this based on our experience and knowledge, related to the Vehicle, Part and its functional aspects.
3. SRC cannot guarantee the interchangeability of the parts to any other manufacturer’s accessory part. It is advised to the User, to inspect and ensure the original state of all other Vehicle parts.
4. We request you to bear in mind, that the Installed part can change the driving behaviour and/or the stability during driving or any other dynamic conditions.
5. If you have the appropriate tools and another person to assist you in the mounting, it will help.
6. To the maximum extent possible, our design use the current Mounting/Fitment of the Original Equipment, so that Installation of these accessories will not affect the Payload or Function of the Vehicle or the Part on which it is mounted to protect it
7. If any additional modifications are to be done, prior to the fitment of the accessories, it will be explicitly specified in the instruction sheets.