

## Scope of Supply/Bill of Material & Mounting Drawings

Part Number: KTM390-01-01-SL / KTM390-01-02

Part Description: Head Light Guard –KTM 390 Adventure

Applicable to Finished colour versions of Black and Silver

### Installation / Parts List / Bill of Material for Mounting

NO.	Description	Quantity	Torque * (N-M)	Remarks **
1	Head Light Guard	1		
2	Socket but ton Head Screw M5x20 mm	1	5.5	Use Liquid Thread Locker
3	AD Head Light Guard	1		
4	Bush delrin M6 11x8	2		
5	AD B Head Light Guard	1		
6	Washer M6	2		
7	Socket but ton Head Screw M6x20 mm	2	9.6	Use Liquid Thread Locker
8	Socket but ton Head Screw M5x10 mm	4	5.5	Use Liquid Thread Locker
9	Washer M5	2		
10	Bush Rubber 5 mm	4		
11	Rubber Grommet	4		
12	AD F B Head Light Guard	1		

SRC Design uses Metric System of Measurement and all dimensions in Millimeters

\* Recommended to use the Torque specified in the table

\*\* Denotes Usage of Liquid Thread Locker in specified Locations

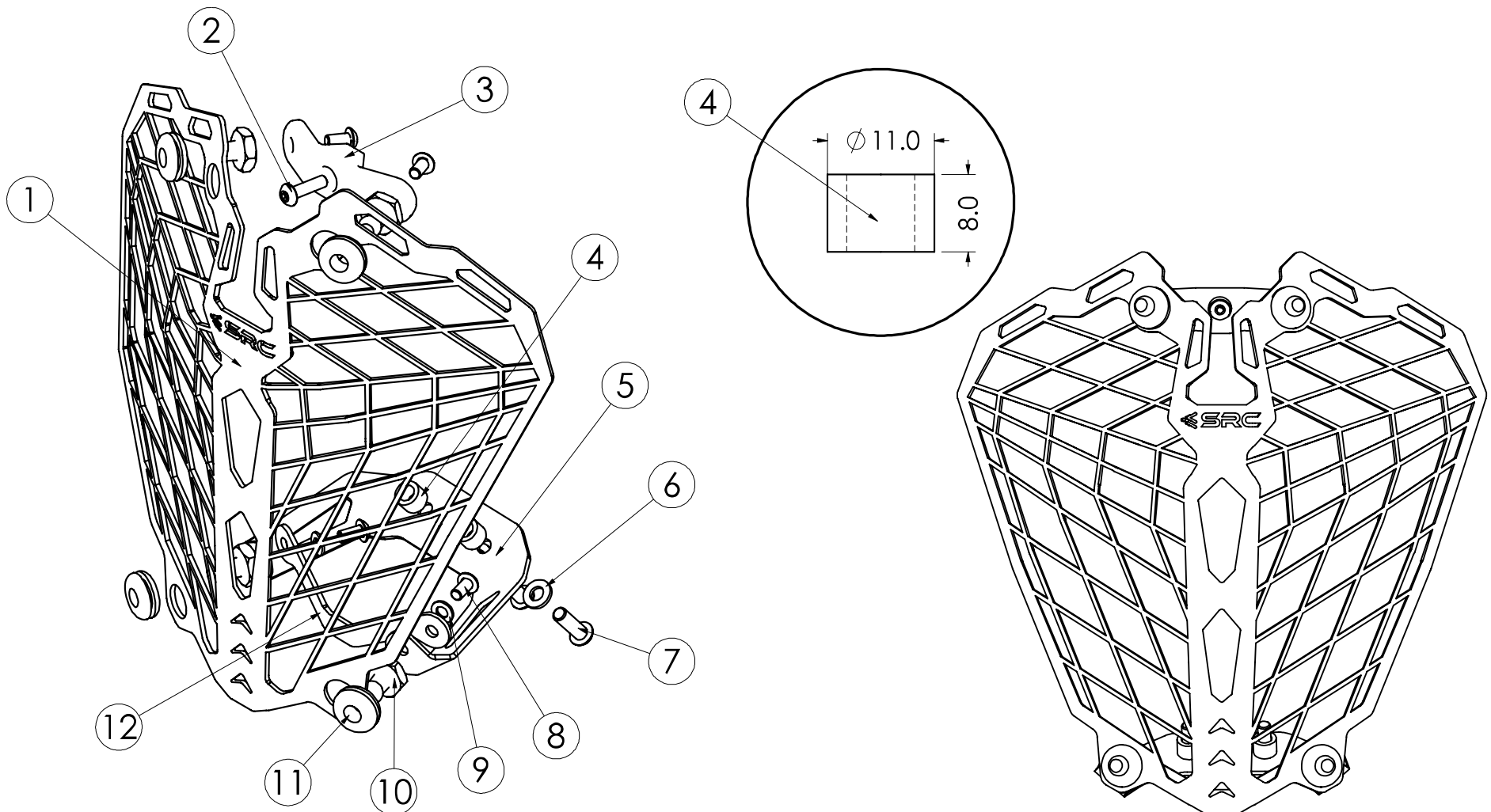

## Mounting Instructions

### Step 1:

Unscrew the Mounting Bolt, (original Screw in the Motorbike) from the Right Side, Left Side and Front Side.

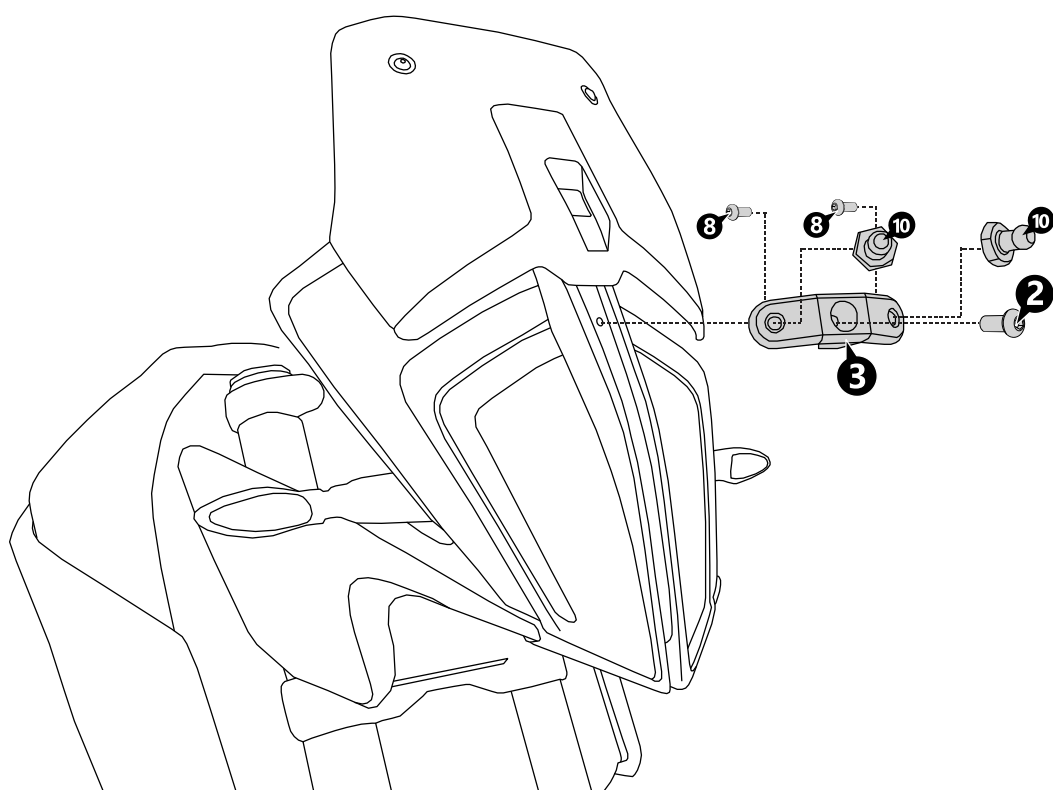
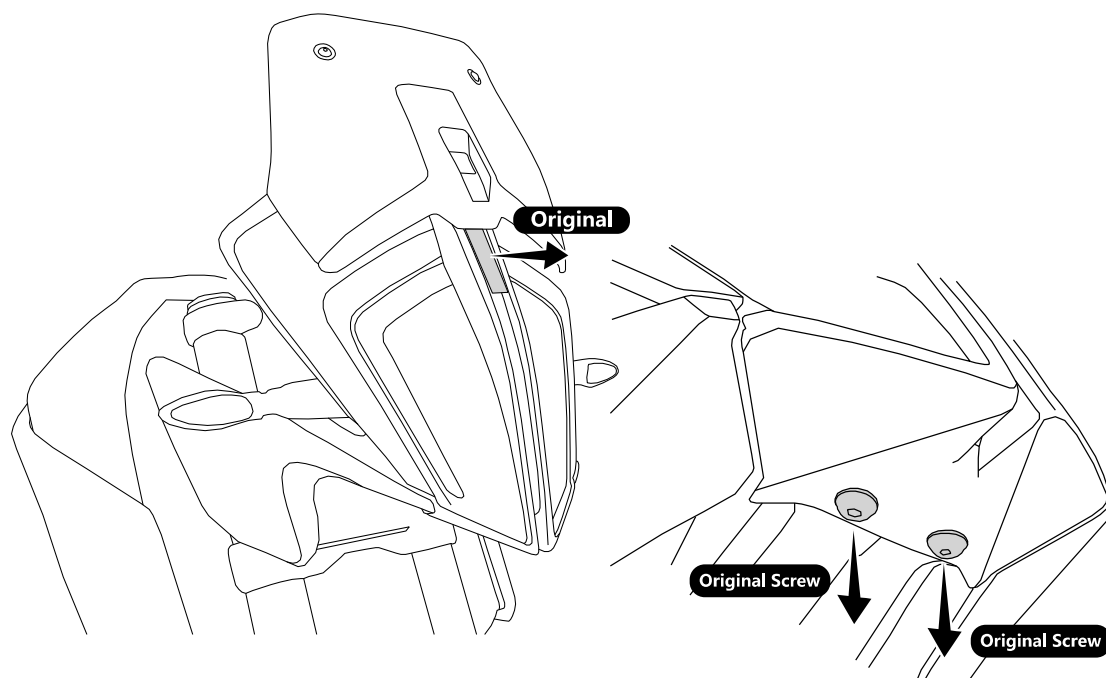

### Step 2:

Orient the Bracket (3), as shown, and slip-in the Bush Rubber (10) and Screw M5x10 (8) – 2 off , and Screw M5x20 (2) – 1 off , as shown .

### Step 3:

Orient the Bracket (5), and the Bracket (12), as shown, and slip-in the Bush Delrin (4)-2 off and Screw M6x20 (7) – 2 off , and Screw M5x10 (8) – 2 off , and slip-in the Bush Rubber (10) as shown .

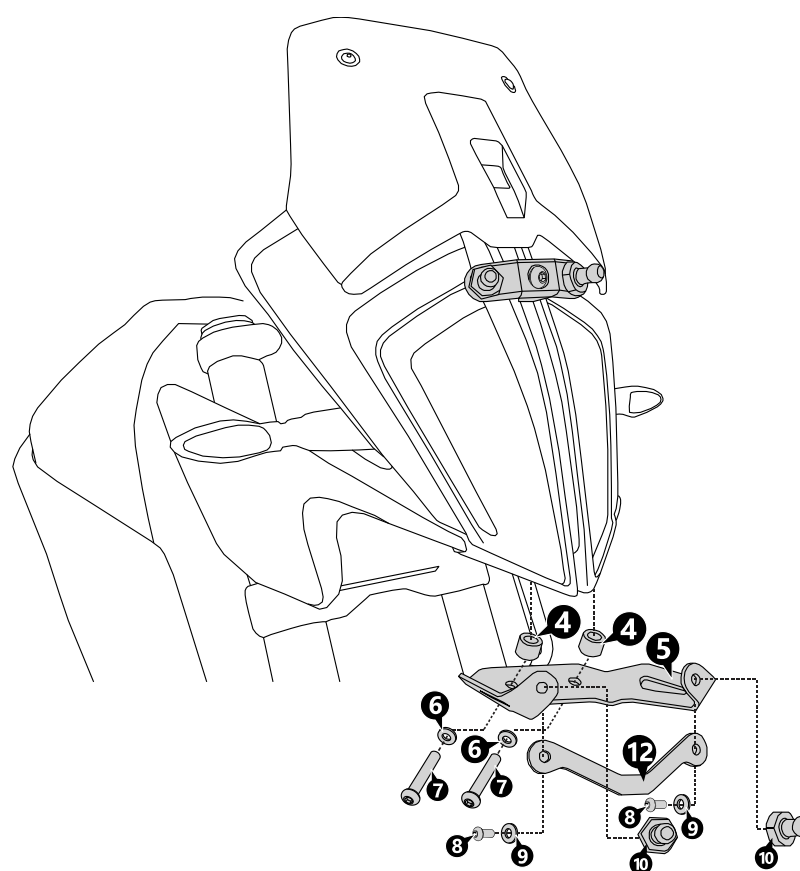

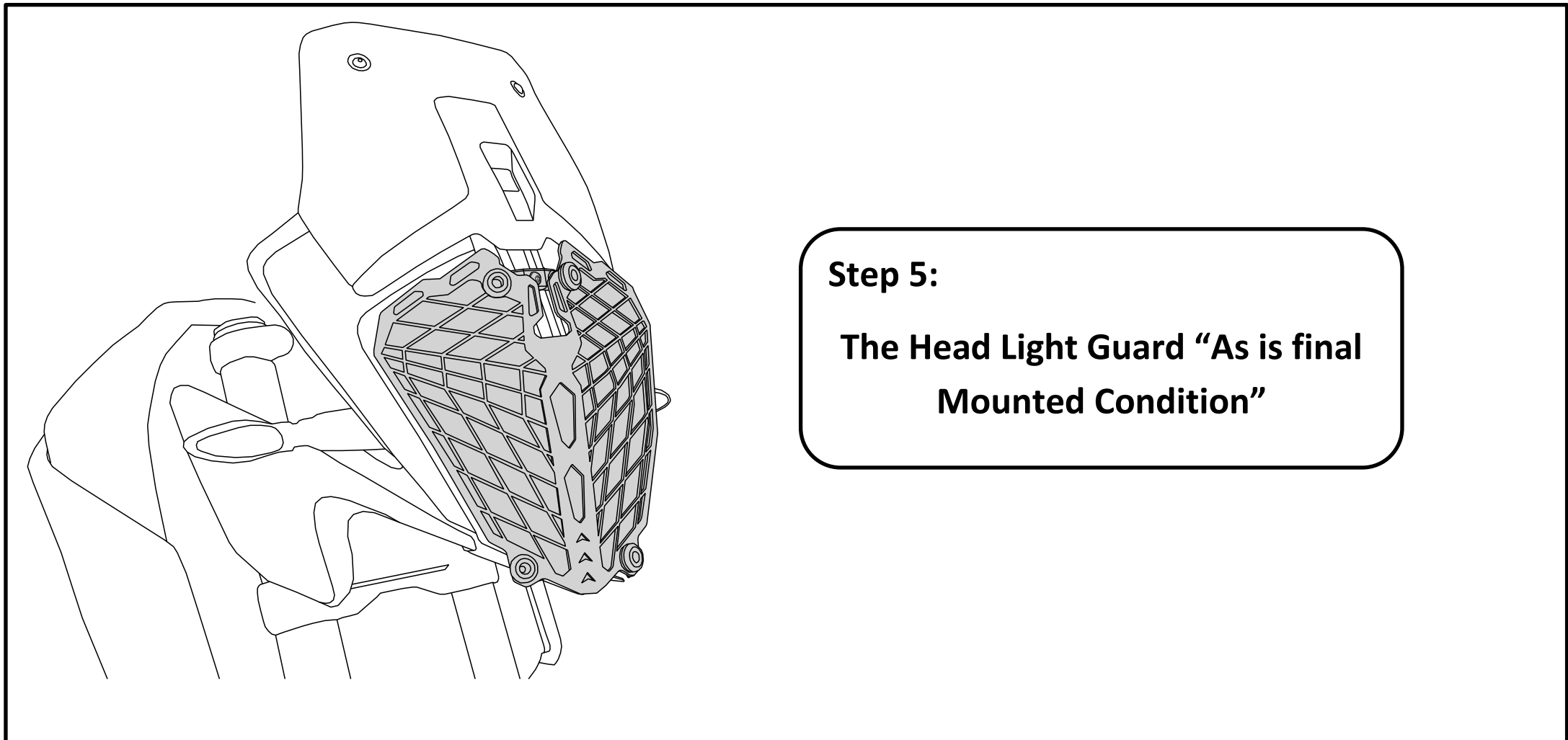
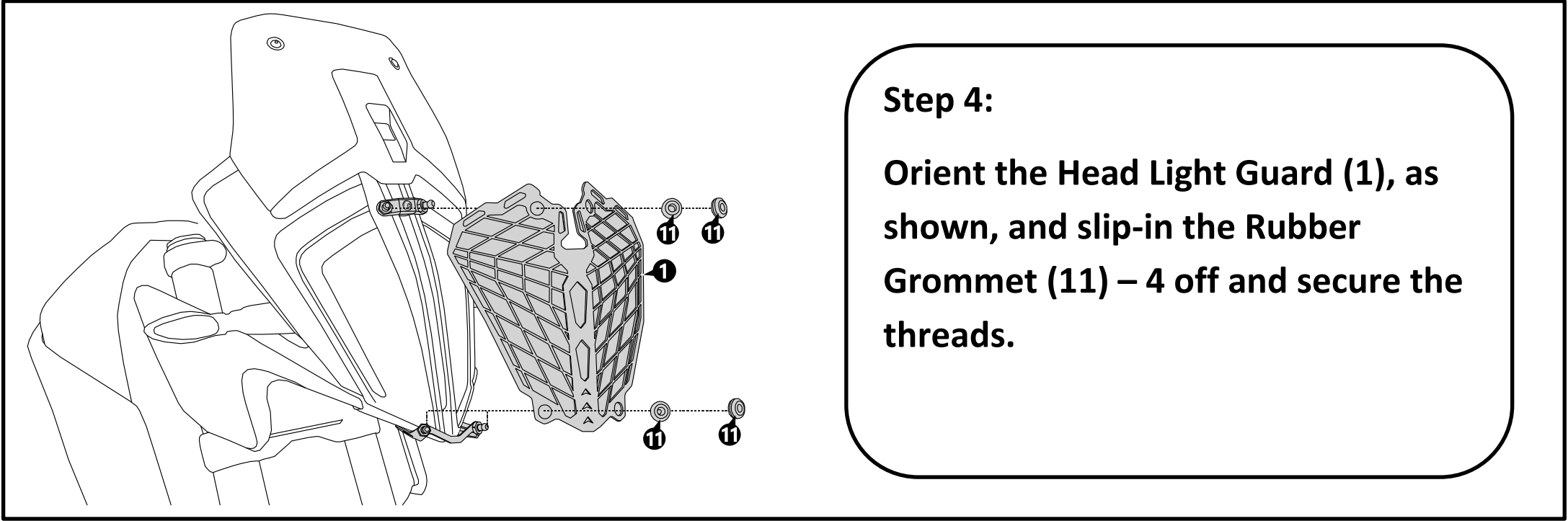



## General Instructions

1. We request you to pay attention to the Mounting Instructions in this document and follow the step-by-step procedures.
2. This Mounting Instruction manual is a “Do It Yourself” (DIY) fitment manual of the Accessory part to the Vehicle. We have prepared this based on our experience and knowledge, related to the Vehicle, Part and its functional aspects.
3. SRC cannot guarantee the interchangeability of the parts to any other manufacturer’s accessory part. It is advised to the User, to inspect and ensure the original state of all other Vehicle parts.
4. We request you to bear in mind, that the Installed part can change the driving behaviour and/or the stability during driving or any other dynamic conditions.
5. If you have the appropriate tools and another person to assist you in the mounting, it will help.
6. After Completion of the Mounting and before taking on a First ride, Ensure and Check all functions of the Vehicle. It is always advised to check loosening of the fasteners after the first 50 kilo meters of ride and at regular intervals.
7. To the maximum extent possible, our design use the current Mounting/Fitment of the Original Equipment, so that Installation of these accessories will not affect the Payload or Function of the Vehicle or the Part on which it is mounted to protect it
8. If any additional modifications are to be done, prior to the fitment of the accessories, it will be explicitly specified in the instruction sheets