

Part Description: CRASH BAR-ENGINE GUARD KLR650

**BOM LIST CRASH BAR**

NO.	Description	Quantity	Torque*(N-M)	Remarks**
1c	Crash bar LH	1		
2c	Crash bar RH	1		
3c	Pin pipe	1		
4c	RUBBER PLATE	2		
5c	Bracket LH	1		REMOVE
6c	Bracket RH	1		REMOVE
7c	Sliders Guards	2		
8c	Bush urethane M8	4		
9c	Socket button head screw M6x15	2		Use Liquid Thread Locker
10c	Socket head cap screw M8x40	2		Use Liquid Thread Locker
11c	Socket head cap screw M8x110	2		Use Liquid Thread Locker
12c	Hex flange nut M8	2		
13c	Washer M6	2		
14c	Washer M8	4		

**BOM LIST ENGINE GUARD**

NO.	Description	Quantity	Torque*(N-M)	Remarks**
1e	Skid plate	1		
2e	Bracket LH	1		
3e	Bracket RH	1		
4e	AL Bush OD18xID8xL12	2		
5e	Sponge tap L=180 mm	2		
6e	Countersunk Washer M6	2		
7e	Countersunk Washer M8	2		
8e	Socket head cap screw M8x80	2		REMOVE
9e	Socket head cap screw M10x80	1		Use Liquid Thread Locker
10e	Socket countersunk head screw M6x30	2		Use Liquid Thread Locker
11e	Socket countersunk head screw M8x20	2		Use Liquid Thread Locker
12e	Hex flange nut M8	2		REMOVE
13e	Hex flange nut M10	1		
14e	Washer M8	2		REMOVE
15e	Washer M10	1		

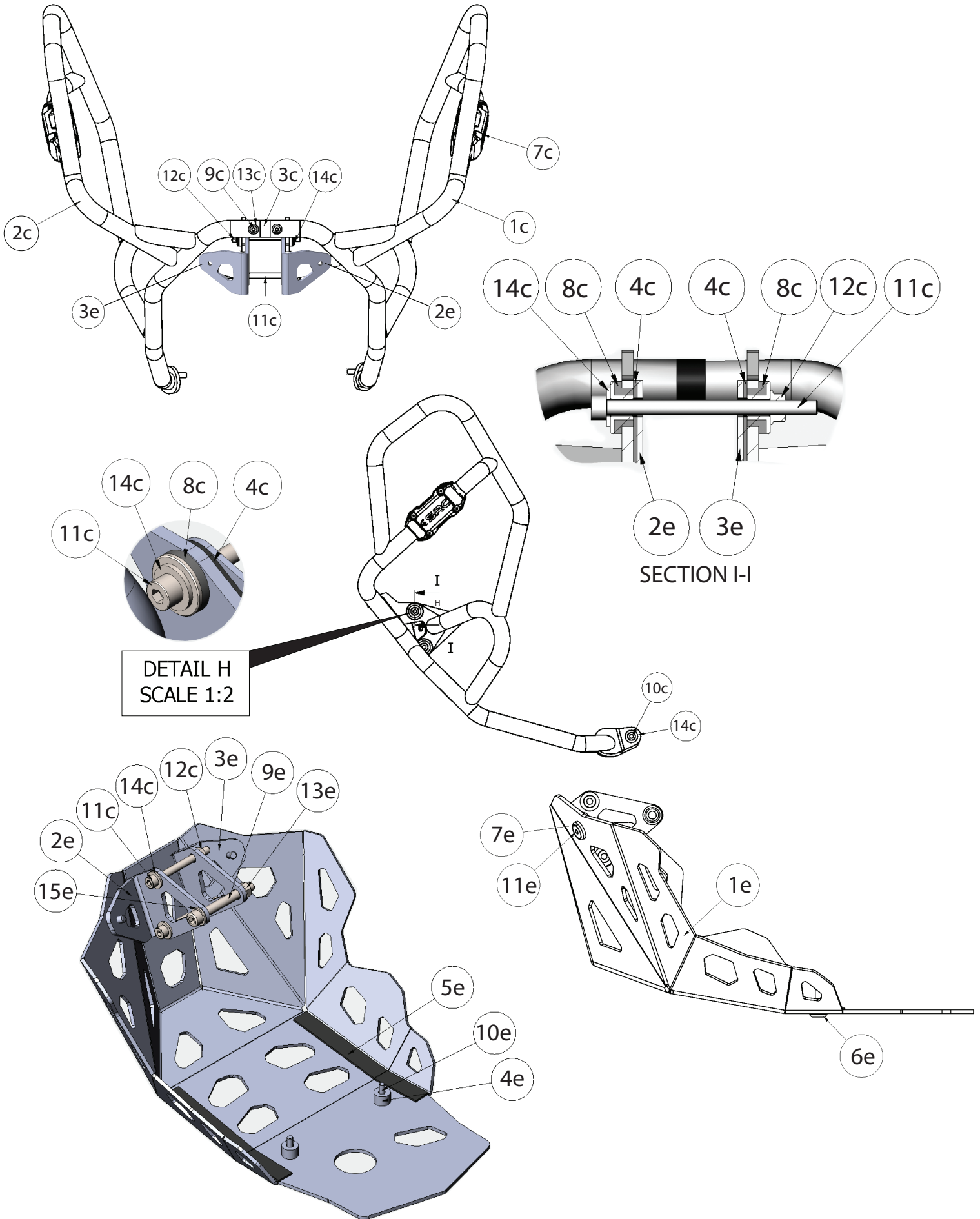

## Torque Values to be used in Mounting Instructions

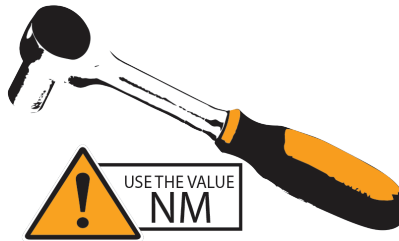

		M4		M5		M6		M8		M10		M12		M14		M16		M18	
	code	(cs)	(Fo)	(cs)	(Fo)	(cs)	(Fo)	(cs)	(Fo)	(cs)	(Fo)	(cs)	(Fo)	(cs)	(Fo)	(cs)	(Fo)	(cs)	(Fo)
<b>Inox</b>	<b>A2</b>	<b>2.6</b>	—	<b>5.1</b>	—	<b>8.7</b>	—	<b>21.2</b>	—	<b>42</b>	—	<b>73</b>	—	<b>118</b>	—	<b>180</b>	—	<b>258</b>	—
<b>steel</b>	<b>8.8</b>	<b>3</b>	3,594	<b>5</b>	5,886	<b>10</b>	8,302	<b>23</b>	15,242	<b>46</b>	24,275	<b>79</b>	35,401	<b>127</b>	48,618	<b>198</b>	66,955	<b>283</b>	83,746
<b>steel</b>	<b>10.9</b>	<b>4</b>	5,279	<b>8.1</b>	8,645	<b>14</b>	12,194	<b>34</b>	22,388	<b>67</b>	35,655	<b>116</b>	51,995	<b>187</b>	71,408	<b>291</b>	98,340	<b>402</b>	119,454

**Tensile load (Fo)**  
**The force in newtons (N)** which maintains pressure contact between assembled components  
**Tightening torque (Cs)** [values are in N-m]

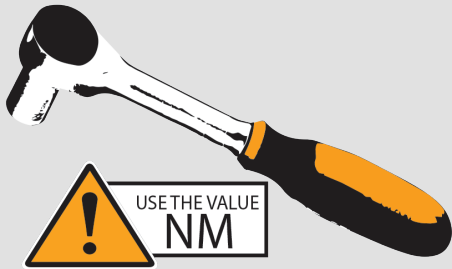

! symbol (NM), refer to the reference value given in the table above for use in the required operation And safe in operation and accuracy in inserting parts.

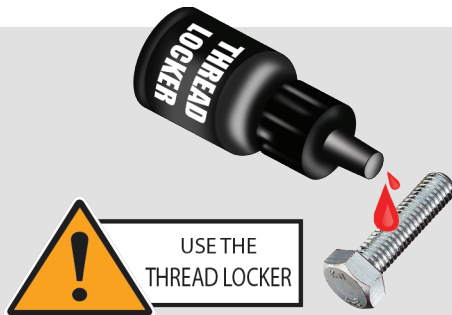

! The tool in the picture is (thread locked). When you see this mark, please insert the medicine to the point where the nut is to be inserted for the firmness and accuracy of the insertion work.

! Please check and check again to make sure that all are inserted. Every piece and don't forget any step to be safe.

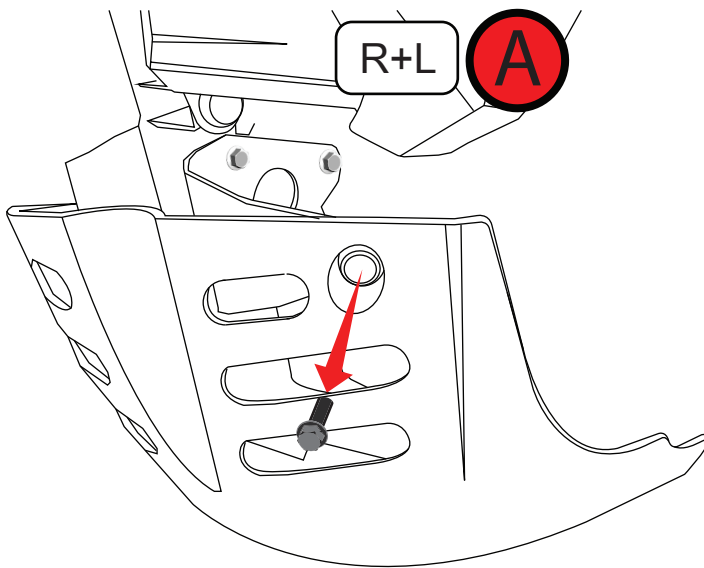
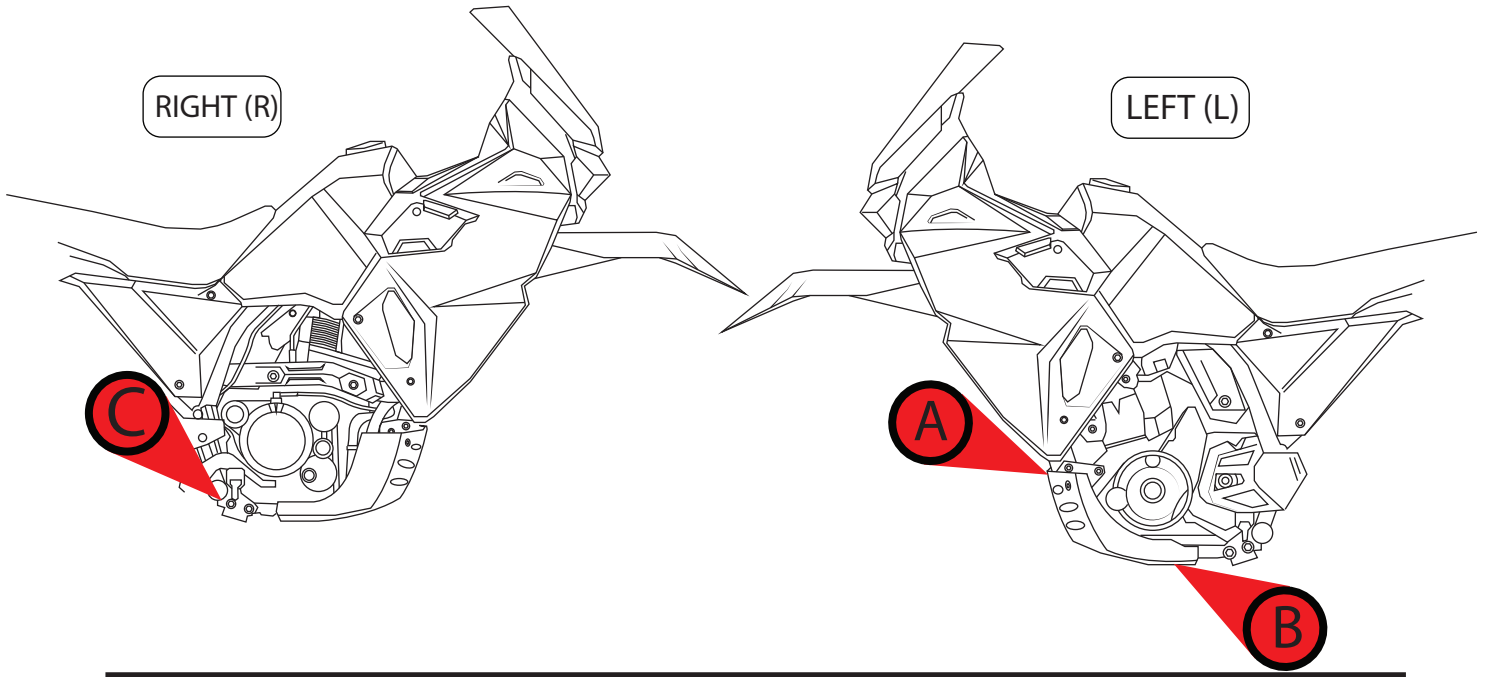

1

Remove the original Bolt, both left - right.

2

Remove the original Bolt below . both left and right and remove the original engine guard

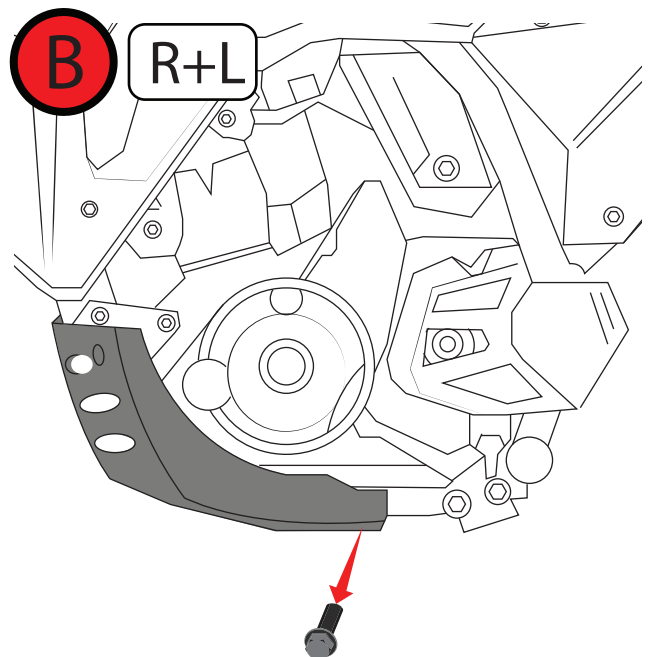

3

Right side  
remove the original nut  
(all 3 points) and braket  
as illustrated

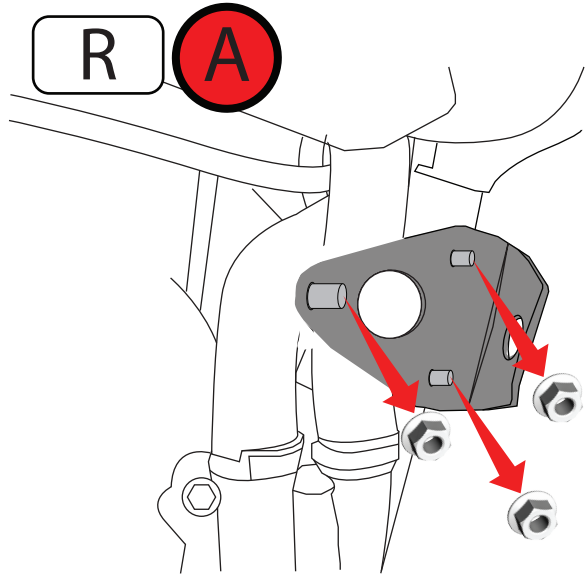

L

A

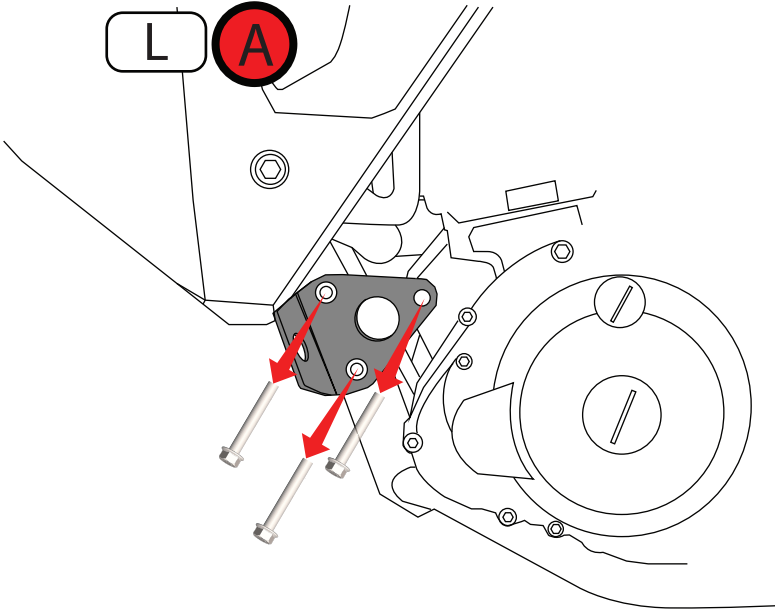

4

Left side  
remove the original Bolt  
( all 3 points ) and bracket  
as illustrated

5

Remove the first original  
bolt below the left-right  
footboard as illustrated.

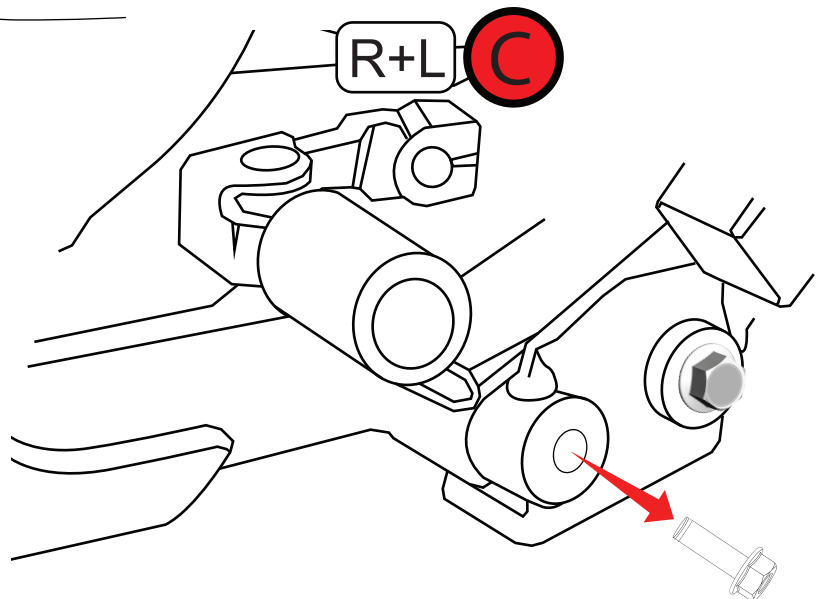

6

Put the bracket on both the left and right side as shown in the illustration.

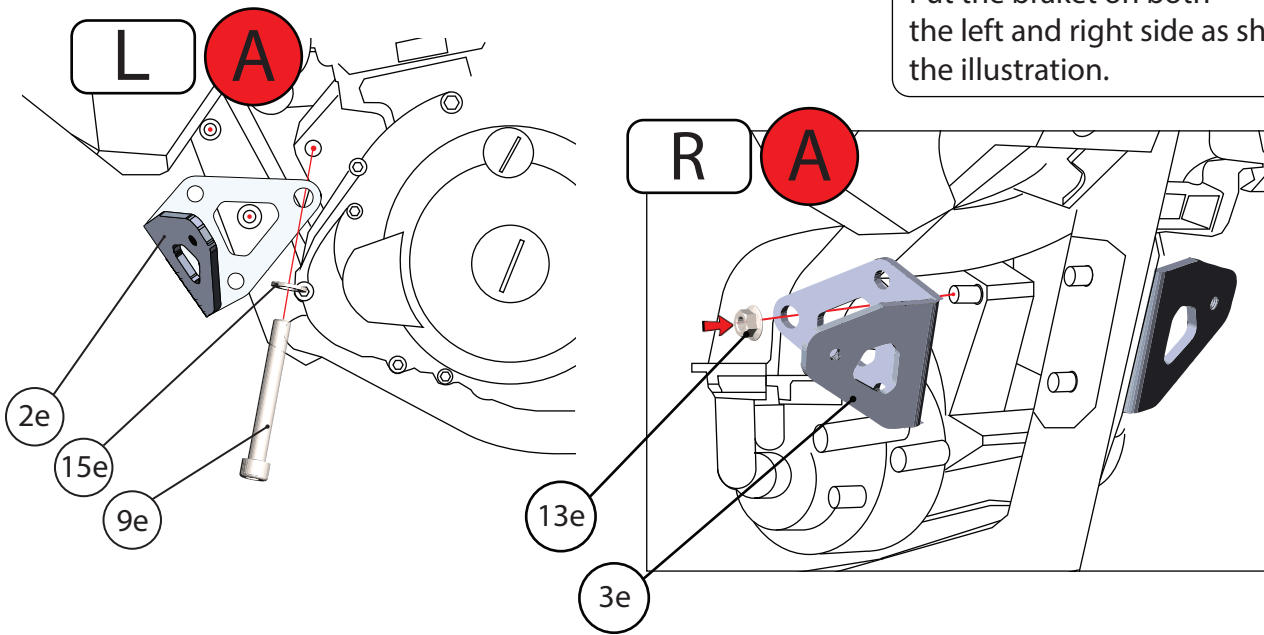

7

Put Bush next to the cache bar left and right sides.  
Put the Pin pipe next to the crash bar and bolt as illustrated.

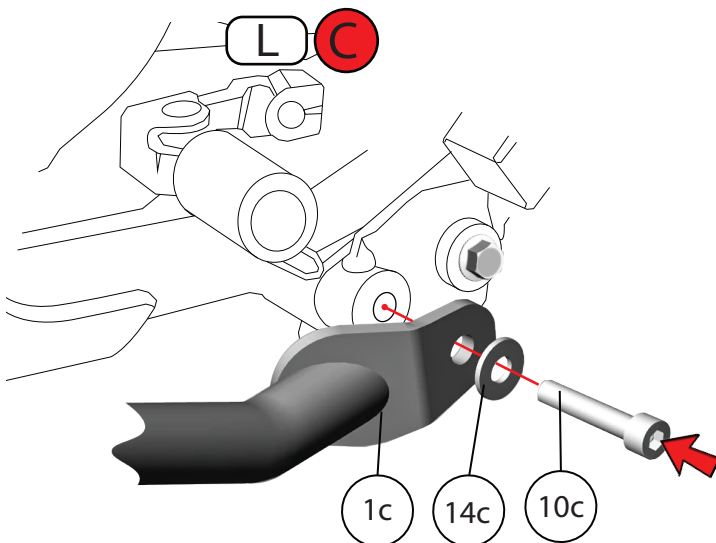
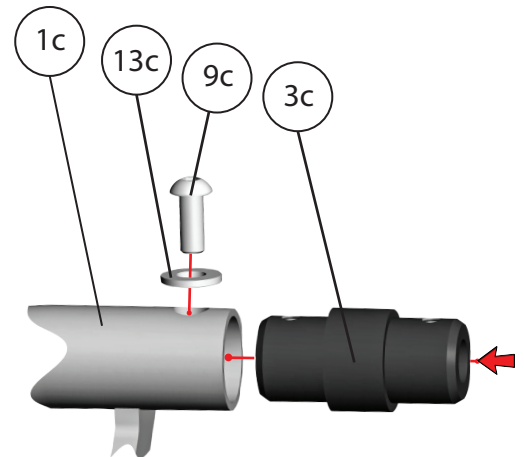
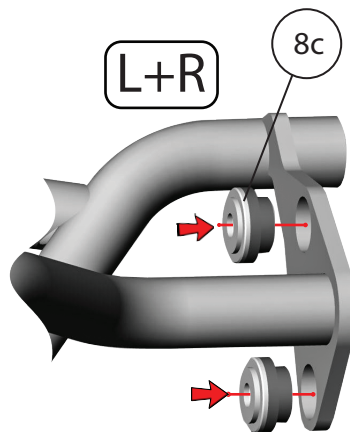

8

Install Crash bar Lh.

Install washer and M8x40 Bolt as illustrated.  
(Lock the bolt loose first)

9

Install RUBBER PLATE, CRASH BAR, Washer, Bolt as illustrated

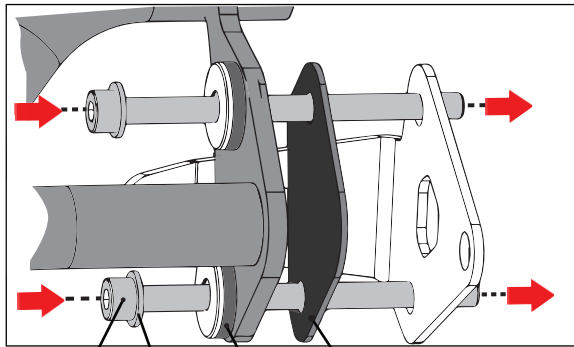

11c  
14c  
8c  
4c

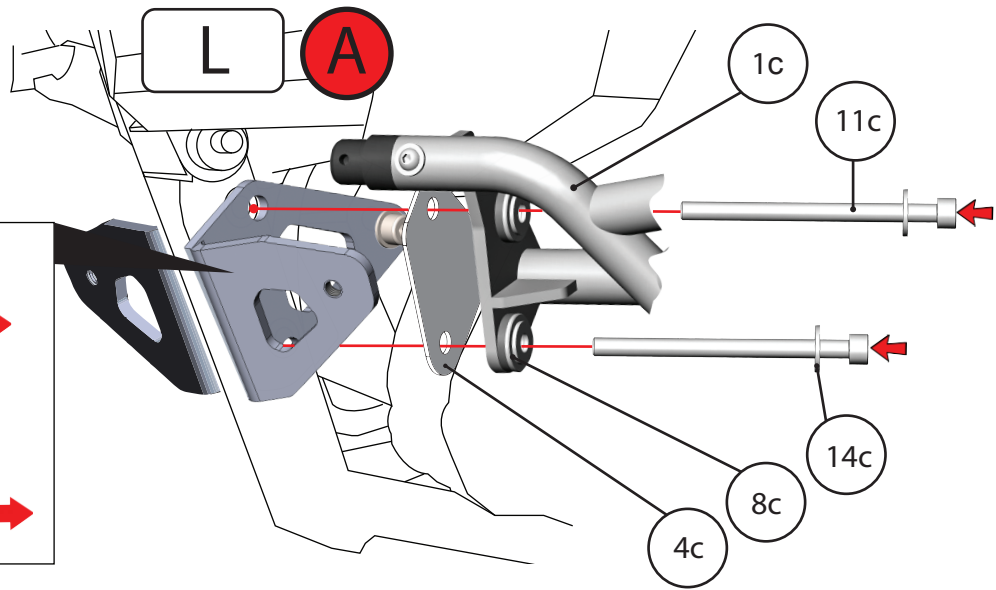

10

Install Crash bar RH  
Install washer and M8x40 bolt as illustrated.  
(Lock the bolt loose first)

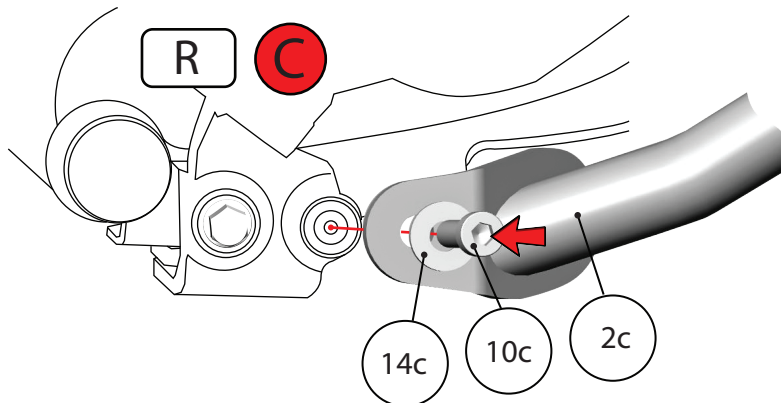

11

Install RUBBER PLATE, CRASH BAR, Nut as illustrated

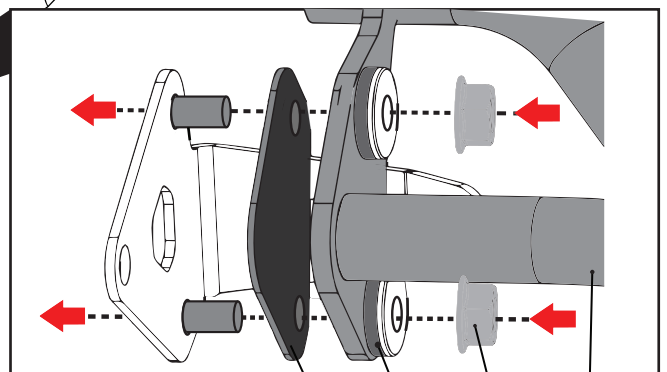
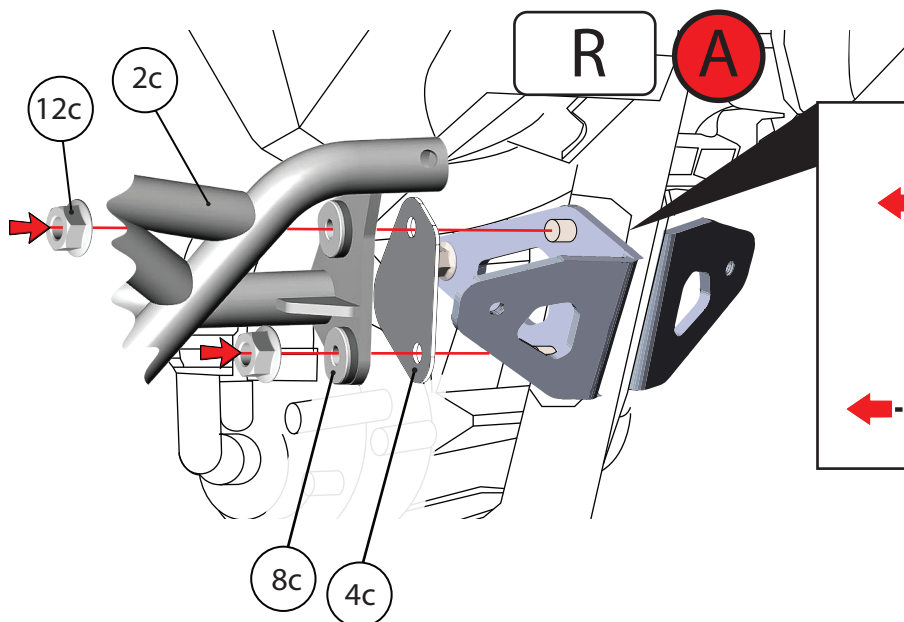

12

Install washer and M6x15 screw as illustrated.

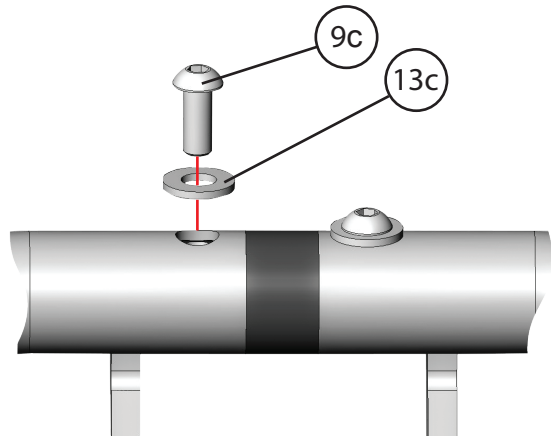

13

install Sponge tap inside Engine Guard as illustrated

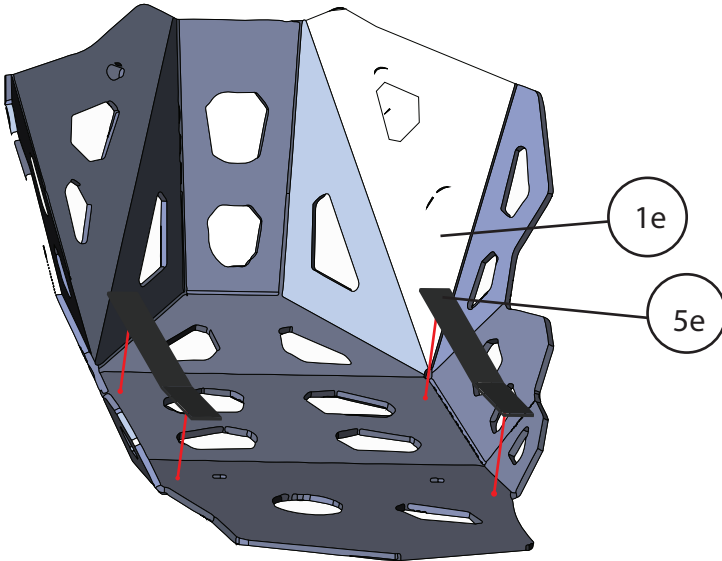

14

install (left-right)  
screw M10x80, Countersunk Washer  
as illustrated.

install (hind)  
screw M10x80, Countersunk Washer  
,Bush urethane M8

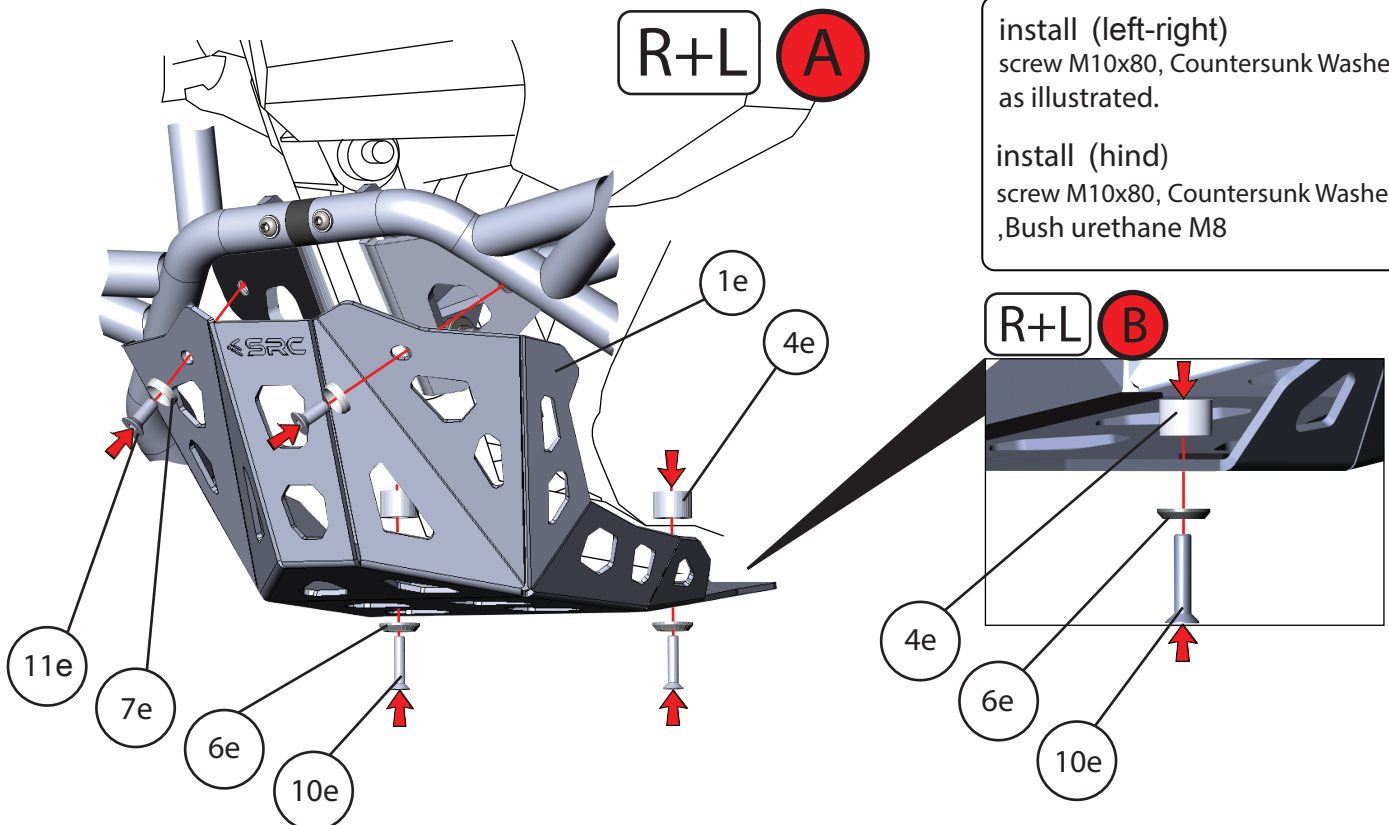



15

Install Sliders Guards  
on both the left-right sides  
as illustrated.

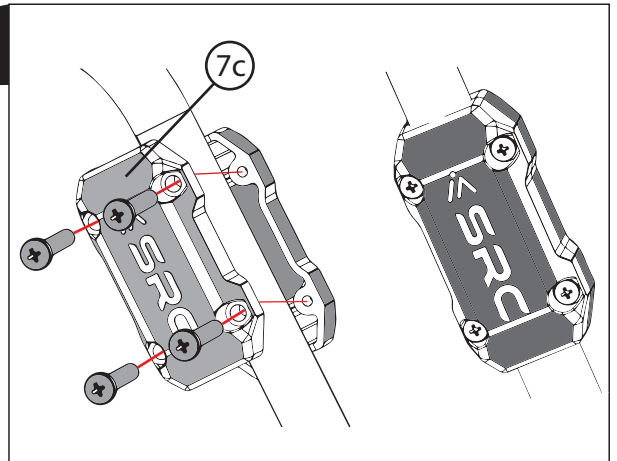
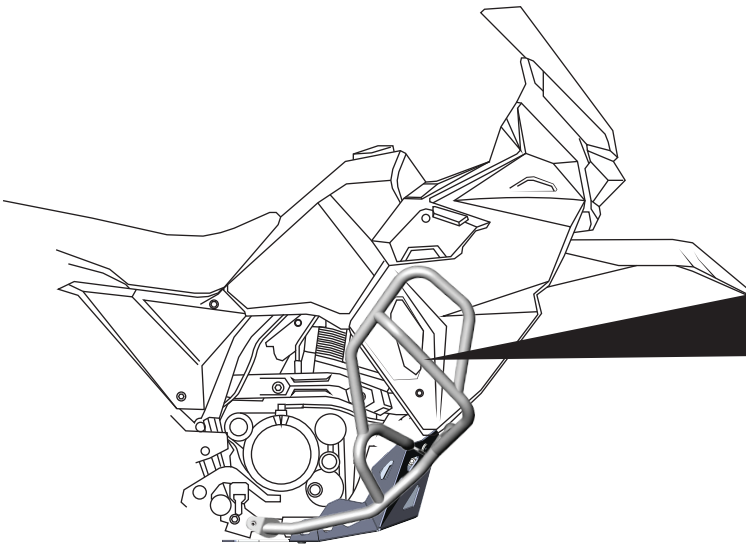

Please check the tightness of the bolts at all mounting points.

- (1.) We request you to pay attention to the Mounting Instructions in this document and follow the step-by-step procedures.
- (2.) This Mounting Instruction manual is a “Do It Yourself” (DIY) fitment manual of the Accessory part to the Vehicle. We have prepared this based on our experience and knowledge, related to the Vehicle, Part and its functional aspects
- (3.) SRC cannot guarantee the interchangeability of the parts to any other manufacturer’s accessory part. It is advised to the User, to inspect and ensure the original state of all other Vehicle parts.
- (4.) We request you to bear in mind, that the Installed part can change the driving behaviour and/or the stability during driving or any other dynamic conditions.
- (5.) If you have the appropriate tools and another person to assist you in the mounting, it will help.
- (6.) After Completion of the Mounting and before taking on a First ride, Ensure and Check all functions of the Vehicle. It is always advised to check loosening of the fasteners after the first 50 kilo meters of ride and at regular intervals.
- (7.) To the maximum extent possible, our design use the current Mounting/Fitment of the Original Equipment, so that Installation of these accessories will not affect the Payload or Function of the Vehicle or the Part on which it is mounted to protect it.
- (8.) If any additional modifications are to be done, prior to the fitment of the accessories, it will be explicitly specified in the instruction sheets

