

**Scope of Supply/Bill of Material & Mounting Drawings**

Part Number: H-CRF300L-05-01-AL / H-CRF300L-05-02-AL

Part Description: EXHAUST HEAT GUARD – HONDA CRF 300L

NO.	Description	Quantity	Torque * (N-M)	Remarks **	Check List
1	Guard Exhaust	1			
2	Bracket	2			
3	Washer M6	2			
4	Screw M6 X 10	2	9 - 10	Use Liquid Thread Locker	
5	Hose Clip	2			
SRC Design uses Metric System of Measurement and all dimensions in Millimeters					
* Recommended to use the Torque specified in the table					
** Denotes Usage of Liquid Thread Locker in specified Locations					

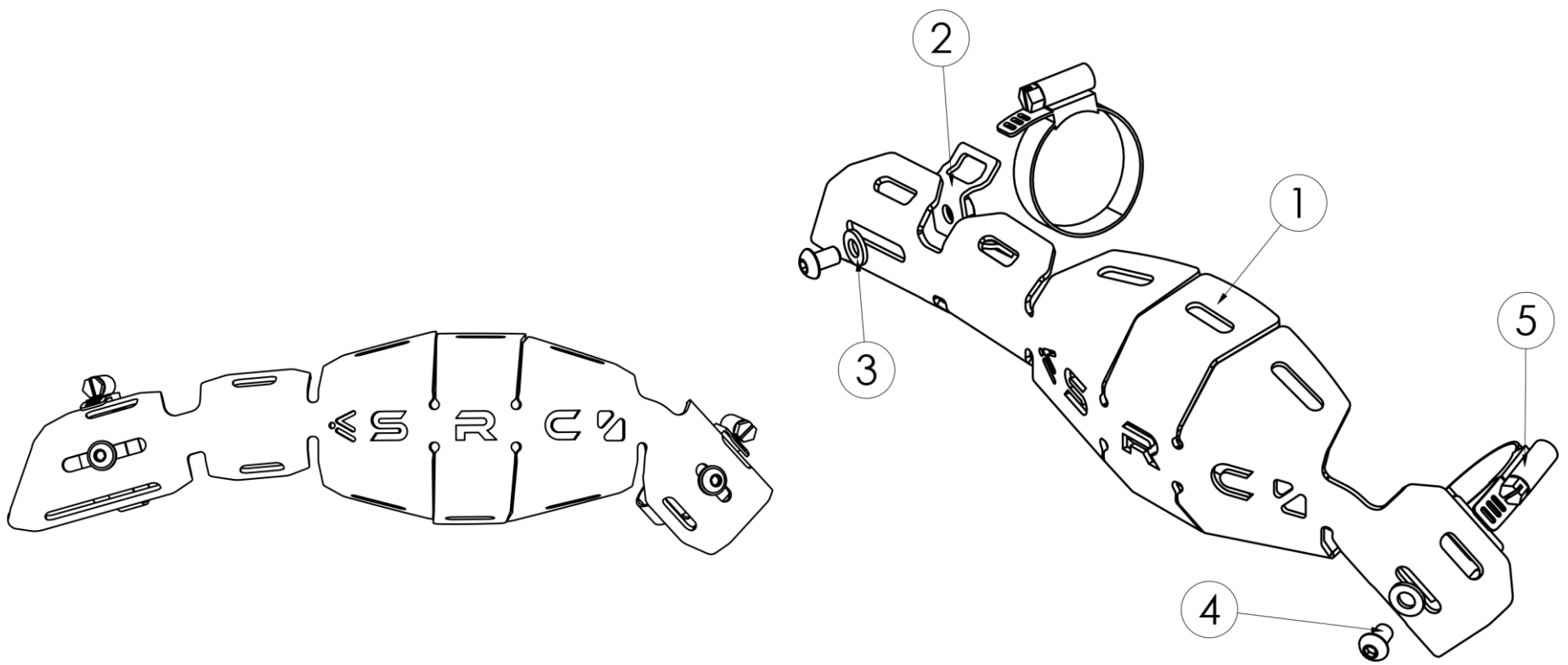

**EXHAUST HEAT GUARD** for protects the header downpipe against any stone/pellet/debris hits (as shown in the drawing)

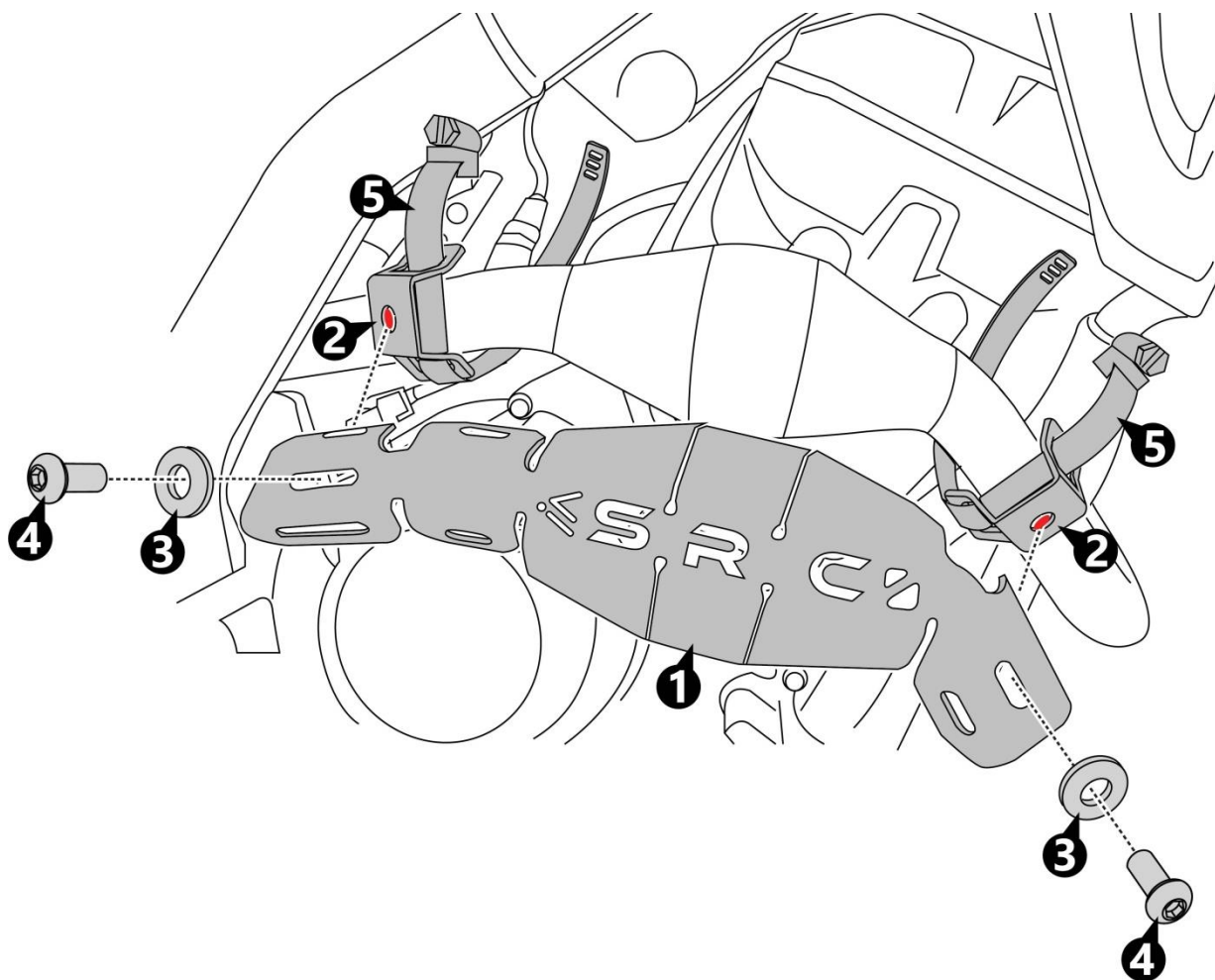
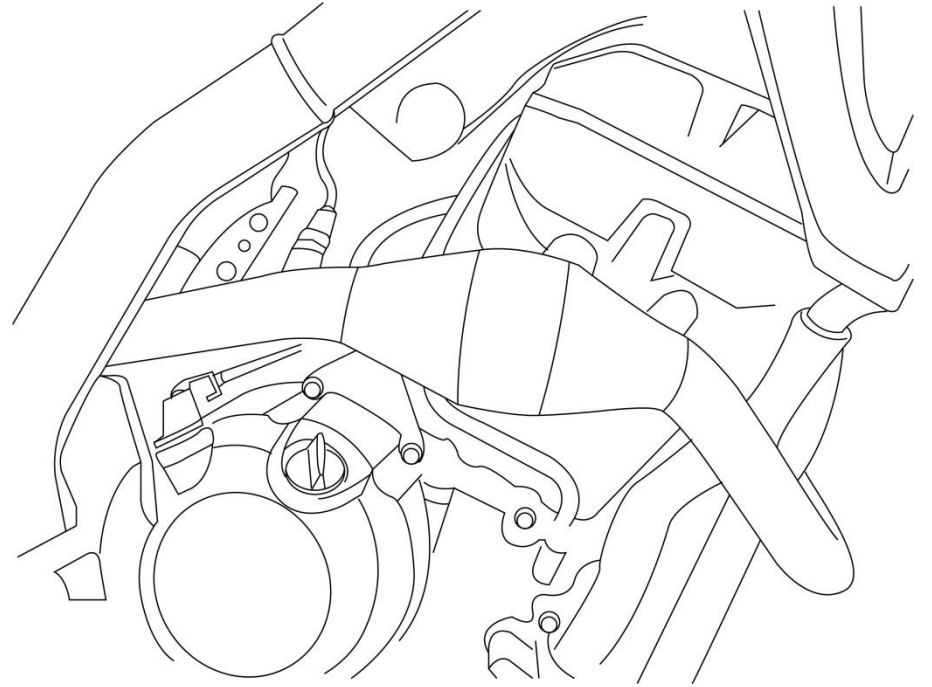

**Step 1:**

**Orient and slip-in the Bracket (2)-2 off, Roll the Hose Clip (5) between the bracket and EXHAUST.**

**Orient and Slip-in the EXHAUST HEAT GUARD and the washer M6 (3)-2 off, screw M6x10 (4)-2 off, and secure the threads.**

**The Head Light Guard “As is final Mounted Condition”**

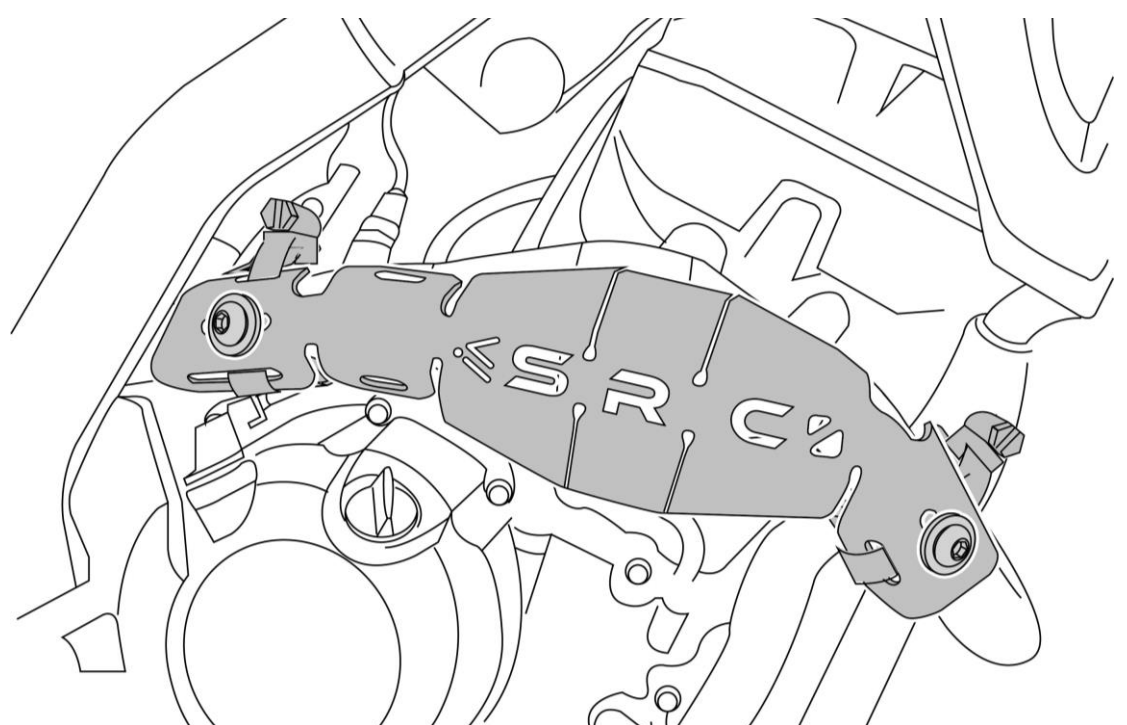



## General Information

1. We request you to pay attention to the Mounting Instructions in this document and follow the step-by-step procedures.
2. This Mounting Instruction manual is a “Do It Yourself” (DIY) fitment manual of the Accessory part to the Vehicle. We have prepared this based on our experience and knowledge, related to the Vehicle, Part and its functional aspects.
3. SRC cannot guarantee the interchangeability of the parts to any other manufacturer’s accessory part. It is advised to the User, to inspect and ensure the original state of all other Vehicle parts.
4. We request you to bear in mind, that the Installed part can change the driving behaviour and/or the stability during driving or any other dynamic conditions.
5. If you have the appropriate tools and another person to assist you in the mounting, it will help.
6. To the maximum extent possible, our design use the current Mounting/Fitment of the Original Equipment, so that Installation of these accessories will not affect the Payload or Function of the Vehicle or the Part on which it is mounted to protect it
7. If any additional modifications are to be done, prior to the fitment of the accessories, it will be explicitly specified in the instruction sheets.