

Scope of Supply/Bill of Material & Mounting Drawings

Part Number: H-CRF300L-01-01-SL / H-CRF300L-01-02

Part Description: Head Light Guard –HONDA CRF300 L

Applicable to Finished colour versions of Black and Silver

Installation / Parts List / Bill of Material for Mounting

NO.	Description	Quantity	Torque * (N-M)	Remarks **
1	Head Light Guard	1		
2	Bracket	1		
3	Bush Spacer Delrin 20x5	2		
4	Bush Spacer Delrin 10x6	1		
5	Taper Ring M6	2		
6	Socket Conutersunk Head Screw M6x30	2	9 - 10	Use Liquid Thread Locker
7	Socket Nutton Head Screw M5x6	2	5 - 6	Use Liquid Thread Locker
8	Socket Nutton Head Screw M5x70	1	5 - 6	Use Liquid Thread Locker
9	Washer M5	3		

SRC Design uses Metric System of Measurement and all dimensions in Millimeters

* Recommended to use the Torque specified in the table

** Denotes Usage of Liquid Thread Locker in specified Locations

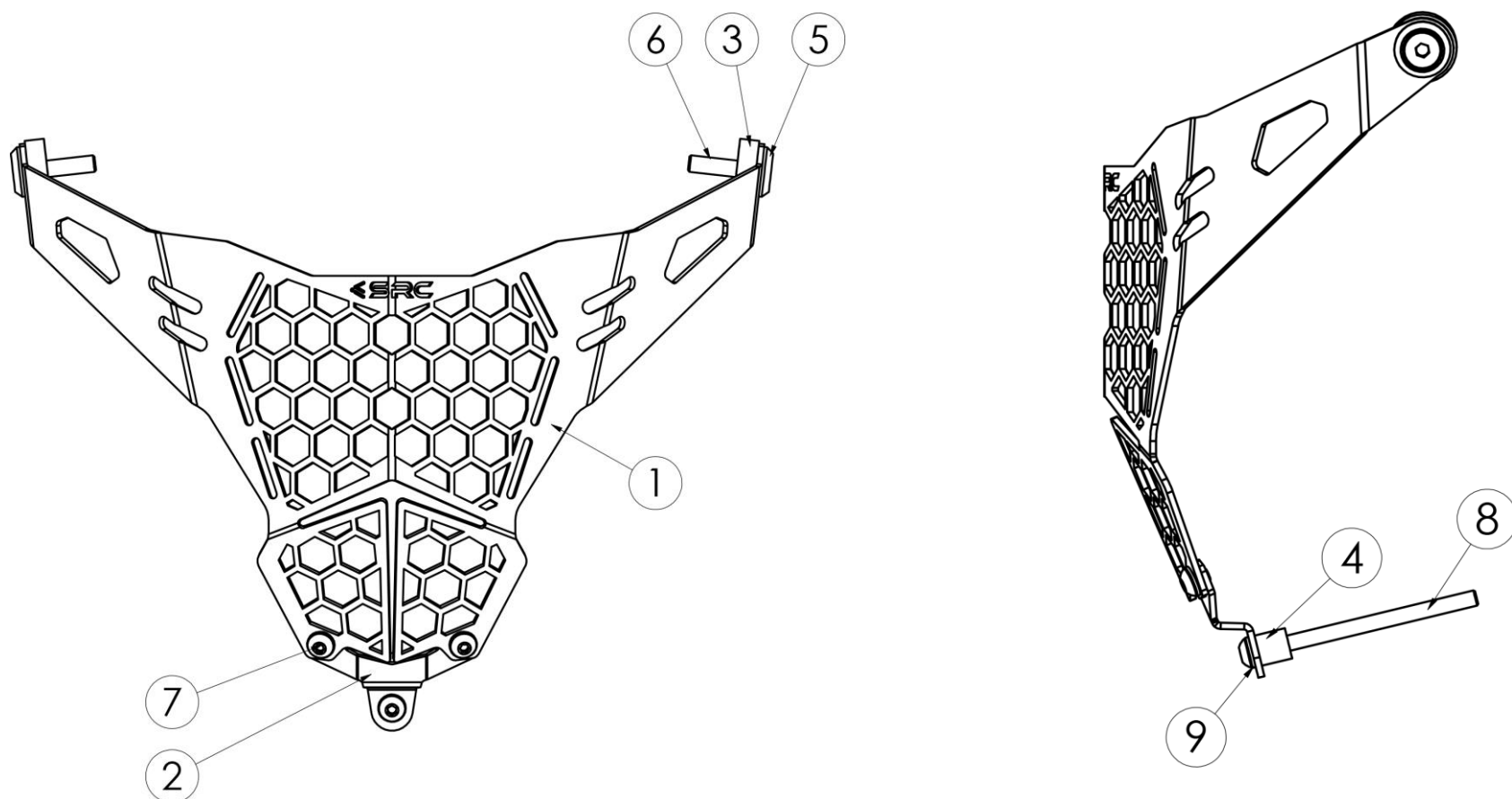

Mounting Instructions

Step 1:

Unscrew the Mounting Bolt, (original Screw in the Motorbike) from the Right Side, Left Side and Front Side.

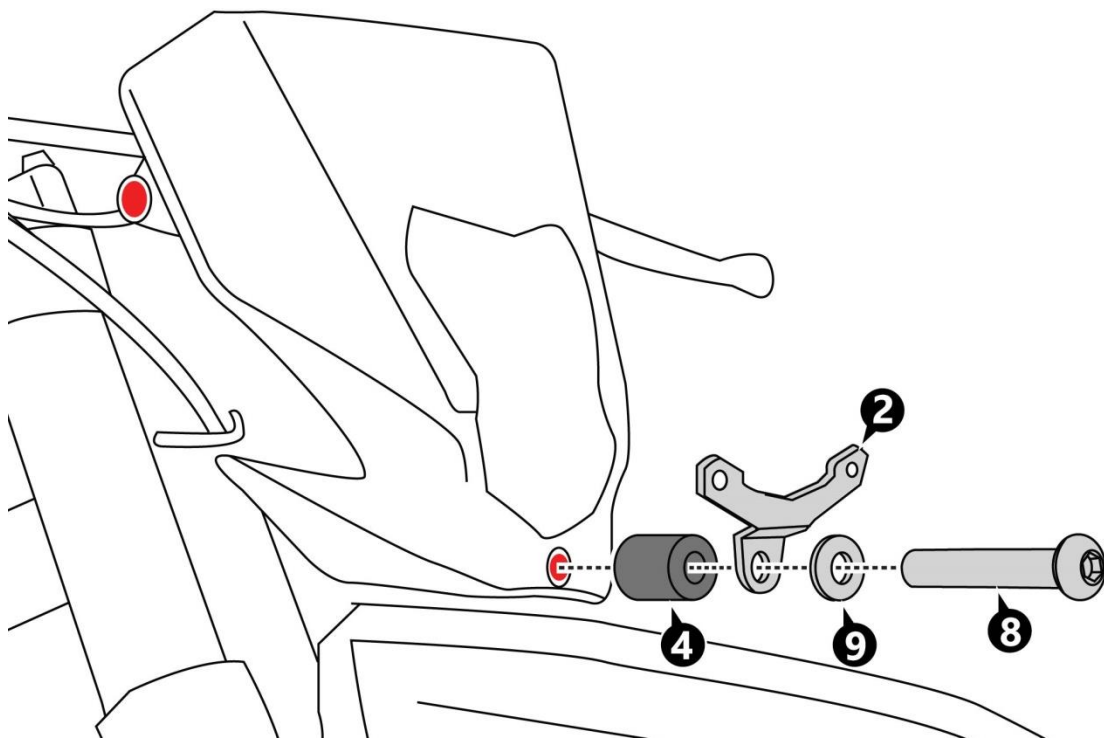
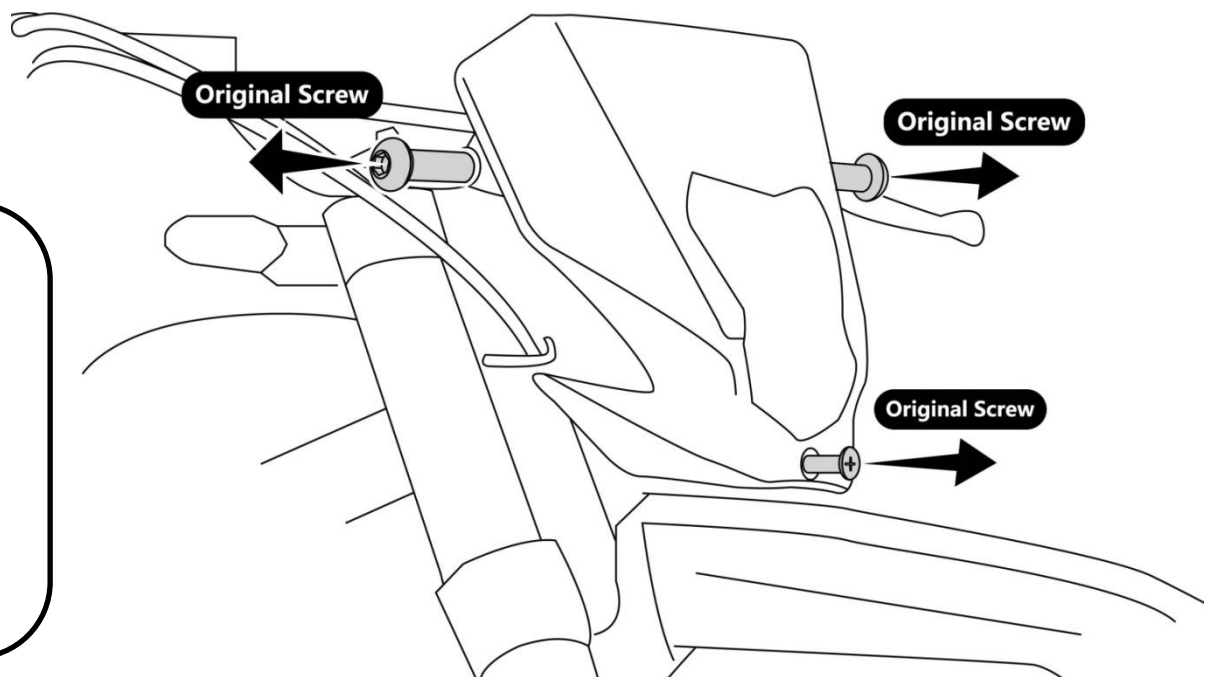

Step 2:

Orient the Bracket (2), as shown, and slip-in the Bush Spacer (4) Washer (9) – 1 off and Screw M5x70 (8) – 1 off, and secure the threads, as shown.

Step 3:

Orient the Head Light Guard (1), as shown, to the Bracket (2) and slip-in the M5 Washer (9) – 2 off, and Screw M5x6 (7) – 2 off, and secure the threads.

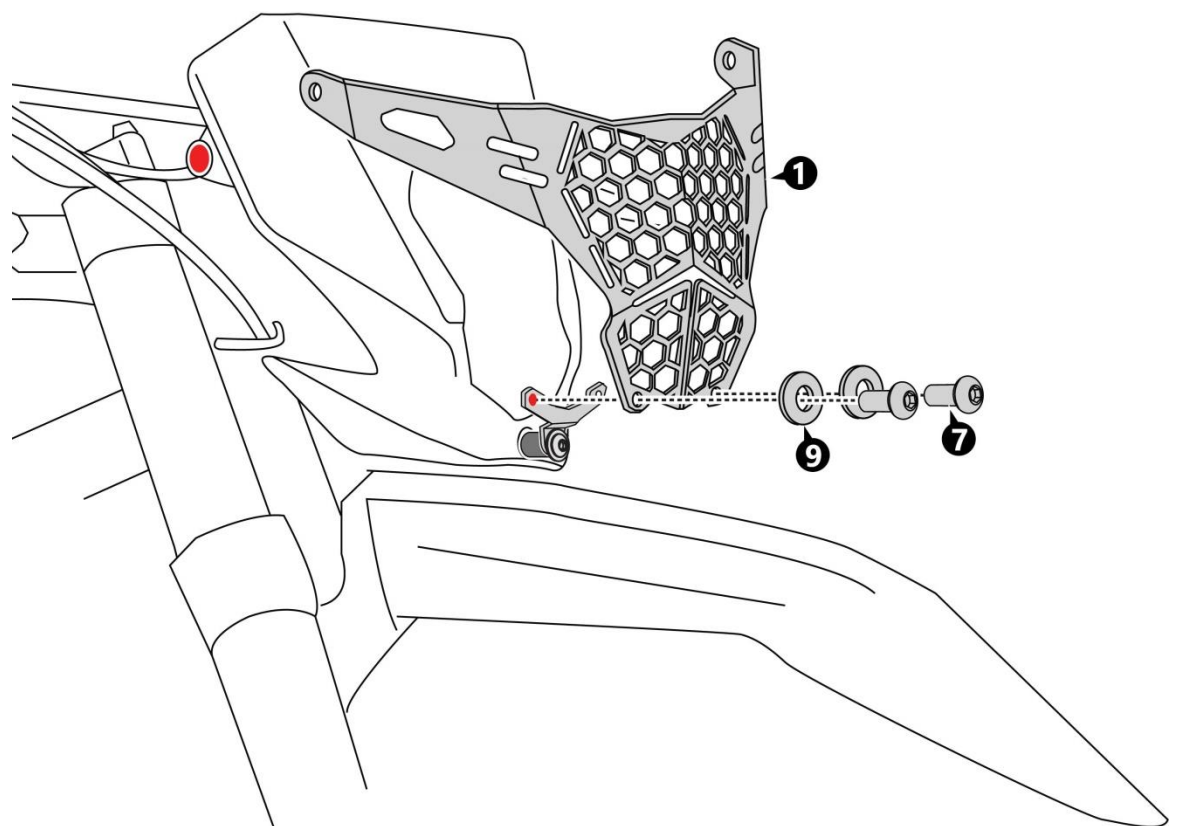

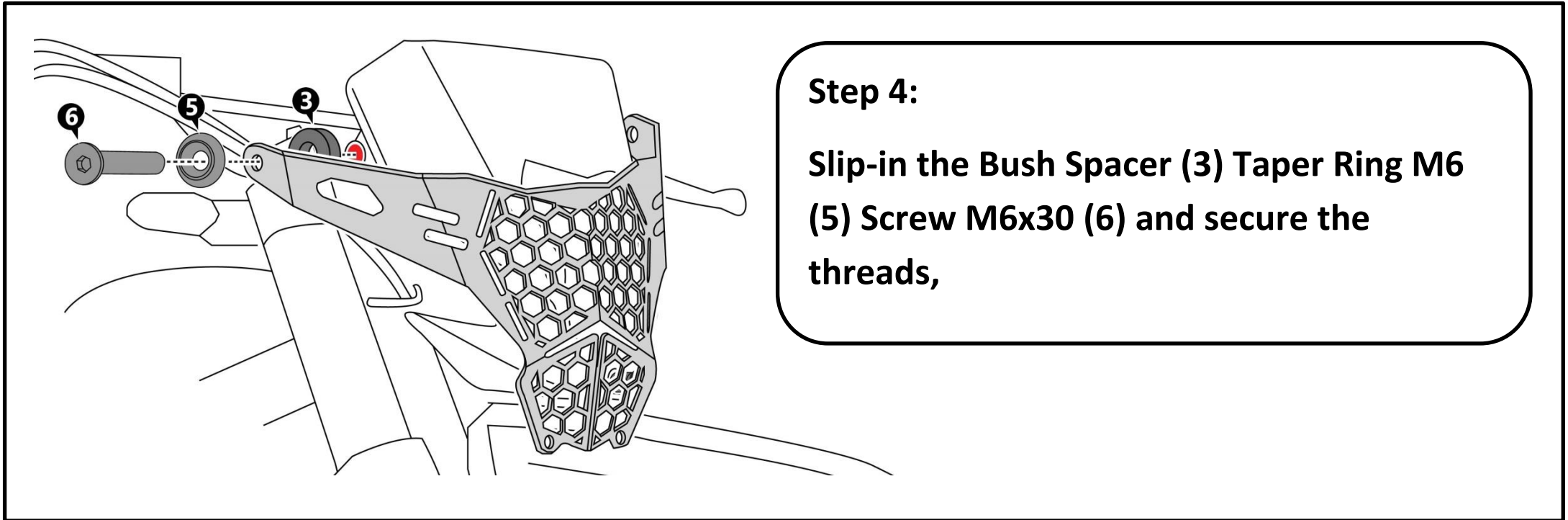

Step 4:

Slip-in the Bush Spacer (3) Taper Ring M6 (5) Screw M6x30 (6) and secure the threads,

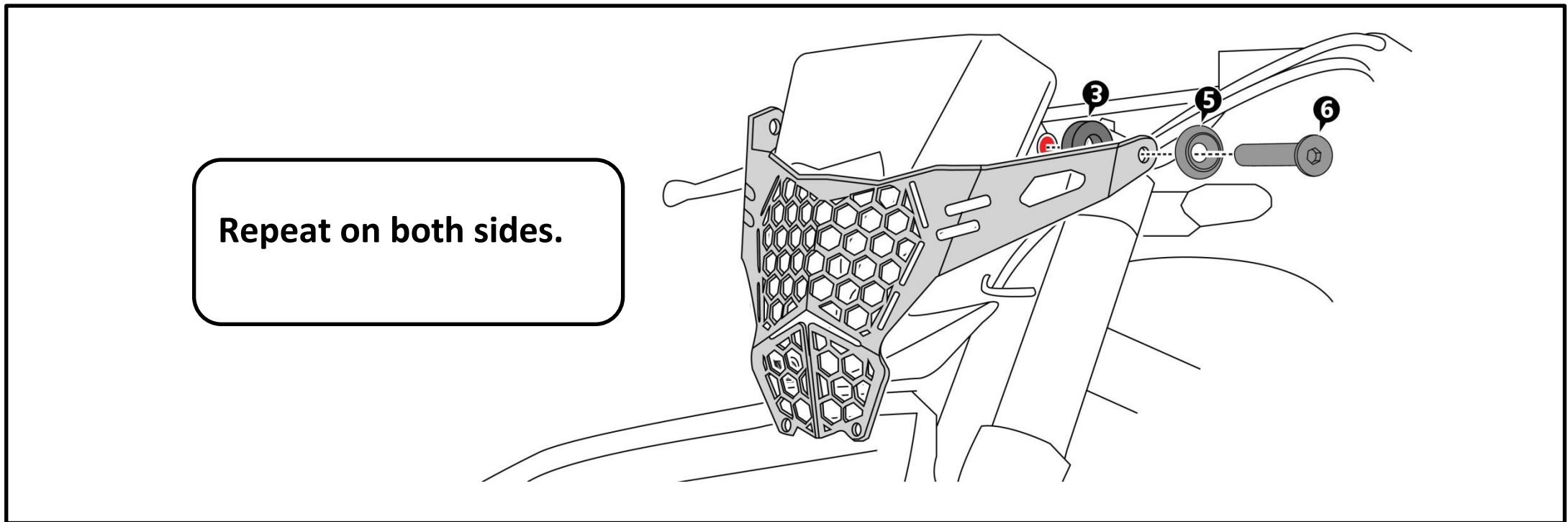

Repeat on both sides.

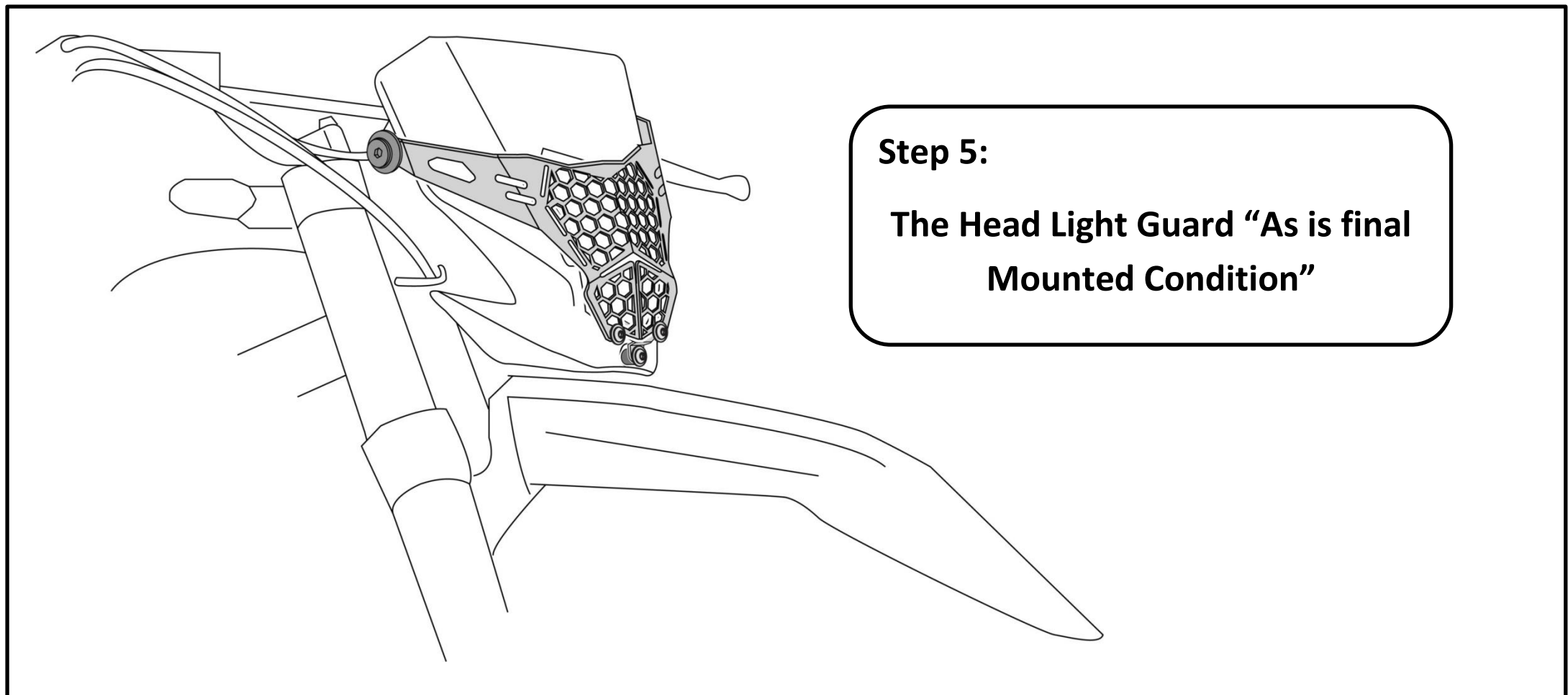

Step 5:

The Head Light Guard “As is final Mounted Condition”



General Instructions

1. We request you to pay attention to the Mounting Instructions in this document and follow the step-by-step procedures.
2. This Mounting Instruction manual is a “Do It Yourself” (DIY) fitment manual of the Accessory part to the Vehicle. We have prepared this based on our experience and knowledge, related to the Vehicle, Part and its functional aspects.
3. SRC cannot guarantee the interchangeability of the parts to any other manufacturer’s accessory part. It is advised to the User, to inspect and ensure the original state of all other Vehicle parts.
4. We request you to bear in mind, that the Installed part can change the driving behaviour and/or the stability during driving or any other dynamic conditions.
5. If you have the appropriate tools and another person to assist you in the mounting, it will help.
6. After Completion of the Mounting and before taking on a First ride, Ensure and Check all functions of the Vehicle. It is always advised to check loosening of the fasteners after the first 50 kilo meters of ride and at regular intervals.
7. To the maximum extent possible, our design use the current Mounting/Fitment of the Original Equipment, so that Installation of these accessories will not affect the Payload or Function of the Vehicle or the Part on which it is mounted to protect it
8. If any additional modifications are to be done, prior to the fitment of the accessories, it will be explicitly specified in the instruction sheets