

Scope of Supply/Bill of Material & Mounting Drawings

Part Number: H-CRF17-14-02-SL (Supplement)

Part Description: Large Side Stand – HONDA CRF250 RALLY

Installation / Parts List / Bill of Material for Mounting

NO.	Description	Quantity	Torque * (N-M)	Remarks **	Check List
1	Bottom Plate	1			
2	Top Plate	1			
3	Buffer Plate	1			
4	Spacer 15 x 15	4			
5	Countersink Screw M 6 X 35	4	9 - 10	Use Liquid Thread Locker	
6	Middle Plate	1			
7	Nut M6	4			

SRC Design uses Metric System of Measurement and all dimensions in Millimeters

* Recommended to use the Torque specified in the table

** Denotes Usage of Liquid Thread Locker in specified Locations

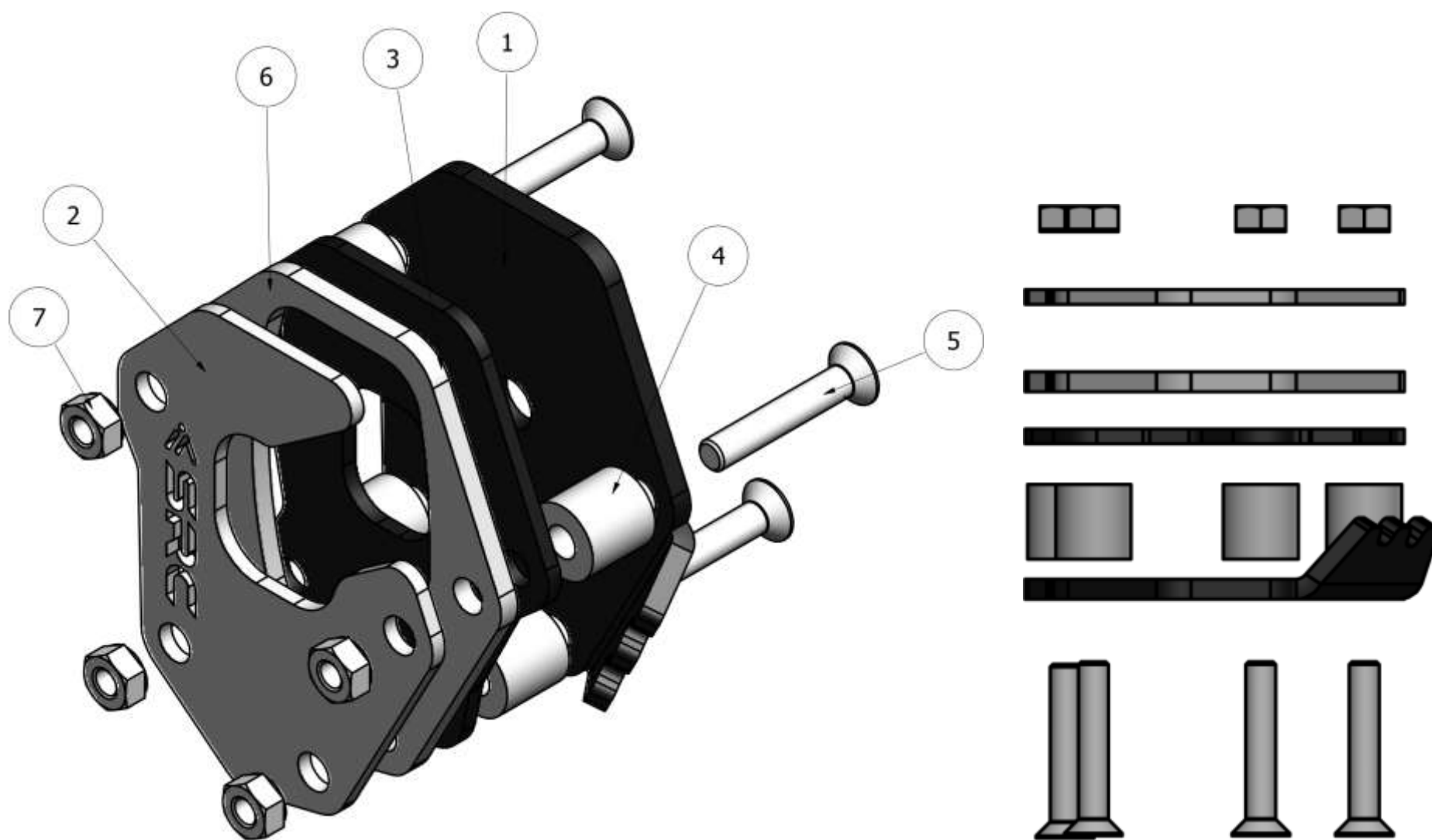

MOUNTING DRAWINGS

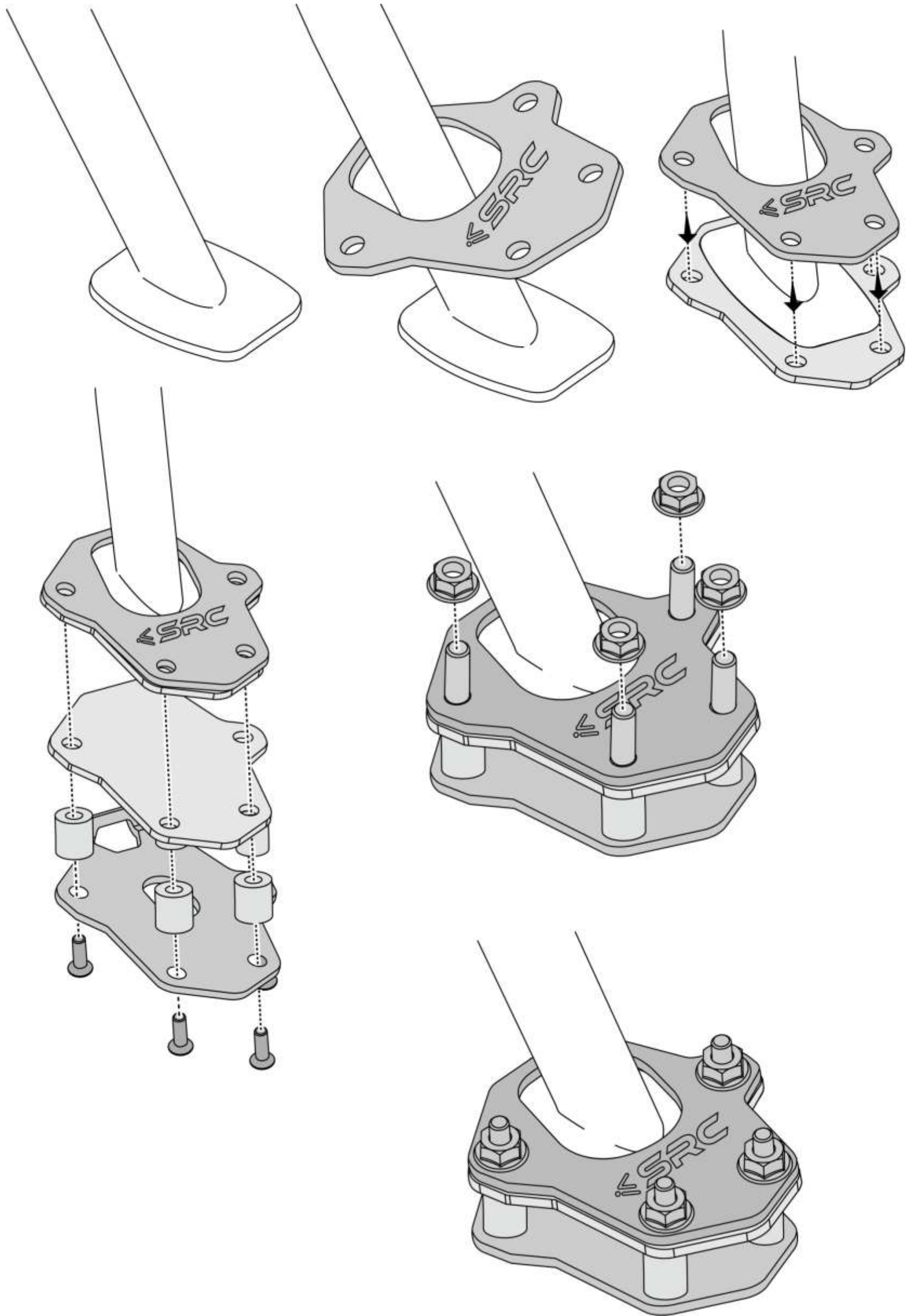

Mounting Instructions

Step 1:

During Mounting the Large Side Stand, let the Motorbike firmly rest on the floor, using the Centre Stand.

The side stand can be brought forward (position as shown in the drawing) to have access to the Mounting/ Assembly of the SRC Large Side Stand.

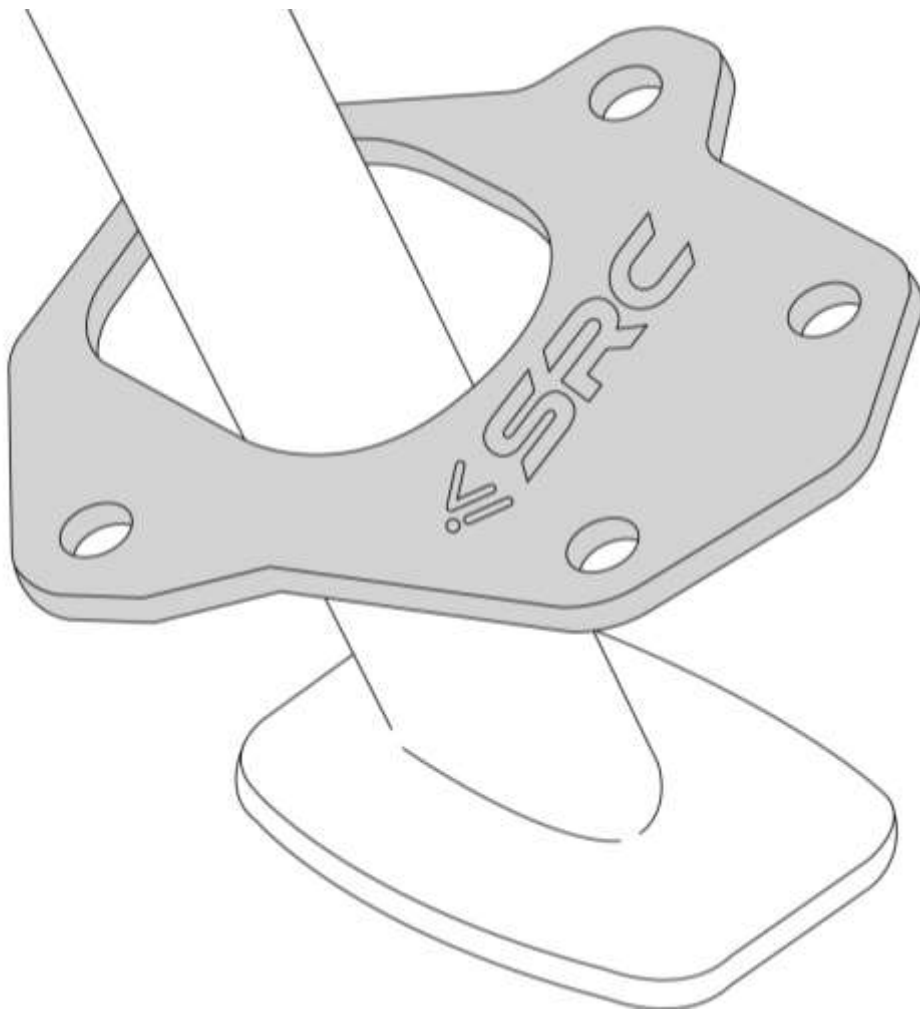

Step 2:

Orient and slip-in the Upper Plate (2), through the Open cut-out and pass the shank of the Side-stand, as shown.

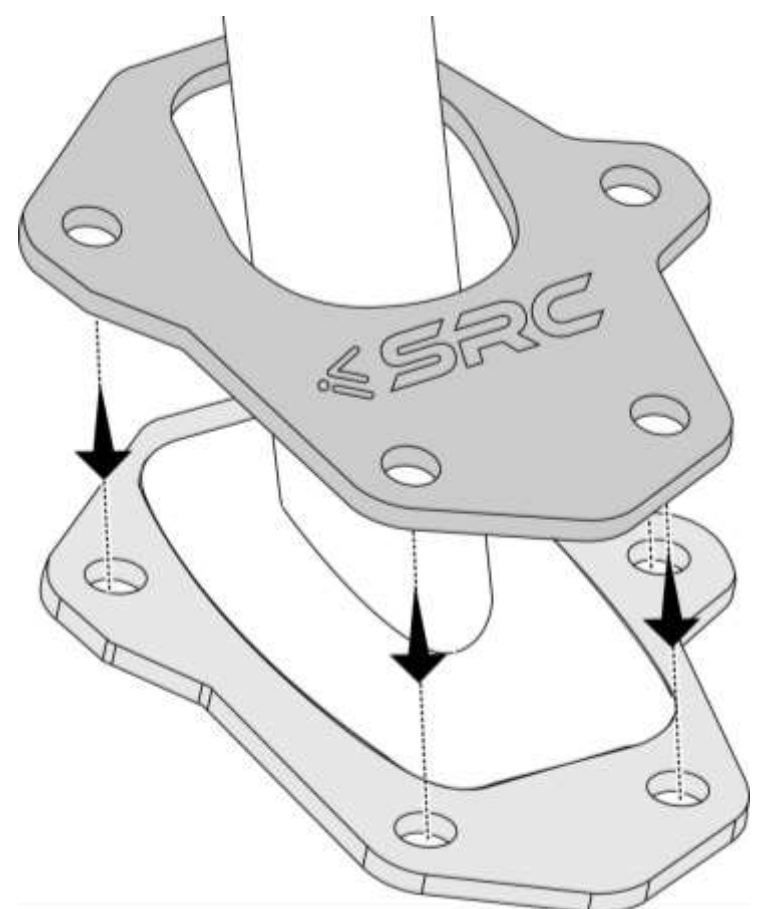

Step 3:

Orient and align the Middle Plate (6), as shown, and in-line with the 4 off Mounting hole in the Upper plate.

The Middle plate's inner walls closely hug the outer peripheral walls of the Side-stand base.

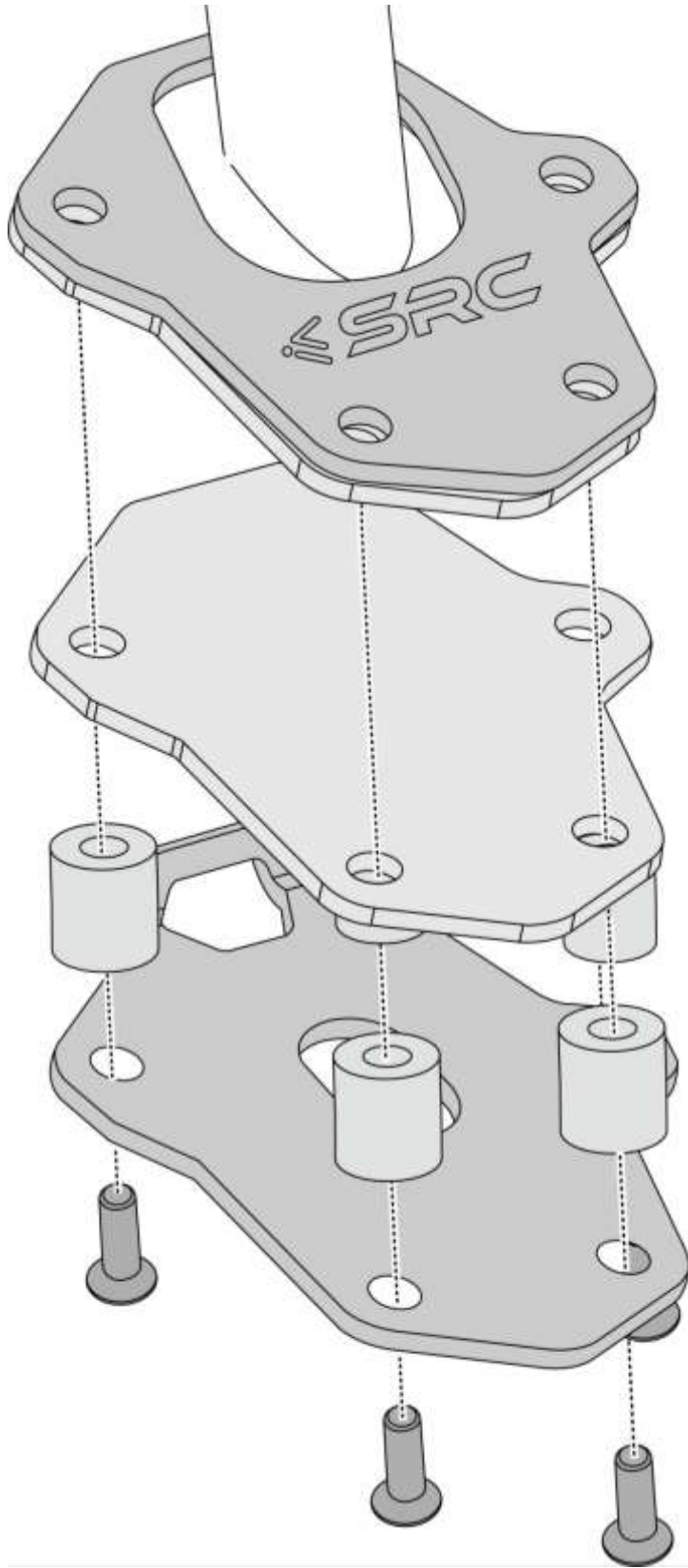

Step 4:

Slip-in the Buffer Plate (3), Spacer (4) – 4 off and Lower Plate (1), as shown and in-line with the mounting holes.

Slip-in the Countersunk screw M6 x 35 (5) – 4 off through the bottom side of the lower plate.

Step 5:

Orient and Stack the Plates closely, as shown and check for any slackness.

The Countersunk screws to flush into the countersunk bores of the Lower Plate.

Slip-in the Nut M6 (7) – 4 off from the top side and secure the threads on the Countersunk screws.

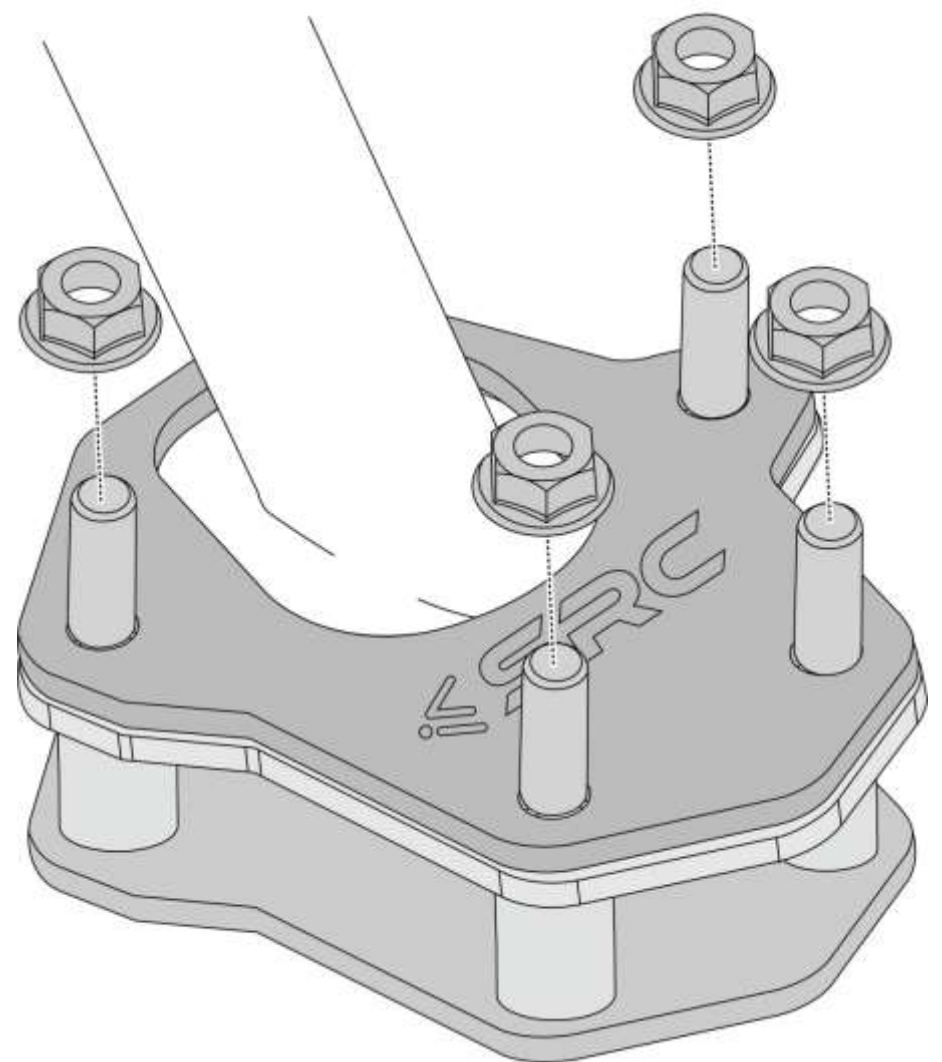

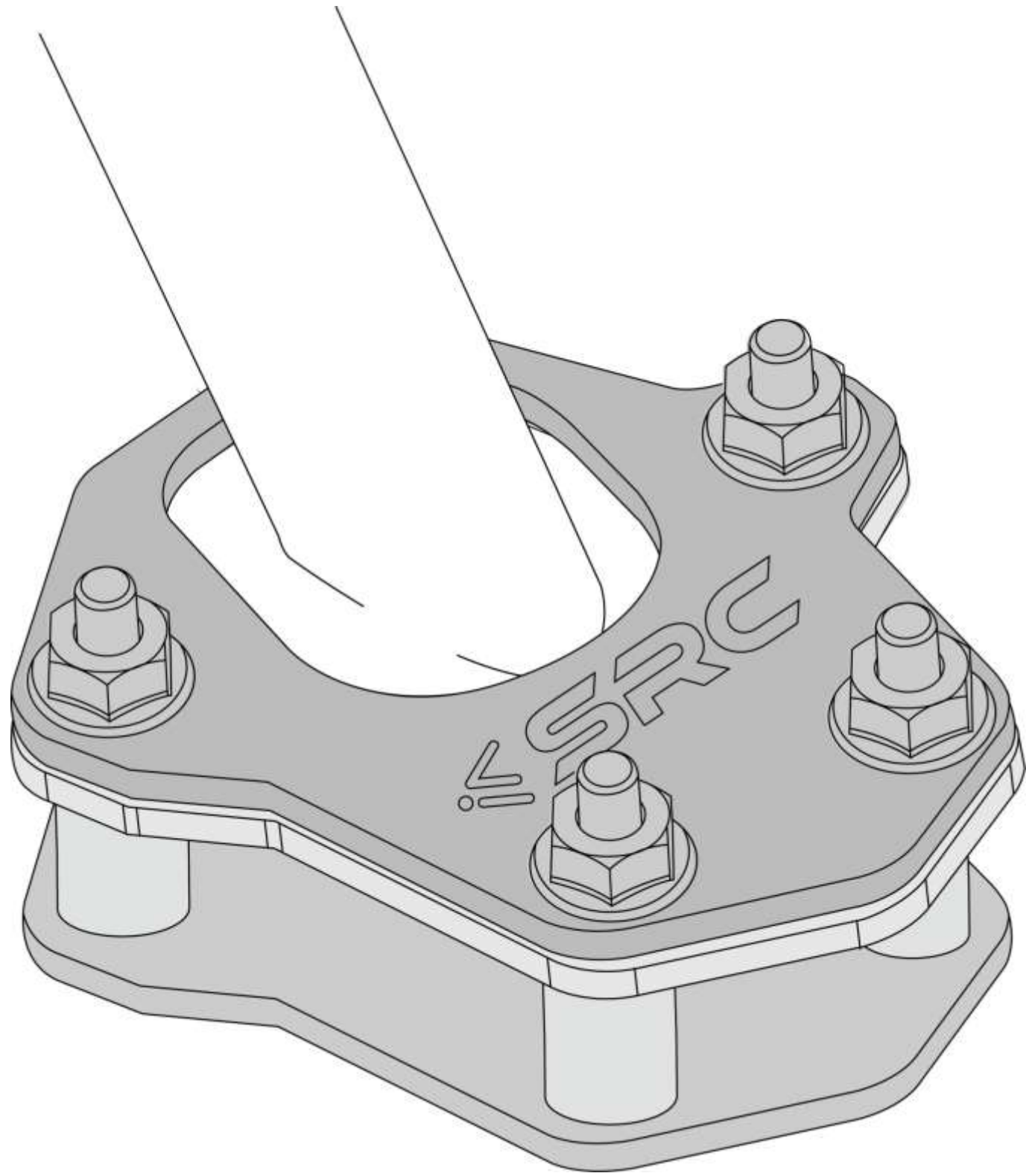

Step 6:

Fully tighten the Nut M6 to torque as per specification in the BOM table.

The final mounted condition of the Large Side Stand will be as shown in the drawing above.



General Instructions

- 1. We request you to pay attention to the Mounting Instructions in this document and follow the step-by-step procedures.**
- 2. This Mounting Instruction manual is a “Do It Yourself” (DIY) fitment manual of the Accessory part to the Vehicle. We have prepared this based on our experience and knowledge, related to the Vehicle, Part and its functional aspects.**
- 3. SRC cannot guarantee the interchangeability of the parts to any other manufacturer’s accessory part. It is advised to the User, to inspect and ensure the original state of all other Vehicle parts.**
- 4. We request you to bear in mind, that the Installed part can change the driving behaviour and/or the stability during driving or any other dynamic conditions.**
- 5. If you have the appropriate tools and another person to assist you in the mounting, it will help.**
- 6. After Completion of the Mounting and before taking on a First ride, Ensure and Check all functions of the Vehicle. It is always advised to check loosening of the fasteners after the first 50 kilo meters of ride and at regular intervals.**
- 7. We are showing here the Scope of Supply/ Installation/Parts list & BOM from SRC**
- 8. To the maximum extent possible, our design use the current Mounting/Fitment of the Original Equipment, so that Installation of these accessories will not affect the Payload or Function of the Vehicle or the Part on which it is mounted to protect it**
- 9. If any additional modifications are to be done, prior to the fitment of the accessories, it will be explicitly specified in the instruction sheets.**