

**Scope of Supply/Bill of Material & Mounting Drawings**

Part Number: H-CRF17-02-01-SL / H-CRF17-02-02

Part Description: Radiator Guard– HONDA CRF250 RALLY

**Installation / Parts List / Bill of Material for Mounting**

No.	Description	Quantity	Torque * (N-m)	Remarks **
1	Radiator Guard	1		
2	Washer M6	2		
3	Screw M6 x 165	2	15	Use Liquid Thread Locker
4	Bush Pipe	2		

SRC Design uses Metric System of Measurement and all dimensions are in Millimeters

\* Recommended to use the Torque specified in the table

\*\* Denotes Usage of Liquid Thread Locker in specified locations

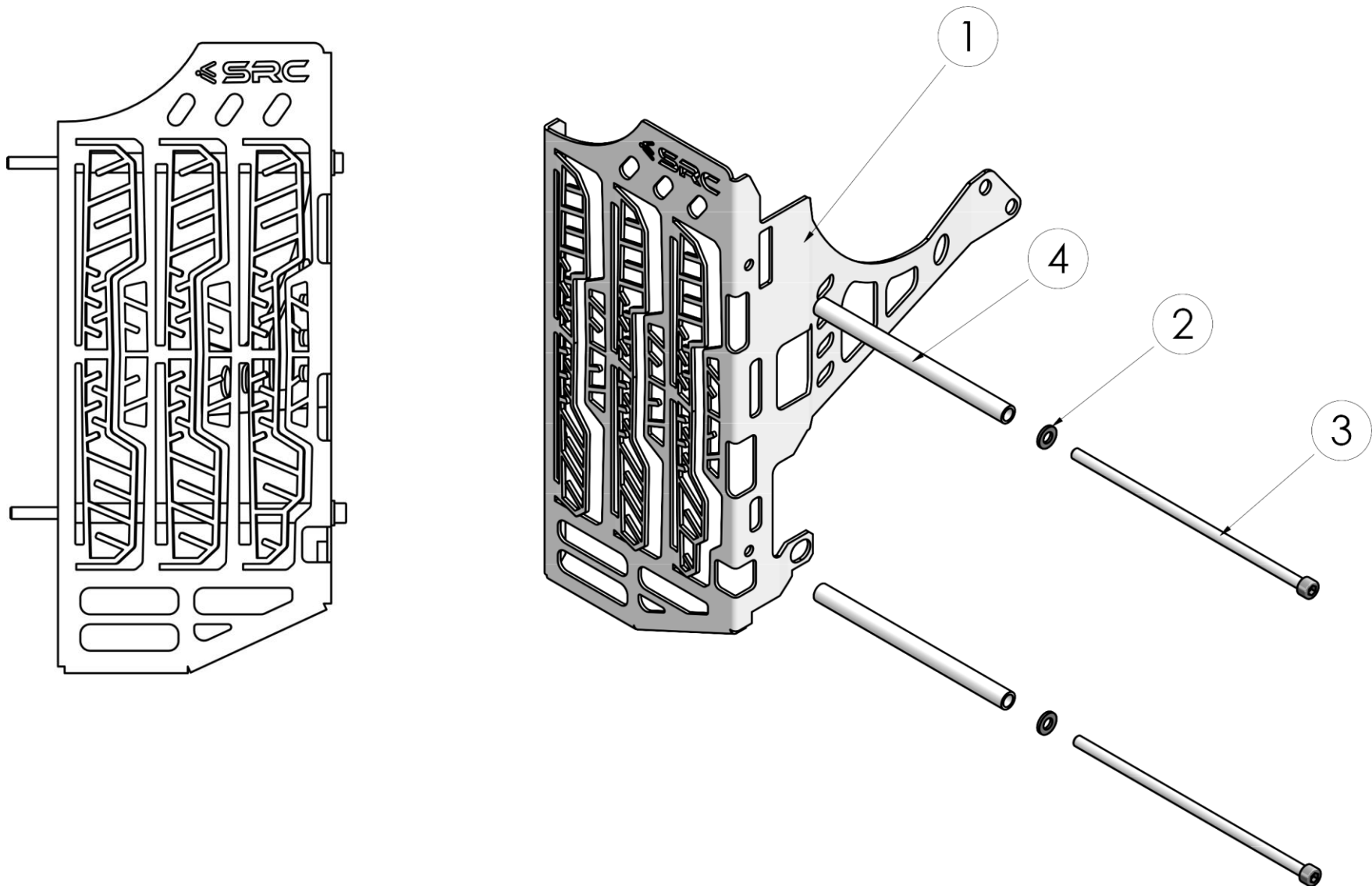

**MOUNTING DRAWINGS**

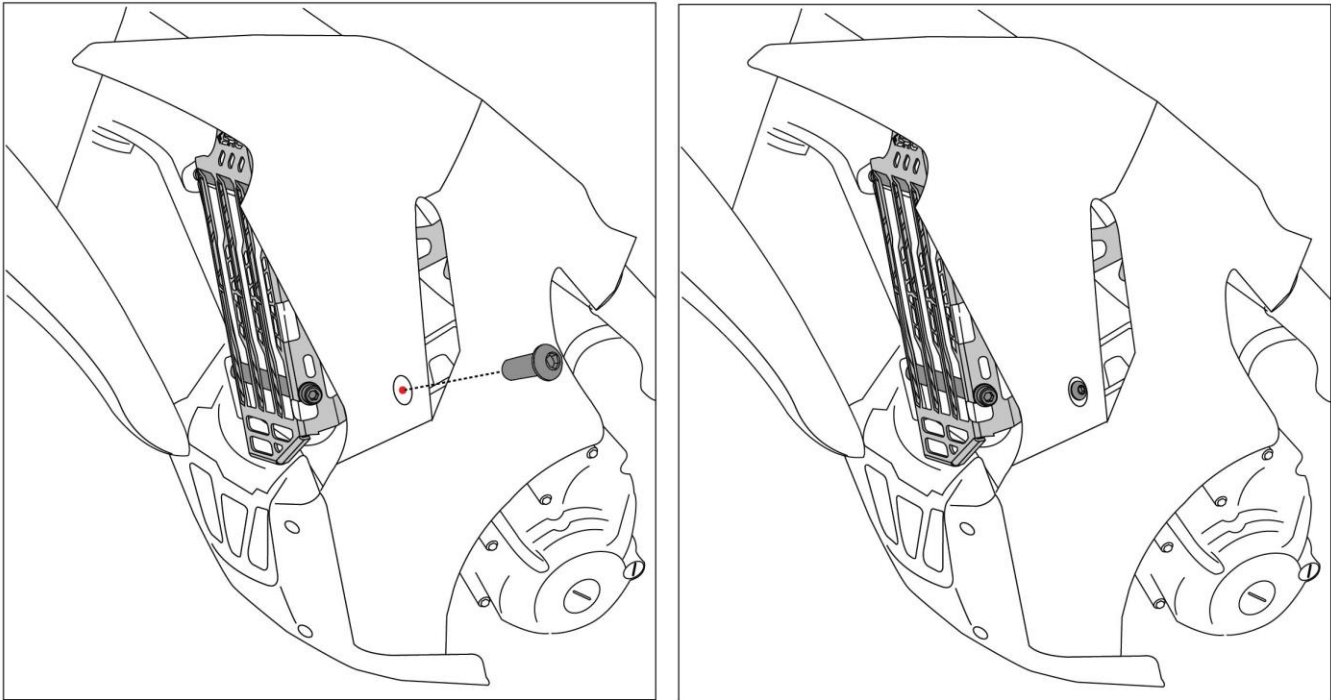
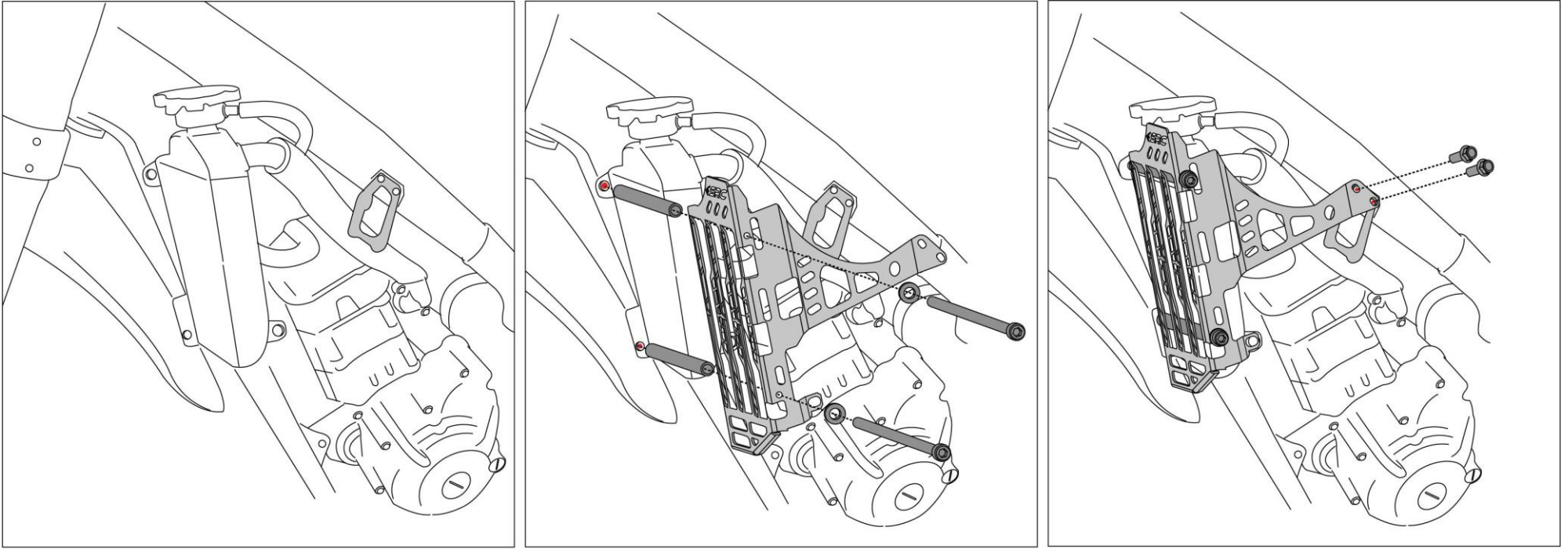

## Mounting Instructions

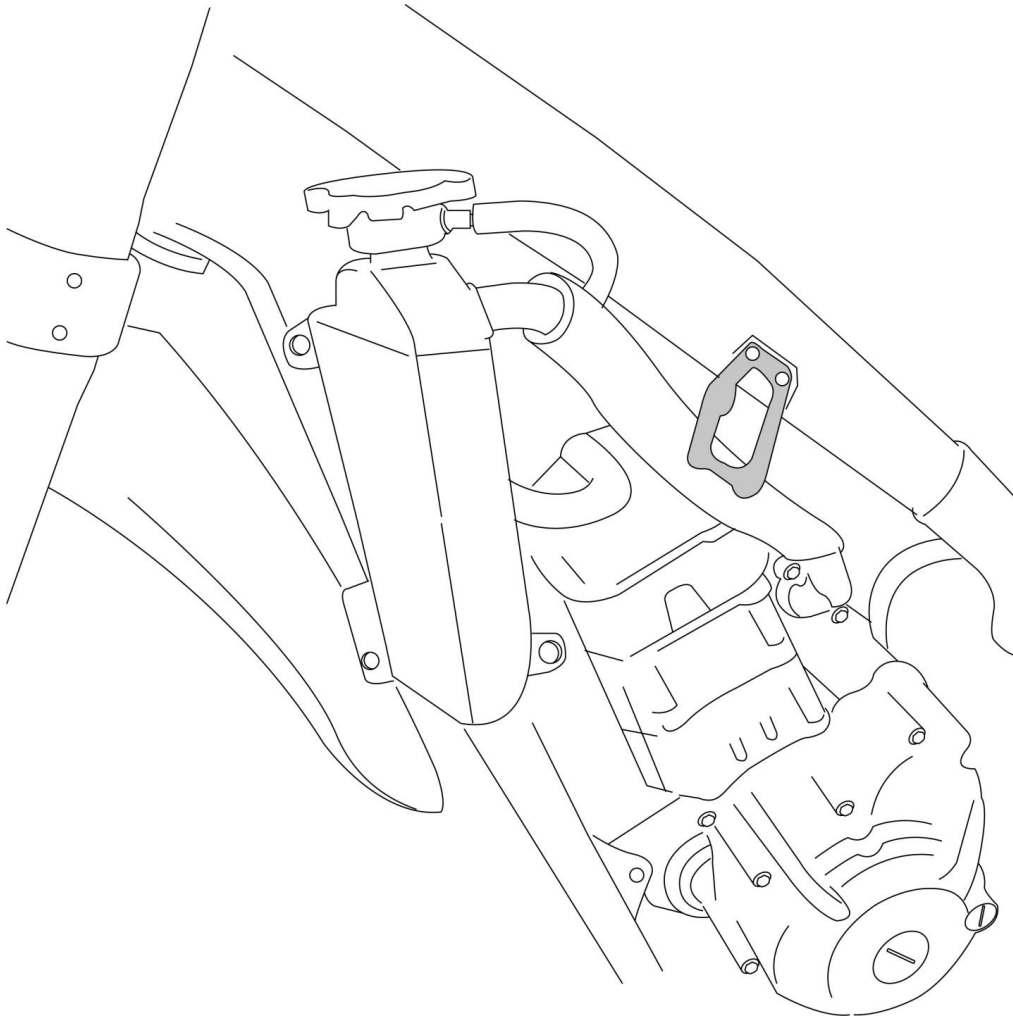

### Step 1:

**Remove the Dirt shield, covering the Radiator. This will allow access to mounting of SRC Radiator Guard**

### Step 2:

**Orient the Radiator Guard (as shown) and slide-in the Bush Pipe (4) – 2 off, and from the Near end, slide-in the Washer M6 (2) – 2 off and Long Screw M6 x 165 (3) – 2 off and secure the threads in the mounting holes, at the rear end (As shown in “Red colour”).**

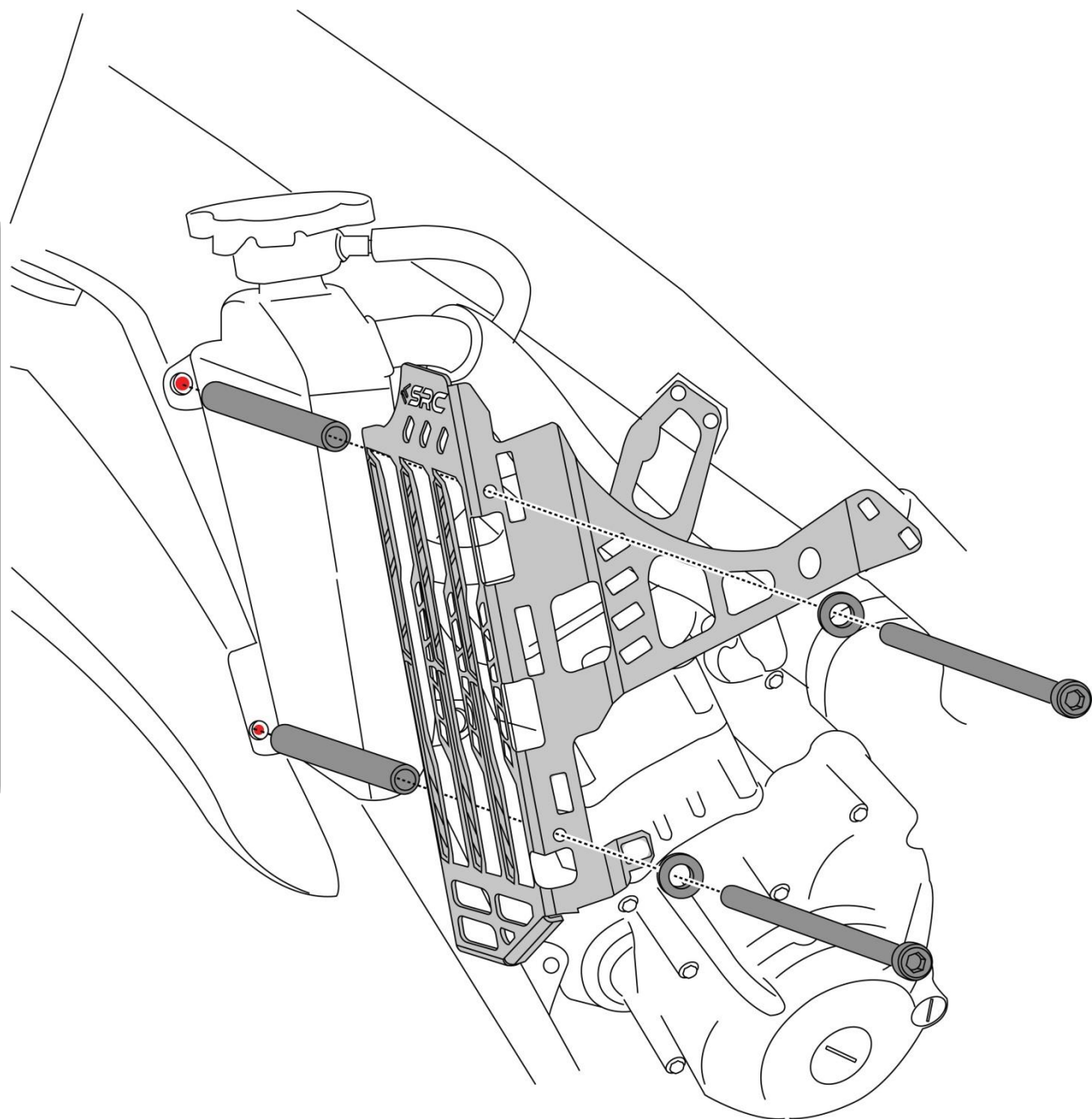

**Step 3:**

**Orient the 2 mounting holes on the Right Wing flap and slip-in and secure the mounting hole threads with the 2 off OE Bolts into the small bracket, attached to the Tubular frame (as shown in "Red colour")**

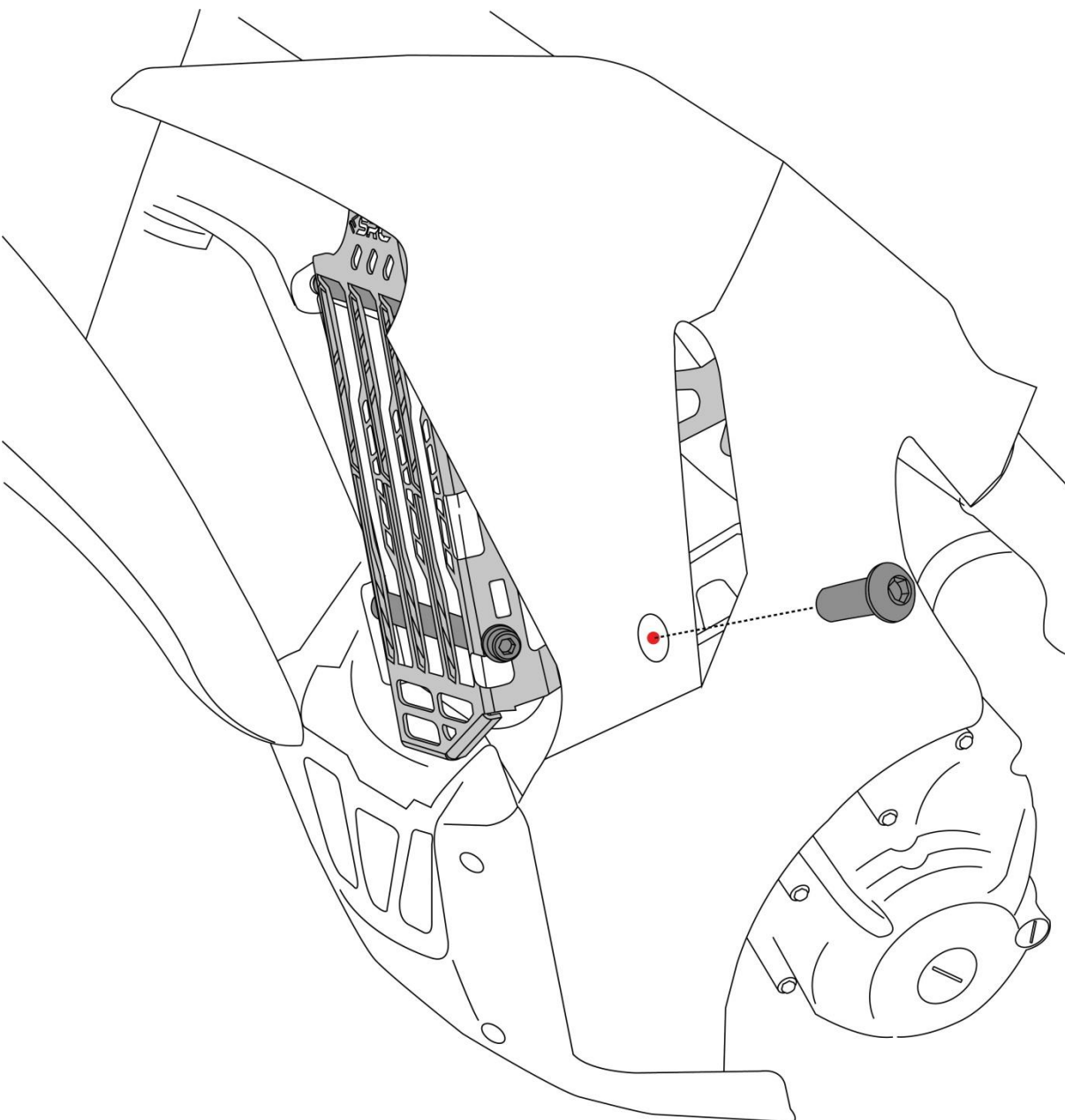
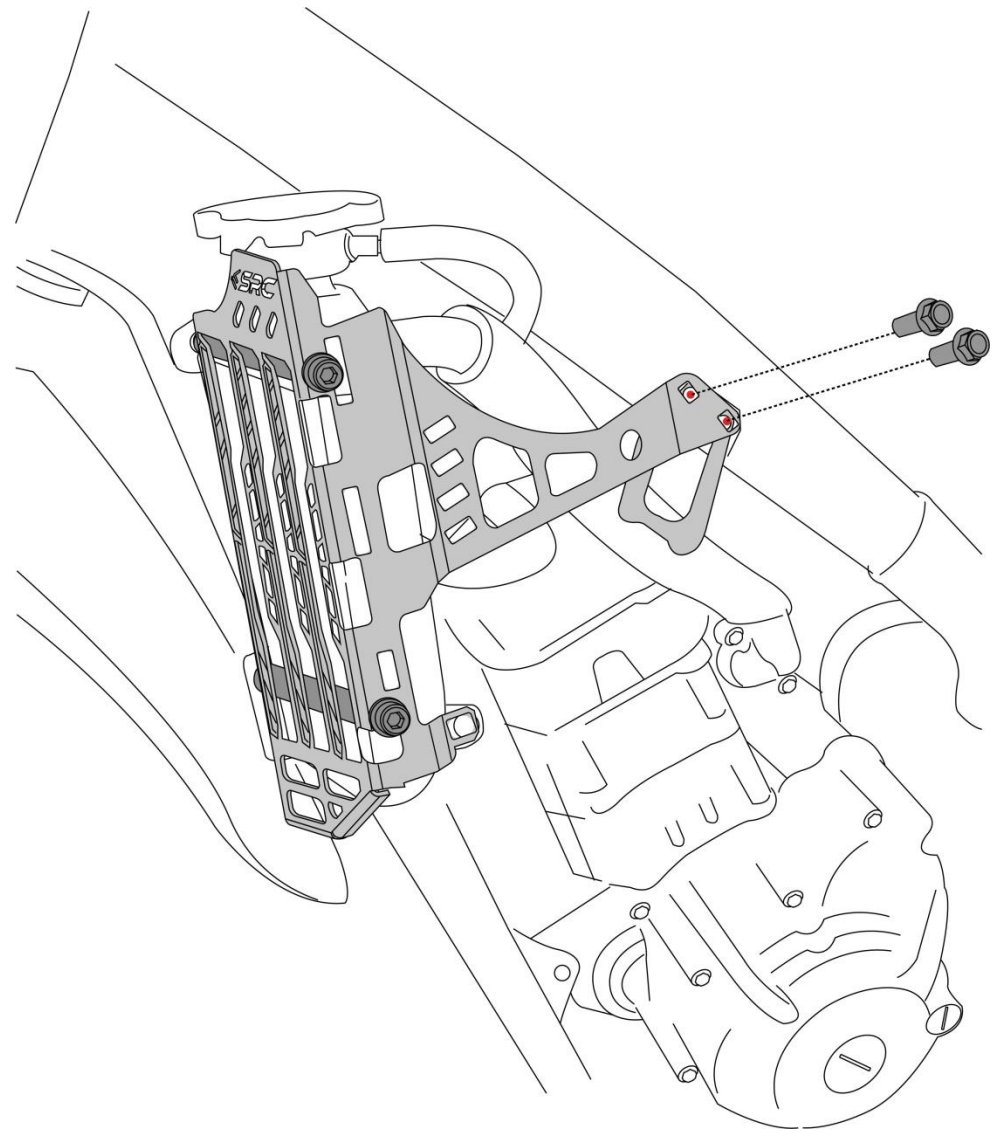

**Step 4:**

**The Dirt shield can be mounted back in its place. The SRC Radiator Guard is provided with a small flap on the bottom side and a slot, through which the OE Bolt can be passed to secure the Mounting hole of the Radiator (the access hole through the Dirt shield is shown in Red colour).**

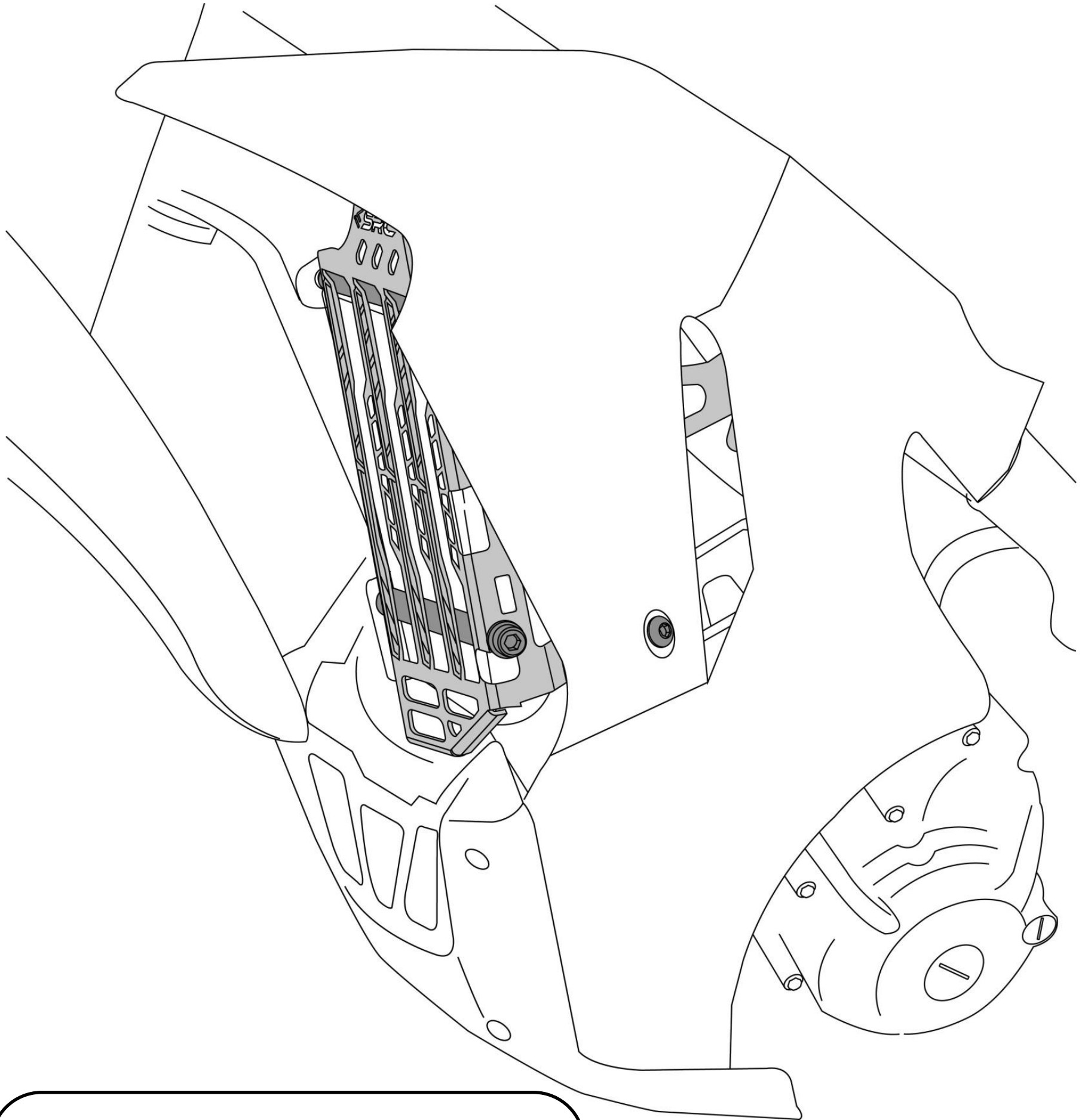

**Step 5:**

**Step 5: The final mounted condition of the Radiator Guard and Dirt Shield mounting condition, is as shown.**

## General Instructions

1. We request you to pay attention to the Mounting Instructions in this document and follow the step-by-step procedures.
2. This Mounting Instruction manual is a “Do It Yourself” (DIY) fitment manual of the Accessory part to the Vehicle. We have prepared this based on our experience and knowledge, related to the Vehicle, Part and its functional aspects.
3. SRC cannot guarantee the interchangeability of the parts to any other manufacturer’s accessory part. It is advised to the User, to inspect and ensure the original state of all other Vehicle parts.
4. We request you to bear in mind, that the Installed part can change the driving behaviour and/or the stability during driving or any other dynamic conditions.
5. If you have the appropriate tools and another person to assist you in the mounting, it will help.
6. After Completion of the Mounting and before taking on a First ride, Ensure and Check all functions of the Vehicle. It is always advised to check loosening of the fasteners after the first 50 kilo meters of ride and at regular intervals.
7. We are showing here the Scope of Supply/ Installation/Parts list & BOM from SRC
8. To the maximum extent possible, our design use the current Mounting/Fitment of the Original Equipment, so that Installation of these accessories will not affect the Payload or Function of the Vehicle or the Part on which it is mounted to protect it
9. If any additional modifications are to be done, prior to the fitment of the accessories, it will be explicitly specified in the instruction sheets.