

Scope of Supply/Bill of Material & Mounting Drawings

Part Number: H-CRF17-01-01-SL / H-CRF17-01-02

Part Description: Head Light Guard –HONDA CRF250 RALLY

Installation / Parts List / Bill of Material for Mounting

No.	Description	Quantity	Torque * (N-m)	Remarks **
1	Head Light Guard	1		
2	Bracket RH	1		
3	Bracket LH	1		
4	Bush	1		
5	Washer M5	5		
6	Screw M5 x 6	4	5-6	Use Liquid Thread Locker
7	Screw M5 x 35	1	5-6	Use Liquid Thread Locker

SRC Design uses Metric System of Measurement and all dimensions are in Millimeters

* Recommended to use the Torque specified in the table

** Denotes Usage of Liquid Thread Locker in specified locations

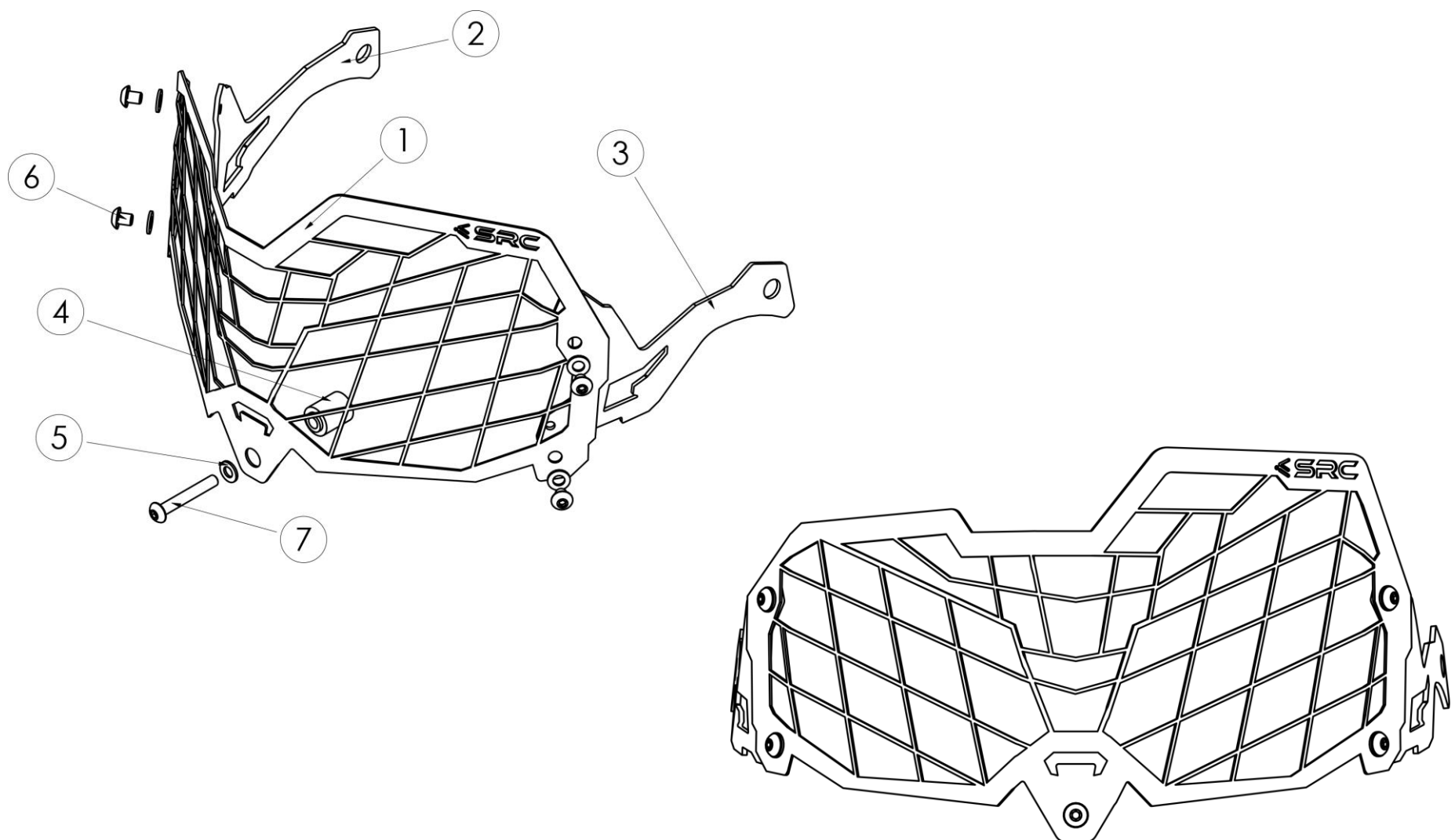

MOUNTING DRAWINGS

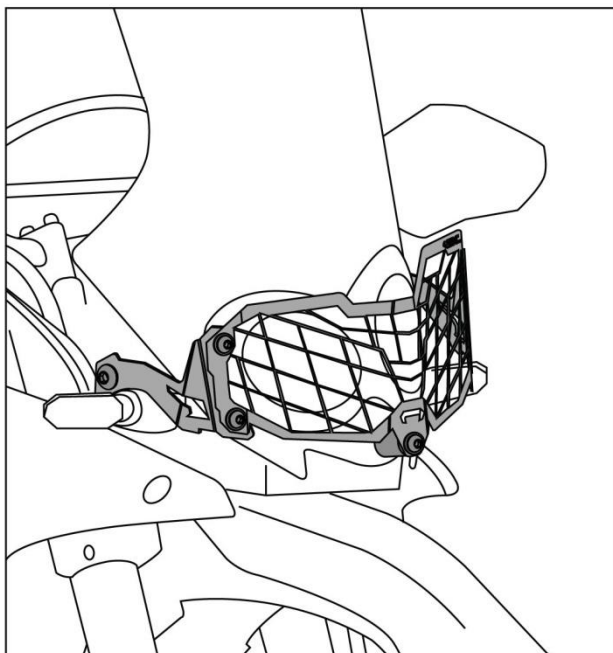
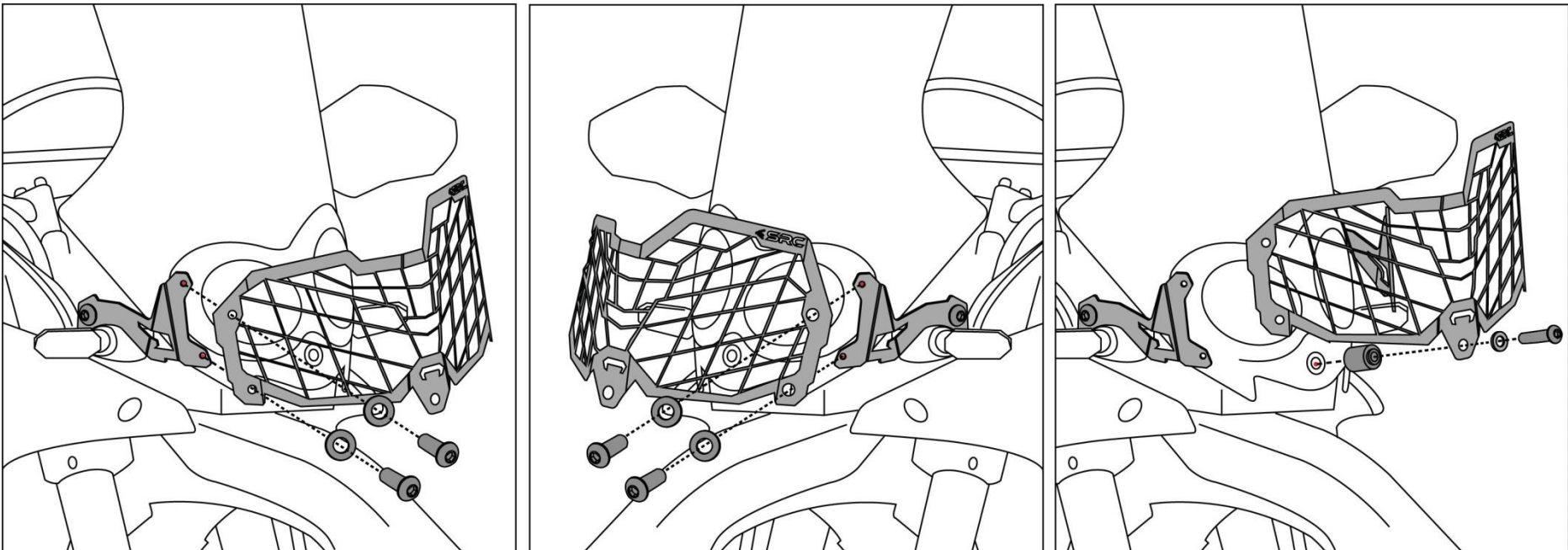
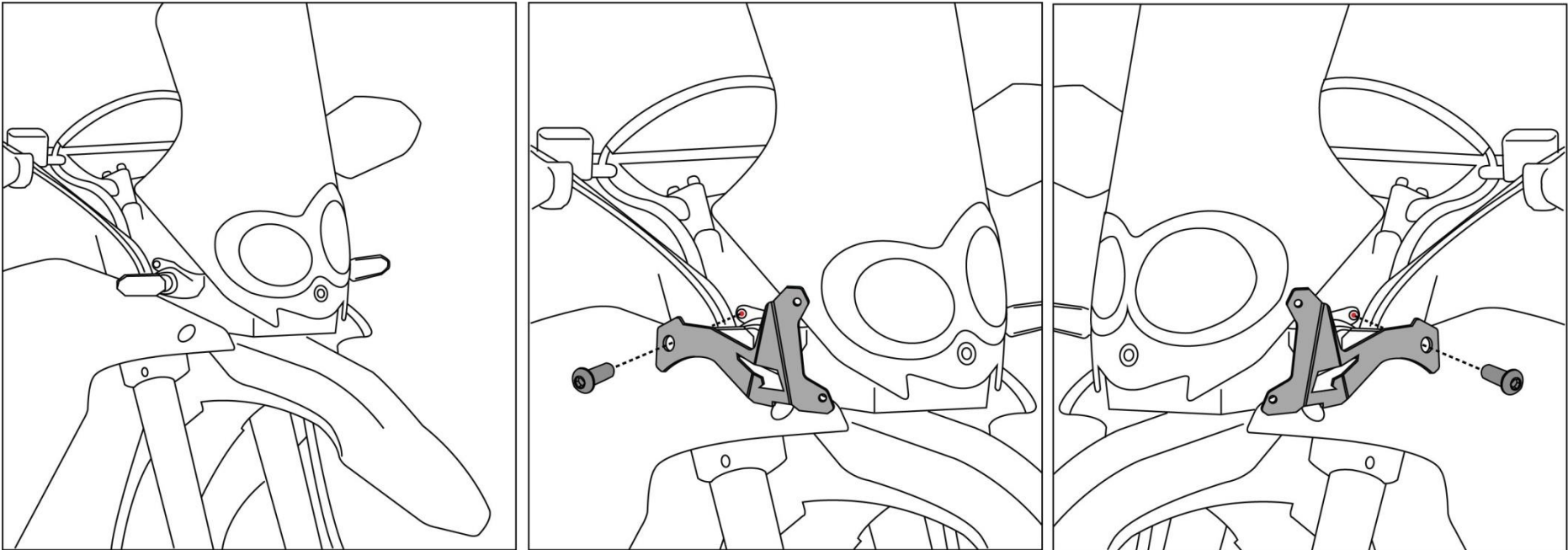

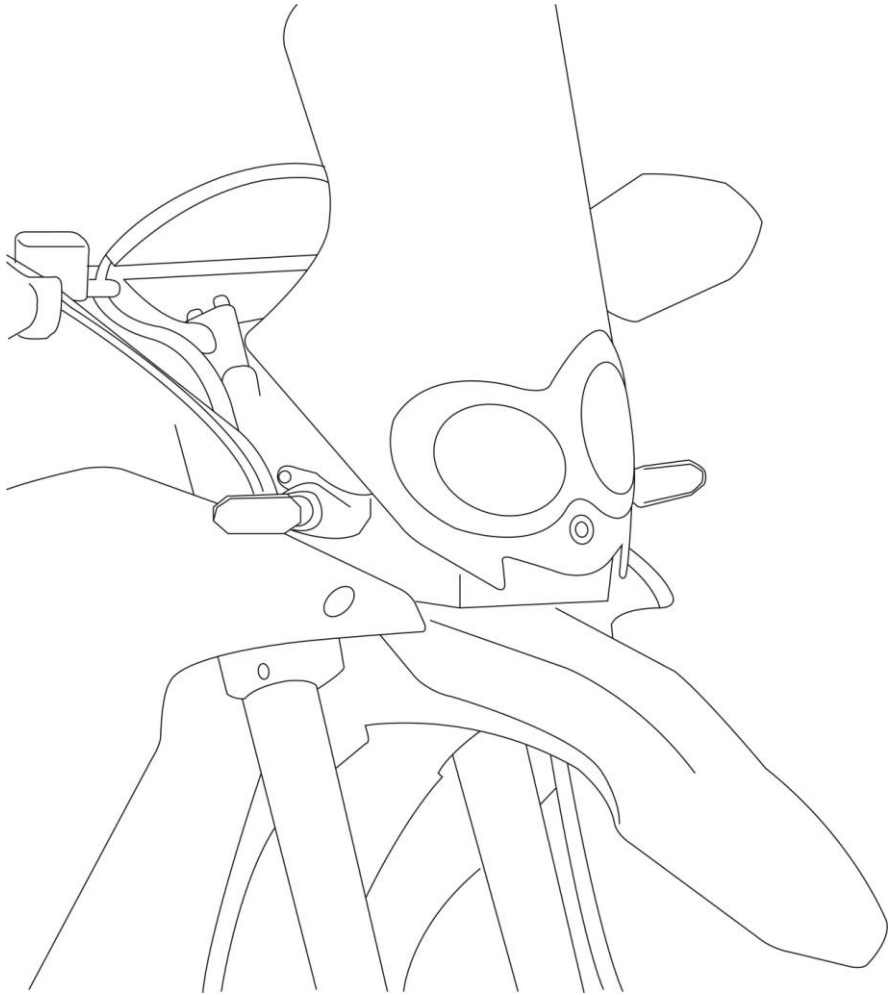

The Mounting holes, which will be used for mounting the Bracket RH (2) and Bracket LH (3), of the Head Light Guard, can be found on the Front Left hand side and Right hand side of the Indicator Lamps.

(The Drawing shows the views of it from the Left Hand Side, when looking from the front side of the Motorbike).

Unscrew them and keep it aside for mounting the Brackets.

Step 1:

Orient and Align the Bracket RH (2) and secure the threads in the Mounting Hole (shown in Red colour) behind the Indicator Lamp, using the OE screw, which was removed in the previous step.

The Bracket LH, has a curved portion, that clears the Indicator Lamp, as shown.

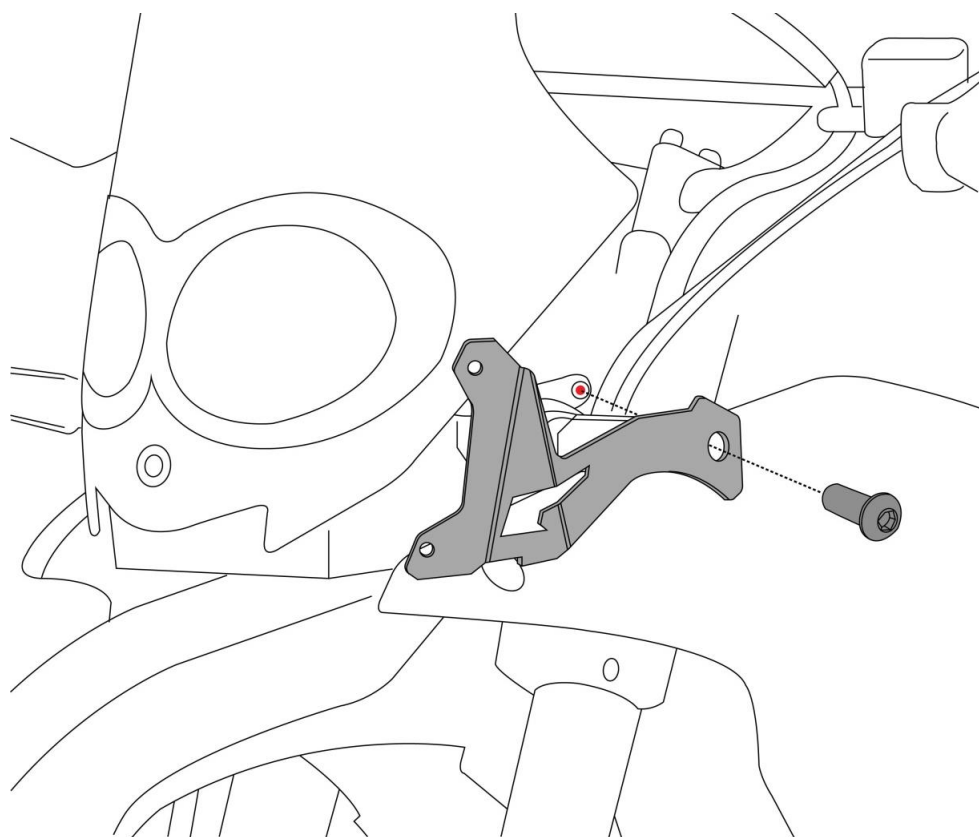
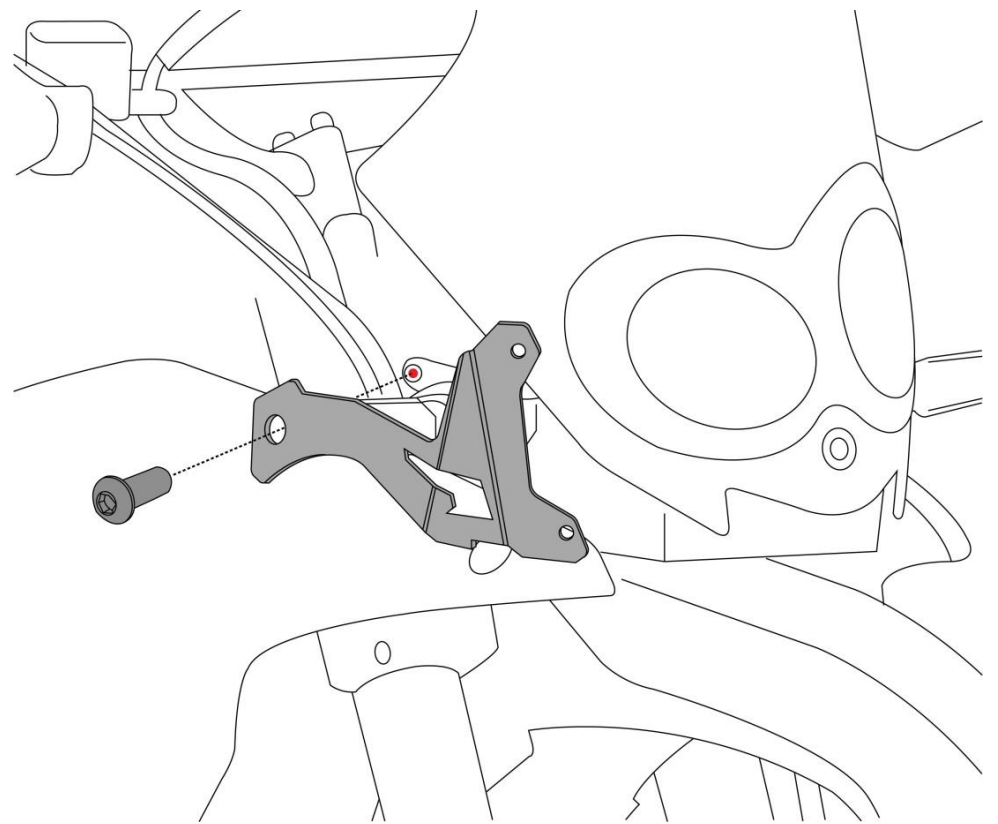

Step 2:

Repeat the Step 1 for mounting the Bracket LH (3).

Orient and Align the Bracket LH (3) and secure the threads in the Mounting Hole (shown in red colour) behind the Indicator Lamp, using the OE screw, which was removed in the previous step.

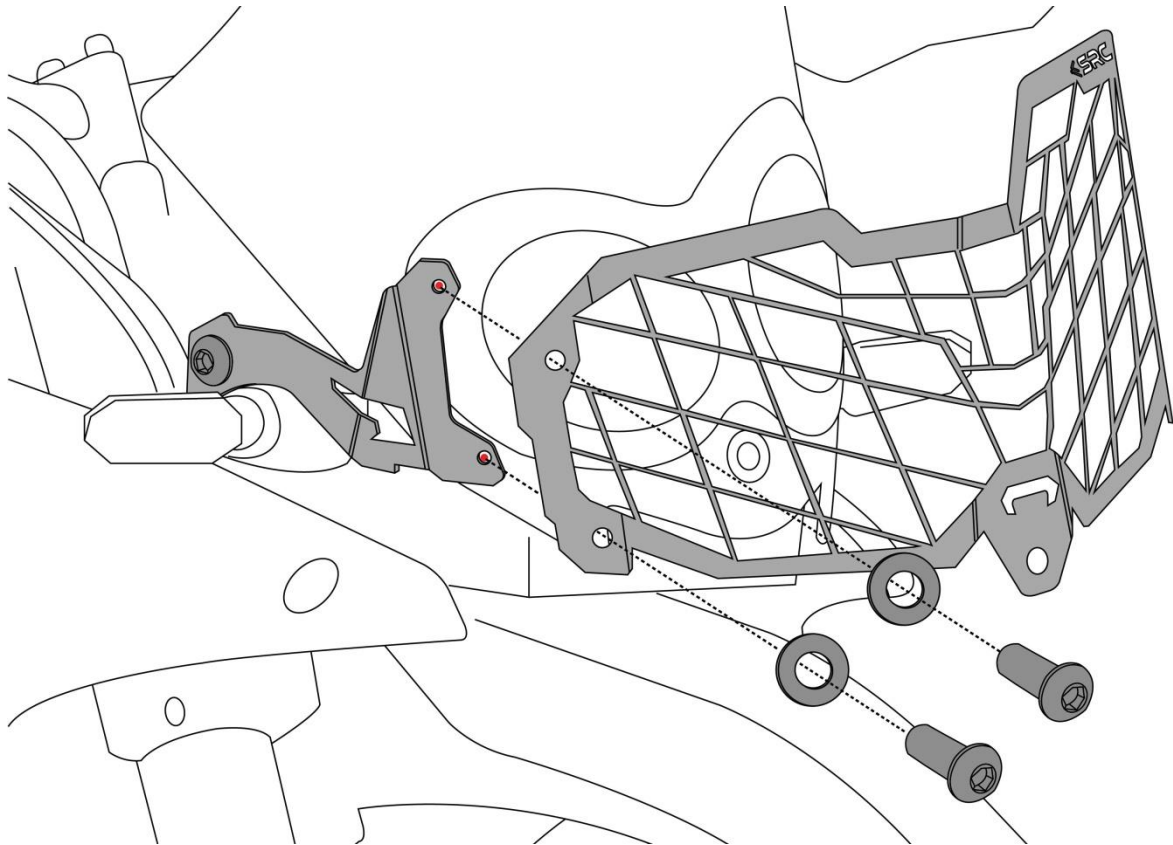

Step 3:

Orient and Align the Head Light Guard (1), as shown, and slip-in the Washer M5 (5) – 2 off, Screw M5 x 6 (6) -2 off, and secure the threads in the mounting hole in the Bracket RH (2).

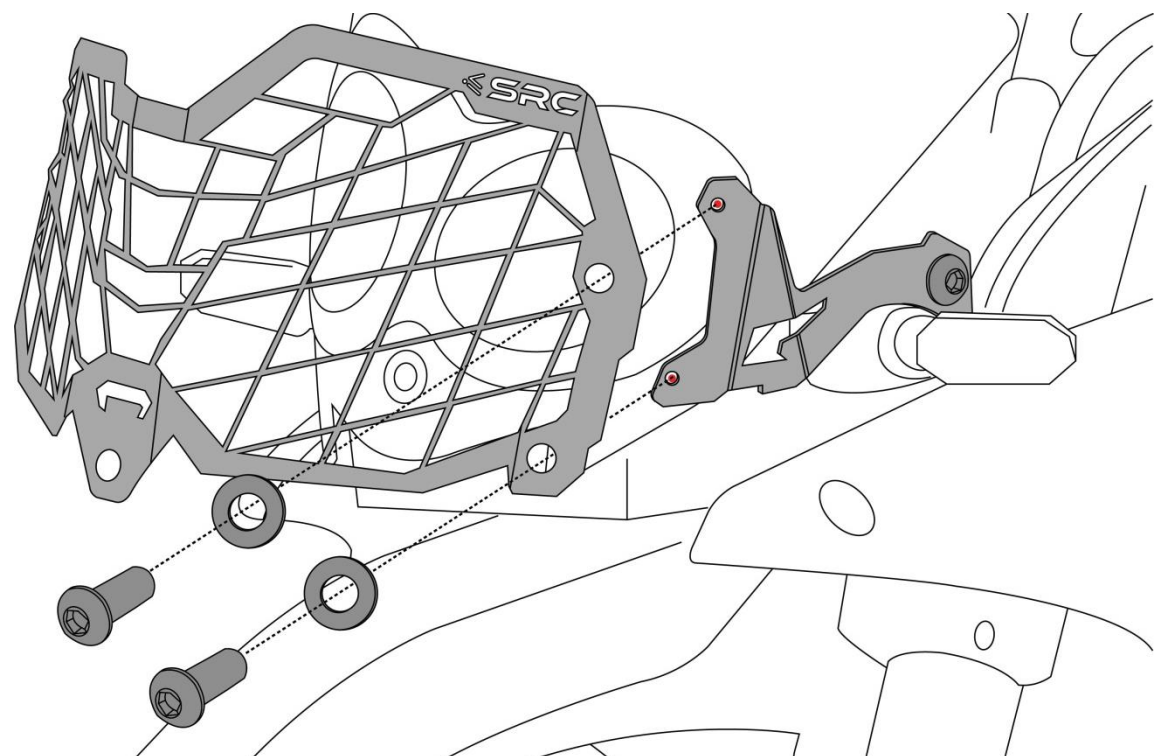

Step 4:

Slip-in the Washer M5 (5) – 2 off, Screw M5 x 6 (6) -2 off, and secure the threads in the mounting hole in the Bracket LH (3), as shown.

Step 5:

Slip-in the Bush (4) – 1 off, Washer M5 (5) – 1 off and Screw M5 x 35 (7) – 1 off, as shown, and secure the threads in the Mounting hole (shown in Red colour), beneath the Head Light, and tighten them fully to the torque, as specified in the BOM table.

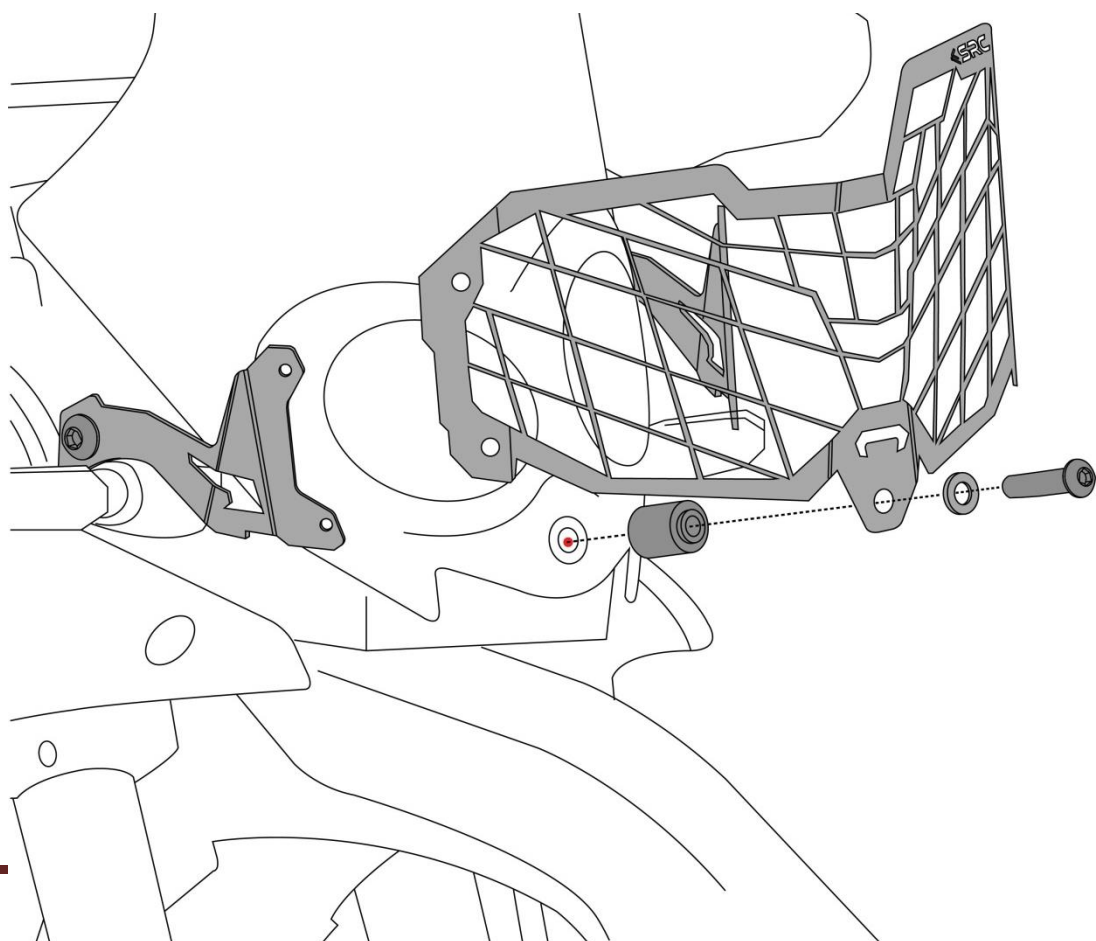

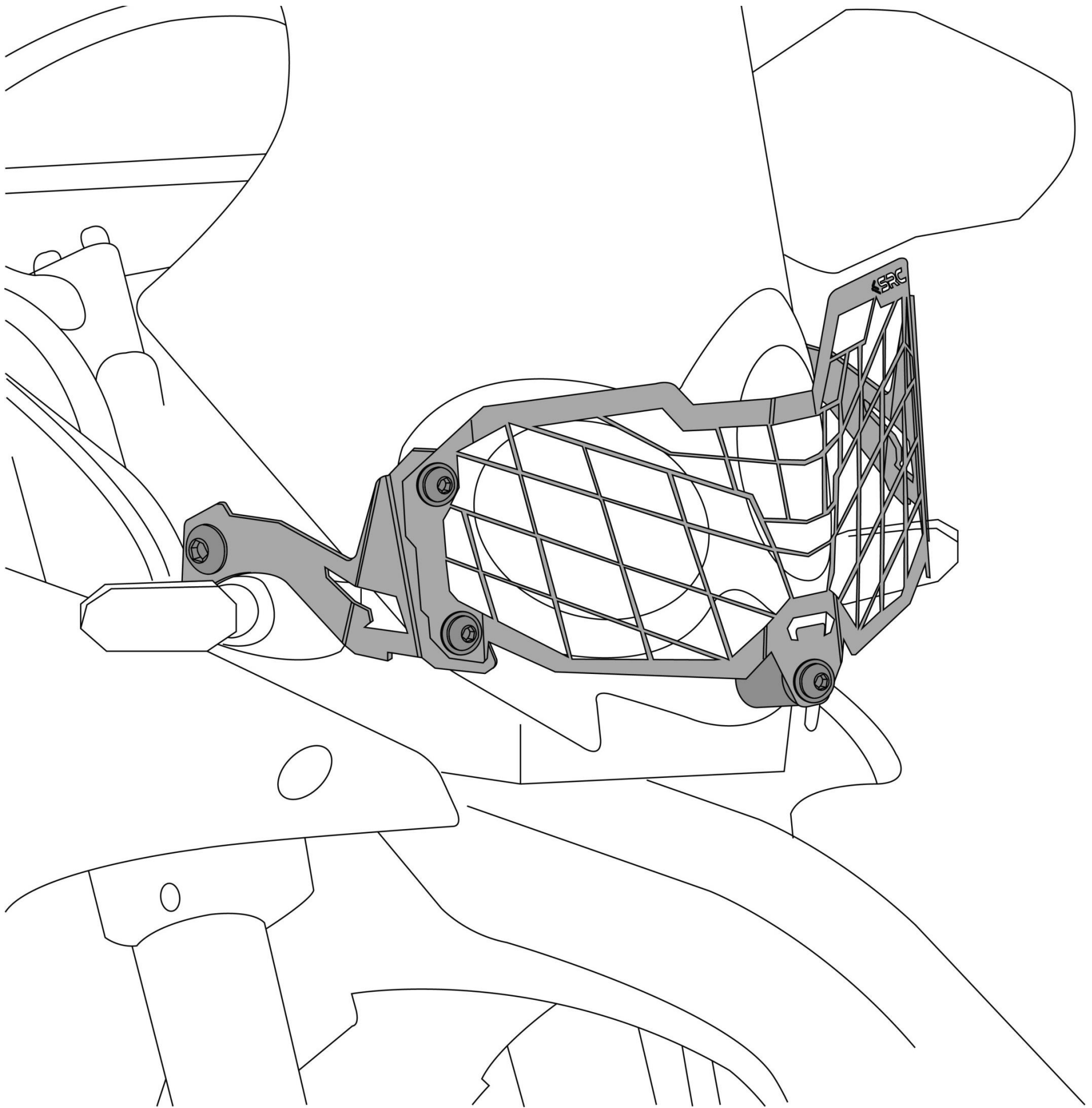

Step 5:

Ensure Orientation symmetry

Tighten all the screws, as per Torque specified in the BOM table.

Final Mounting condition of the Head Light Guard, is as shown.



General Instructions

1. We request you to pay attention to the Mounting Instructions in this document and follow the step-by-step procedures.
2. This Mounting Instruction manual is a “Do It Yourself” (DIY) fitment manual of the Accessory part to the Vehicle. We have prepared this based on our experience and knowledge, related to the Vehicle, Part and its functional aspects.
3. SRC cannot guarantee the interchangeability of the parts to any other manufacturer’s accessory part. It is advised to the User, to inspect and ensure the original state of all other Vehicle parts.
4. We request you to bear in mind, that the Installed part can change the driving behaviour and/or the stability during driving or any other dynamic conditions.
5. If you have the appropriate tools and another person to assist you in the mounting, it will help.
6. After Completion of the Mounting and before taking on a First ride, Ensure and Check all functions of the Vehicle. It is always advised to check loosening of the fasteners after the first 50 kilo meters of ride and at regular intervals.
7. To the maximum extent possible, our design use the current Mounting/Fitment of the Original Equipment, so that Installation of these accessories will not affect the Payload or Function of the Vehicle or the Part on which it is mounted to protect it
8. If any additional modifications are to be done, prior to the fitment of the accessories, it will be explicitly specified in the instruction sheets