

Scope of Supply/Bill of Material & Mounting Drawings

Part Number: H-CB500X-18-01-SL

Part Description: WIDE FOOT PEG ADEPTER – HONDA CB500X

Installation / Parts List / Bill of Material for Mounting

NO.	Description	Quantity	Torque * (N-M)	Remarks **
1	Wide Foot Peg	2		
2	Washer M5	4		
3	Nut M5	4	5 - 6	Use Liquid Thread Locker
4	Screw M5 X 25	4	5 - 6	Use Liquid Thread Locker
SRC Design uses Metric System of Measurement and all dimensions in Millimeters				
* Recommended to use the Torque specified in the table				
** Denotes Usage of Liquid Thread Locker in specified Locations				

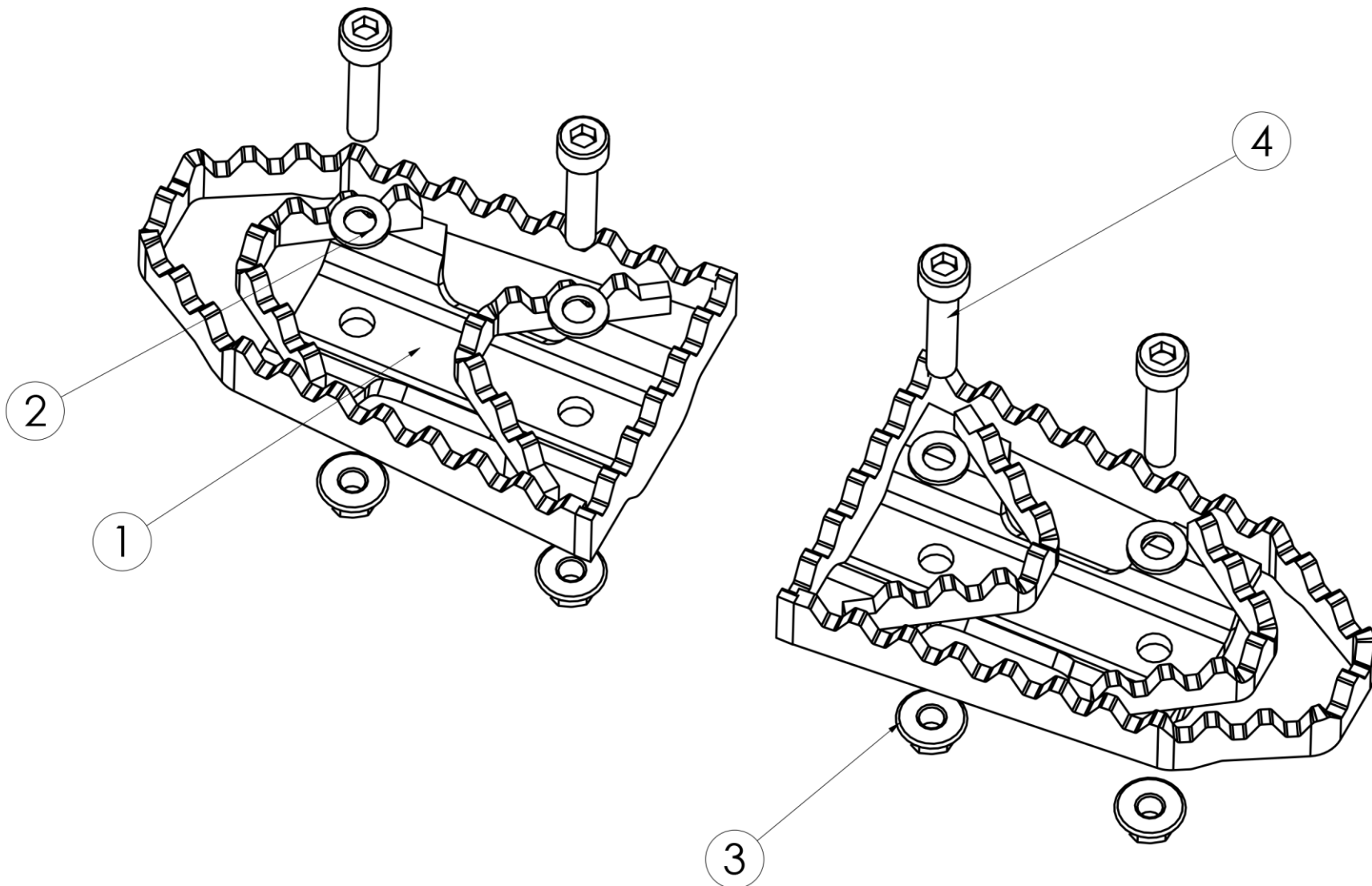

Mounting Drawings

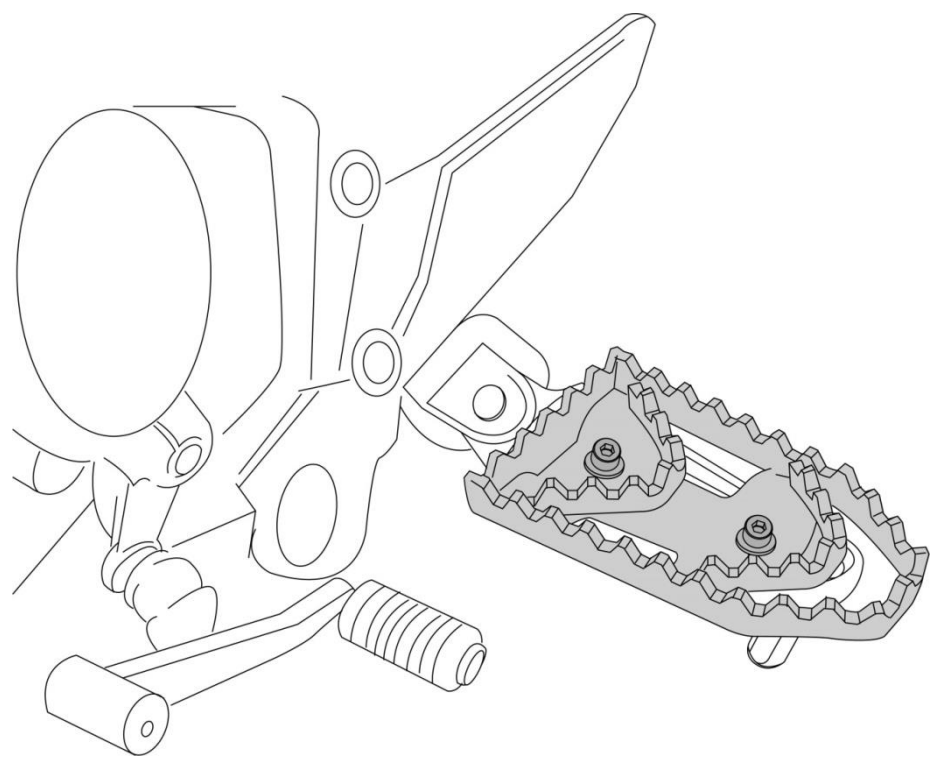
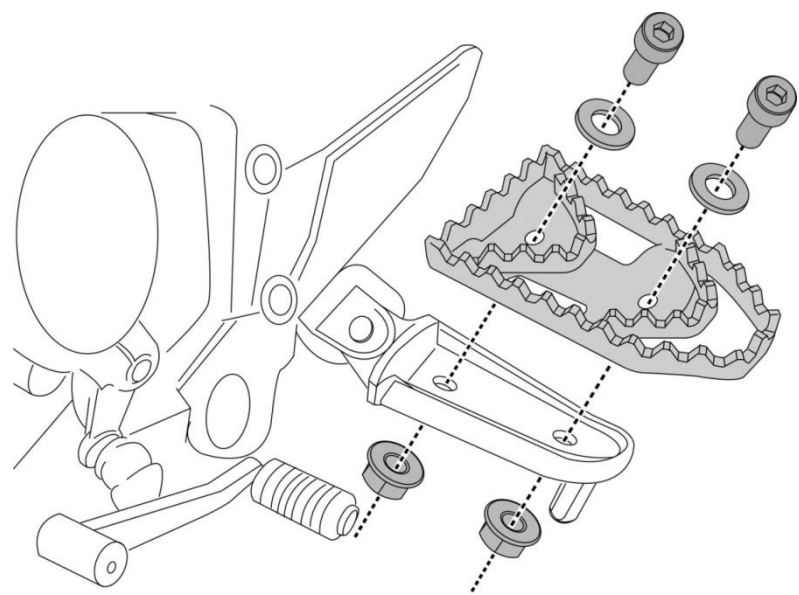
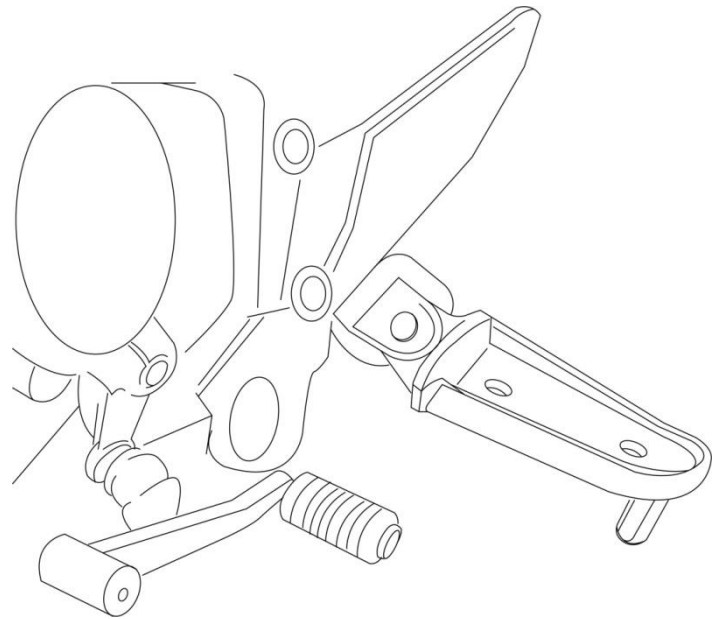

Mounting Instructions

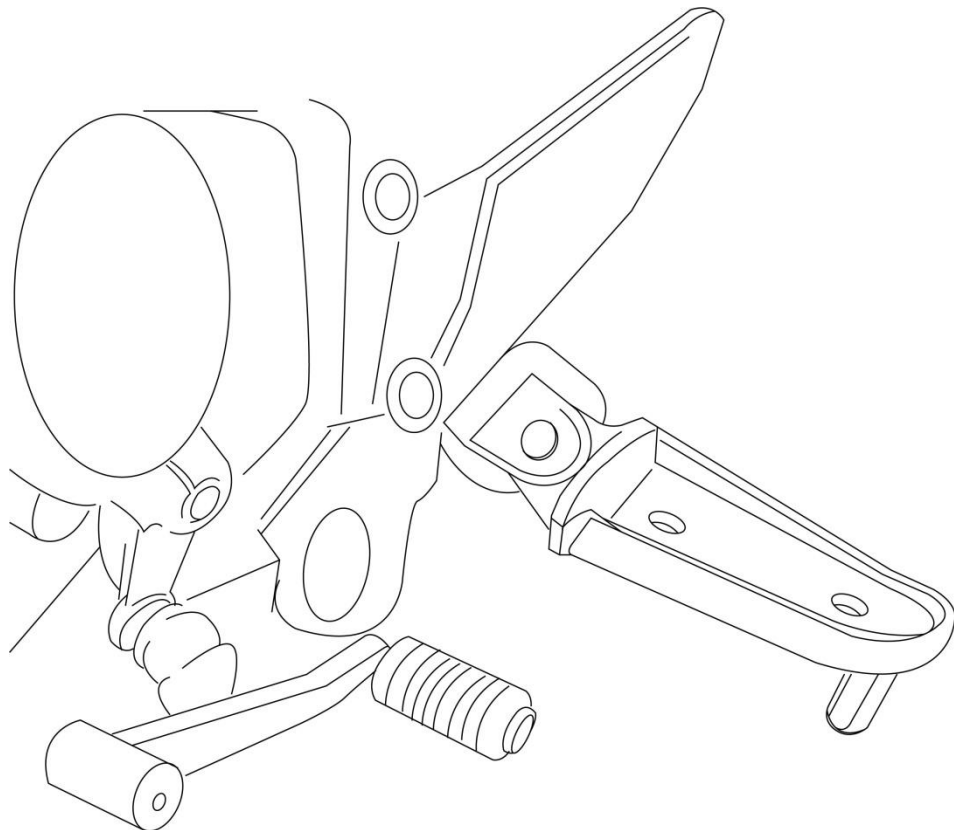

Step 1:

Foot Peg scope of supply and fitment is 2 off...The drawing shown here is for mounting/fitting the Foot Peg on the Left Hand side.

The procedure can be repeated for the Right Hand side.

Step 2:

Orient the Foot Peg (1), as shown, in-line with the Mounting Holes on the existing foot peg in the Motorbike, and slide-in the M5 x 25 Screw (4) and Washer M5 (2) and secure from the bottom side using M5 Nut (3), as shown.

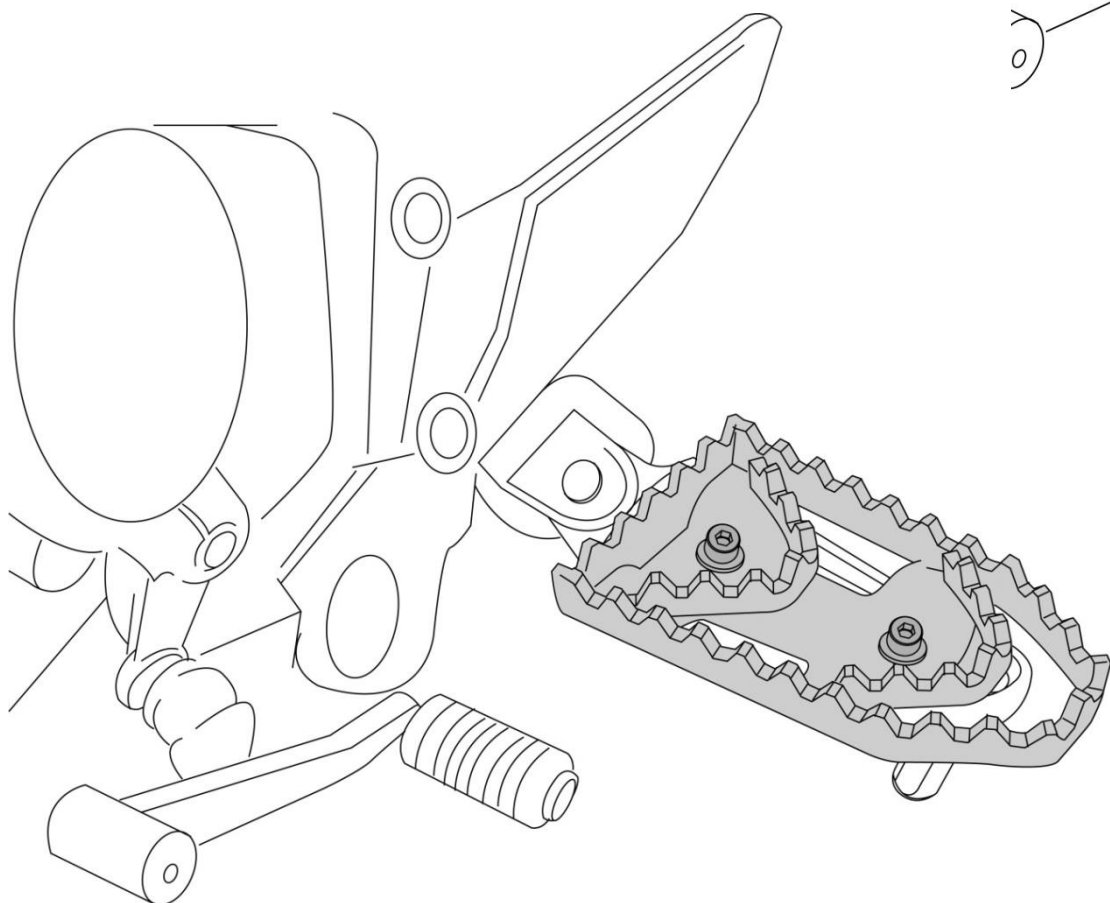
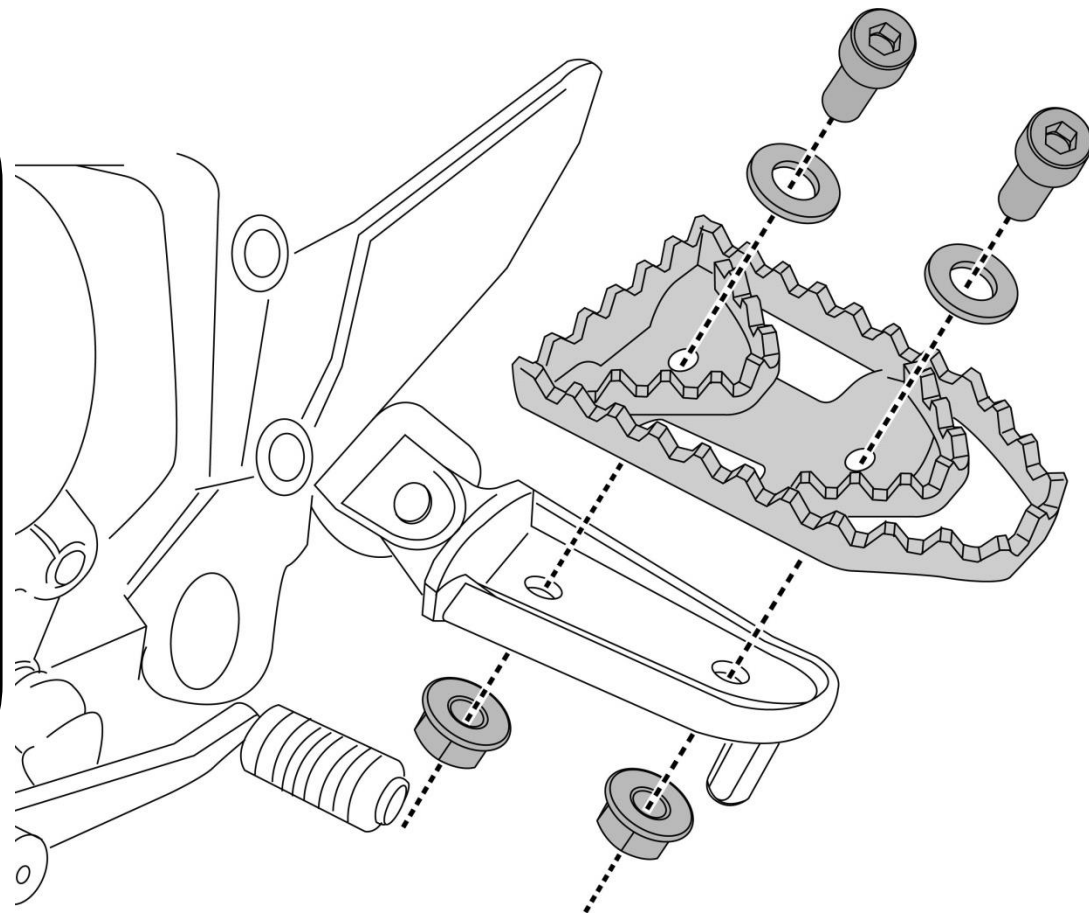

Step 3:

Visually ensure fitment, without any slackness, and tighten the Nuts to the torque, as specified in the BOM table.

Repeat the steps for mounting and fitting the Foot Peg on the other side.



General Information

1. We request you to pay attention to the Mounting Instructions in this document and follow the step-by-step procedures.
2. This Mounting Instruction manual is a “Do It Yourself” (DIY) fitment manual of the Accessory part to the Vehicle. We have prepared this based on our experience and knowledge, related to the Vehicle, Part and its functional aspects.
3. SRC cannot guarantee the interchangeability of the parts to any other manufacturer’s accessory part. It is advised to the User, to inspect and ensure the original state of all other Vehicle parts.
4. We request you to bear in mind, that the Installed part can change the driving behaviour and/or the stability during driving or any other dynamic conditions.
5. If you have the appropriate tools and another person to assist you in the mounting, it will help.
6. To the maximum extent possible, our design use the current Mounting/Fitment of the Original Equipment, so that Installation of these accessories will not affect the Payload or Function of the Vehicle or the Part on which it is mounted to protect it
7. If any additional modifications are to be done, prior to the fitment of the accessories, it will be explicitly specified in the instruction sheets.