

Part Number: H-CB19-V2-17-02

Part Description: CRASH BAR FOR HONDA CB500X / 2019-2022

Installation / Parts List / Bill of Material for Mounting

NO.	Description	Quantity	Torque*(N-M)	Remarks**
1	Crash bar LH	1		
2	Crash bar RH	1		
3	Crash bar Low LH	1		
4	Crash bar Low RH	1		
5	Upper bracket	1		
6	Bracket arm	1		
7	Ring AL OD25xD12xL5	1		
8	Sliders Guards	2		
9	End cap	4		
10	Socket button head screw M6x15mm	2		Use Liquid Thread Locker
11	Socket head cap screw M8x40	2		Use Liquid Thread Locker
12	Socket head cap screw M10x40	2		Use Liquid Thread Locker
13	Socket head cap screw M10x170	1		Use Liquid Thread Locker
14	Socket head cap screw M10x1.25 L60	2		Use Liquid Thread Locker
15	Socket head cap screw M10x1.25 L65	1		Use Liquid Thread Locker
16	Socket head cap screw M10x1.25 L75	1		Use Liquid Thread Locker
17	Hex flange nut M10	1		
18	Hex flange nut M8	2		
19	Washer M6	2		
20	Washer M8	2		
21	Washer M10	3		
SRC Design uses Metric System of Measurement and all dimensions in Millimeters				
Recommended to use the Torque specified in the table				
Denotes Usage of Liquid Thread Locker in specified Locations				

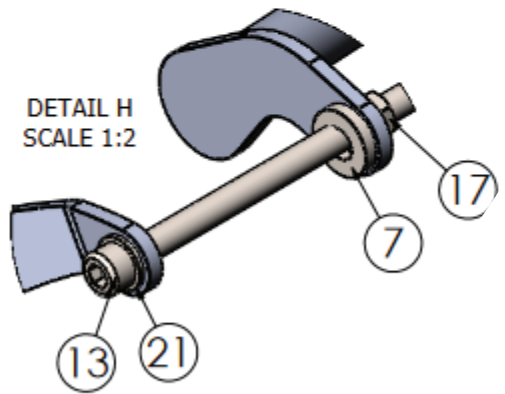
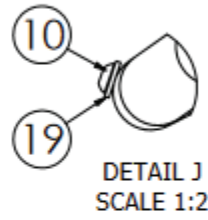
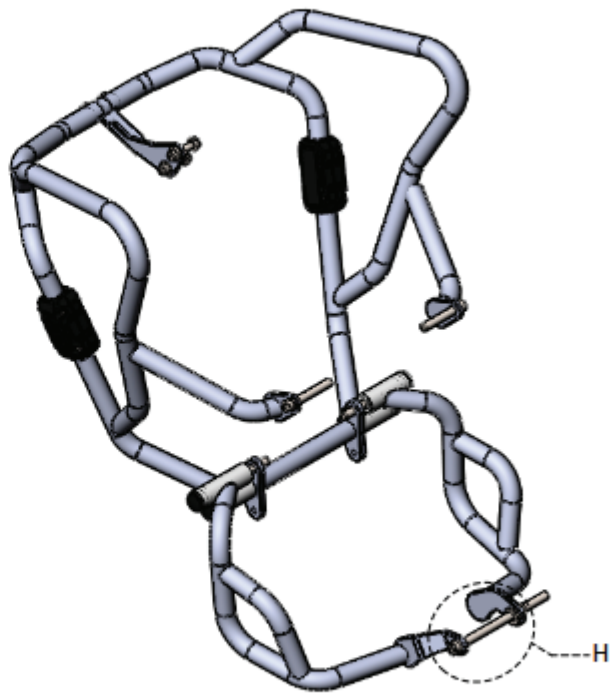
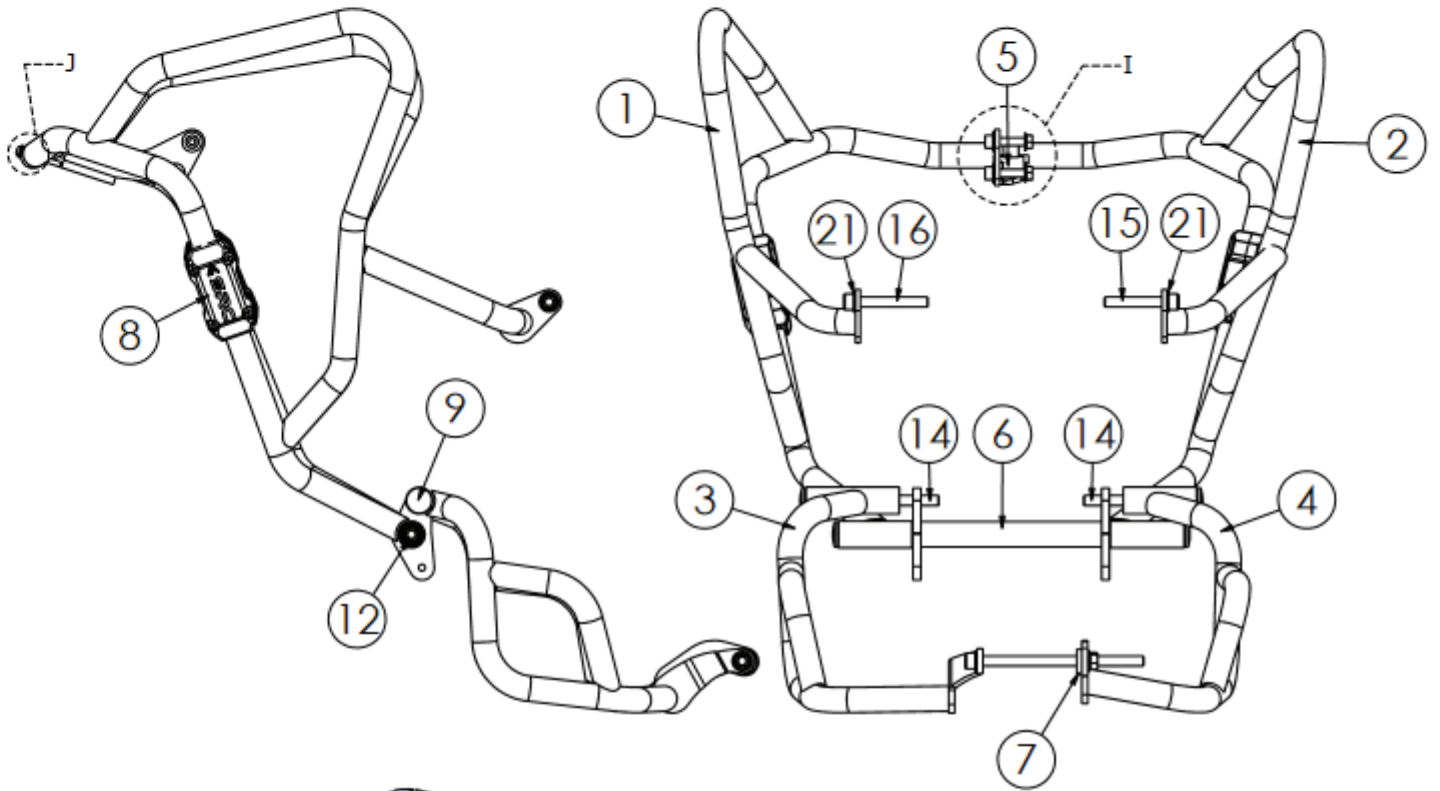

DETAIL I
SCALE 1:2

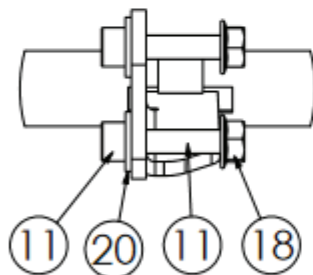

Torque Values to be used in Mounting Instructions

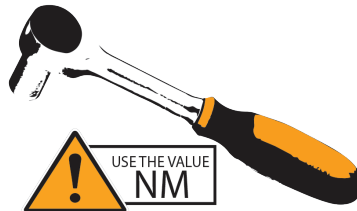

		M4		M5		M6		M8		M10		M12		M14		M16		M18	
code		(cs)	(Fo)	(cs)	(Fo)	(cs)	(Fo)	(cs)	(Fo)	(cs)	(Fo)	(cs)	(Fo)	(cs)	(Fo)	(cs)	(Fo)	(cs)	(Fo)
Inox	A2	2.6	—	5.1	—	8.7	—	21.2	—	42	—	73	—	118	—	180	—	258	—
steel	8.8	3	3,594	5	5,886	10	8,302	23	15,242	46	24,275	79	35,401	127	48,618	198	66,955	283	83,746
steel	10.9	4	5,279	8.1	8,645	14	12,194	34	22,388	67	35,655	116	51,995	187	71,408	291	98,340	402	119,454

Tensile load (Fo)
The force in newtons (N) which maintains pressure contact between assembled components
Tightening torque (Cs) [values are in N-m]

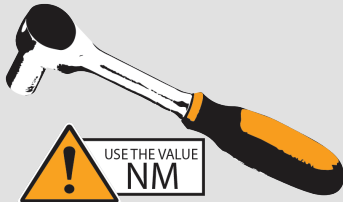

! symbol (NM), refer to the reference value given in the table above for use in the required operation And safe in operation and accuracy in inserting parts.



! The tool in the picture is (thread locked). When you see this mark, please insert the medicine to the point where the nut is to be inserted for the firmness and accuracy of the insertion work.



! The letter sign indicates the position of the motorcycle.



! This label indicates the sequence of steps.



This label will display various descriptions.



Please check and check again to make sure that all are inserted. Every piece and don't forget any step to be safe.

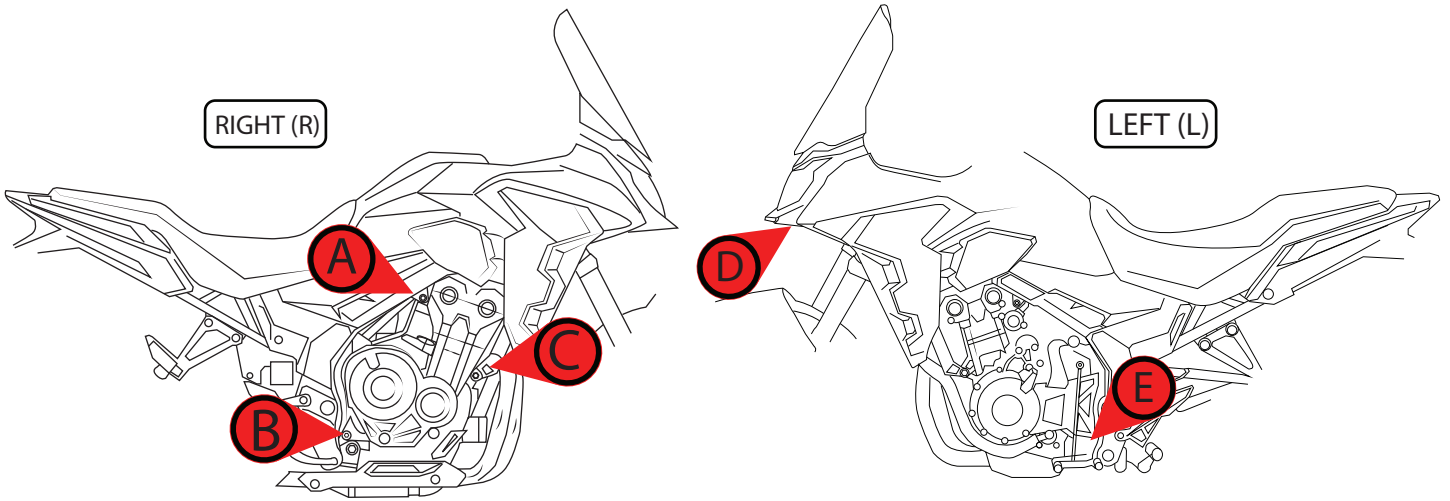

1

Remove both original nuts according to illustration

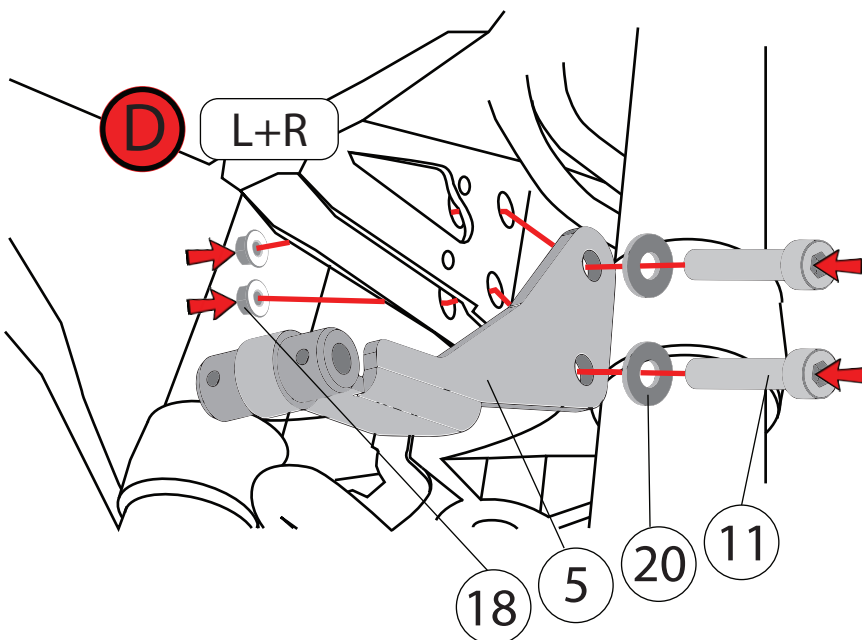
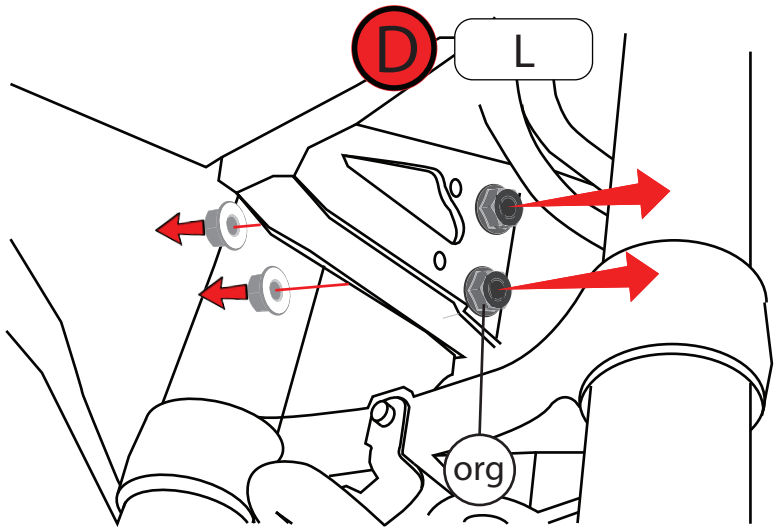

2

Bring Upper bracket and nut as shown in the illustration

3

Remove the original Bolt, both left - right.

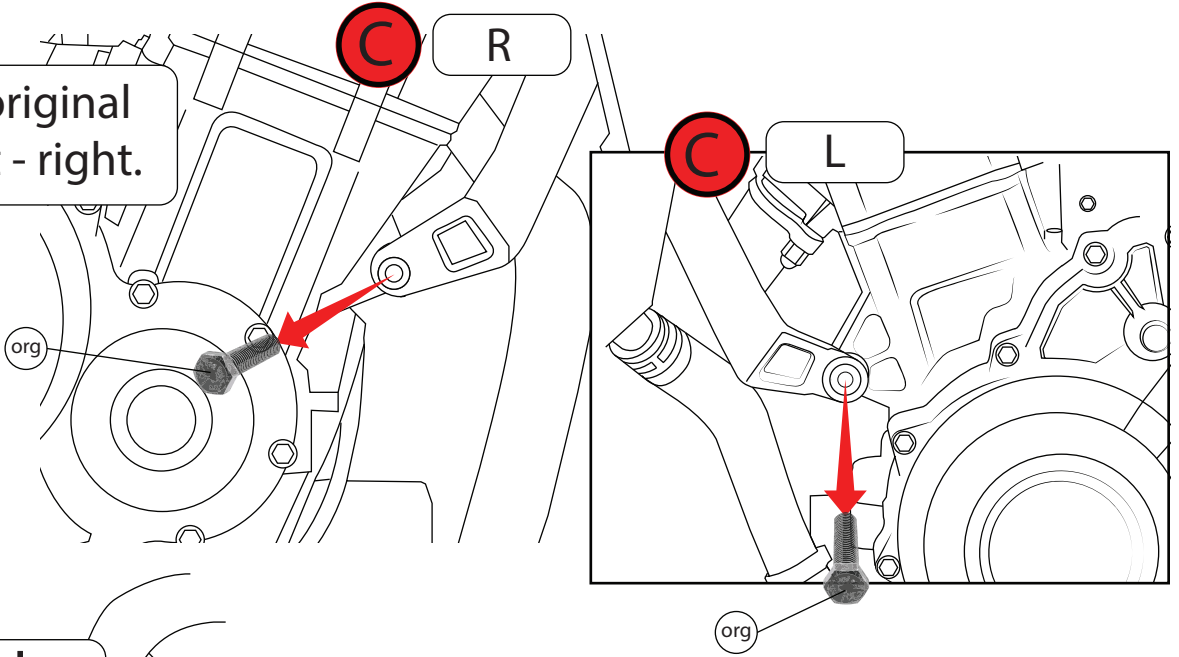

4

Left side
Remove the original Bolt and chain cover Shown in the illustration

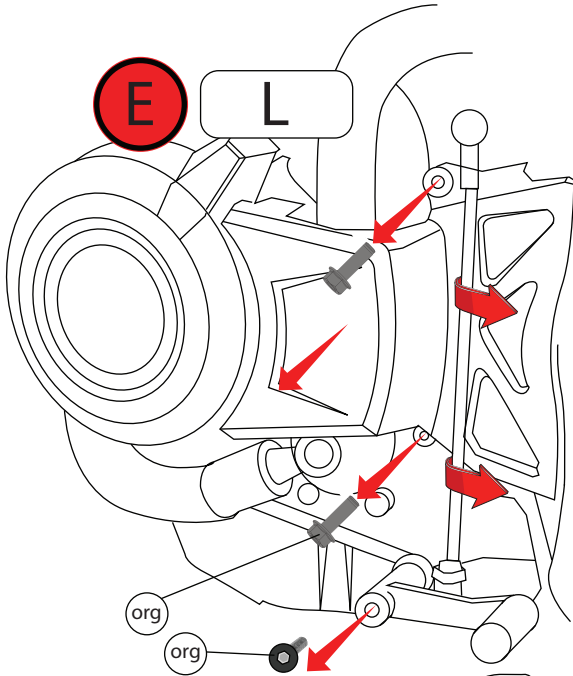

5

Remove the original Bolt, both left - right. Shown in the illustration

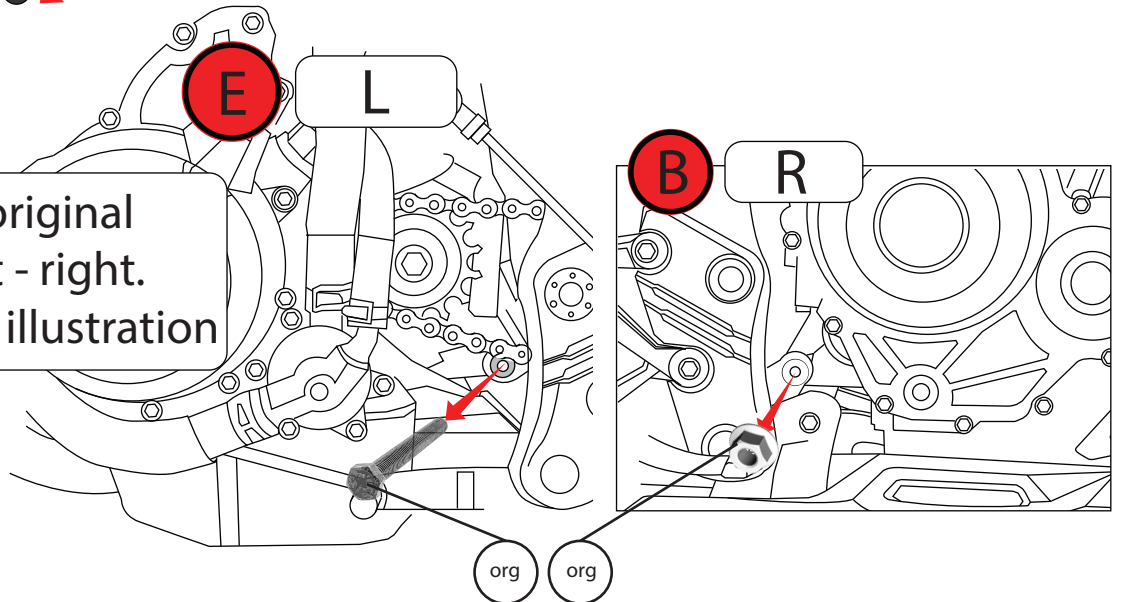

6

Install (LEFT)
CRASH BAR, Washer, Bolt
as illustrated

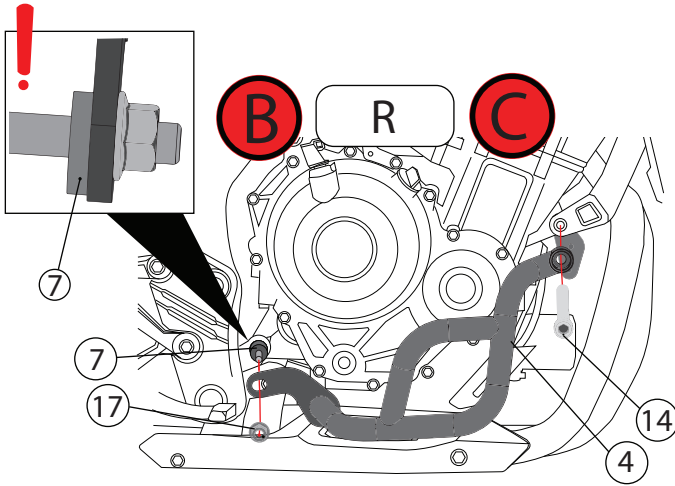
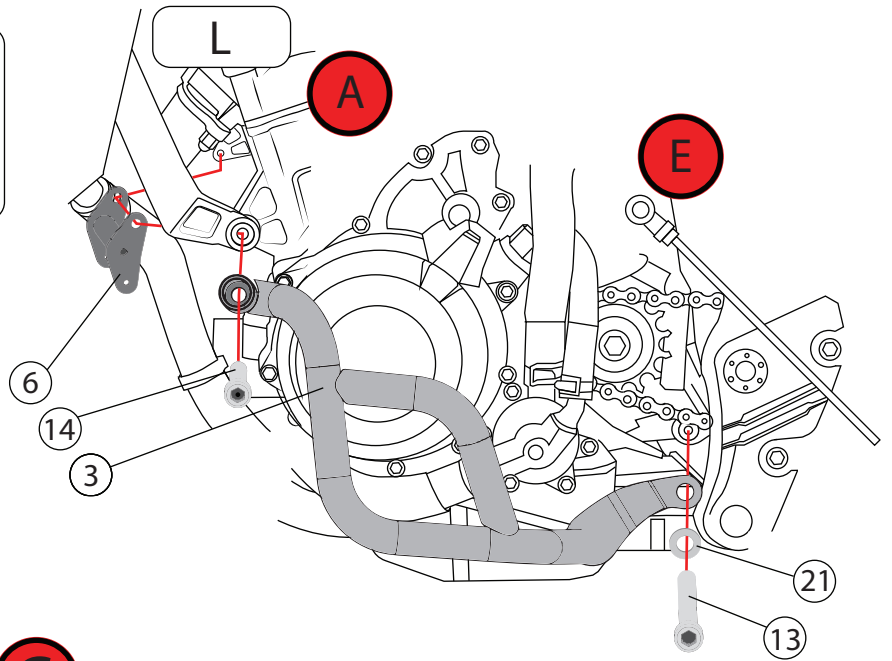

7

Install (RIGHT)
CRASH BAR, Washer, Bolt
as illustrated

8

Remove both original
.according to illustration
left - right.

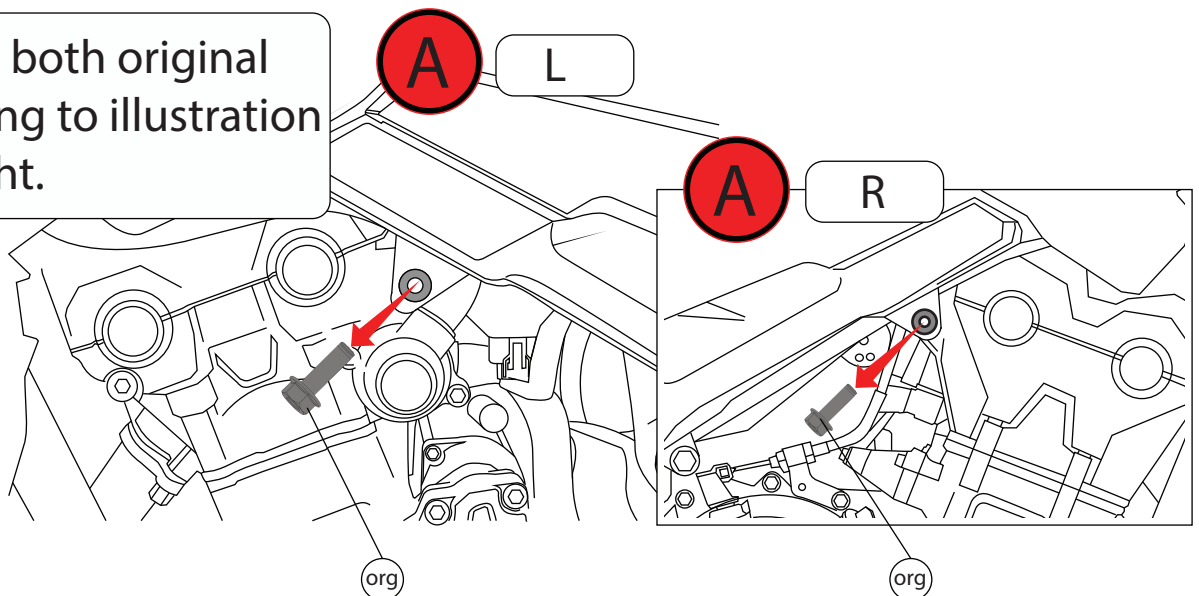

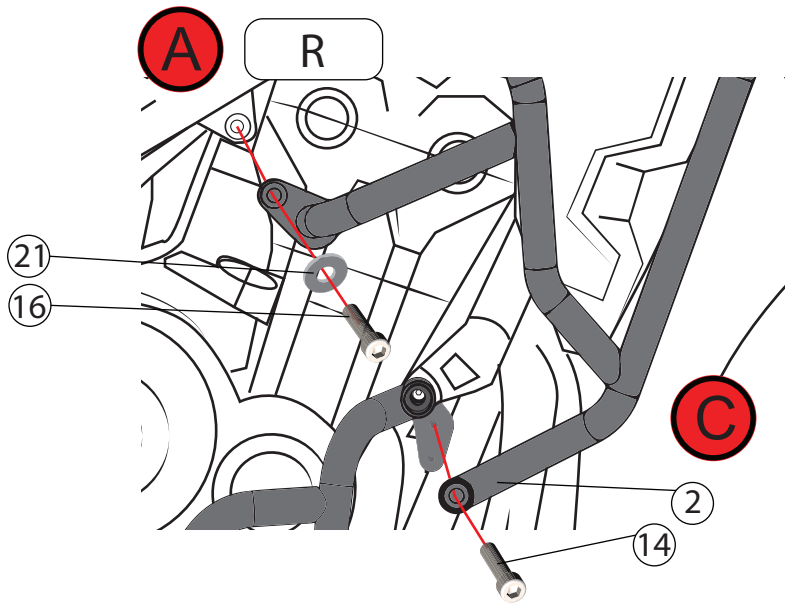

9

Install
CRASH BAR ,Washer ,Bolt
as illustrated

10

Install
washer and M6x15 screw
as illustrated.

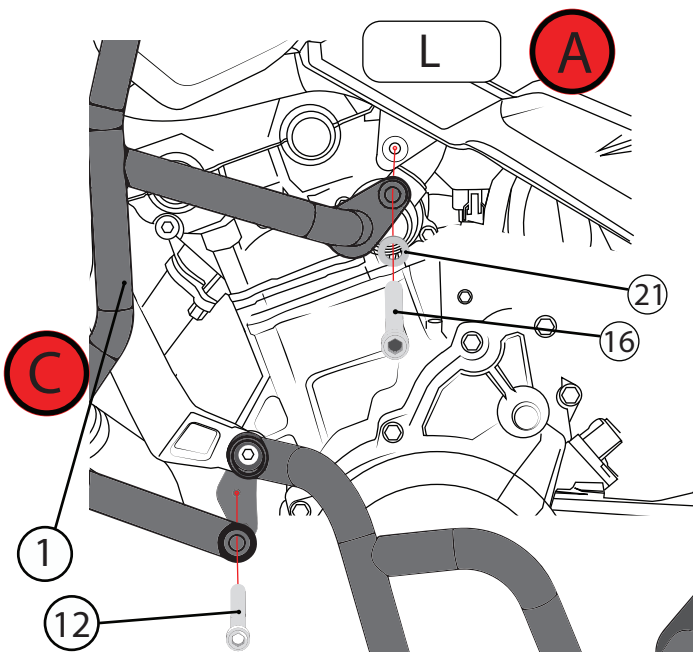
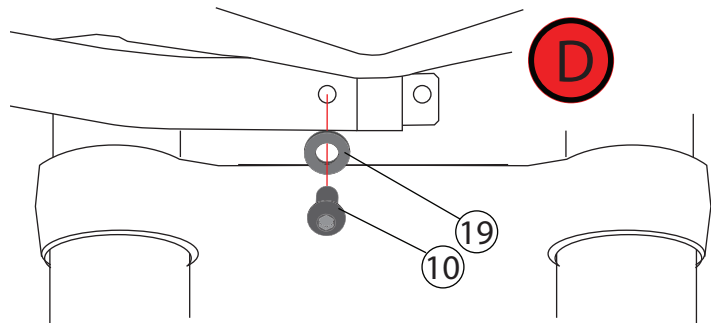

11

Install
CRASH BAR ,Washer ,Bolt
as illustrated

12

Install washer and M6x15 screw as illustrated.

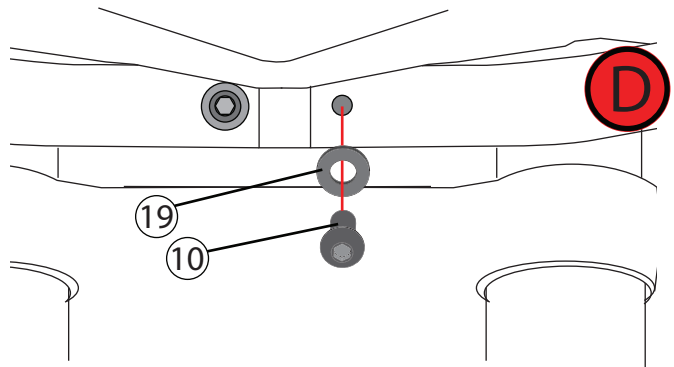

13

Left side
Install the original Bolt and chain cover Shown in the illustration

14

Install Sliders Guards on both the left-right sides as illustrated.

Install End cap left - right Shown in the illustration .

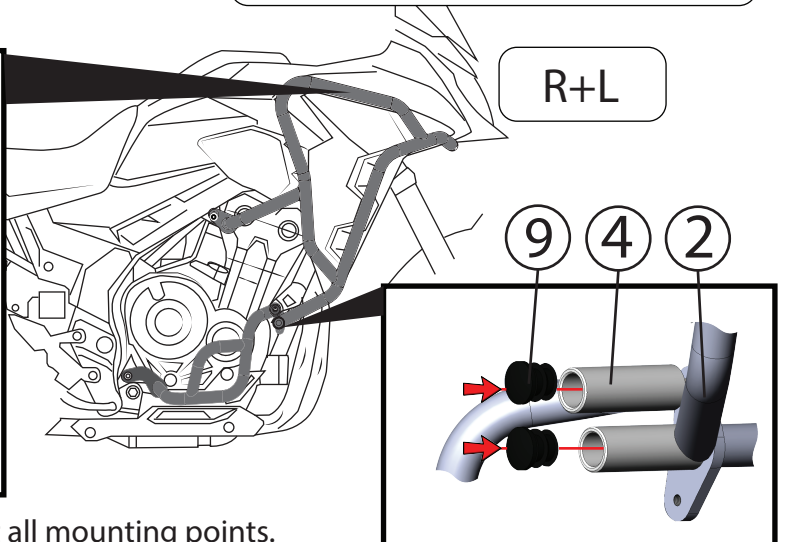
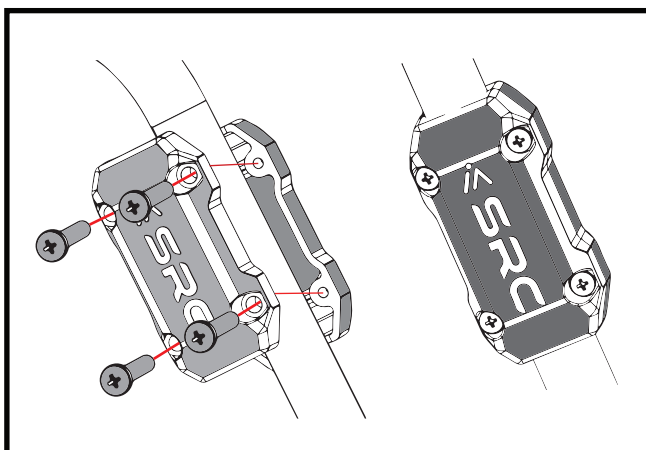
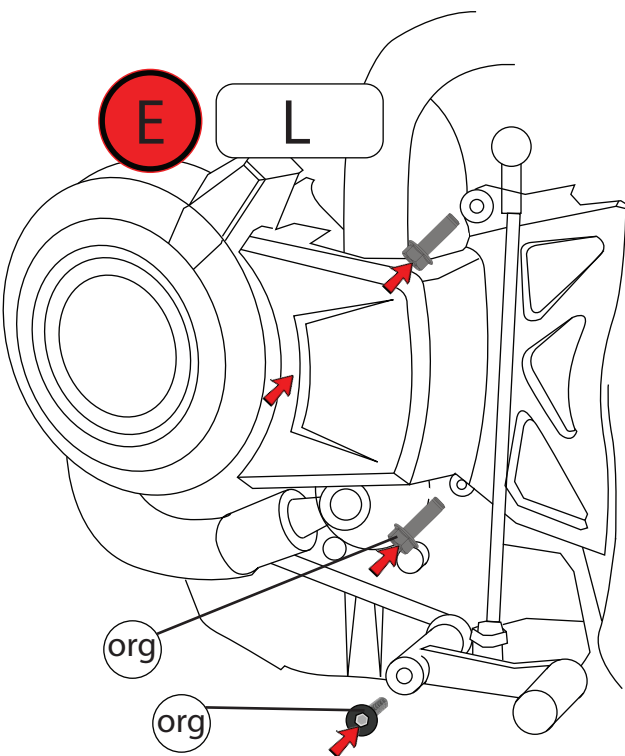

Please check the tightness of the bolts at all mounting points.

- (1.) We request you to pay attention to the Mounting Instructions in this document and follow the step-by-step procedures.
- (2.) This Mounting Instruction manual is a “Do It Yourself” (DIY) fitment manual of the Accessory part to the Vehicle. We have prepared this based on our experience and knowledge, related to the Vehicle, Part and its functional aspects
- (3.) SRC cannot guarantee the interchangeability of the parts to any other manufacturer’s accessory part. It is advised to the User, to inspect and ensure the original state of all other Vehicle parts.
- (4.) We request you to bear in mind, that the Installed part can change the driving behaviour and/or the stability during driving or any other dynamic conditions.
- (5.) If you have the appropriate tools and another person to assist you in the mounting, it will help.
- (6.) After Completion of the Mounting and before taking on a First ride, Ensure and Check all functions of the Vehicle. It is always advised to check loosening of the fasteners after the first 50 kilo meters of ride and at regular intervals.
- (7.) To the maximum extent possible, our design use the current Mounting/Fitment of the Original Equipment, so that Installation of these accessories will not affect the Payload or Function of the Vehicle or the Part on which it is mounted to protect it.
- (8.) If any additional modifications are to be done, prior to the fitment of the accessories, it will be explicitly specified in the instruction sheets

