

Scope of Supply/Bill of Material & Mounting Drawings

Part Number: H-AFT17-17-01-SL / H-AFT17-17-02

Part Description: Crash Bar – Honda CRF1000 – Africa Twin 2017 – 2019 (MT , DCT)

Installation / Parts List / Bill of Material for Mounting

NO.	Description	Quantity	Torque * (N-M)	Remarks **	Check List
1	Crash Bar-LH	1			
2	Crash Bar-RH	1			
3	Orientation Bracket-LH	1			
4	Orientation Bracket-RH	1			
5	Strap Plat RH	1			
6	Bush 20 X 10	1			
7	Upper Bracket	1			
8	Pin Bracket	1			
9	Slider Guard	2			
10	Rubber Support	1		Misumi	
11	Screw M6 X 15	2	15	Use Liquid Thread Locker	
12	Screw M8 X 20	2	35	Use Liquid Thread Locker	
13	Screw M10 X 55	2	65	Use Liquid Thread Locker	
14	Screw M8 X 115	1	35	Use Liquid Thread Locker	
15	Screw M10 X 115	1	65	Use Liquid Thread Locker	
16	Bolt M8 X 30	2	35	Use Liquid Thread Locker	
17	Bolt M10 X 20	1	35	Use Liquid Thread Locker	
18	Nut M 10	4	65	Use Liquid Thread Locker	
19	Nut M8	2	65	Use Liquid Thread Locker	
20	Screw M10 x 70	1	35	Use Liquid Thread Locker	
21	Screw M10 x 80	1			
22	Washer M6	2			
23	Washer M8	3			
24	Washer M10	5			
SRC Design uses Metric System of Measurement and all dimensions in Millimeters					
* Recommended to use the Torque specified in the table					
** Denotes Usage of Liquid Thread Locker in specified Locations					

Pictorial View of Assembly Drawing

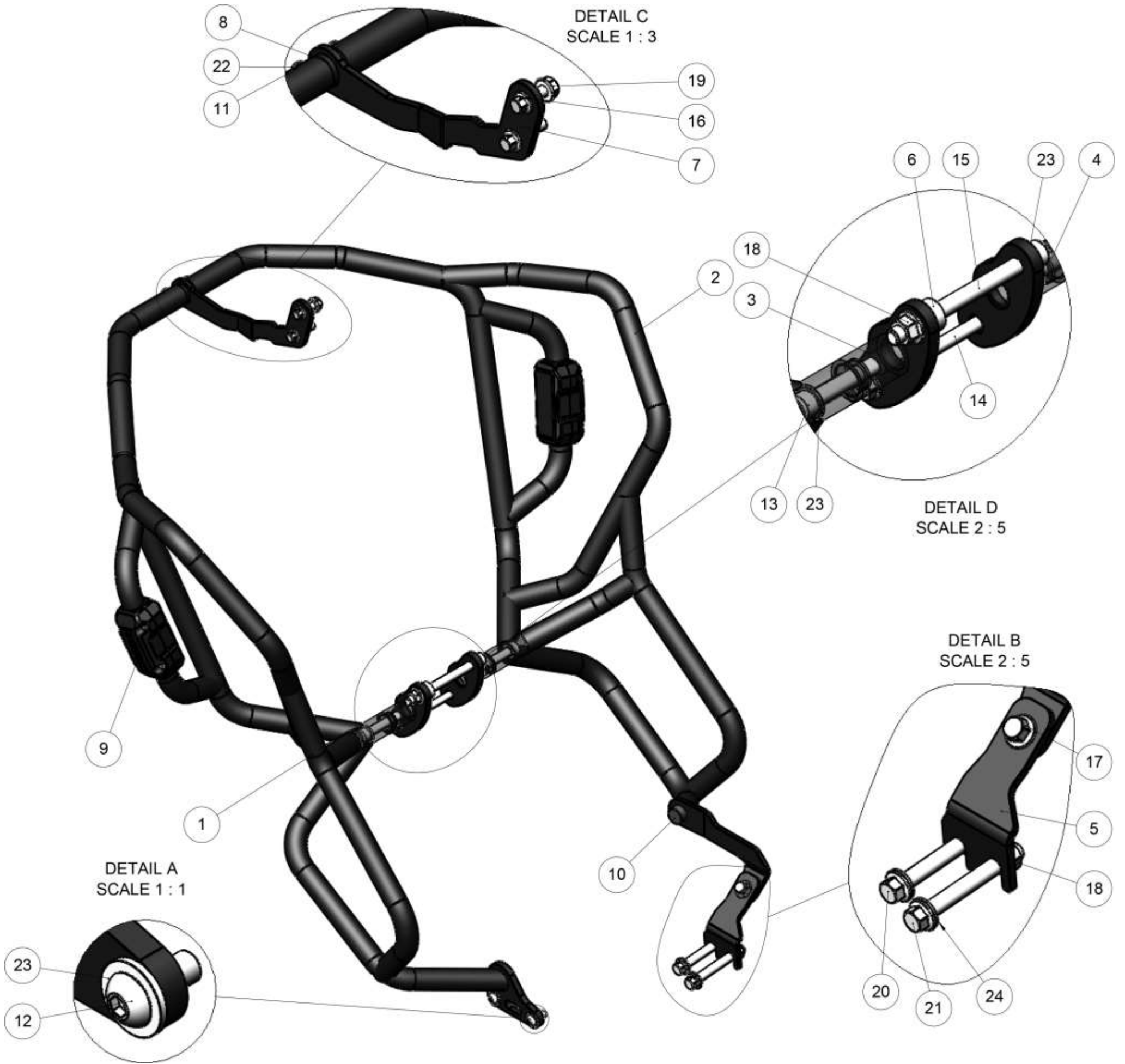

Mounting Installation

Remove the Original Engine Guard and intake from the original frame at side Right.

Remove the Original screws and Nuts from the original frame at front.

Mounting the Bracket RH & LH and slip-in Bush A1 -1 off, washer -2 off, screw – 2 off, at hold side left. (Red color ad shown drawing) and slip-in the Bracket and Nut -2 off, and secure the threads in the Motorbike. (As shown)

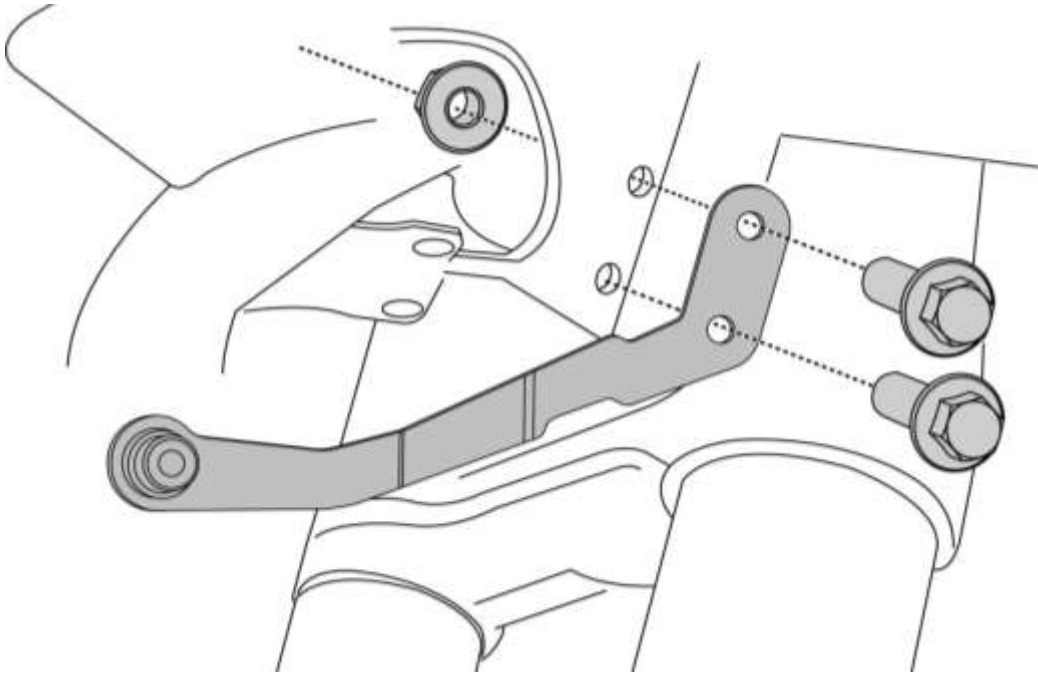

Orientation and Mounting of Upper Bracket (Detail 7) and Refer to Detail “C” in the Pictorial Drawing
(Before. no need to tighten the screws.)

Orientation and Mounting of Lateral Side Bracket - RH (Detail 5) and Refer to Detail “B” in the Pictorial Drawing
(Before. no need to tighten the screws.)

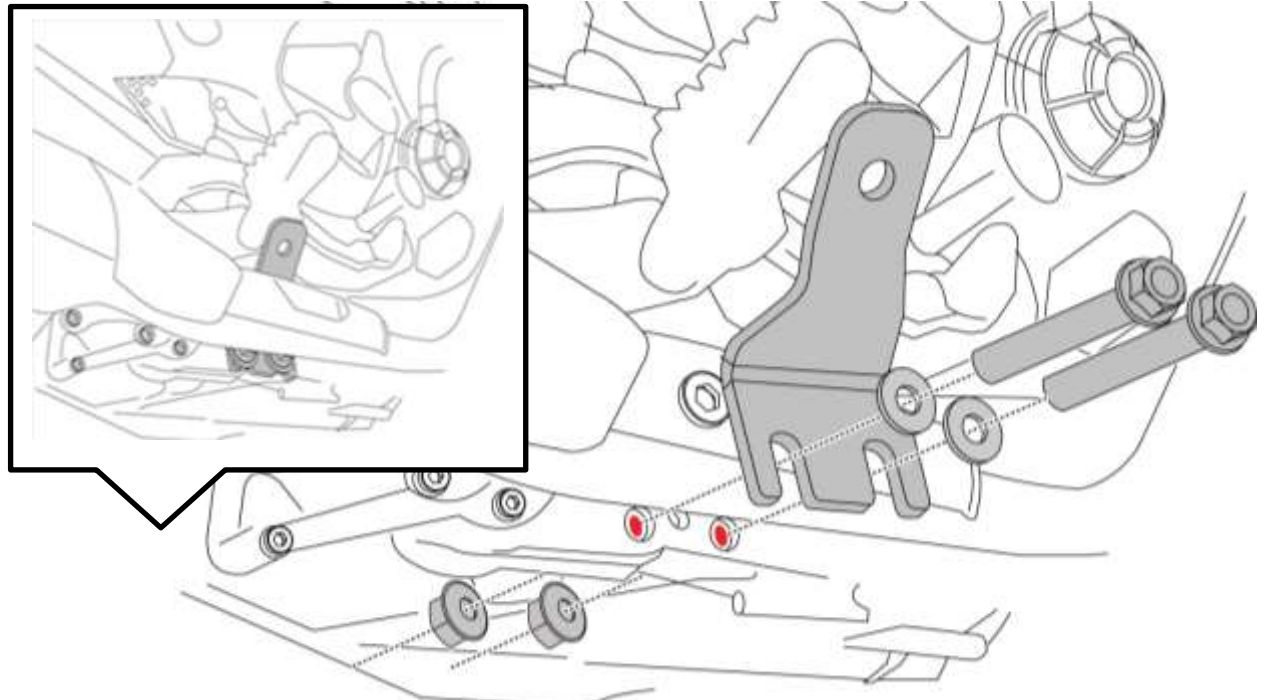

Crash Bar – LH in “As Is Mounted Condition”
(Before. no need to tighten the screws.)

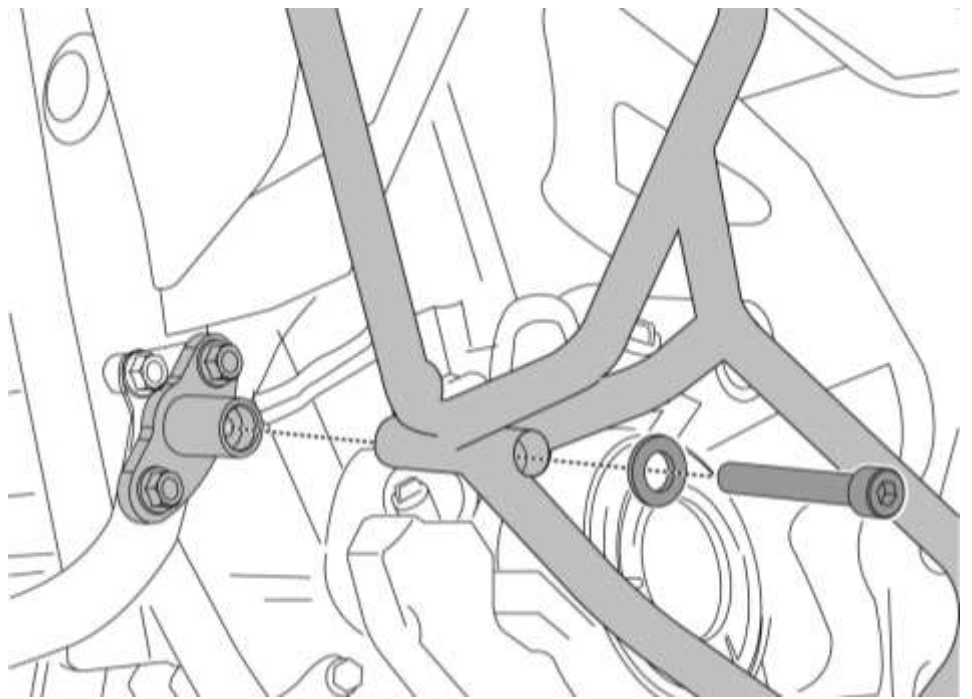
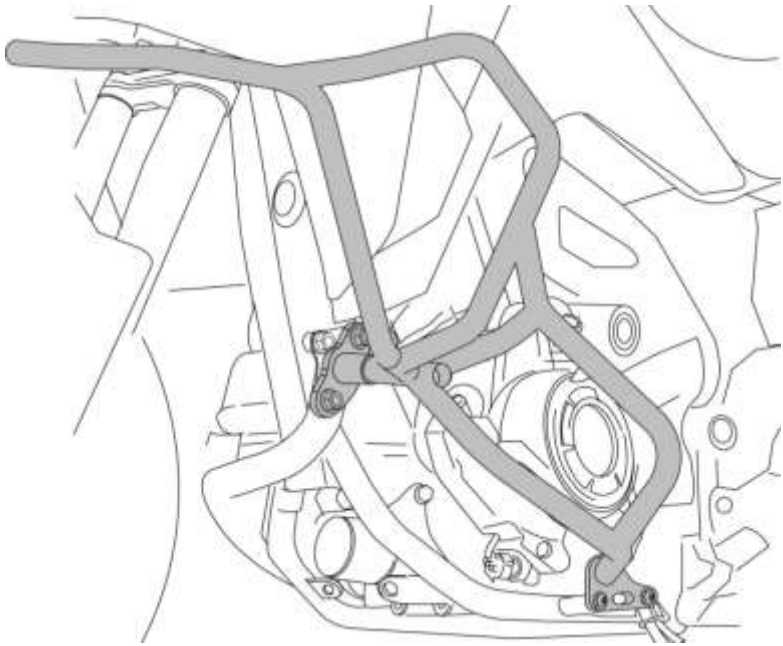

Crash Bar – LH As Is Mounted Condition

**Orient the Top End of the Crash Bar – LH to the Pin Bracket attached to the Top Bracket
(Before. no need to tighten the screws.)**

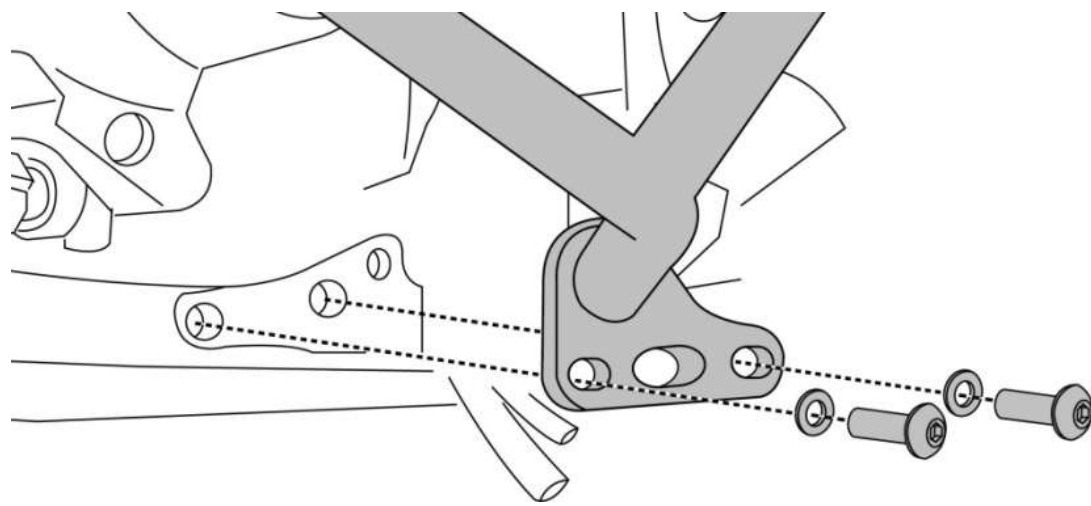
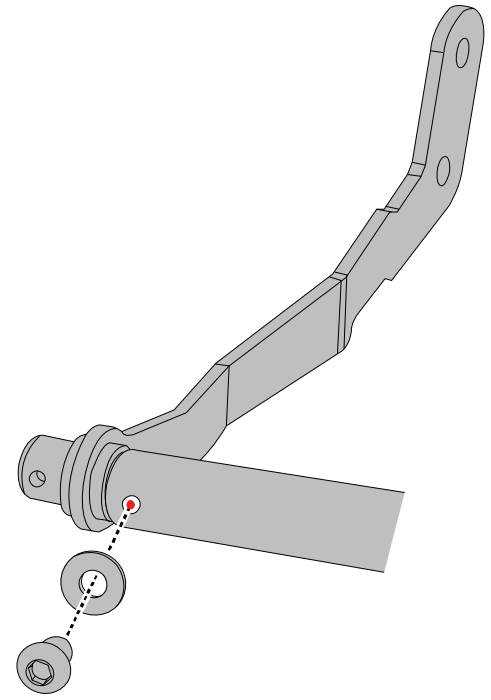

**Lateral Side Bracket – RH in “As Is Mounted Condition”
(Before. no need to tighten the screws.)**

**Orient and Mount the Crash Bar – RH (Detail 2)
(Before. no need to tighten the screws.)**

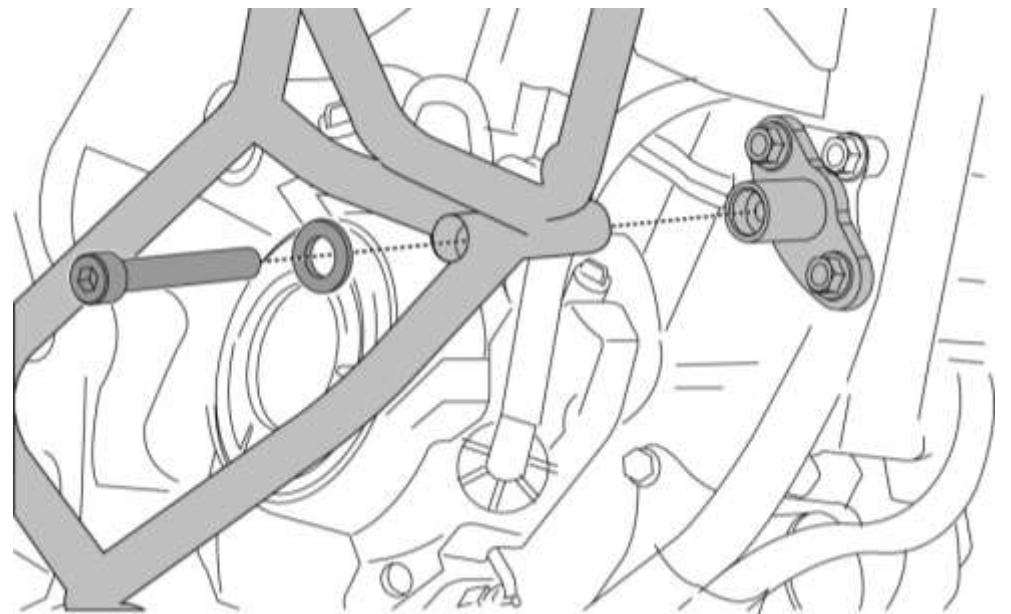

Crash Bar – RH “As Is Mounted Condition”

Orient the Top End of the Crash Bar – RH to the Pin Bracket attached to the Top Bracket

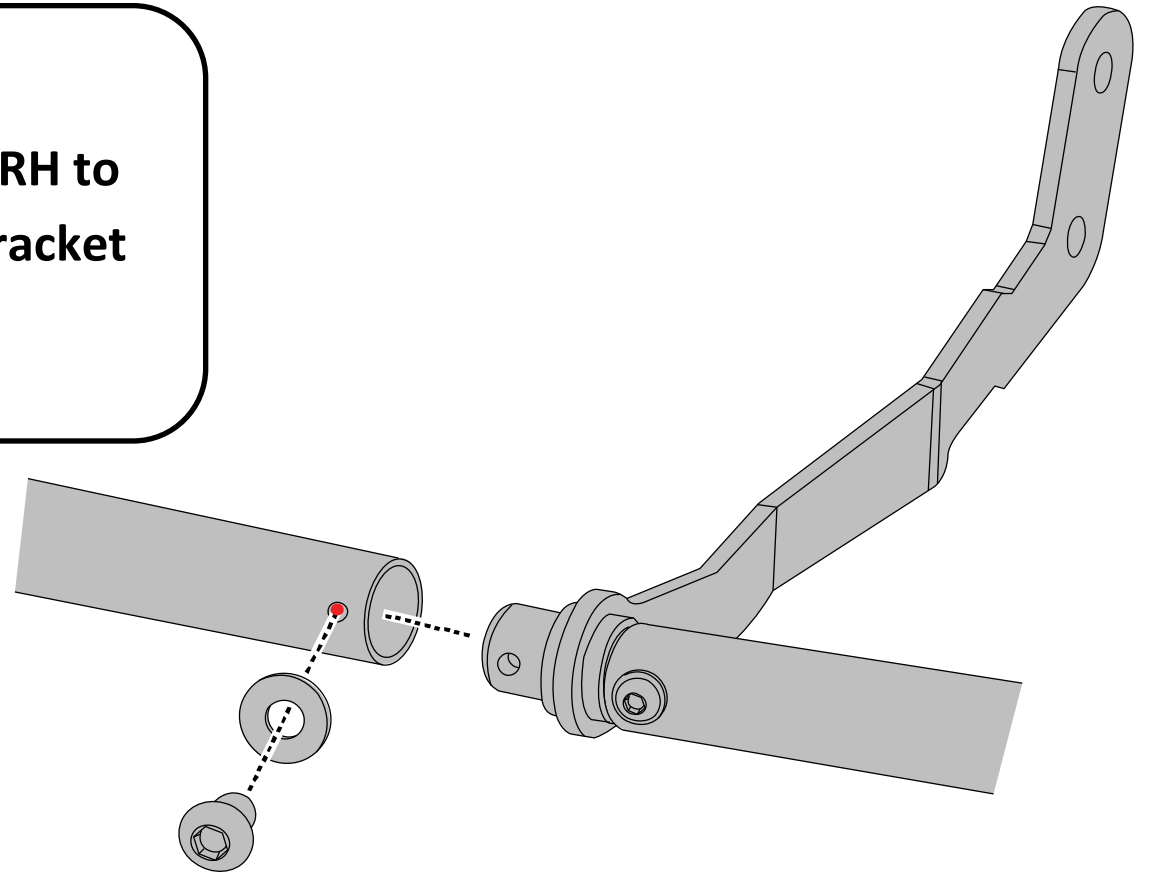

Orient and Mount the Crash Bar – LH (Detail 1)

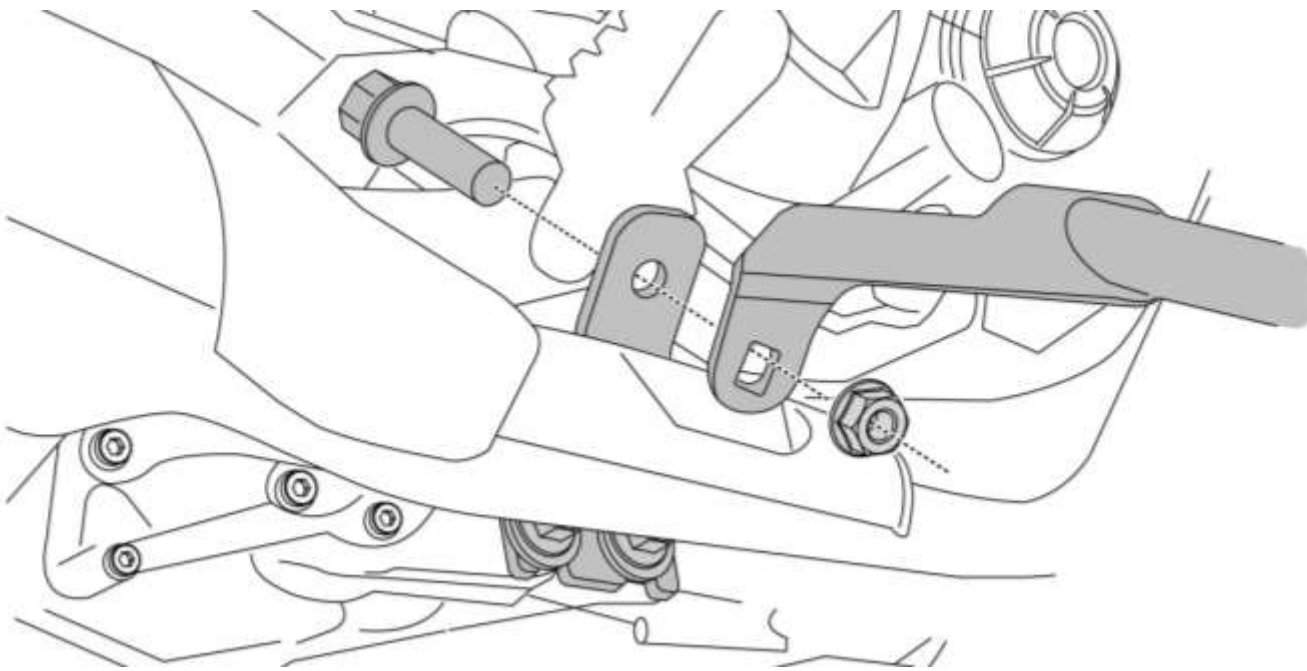

Assemble the Slider Bar on each of the Crash Bar as shown.

Use the Slider Bar as the Virtual Orientation and looking from the front side of the Motorbike, make one final Positioning and Alignment of the Crash bars.

Ensure mounting symmetry of the Slider Bars visually (it must not be offset or shifted visually when seen from the front side and back side).

All Screws can be fully tightened to the torque, as specified in the BOM table.

The installation is completed with this step.

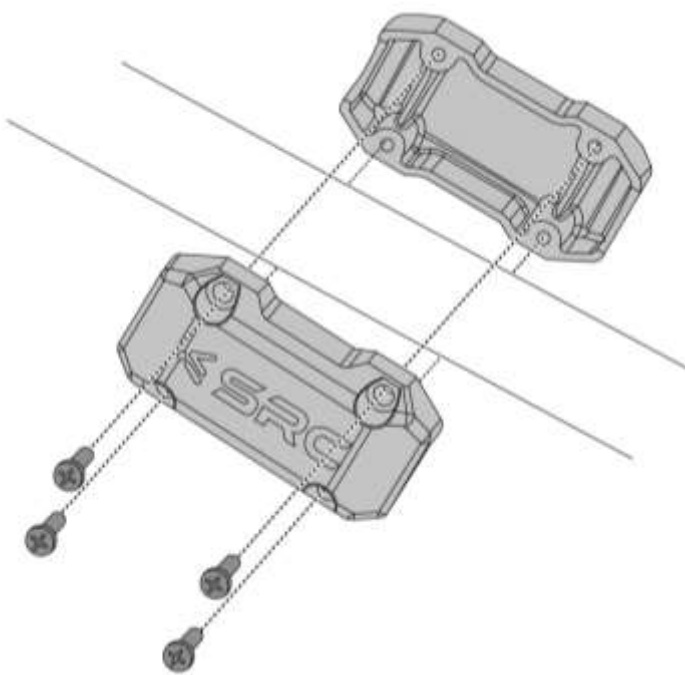

General Information

1. We request you to pay attention to the Mounting Instructions in this document and follow the step-by-step procedures.
2. This Mounting Instruction manual is a “Do It Yourself” (DIY) fitment manual of the Accessory part to the Vehicle. We have prepared this based on our experience and knowledge, related to the Vehicle, Part and its functional aspects.
3. SRC cannot guarantee the interchangeability of the parts to any other manufacturer’s accessory part. It is advised to the User, to inspect and ensure the original state of all other Vehicle parts.
4. We request you to bear in mind, that the Installed part can change the driving behaviour and/or the stability during driving or any other dynamic conditions.
5. If you have the appropriate tools and another person to assist you in the mounting, it will help.
6. To the maximum extent possible, our design use the current Mounting/Fitment of the Original Equipment, so that Installation of these accessories will not affect the Payload or Function of the Vehicle or the Part on which it is mounted to protect it
7. If any additional modifications are to be done, prior to the fitment of the accessories, it will be explicitly specified in the instruction sheets.