

## Scope of Supply/Bill of Material & Mounting Drawings

Part Number: H-CB500X-09-01-AL / H-CB500X-09-02-AL

Part Description: Engine Guard–HONDA CB500 X

Applicable to Finished colour versions of Silver and Black

### Installation / Parts List / Bill of Material for Mounting

NO.	Description	Quantity	Torque * (N-M)	Remarks **
1	Skid Plate	1		
2	Bracket A	1		
3	Bracket B	1		
4	Bracket C	1		
5	Bracket D	1		
6	Bush	2		
7	Taper Ring	8		
8	Screw M6x15	8	9 - 10	Use Liquid Thread Locker
SRC Design uses Metric System of Measurement and all dimensions in Millimeters				
* Recommended to use the Torque specified in the table				
** Denotes Usage of Liquid Thread Locker in specified Locations				

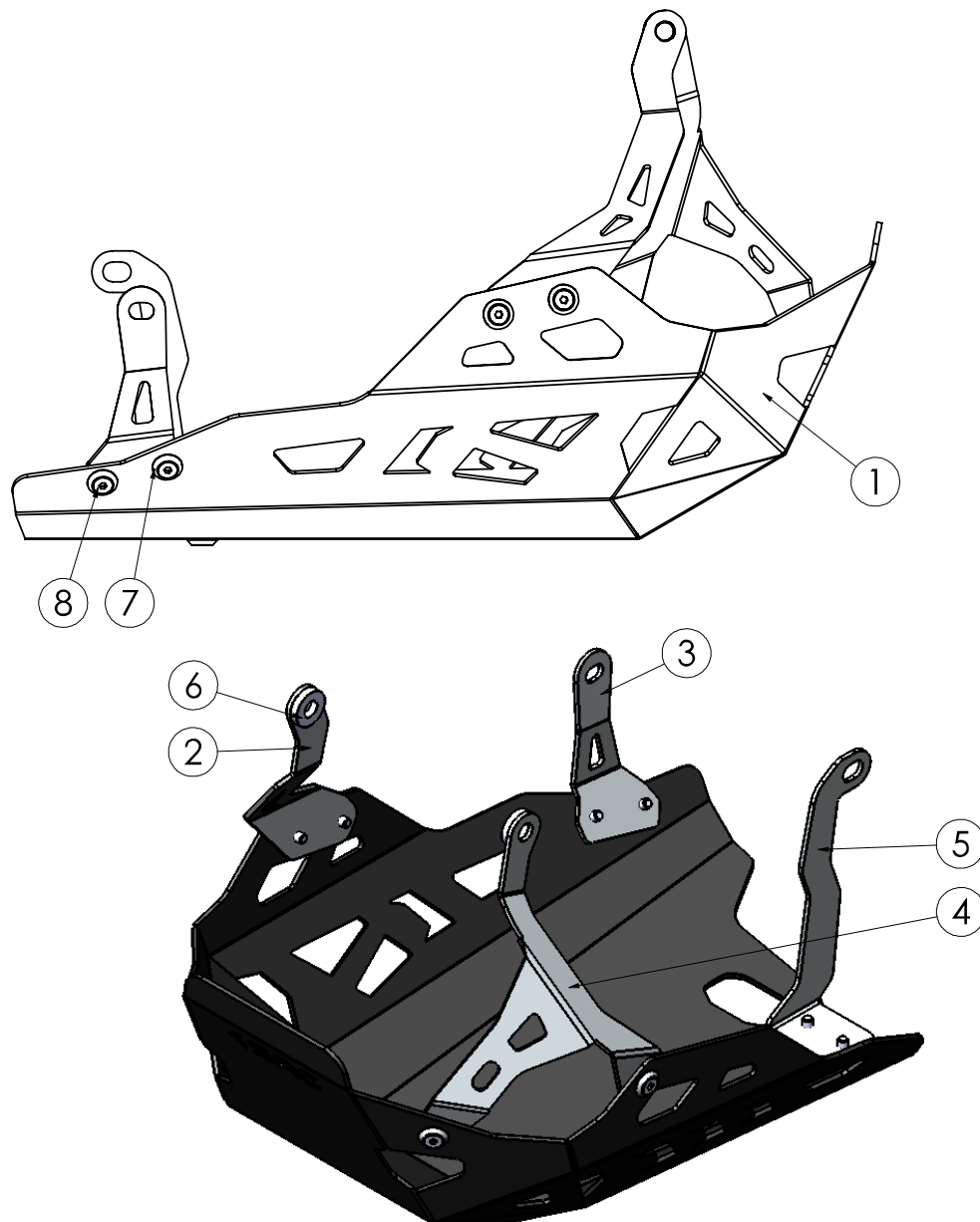

MOUNTING DRAWINGS

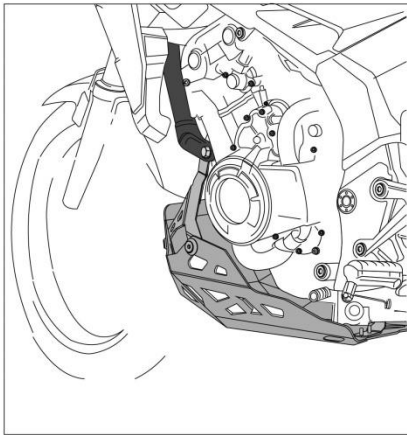
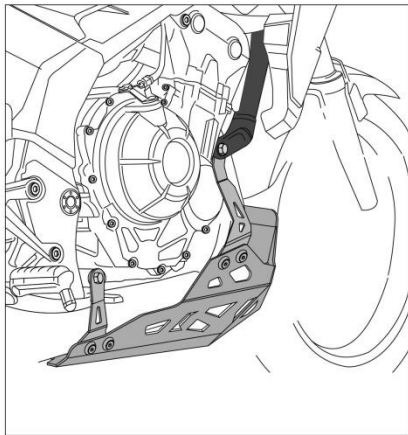
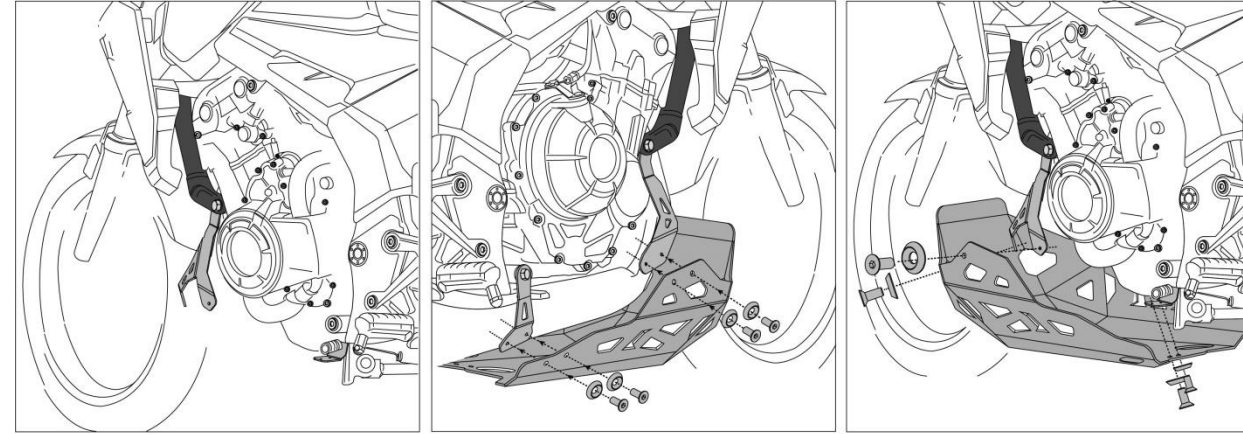
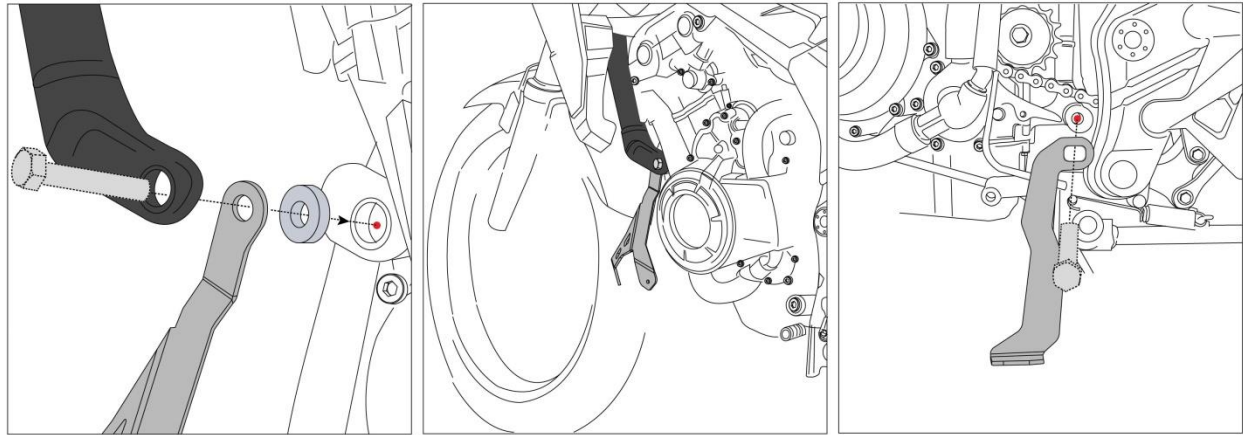
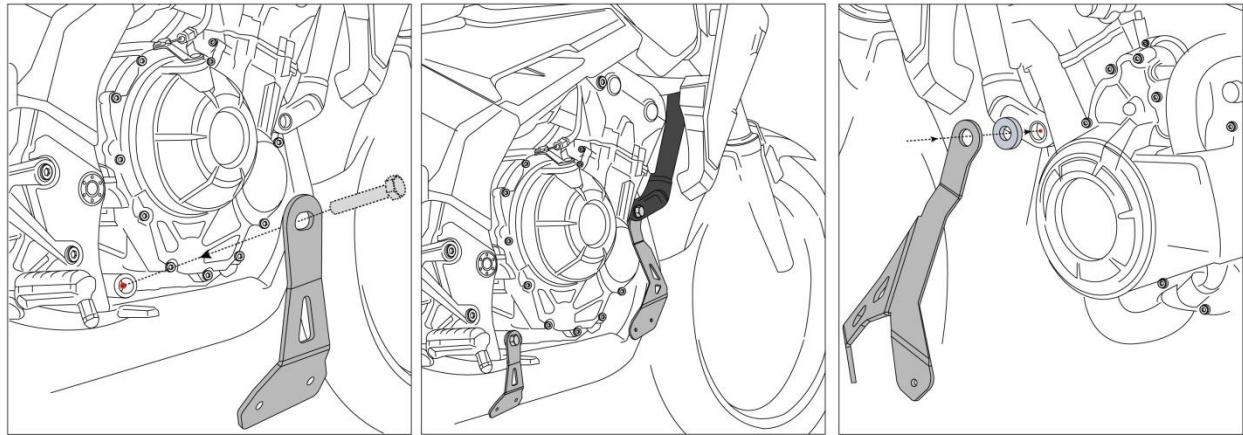
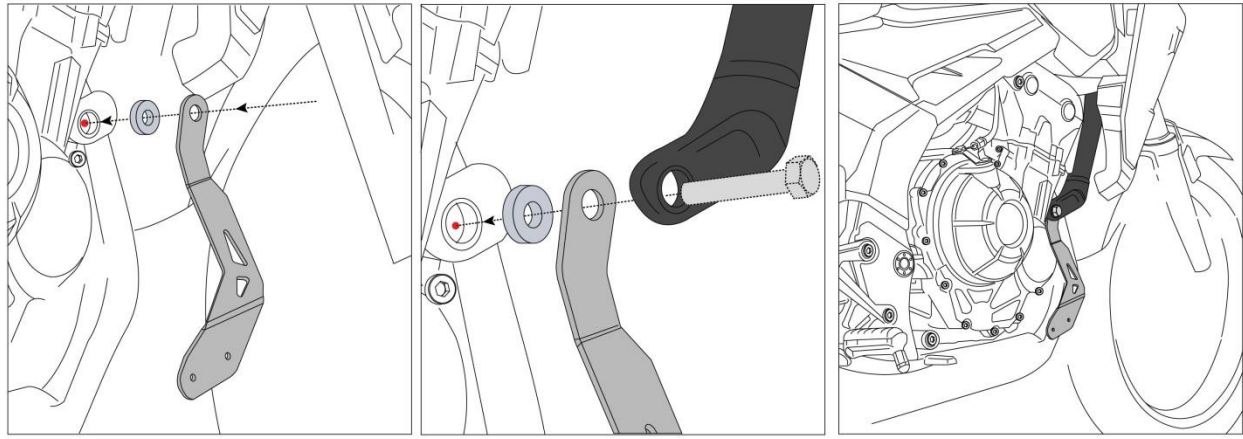



## Mounting Instructions

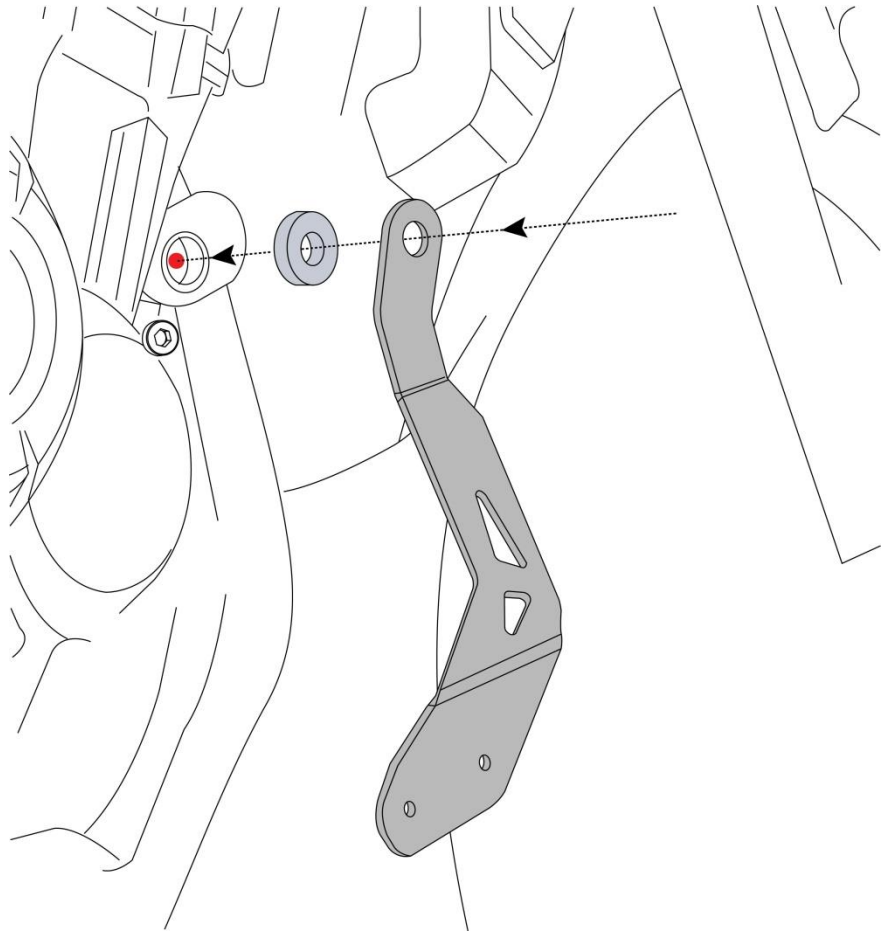

### Step 1:

#### Mounting of Bracket "A" (2) (On the Right hand side)

Unscrew the M10 Bolt (OE Part) from the hole (Shown in Red colour in the drawing below)

(which connects the Tubular frame to the Engine housing) and Slip-in the Bush (6) and Orient the Bracket "A" (2) in-line to this mounting hole.

The drawing to the right shows the Tubular frame, Mounting hole and the train of parts which has to be used for Mounting the Bracket "A".

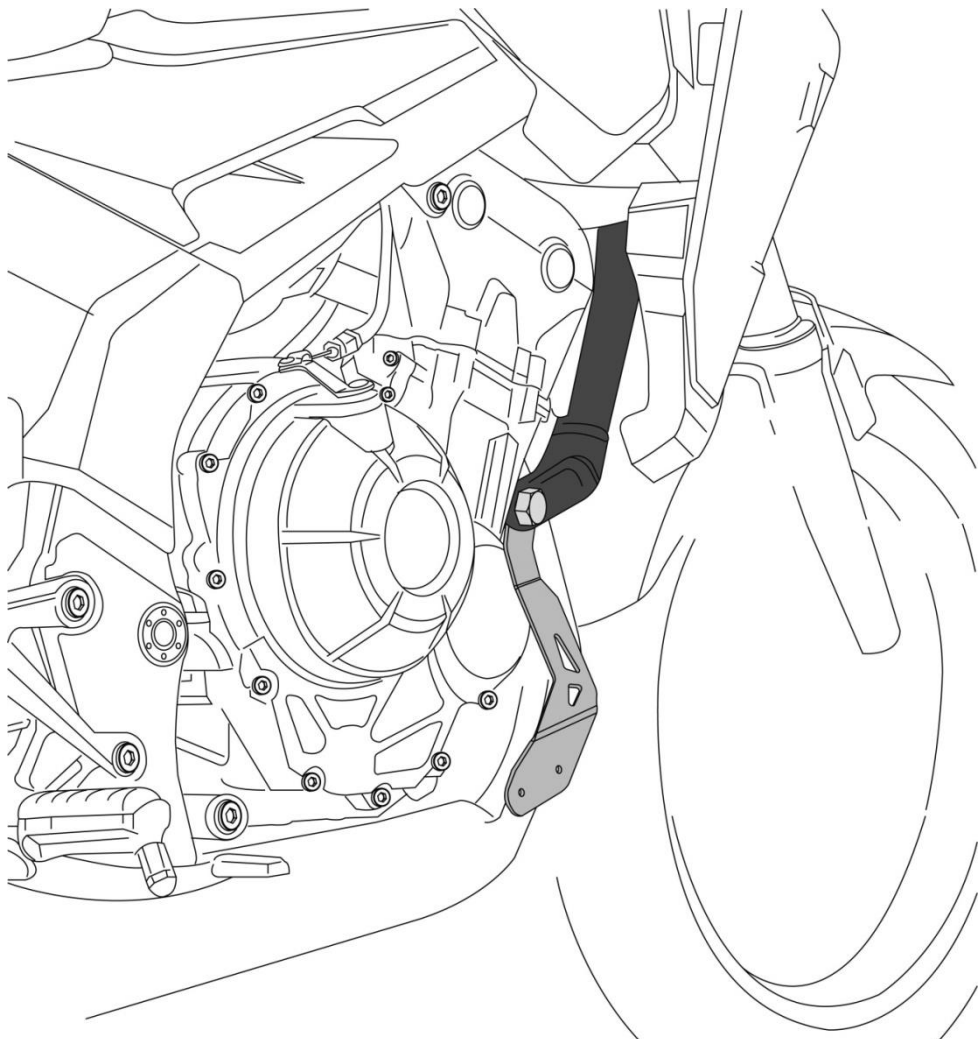
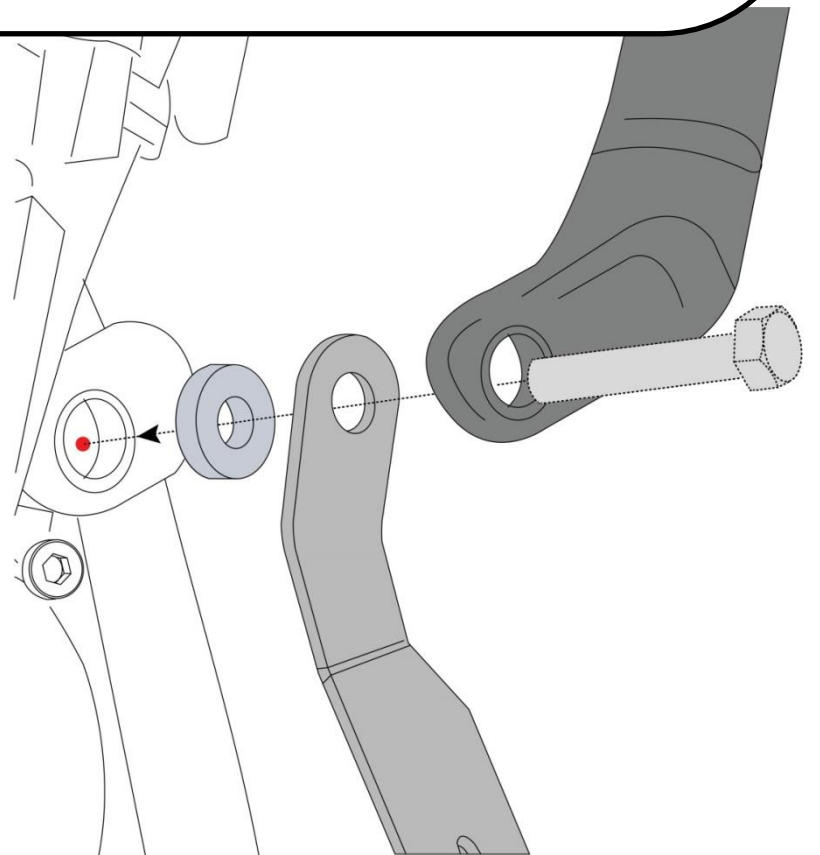

Secure the threads as shown, but not tighten it fully.

Bracket "A" in "As is mounted condition", is shown below.

**Step 2:**

**Mounting of Bracket "B" (3)**

**Orient the Bracket "B" to the Mounting hole (as shown in Red) and use the M10 bolt (OE Part in the Motorbike) and secure the threads.**

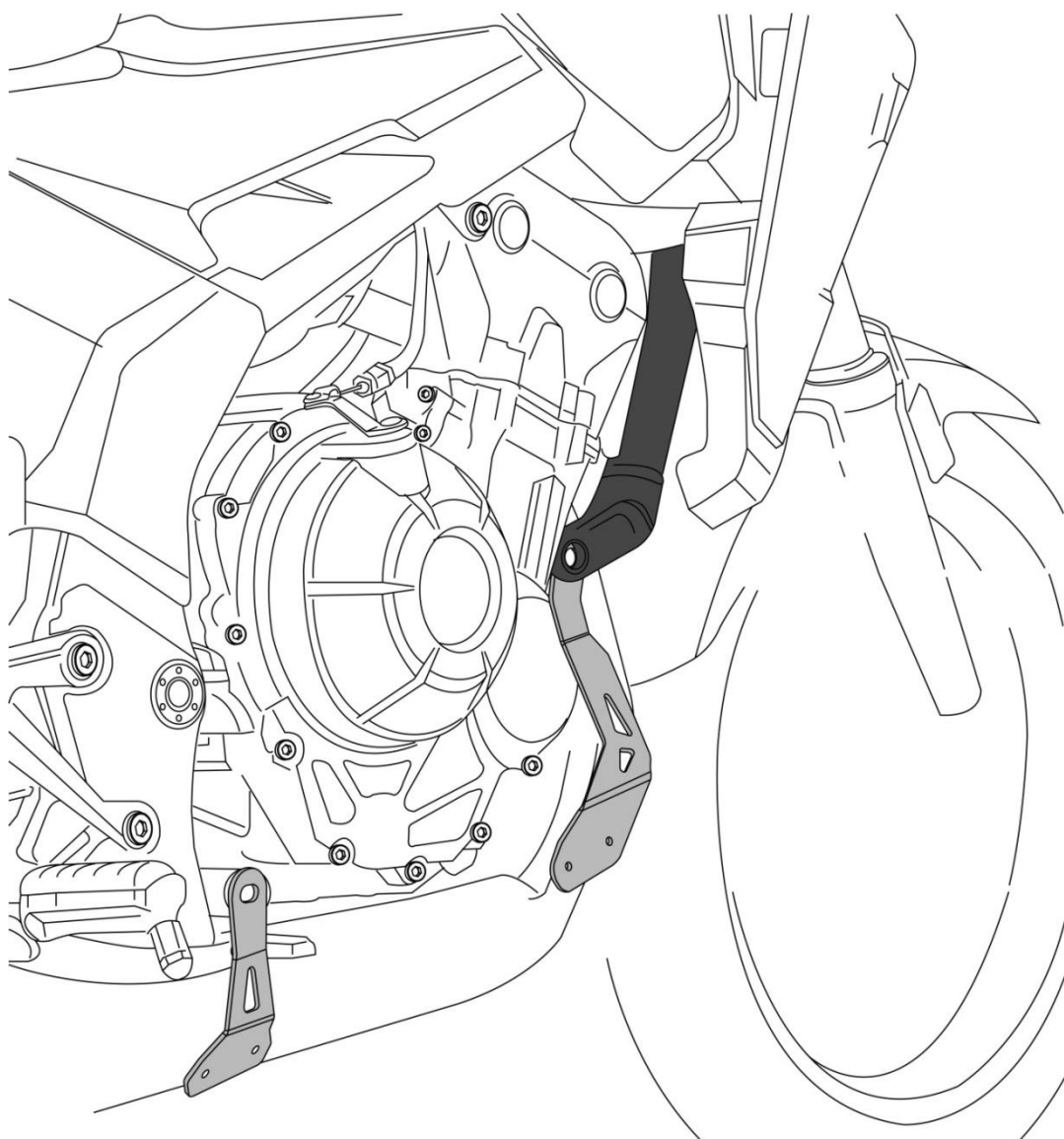
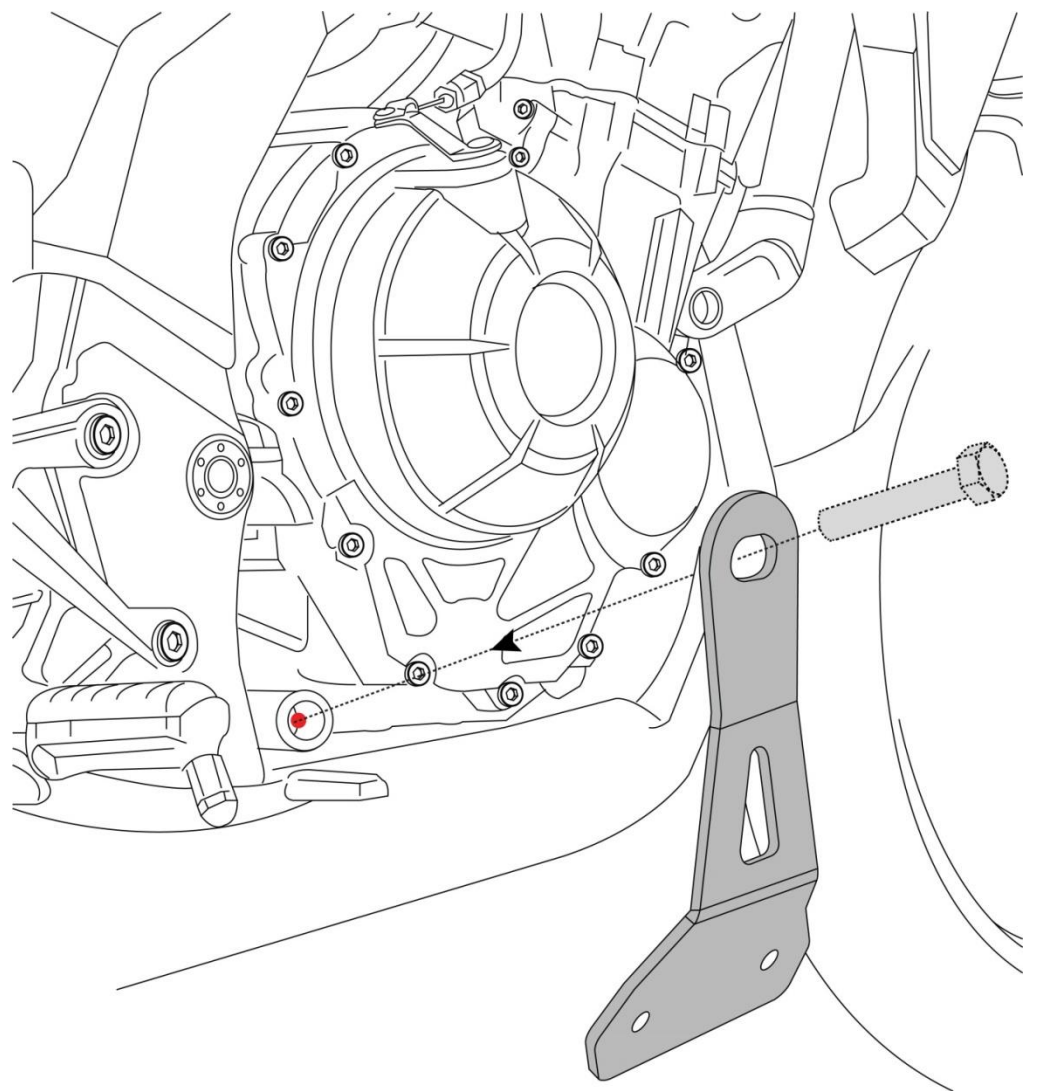

**Do not fully tighten the Bolt to the Mounting hole threads.**

**Drawing view to the left shows the Right hand Side brackets "A" and "B" in "As is Mounted Condition".**



**Step 3:**

**Mounting of Bracket "C" (4) (On the Left hand Side)**

**Unscrew the M10 Bolt (OE bolt in the Motorbike) from the hole (Shown in Red) (which connects the Tubular frame to the Engine housing) and Slip-in the Bush(6) and Orient the Bracket "C" (4) in-line with the mounting hole.**

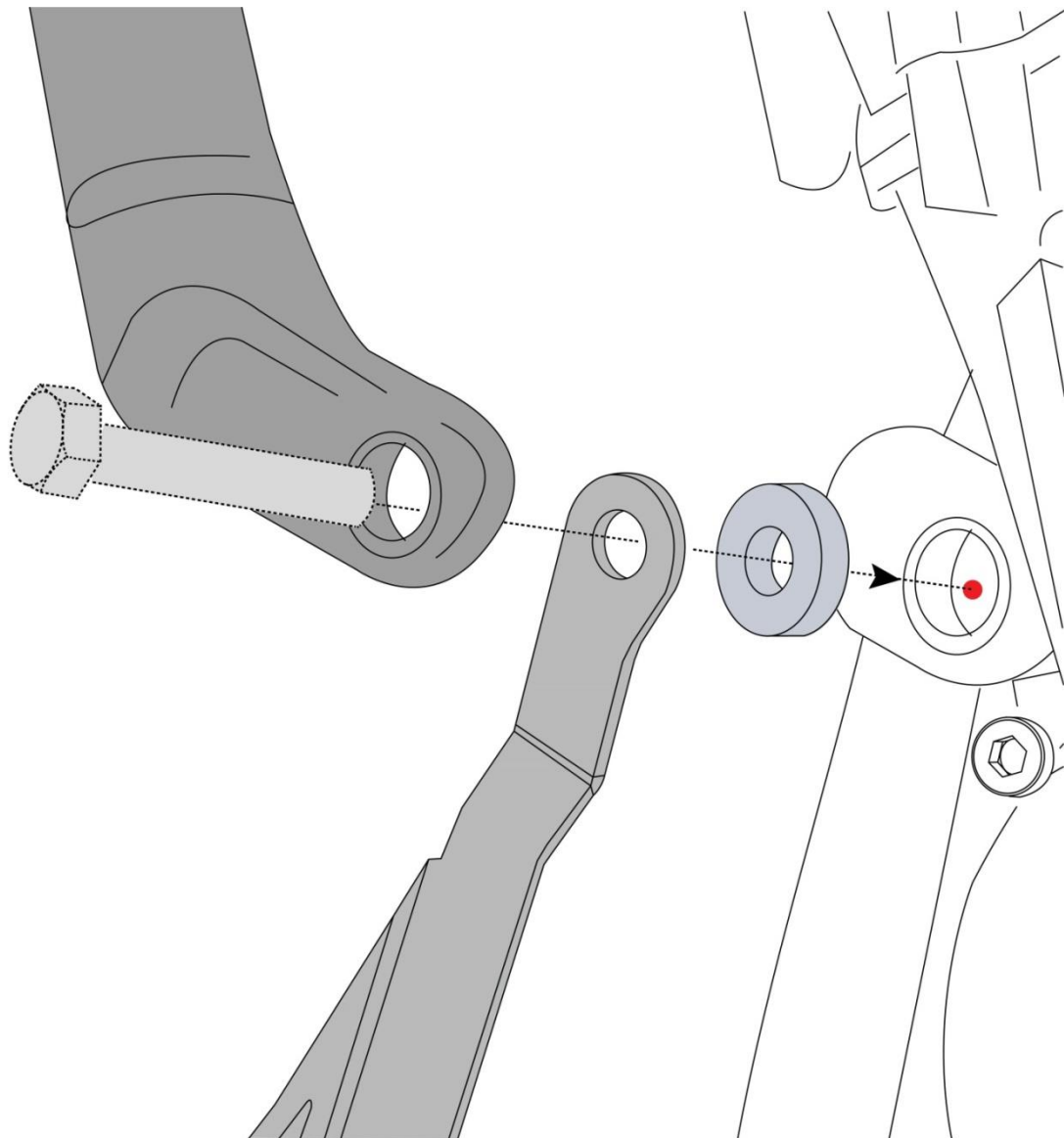
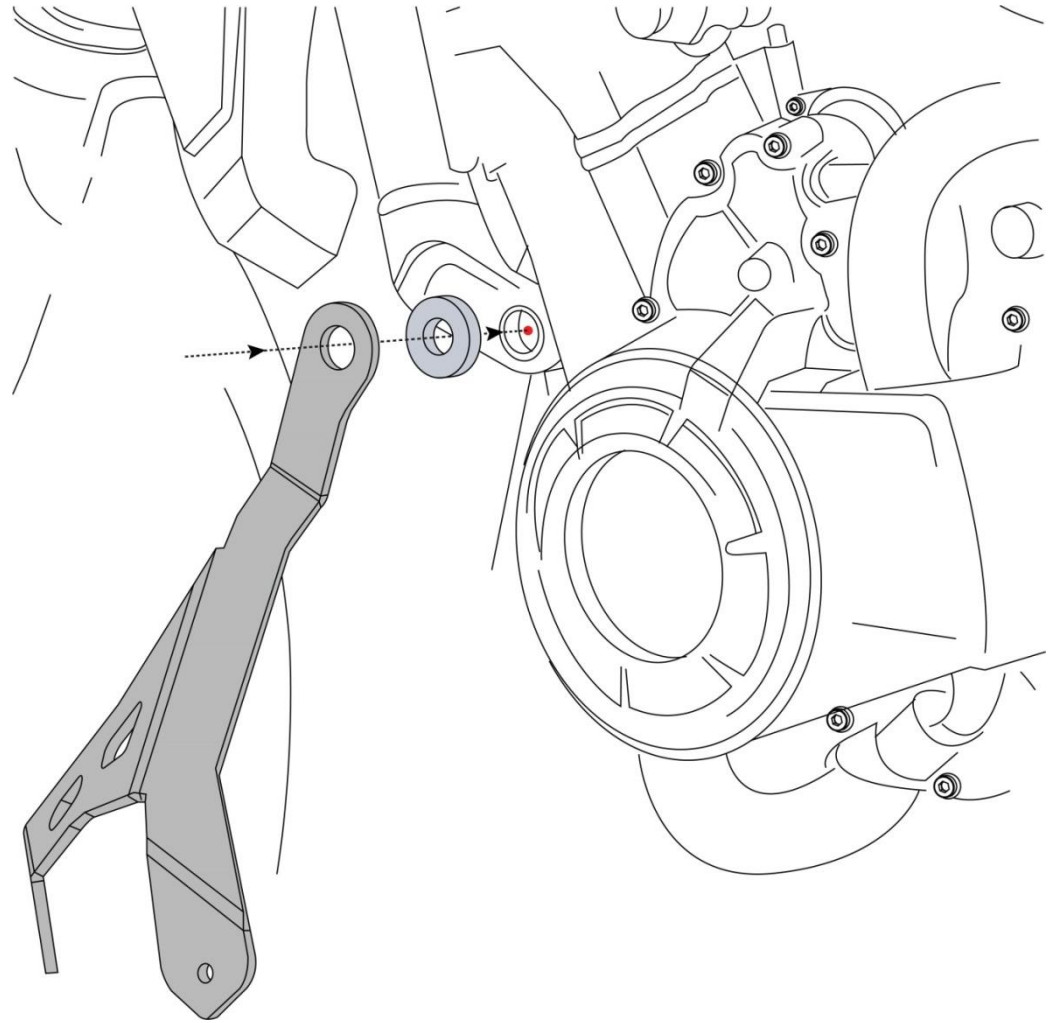

**Slip-in the OE bolt and secure the threads as shown, but not tighten it fully.**

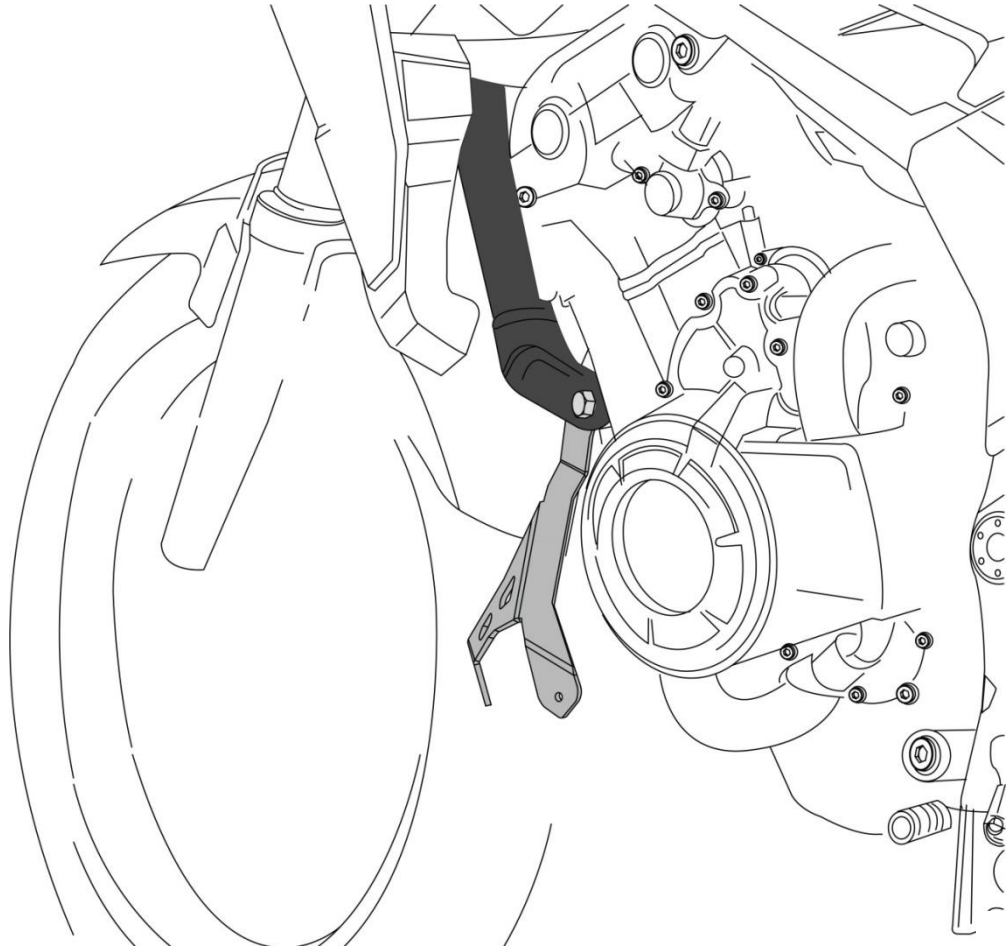

**Secure the threads as shown, but not tighten it fully.**

**Bracket "C" in "As is mounted condition", is shown below.**

**Step 4:**

**Mounting of Bracket "D" (5)**

**Orient the Bracket "D" to the Mounting hole (as shown in Red) and use the M10 bolt (Already available in the Vehicle) and slip-in the bolt in-line with the Mounting hole, as shown.**

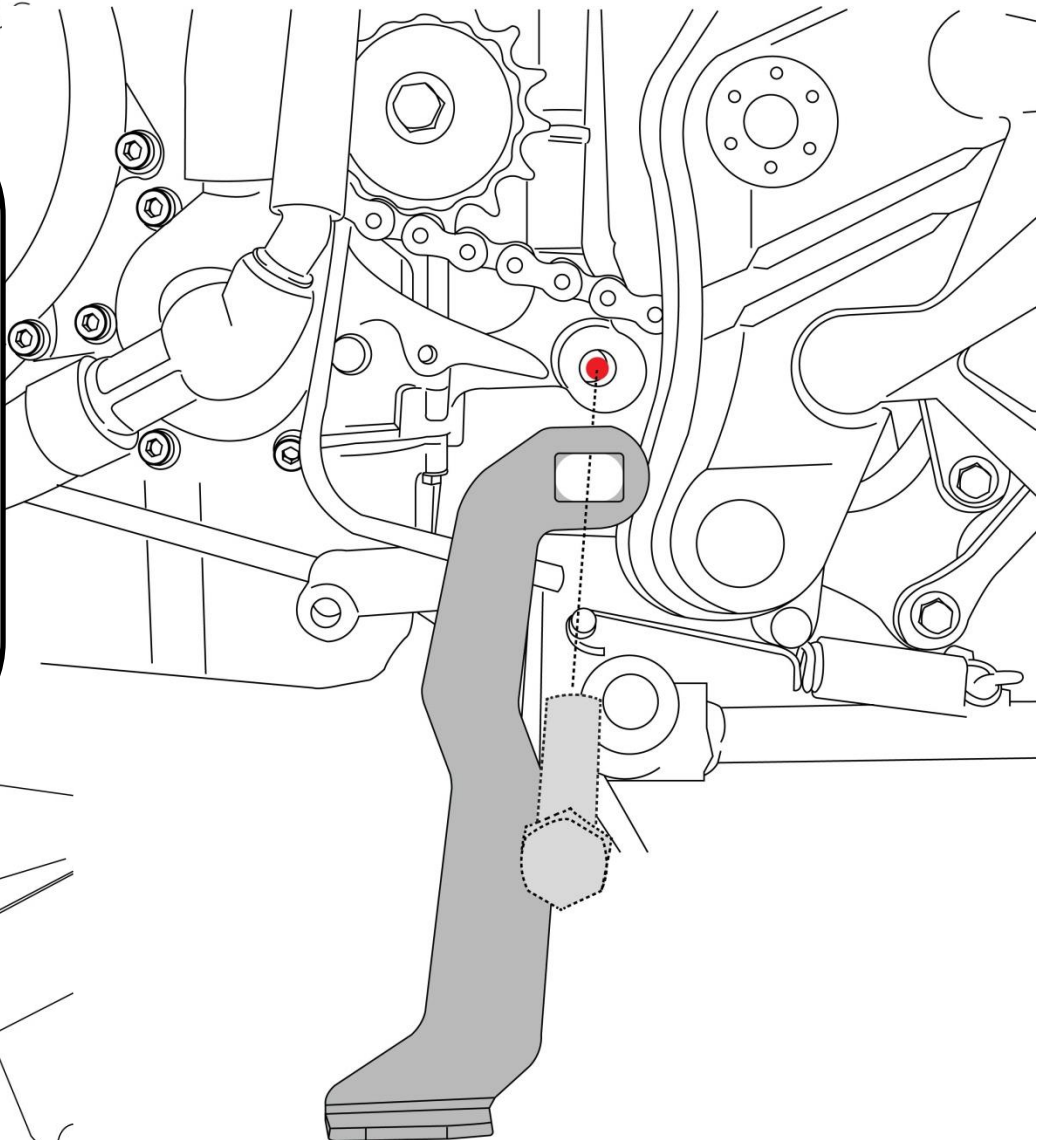

**Do not fully tighten the Bolt to the Mounting hole threads.**

**Drawing view to the left shows the Right hand Side brackets "C" and "D" in "As is Mounted Condition".**

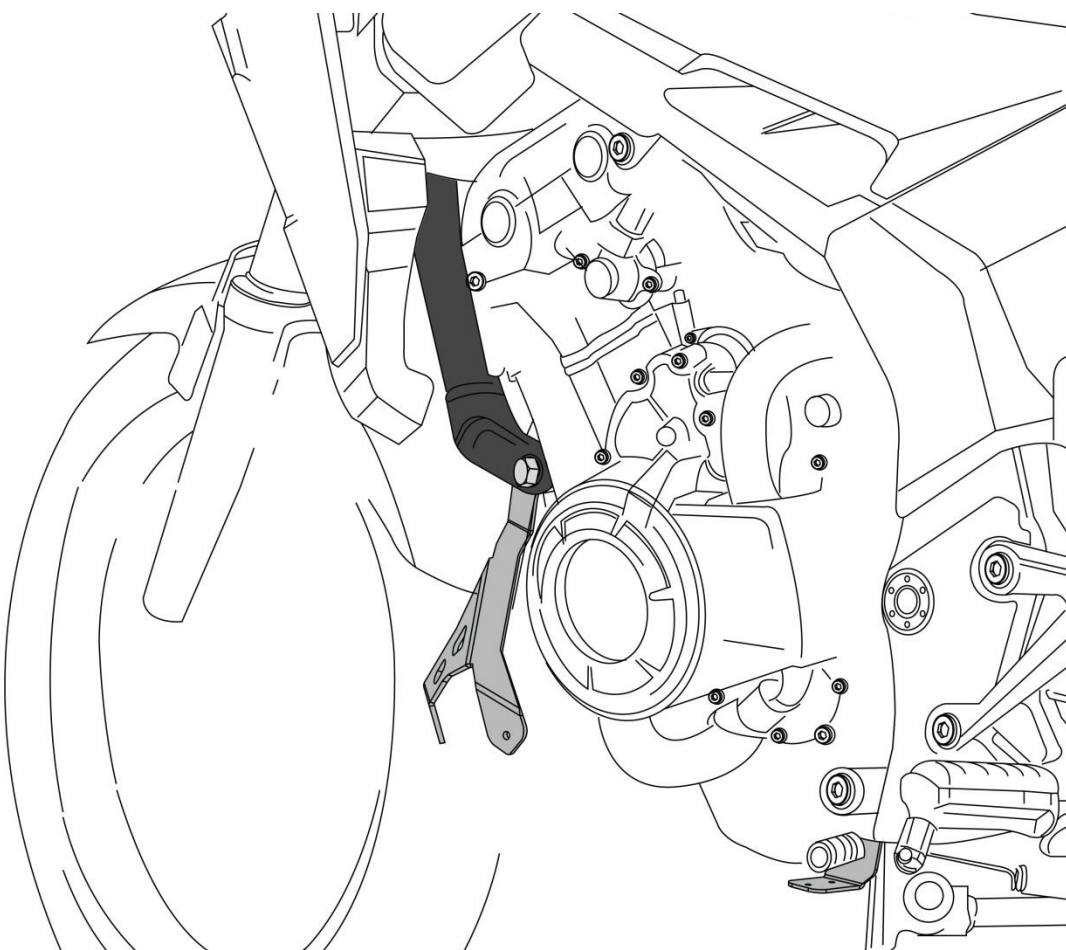



**Step 5:**

**Mounting of Engine Guard (1), as seen from the Right hand Side**

**Orient the Engine Guard (1), and register its inner surface against Brackets (A)(2) and (B)(3), and slide in the 4 off Taper Ring (7) and Countersink Screws (8) – 4 off, as shown in the drawing and secure the threads, but not tighten it fully**

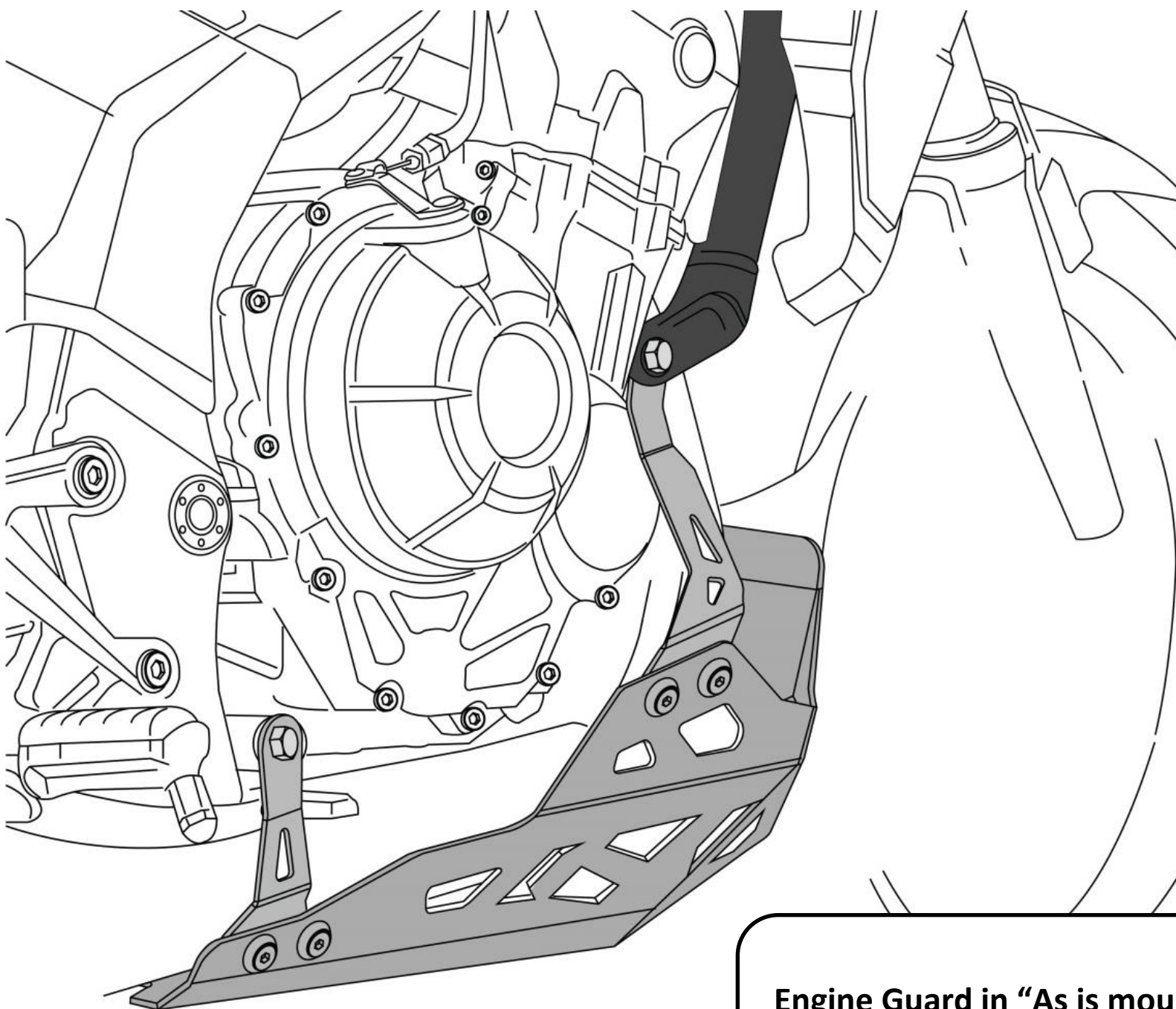
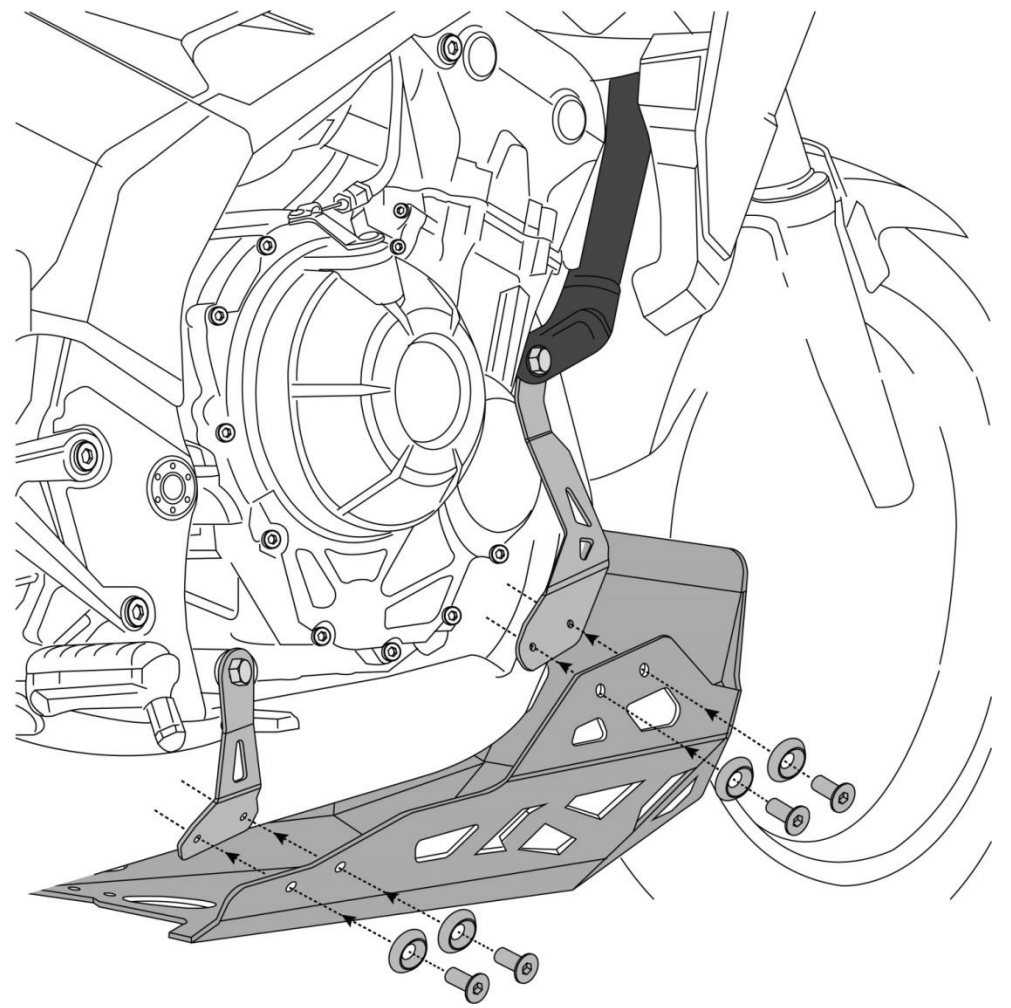

**Engine Guard in “As is mounted condition” is as shown in the drawing to the left.**



**Step 6:**

**Mounting of Engine Guard (1), as seen from the Left hand Side**

**Orient the Engine Guard (1), and register its inner surface against Brackets (C) (4) and (D)(5), and slide in the 4 off Taper Ring (7) and Countersink Screws (8) – 4 off, as shown in the above drawing and secure the threads, but not tighten it fully**

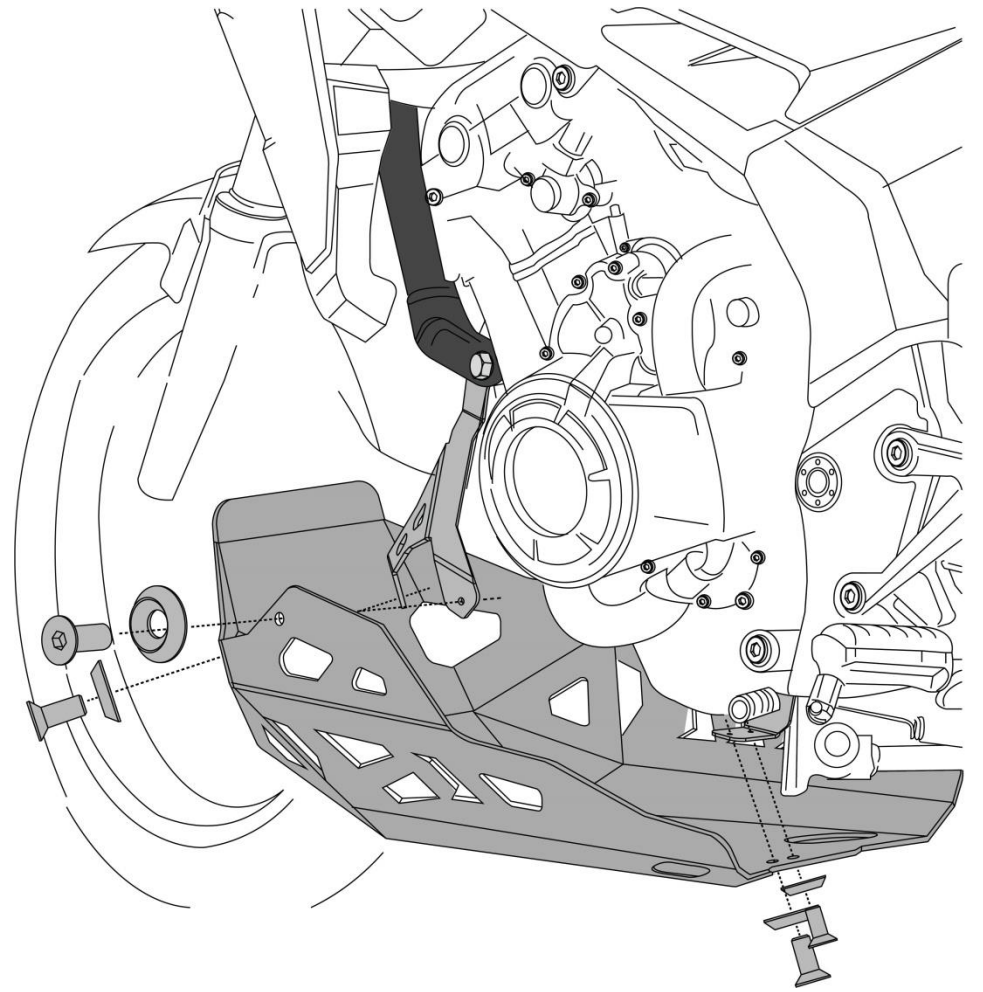

**Step 7:**

**Ensure the Orientation visually and tighten all the screws as per torque specified in the BOM table.**

**The Engine Guard “Final Mounted Condition” is as shown in the drawings below.**

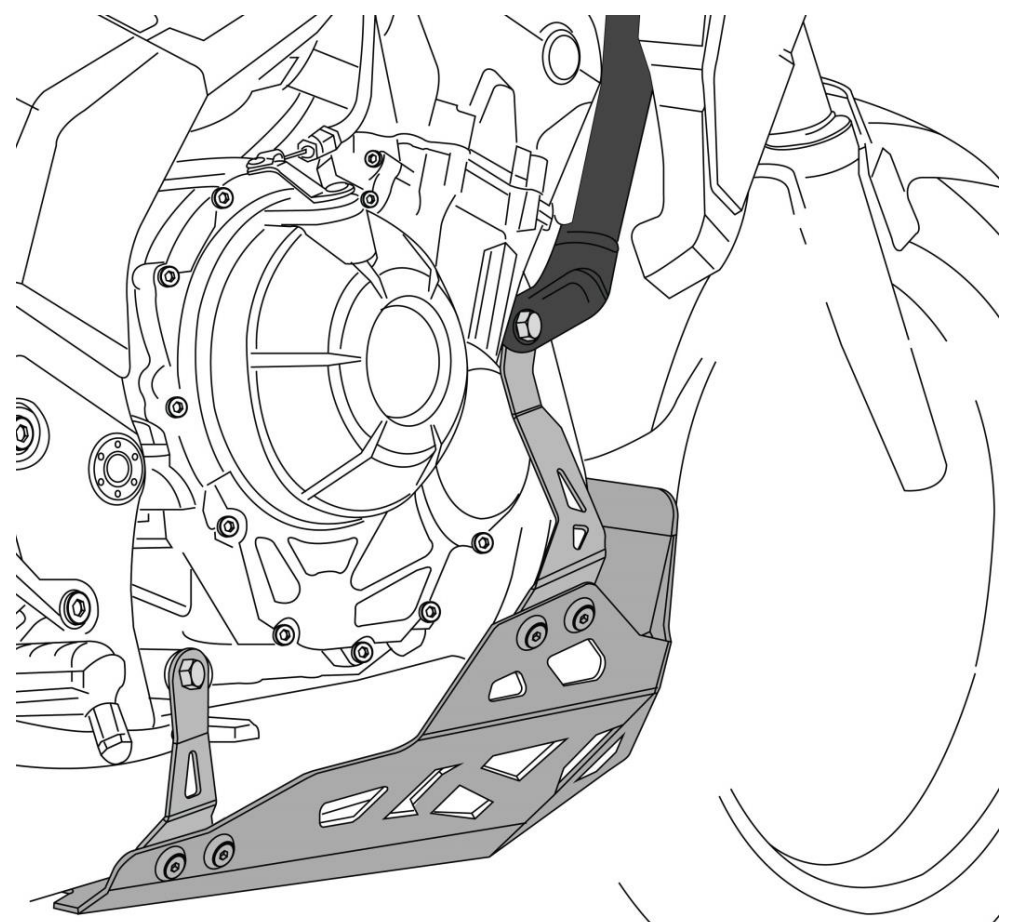
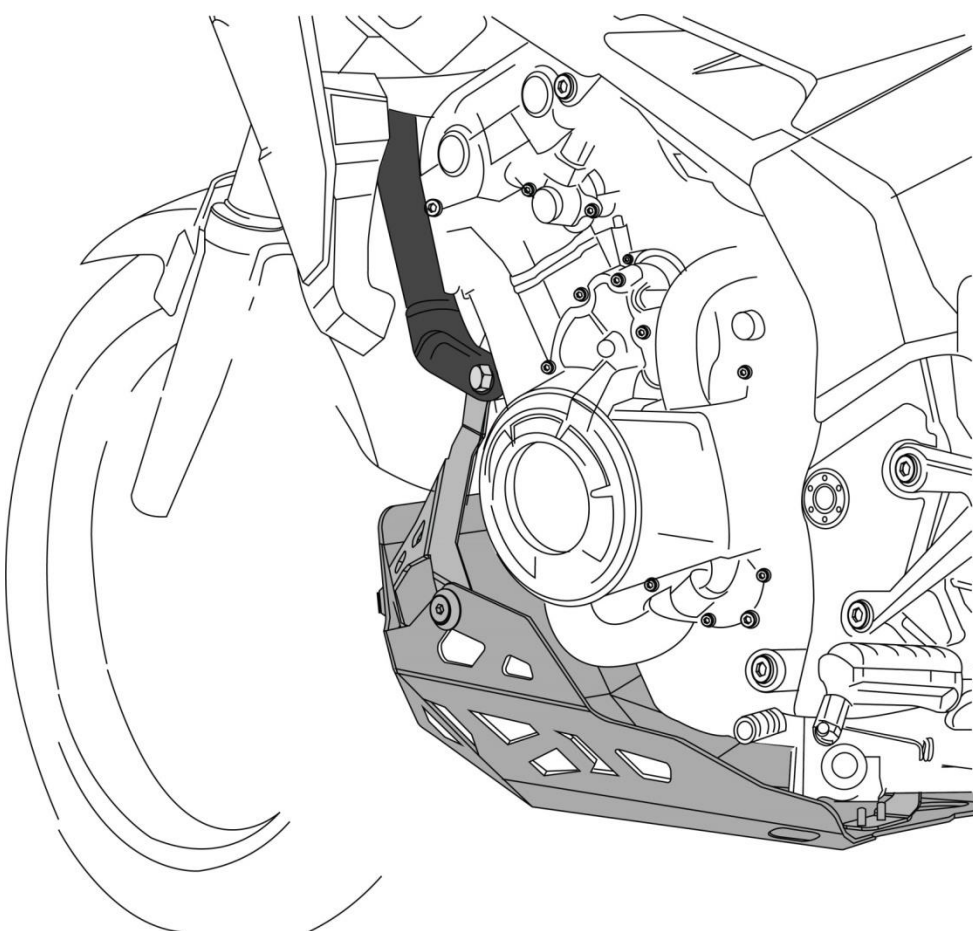





## General Instructions

1. We request you to pay attention to the Mounting Instructions in this document and follow the step-by-step procedures.
2. This Mounting Instruction manual is a “Do It Yourself” (DIY) fitment manual of the Accessory part to the Vehicle. We have prepared this based on our experience and knowledge, related to the Vehicle, Part and its functional aspects.
3. SRC cannot guarantee the interchangeability of the parts to any other manufacturer’s accessory part. It is advised to the User, to inspect and ensure the original state of all other Vehicle parts.
4. We request you to bear in mind, that the Installed part can change the driving behaviour and/or the stability during driving or any other dynamic conditions.
5. If you have the appropriate tools and another person to assist you in the mounting, it will help.
6. After Completion of the Mounting and before taking on a First ride, Ensure and Check all functions of the Vehicle. It is always advised to check loosening of the fasteners after the first 50 kilo meters of ride and at regular intervals.
7. To the maximum extent possible, our design use the current Mounting/Fitment of the Original Equipment, so that Installation of these accessories will not affect the Payload or Function of the Vehicle or the Part on which it is mounted to protect it
8. If any additional modifications are to be done, prior to the fitment of the accessories, it will be explicitly specified in the instruction sheets