

Scope of Supply/Bill of Material & Mounting Drawings

Part Number: Y-900GT-09-01-AL / Y-900GT-09-02-AL
 Part Description: Engine Guard–YAMAHA TRACER 900 GT
 Applicable to Finished colour versions of Silver and Black

Installation / Parts List / Bill of Material for Mounting

NO.	Description	Quantity	Torque * (N-M)	Remarks **
1	Skid Plate	1		
2	Bracket A	1		
3	Bracket B	1		
4	Bracket C	1		
5	Spacer	2		
6	Taper Ring M6	8		
7	Delrin Spacer	4		
8	Screw M6x15	2	9 - 10	Use Liquid Thread Locker
9	Screw M6x35	6	9 - 10	Use Liquid Thread Locker

SRC Design uses Metric System of Measurement and all dimensions in Millimeters

* Recommended to use the Torque specified in the table

** Denotes Usage of Liquid Thread Locker in specified Locations

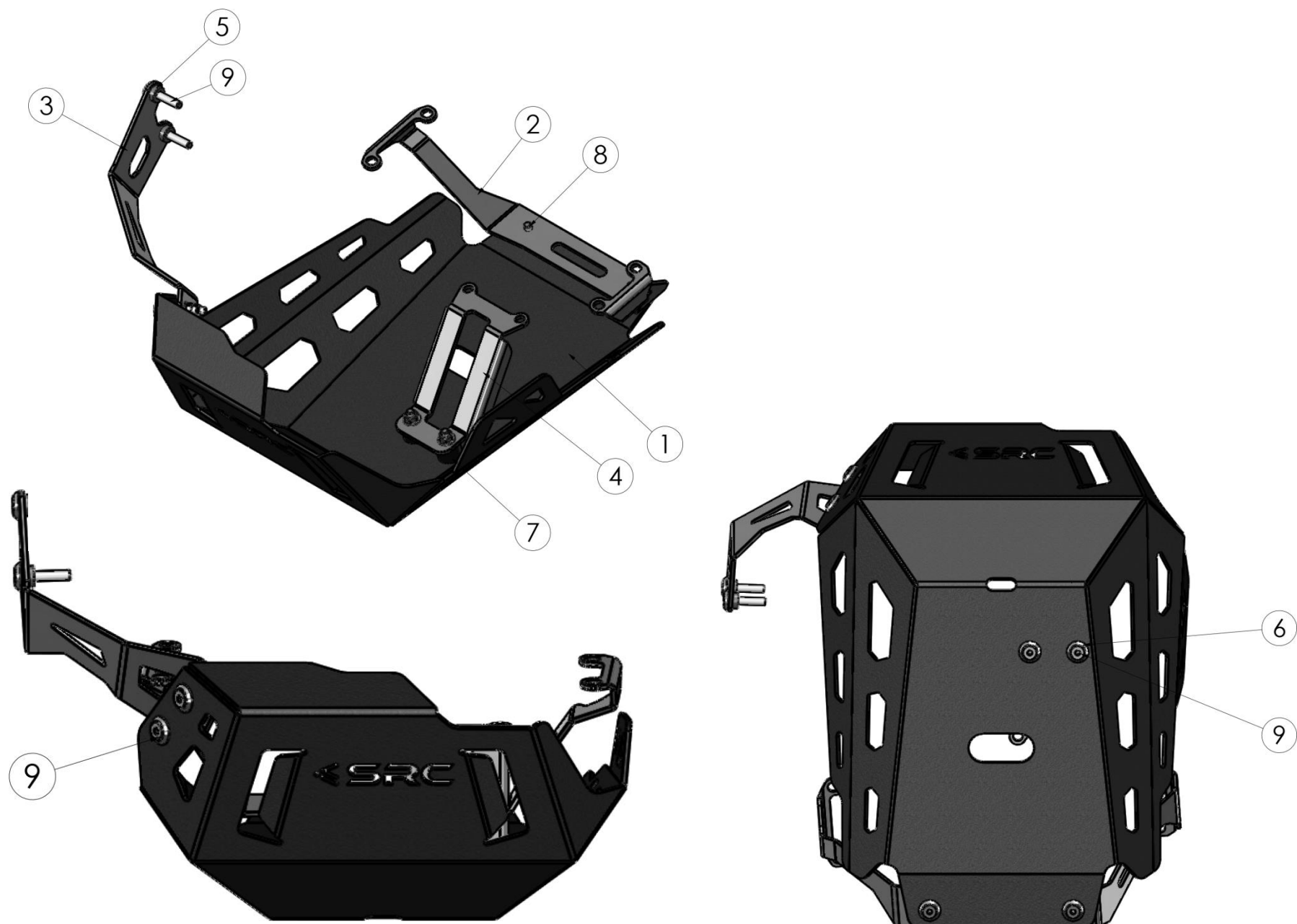

MOUNTING DRAWINGS

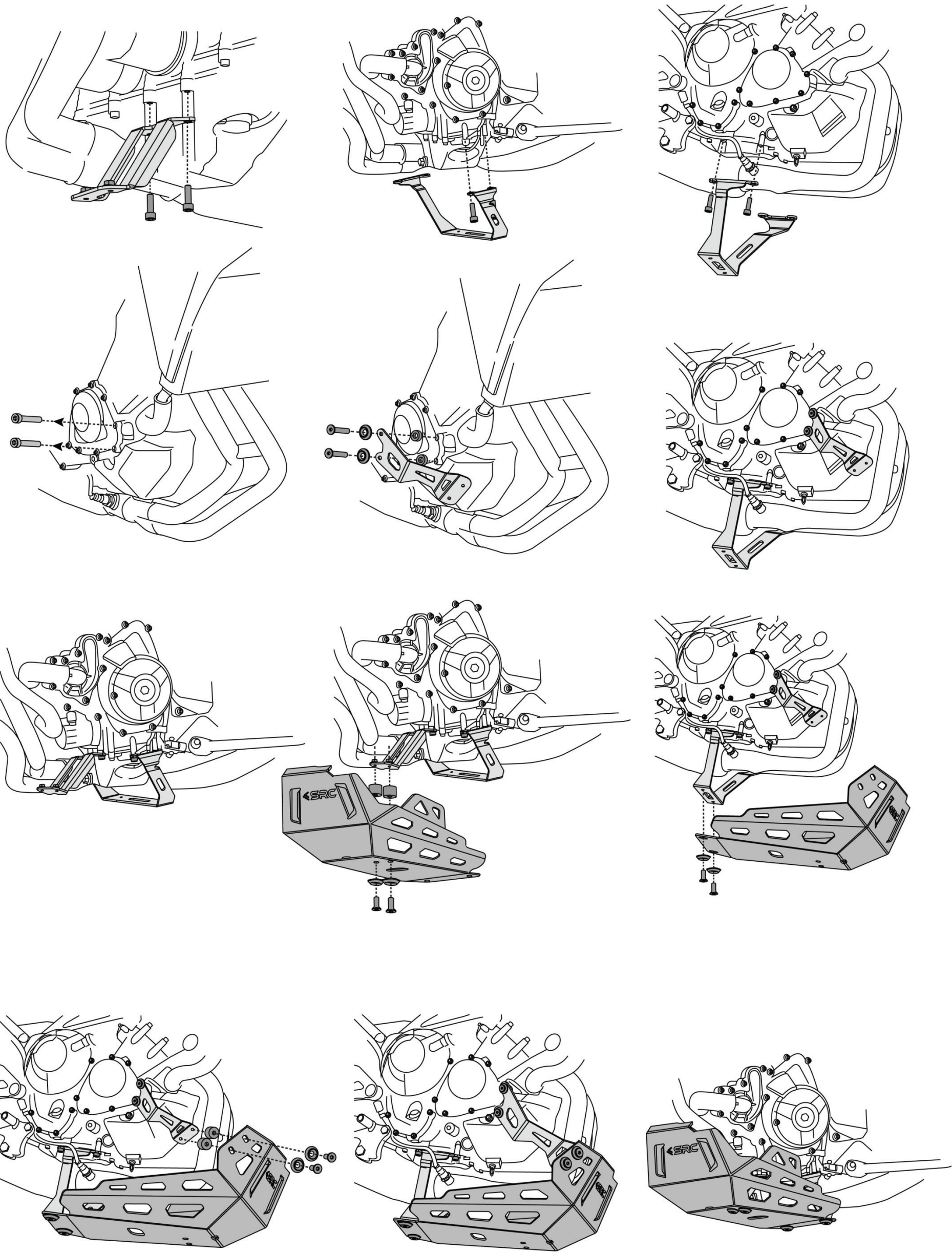

Mounting Instructions

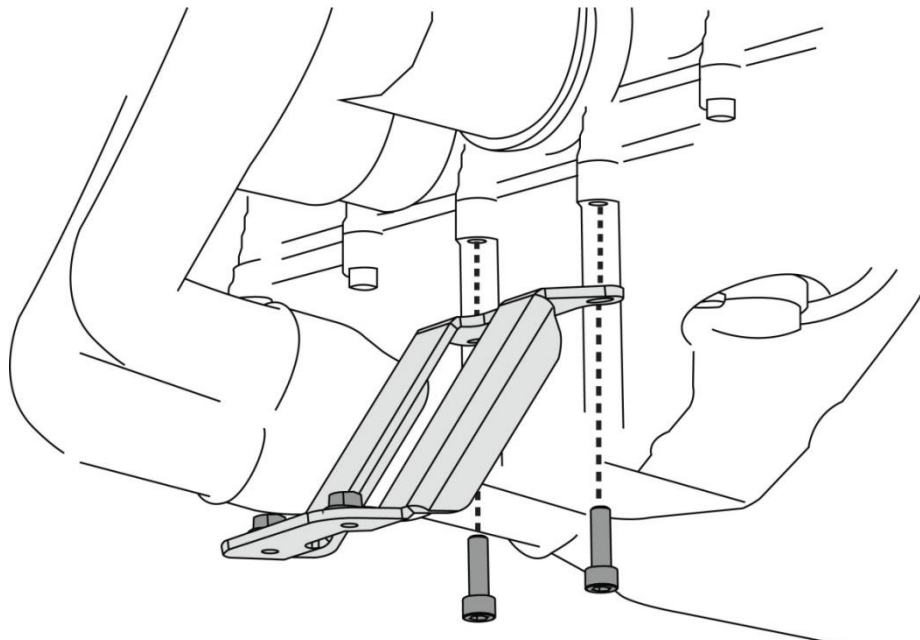

Step 1:

Mounting of Bracket B (3) to the Motorbike Under chassis

Remove the two mounting screws (already available in the Under chassis).

Orient and align the Bracket B (3), as shown, with the mounting holes in-line to the under chassis mounting holes and slide-in the two screws and secure the threads in the Mounting holes.

The two other Hex Nuts shown in the drawing, are Integral and Welded to Bracket B, and it is meant for mounting the Skid Plate and using Delrin Spacers.

Step 2:

Mounting of Bracket A (2), afar end to Bracket B

Orient and align the Bracket A (2), as shown. The Bracket A, has two flaps, one on the Left Hand side (when viewed from the front of the Motorbike) and one on the Right hand side.

Prior to that, unscrew the 2 off x 2 sets of mounting screws (which are already available on the Motorbike).

Slide-in the 2 off screws through the left hand flap, to secure the threads to the Under chassis mounting holes.

Slide-in the other 2 off screws through the Right hand flap, to secure the threads to the Under chassis mounting holes.

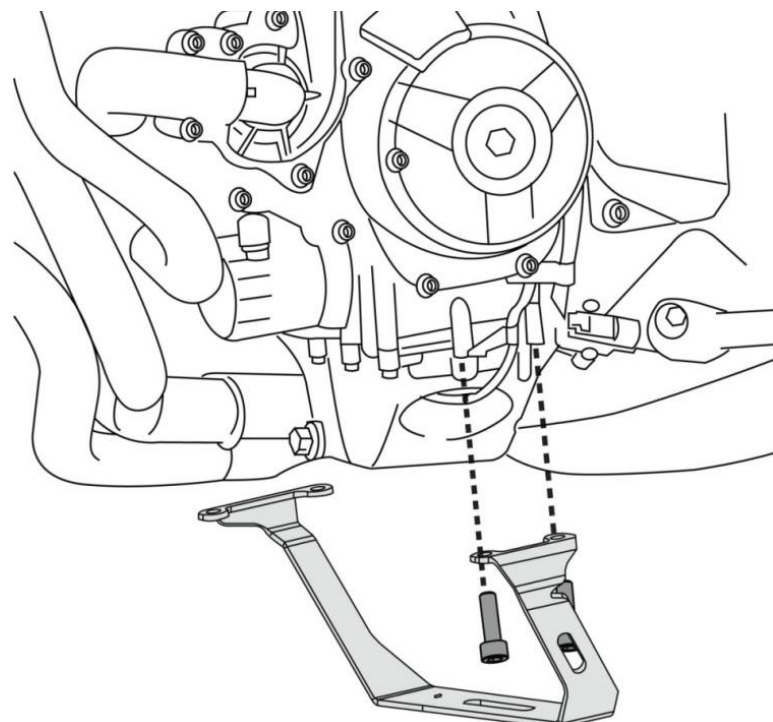
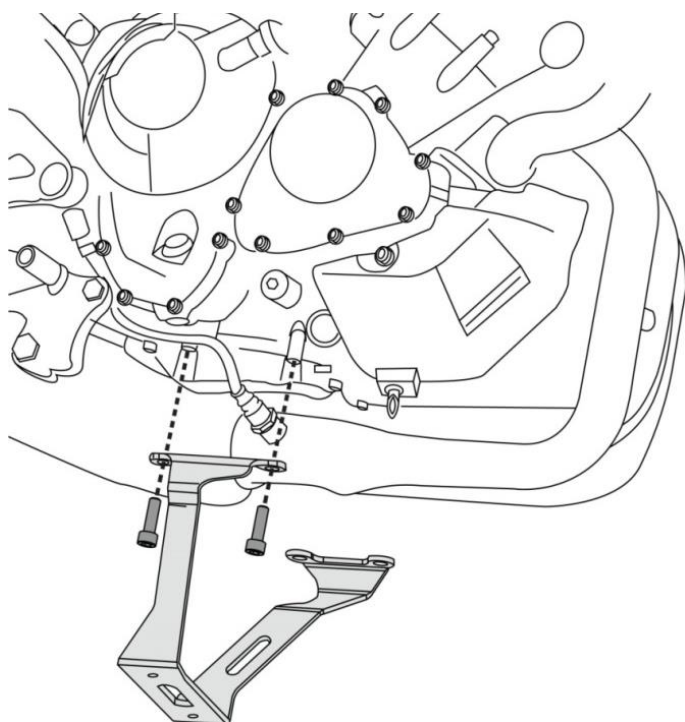

Step 3:

Mounting of Bracket C (4) to the Side chassis housing cover (as shown in the drawing).

Unscrew the lower end screws and keep them aside.

The two mounting holes are accessible will be used for mounting Bracket C (4)

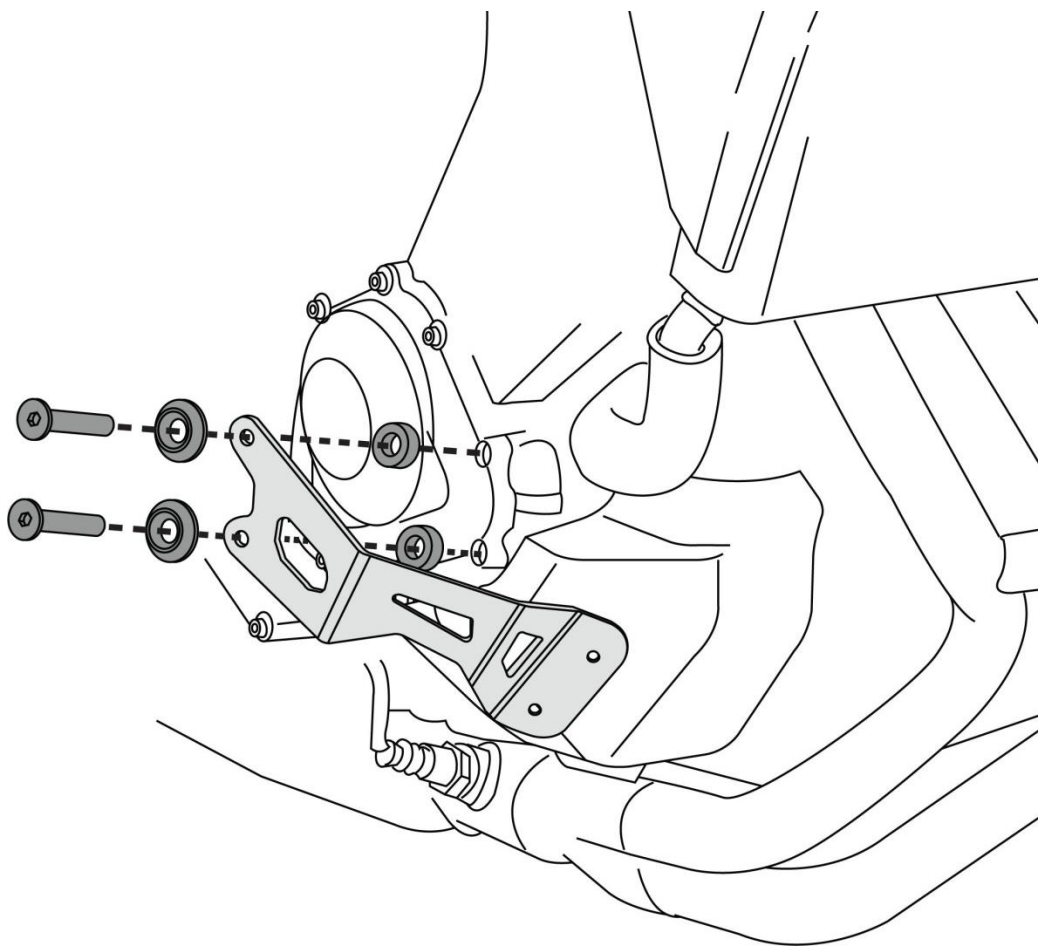
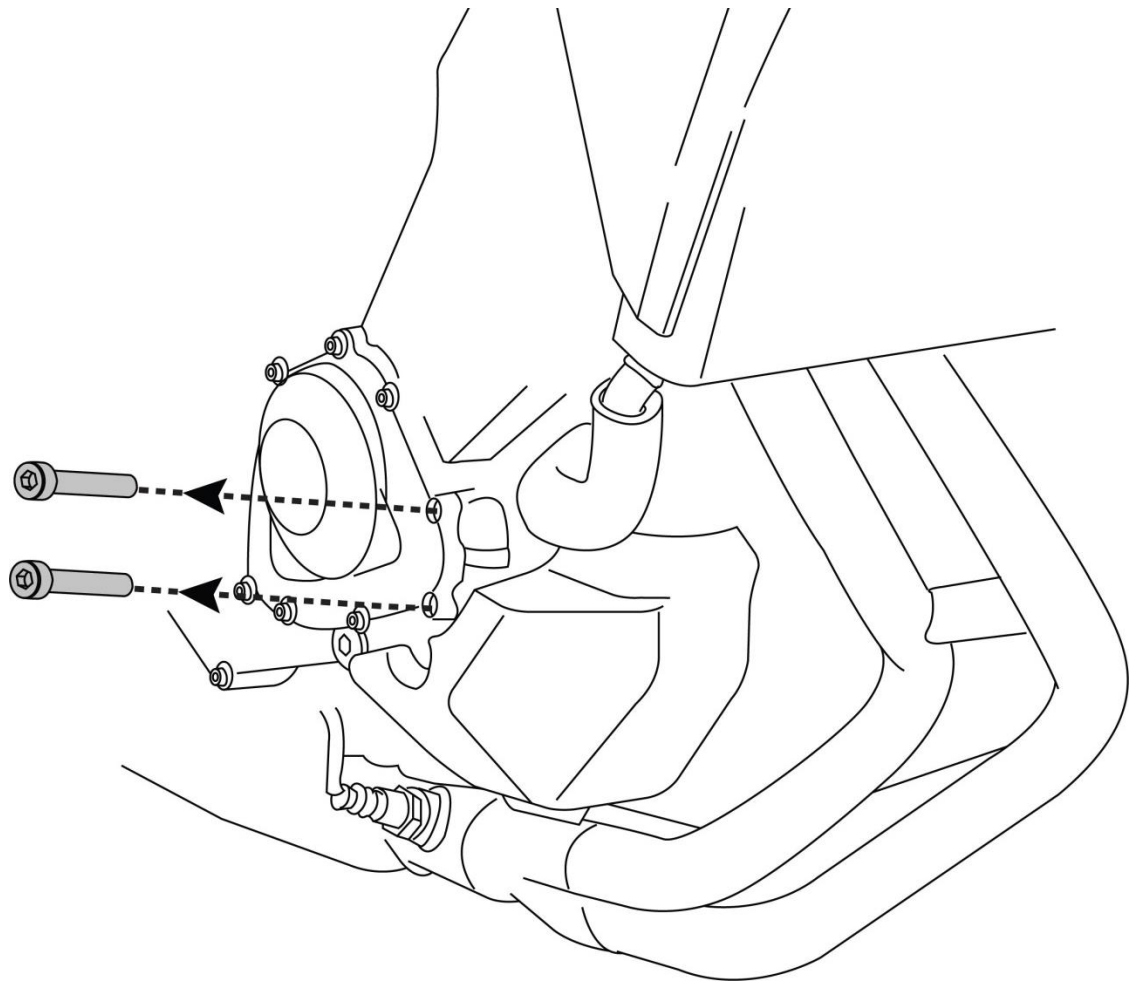

Step 4:

Orient the Bracket C (4), as shown, and slip-in Spacer (5) – 2 off to the rear side, and Taper Ring M6 (6) – 2 off and Screw M6 x 35 (9) – 2 off and secure the threads in the mounting holes.

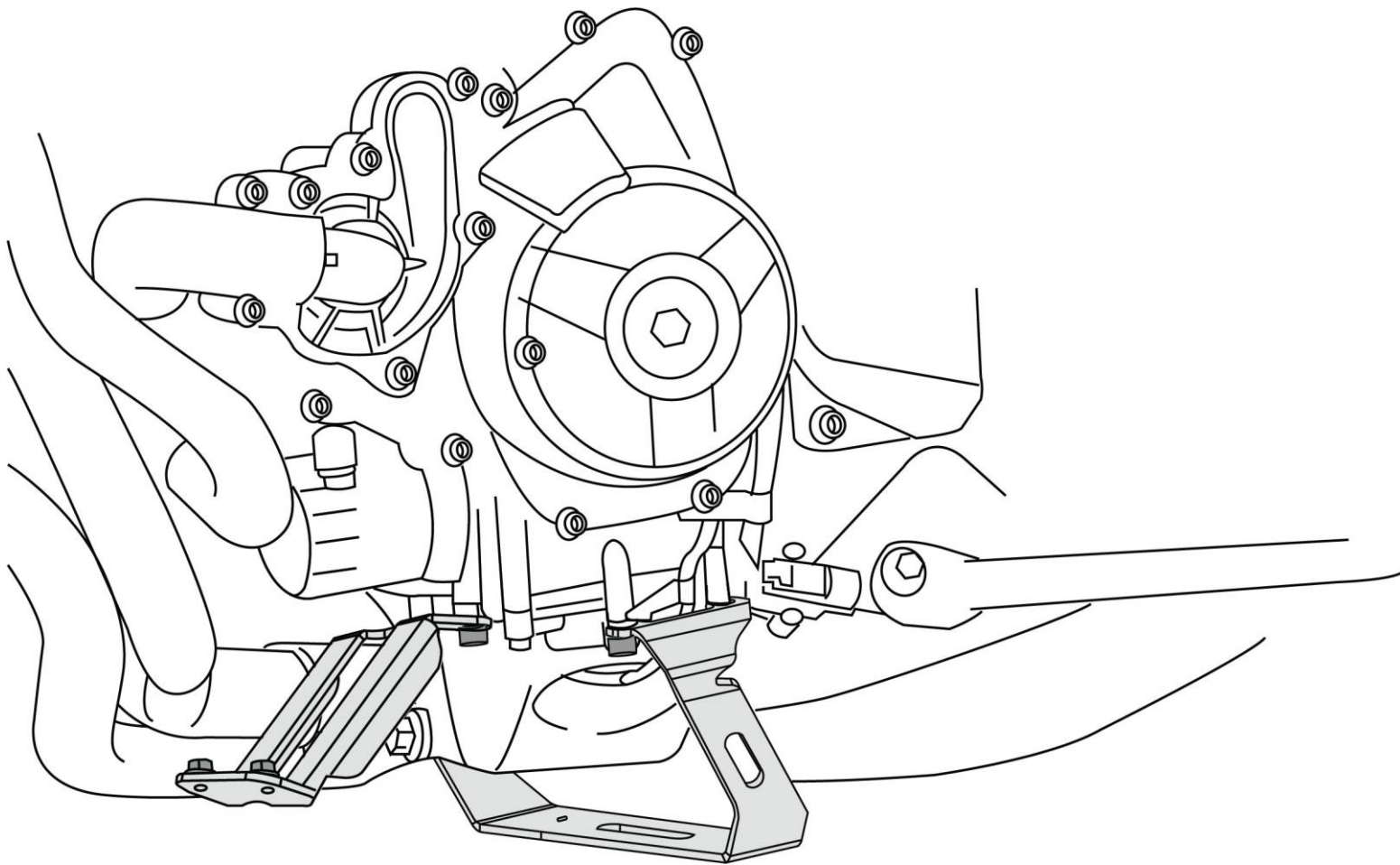

Step 5:

Ensure visual orientation of Bracket A, Bracket B and Bracket C, as shown and tighten them fully.

The drawing above and the one to the right hand side, shows the Brackets in their “As is mounted condition”.

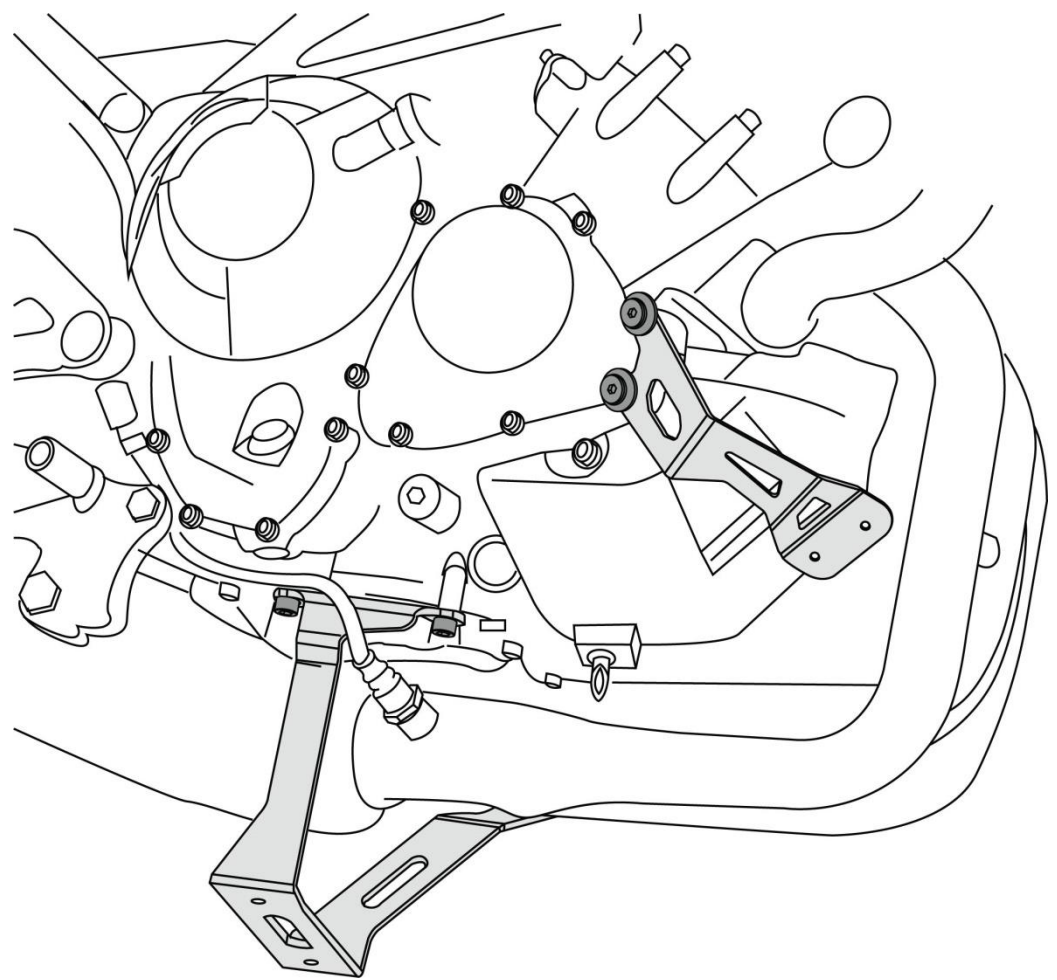

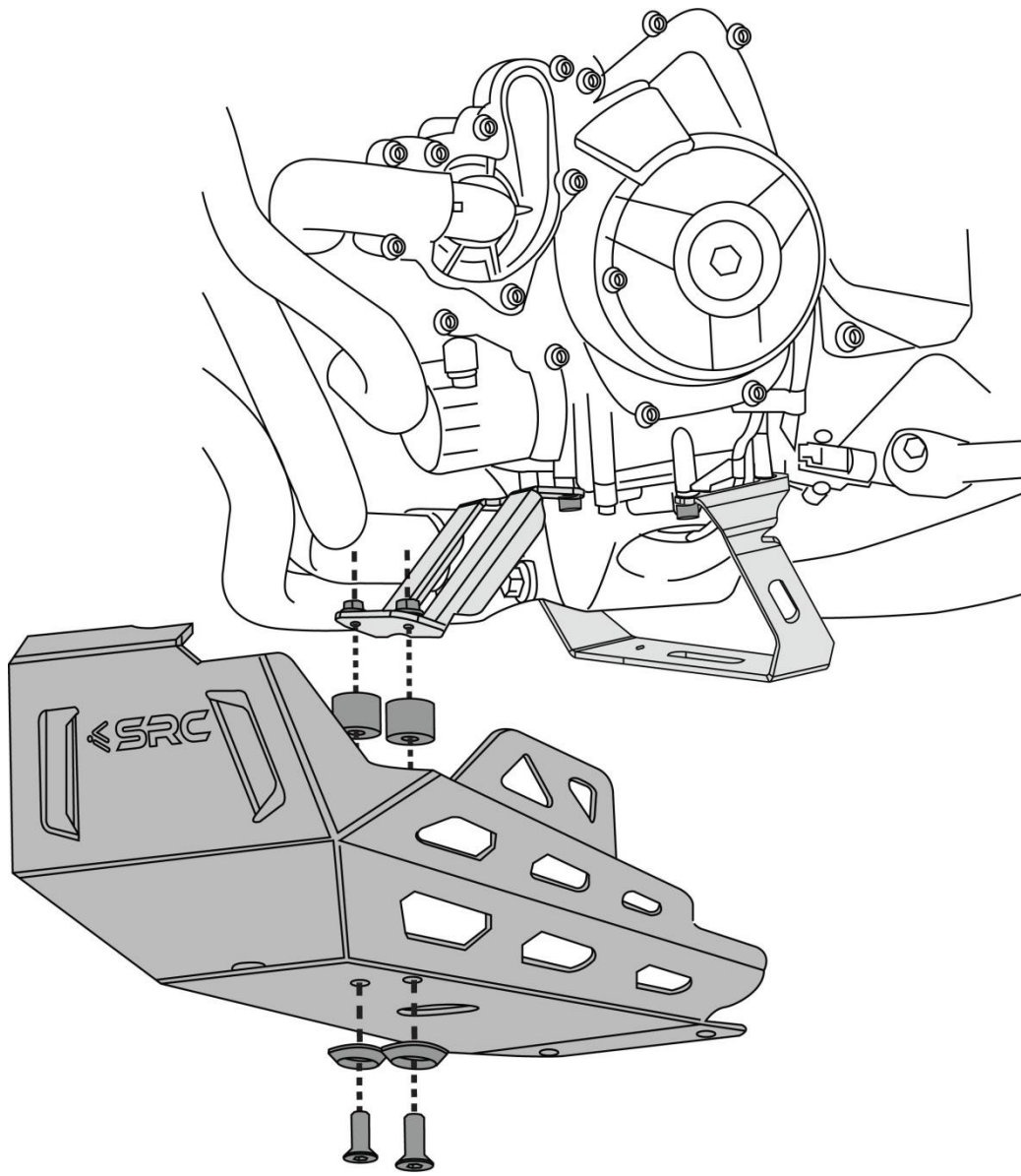

Step 6:

Mounting of the Skid Plate to Bracket B

Orient and align the Skid Plate (1), as shown and Slip-in the Damper (7) – 2 off inside sandwiching between the flap of Bracket B, and slide-in Taper ring M6 (6) – 2 off and Screw M6 x 15 (8) – 2 off and secure using the Nut M6 (10) – 2 off.

Step 7:

Mounting of Skid Plate to Bracket A

Orient the Skid plate to the rear end and in-line with the mounting holes in the hanging flap of Bracket A and slide-in Taper Ring M6 (6) – 2 off and Screw M6 x 15 (8) – 2 off and secure it to the threads in the Bracket A, as shown.

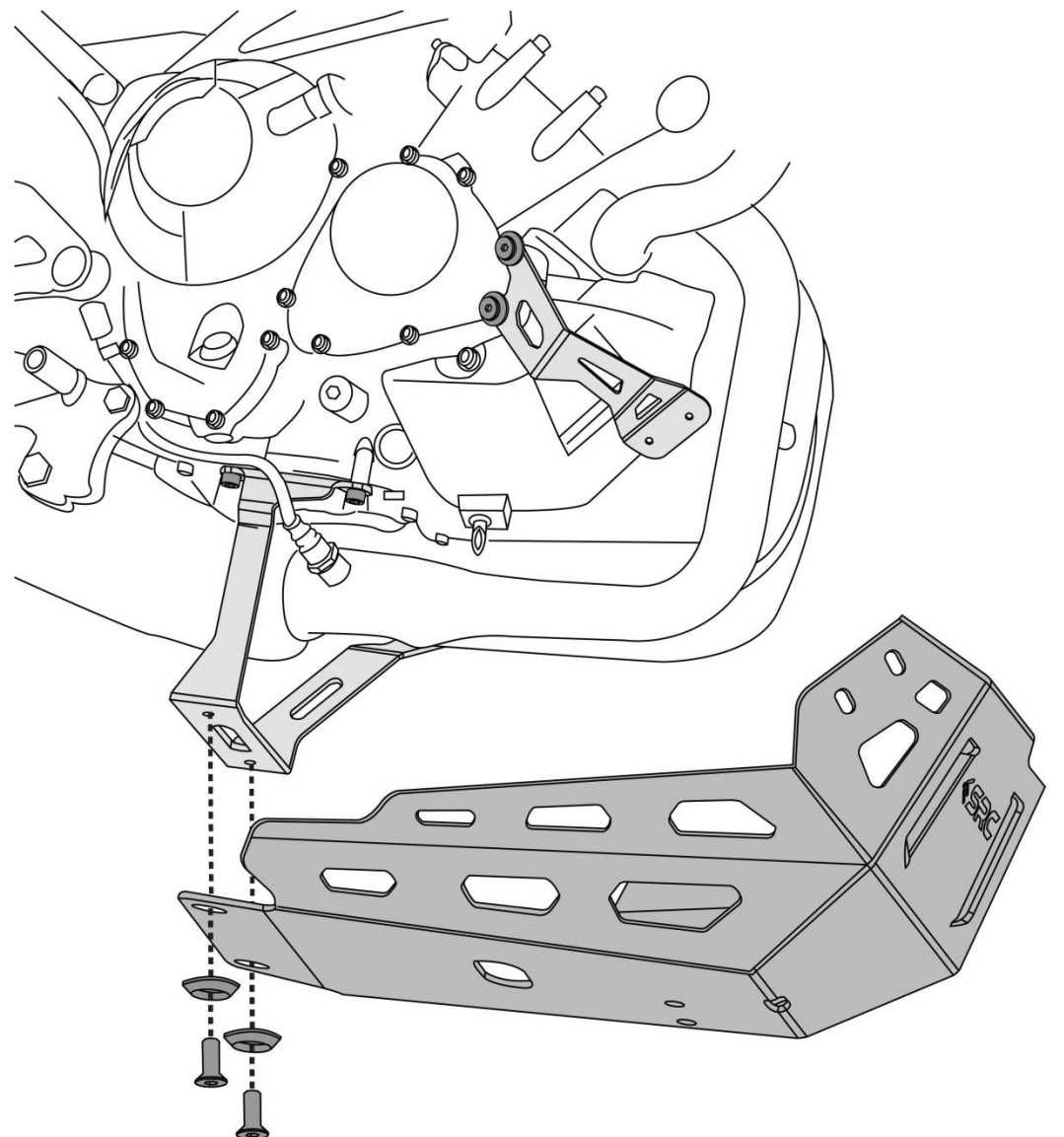

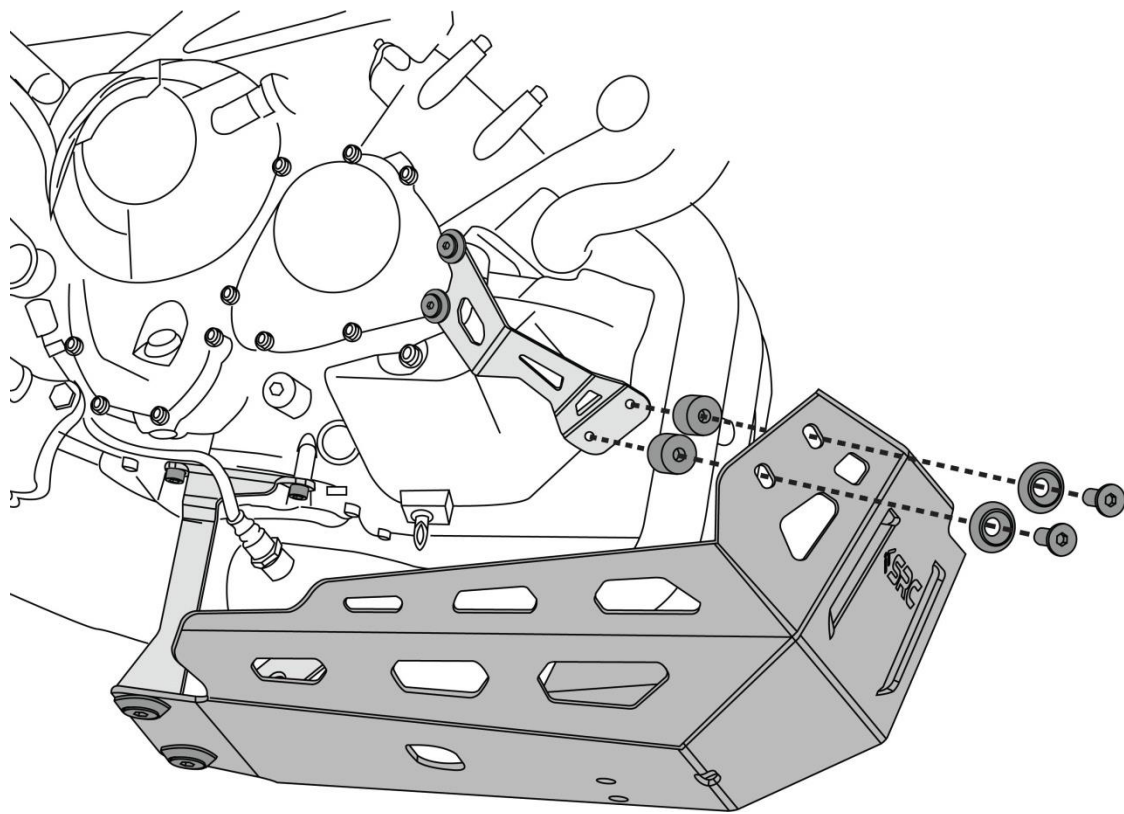

Step 8:

Mounting of Skid Plate to the Bracket C.

Orient and align the Skid plate in-line with open flap with mounting holes in Bracket C.

Slip-in Damper (7) – 2 off between the lower flap of Bracket C and inside of Skid plate.

Slide-in Taper ring M6 (6) – 2 off and Screw M6 x 15 (8) – 2 off and secure using the Nut M6 (10) – 2 off.

Step 9:

Ensure Orientation of the Skid plate with respect to each of the Brackets and ensure, there are no fouling inside with the Crank case and tighten the screws to the torque, as per specifications in the BOM table.

The drawing below shows the final mounted condition of Skid plate.

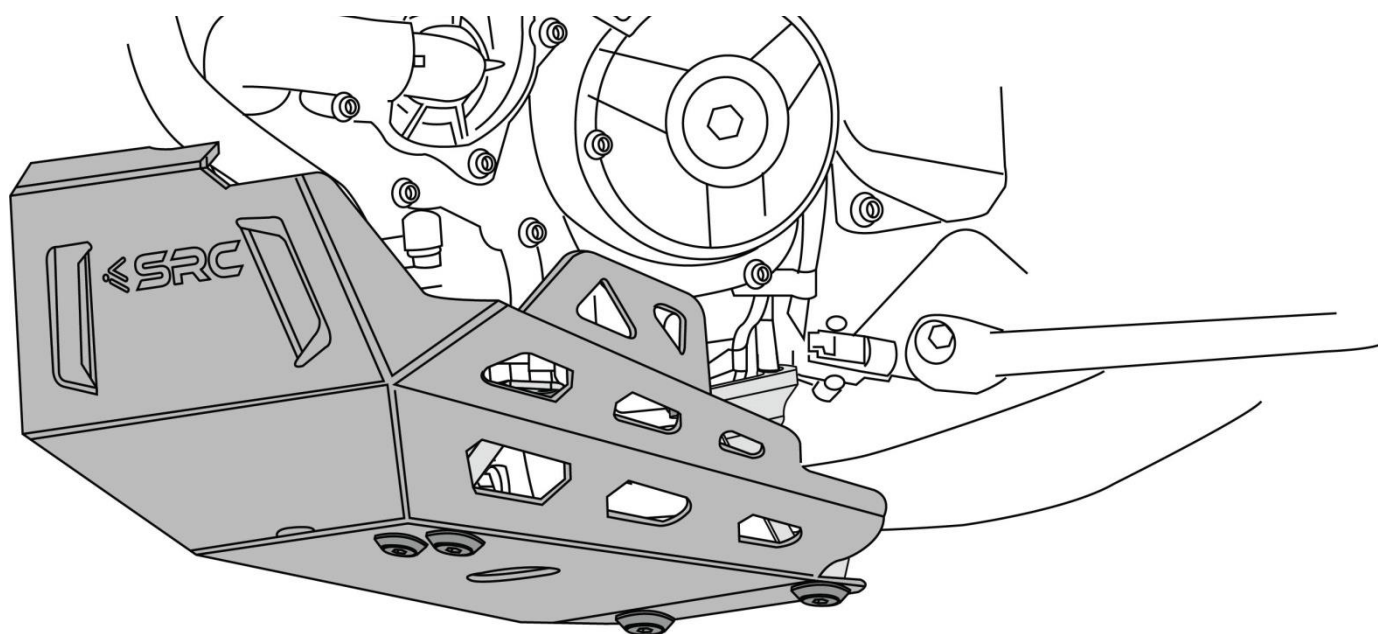
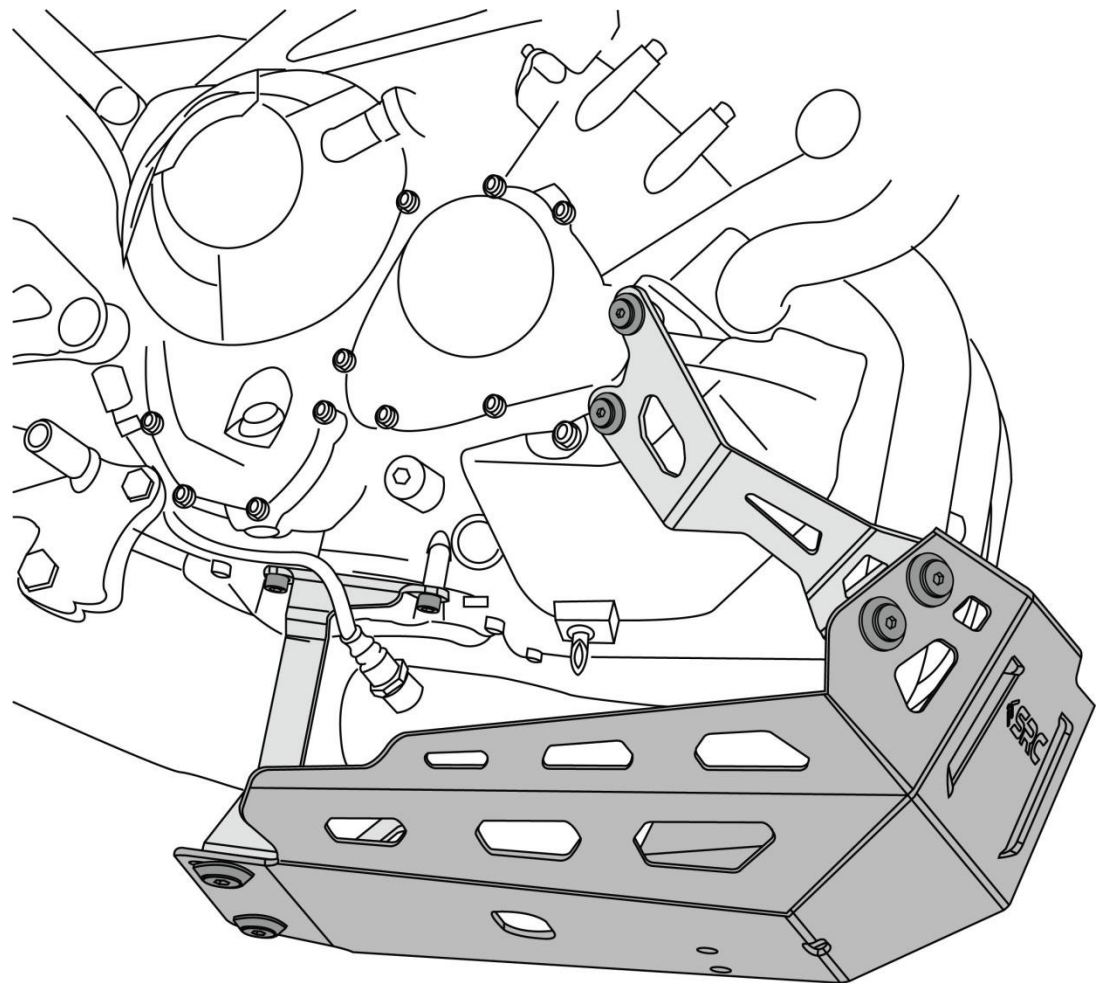



General Instructions

1. We request you to pay attention to the Mounting Instructions in this document and follow the step-by-step procedures.
2. This Mounting Instruction manual is a “Do It Yourself” (DIY) fitment manual of the Accessory part to the Vehicle. We have prepared this based on our experience and knowledge, related to the Vehicle, Part and its functional aspects.
3. SRC cannot guarantee the interchangeability of the parts to any other manufacturer’s accessory part. It is advised to the User, to inspect and ensure the original state of all other Vehicle parts.
4. We request you to bear in mind, that the Installed part can change the driving behaviour and/or the stability during driving or any other dynamic conditions.
5. If you have the appropriate tools and another person to assist you in the mounting, it will help.
6. After Completion of the Mounting and before taking on a First ride, Ensure and Check all functions of the Vehicle. It is always advised to check loosening of the fasteners after the first 50 kilo meters of ride and at regular intervals.
7. To the maximum extent possible, our design use the current Mounting/Fitment of the Original Equipment, so that Installation of these accessories will not affect the Payload or Function of the Vehicle or the Part on which it is mounted to protect it
8. If any additional modifications are to be done, prior to the fitment of the accessories, it will be explicitly specified in the instruction sheets