

Scope of Supply/Bill of Material & Mounting Drawings

Part Number: BMW-R1250GS-13-01-SL / BMW-R1250GS-13-02

Part Description: KICK STAND SENSOR GUARD – BMW R1250 GS

Installation / Parts List / Bill of Material for Mounting

NO.	Description	Quantity	Torque * (N-M)	Remarks **
1	Kick Stand Sensor Guard	1		
2	Cable Tie	2		
SRC Design uses Metric System of Measurement and all dimensions in Millimeters				
* Recommended to use the Torque specified in the table				
** Denotes Usage of Liquid Thread Locker in specified Locations				

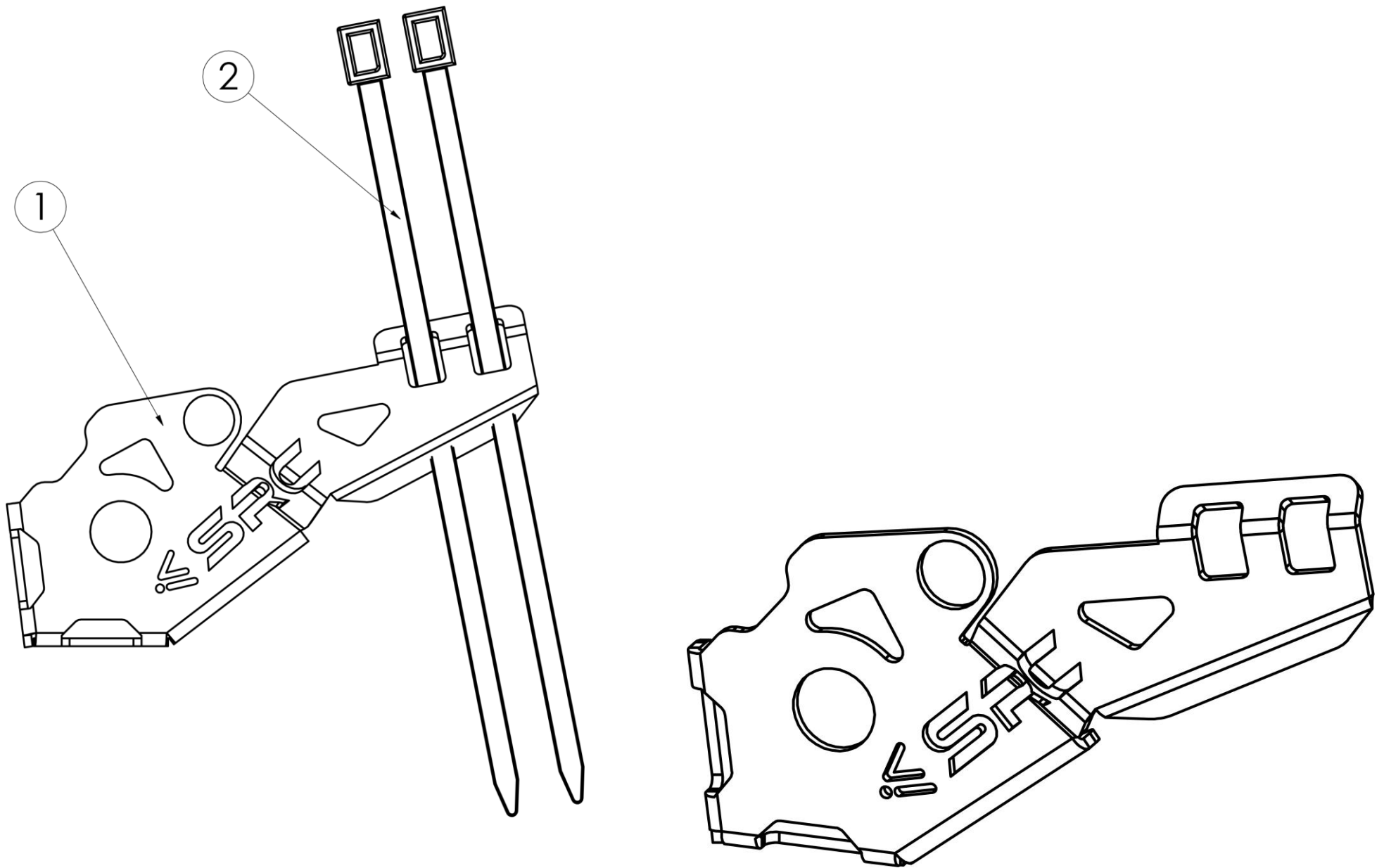

MOUNTING DRAWINGS

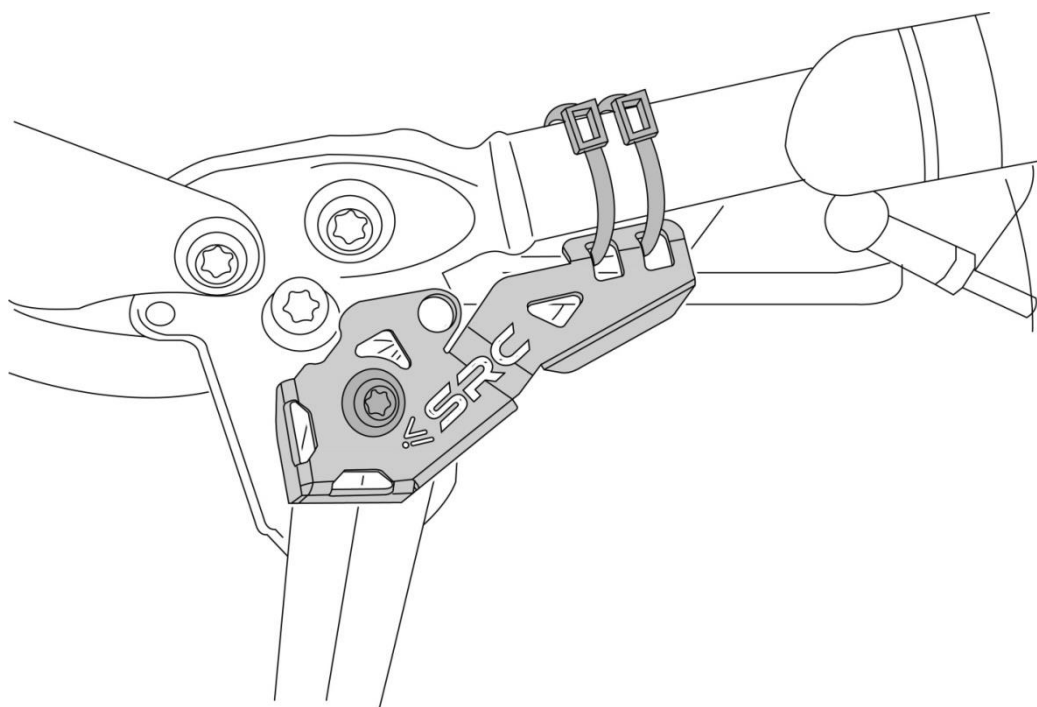
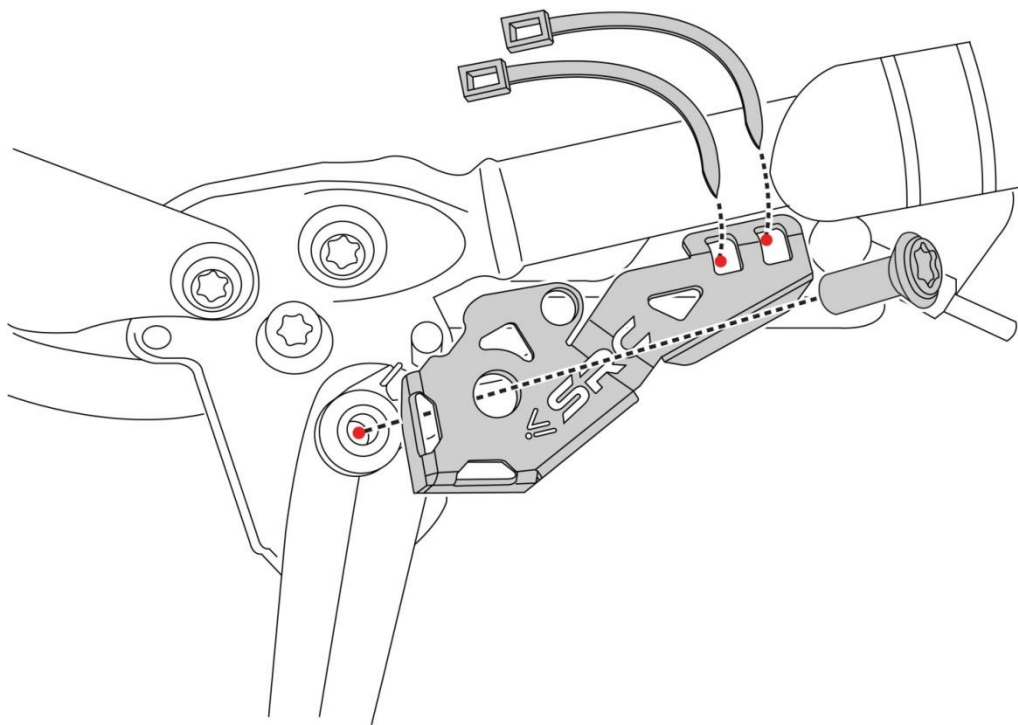
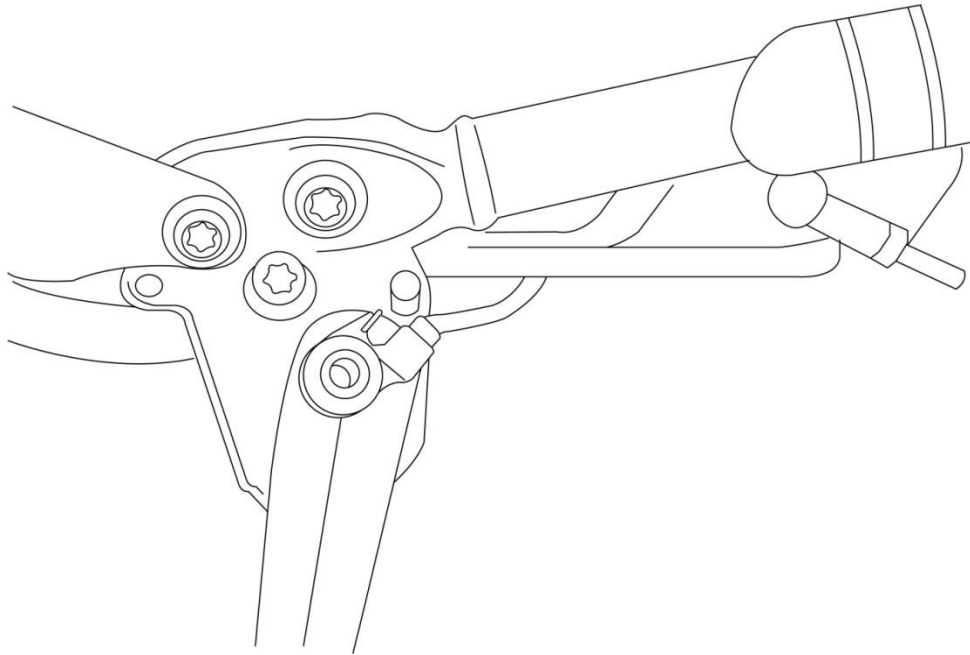

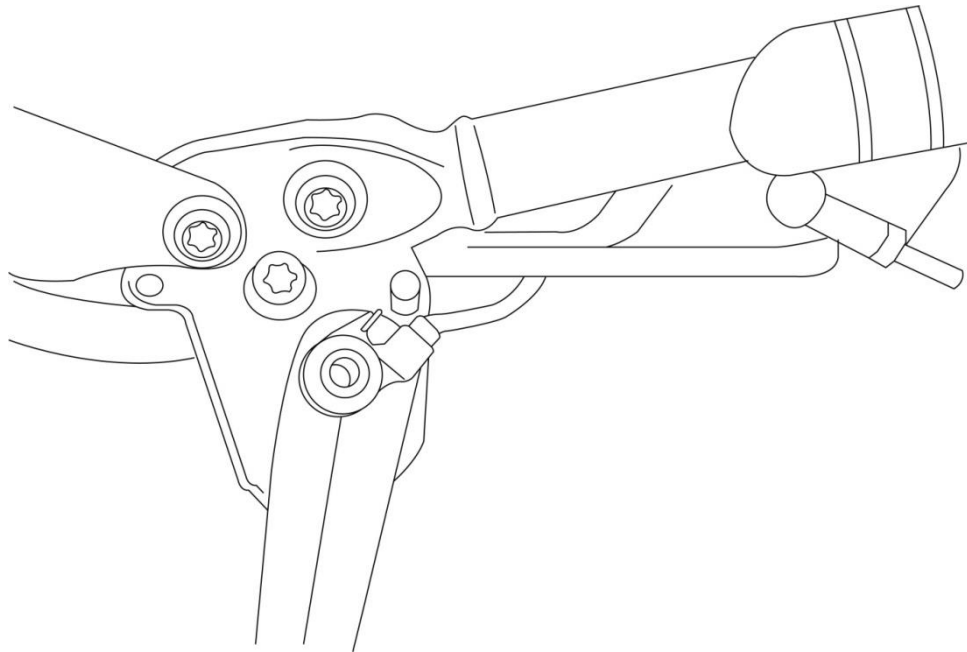

Step: 1

Unscrew the OE Mounting Bolt holding the Sensor in its place.

The same screw will be used for mounting the Sheet Metal Guard.

Step: 2

Orient and Align the Kick Stand Sensor Guard, as shown, and Slip-in the OE screw through the Mounting hole in the Guard and secure the threads in the Sensor Housing, as shown in Red Colour.

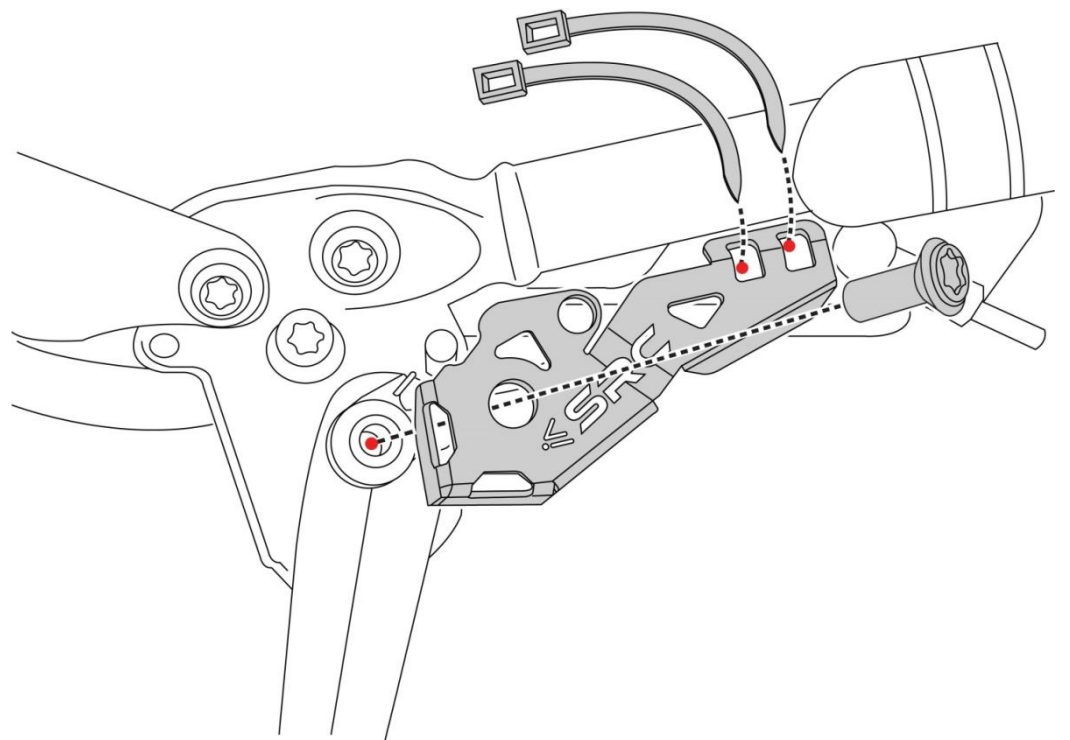

Step: 3

Lead the Cable tie – 2 off, as shown, and inserting them into the slots in the Guard, tie it around the Stand stem.

SRC Kick Stand Sensor Guard protects the, sensor, its mount and the sensor connector, as shown.

Final mounted condition of the Sensor Guard is as shown.

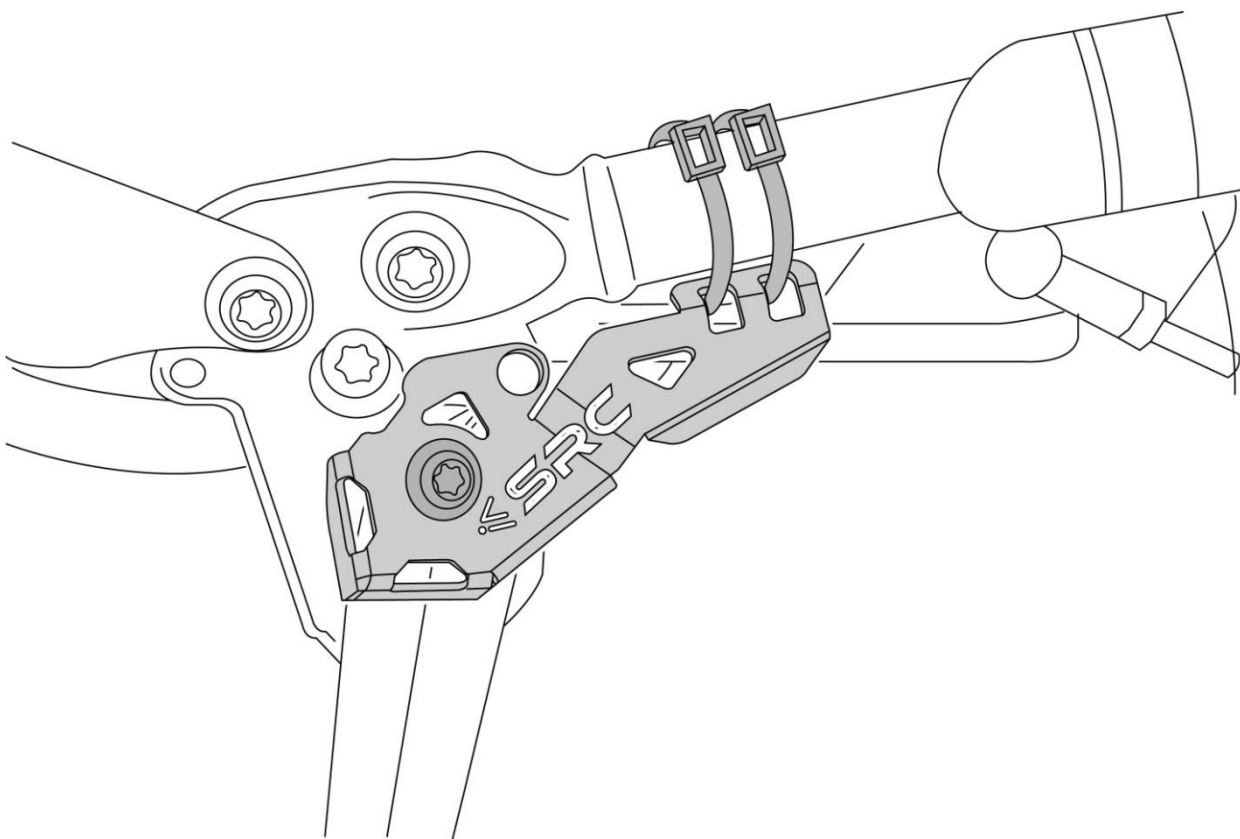

General Instructions

1. We request you to pay attention to the Mounting Instructions in this document and follow the step-by-step procedures.
2. This Mounting Instruction manual is a “Do It Yourself” (DIY) fitment manual of the Accessory part to the Vehicle. We have prepared this based on our experience and knowledge, related to the Vehicle, Part and its functional aspects.
3. SRC cannot guarantee the interchangeability of the parts to any other manufacturer’s accessory part. It is advised to the User, to inspect and ensure the original state of all other Vehicle parts.
4. We request you to bear in mind, that the Installed part can change the driving behaviour and/or the stability during driving or any other dynamic conditions.
5. If you have the appropriate tools and another person to assist you in the mounting, it will help.
6. After Completion of the Mounting and before taking on a First ride, Ensure and Check all functions of the Vehicle. It is always advised to check loosening of the fasteners after the first 50 kilo meters of ride and at regular intervals.
7. We are showing here the Scope of Supply/ Installation/Parts list & BOM from SRC
8. To the maximum extent possible, our design use the current Mounting/Fitment of the Original Equipment, so that Installation of these accessories will not affect the Payload or Function of the Vehicle or the Part on which it is mounted to protect it.
9. If any additional modifications are to be done, prior to the fitment of the accessories, it will be explicitly specified in the instruction sheets.