

Note!

Before installing this product, check the contents of the kit. If anything is missing, please check an Öhlins dealer.

Kit Contents

Description	Part No	Pcs
Shock absorber	SU 916	1
Bracket	01165-20	1
Nut M6	00430-02	4
Screw M6x25	05404-06	2
Screw M6x20	05404-03	2
Washer 6.3/10/1.2	60426-04	2
Washer 6.4/17/3	15875-01	4
Sticker set	10207-01	1
Owners manual road & track	07241-02	1

Note!

Please note that this image is a general representation of the product and may differ slightly from your product.

Note!

Please note that during storage and transportation, especially at high ambient temperature, some of the oil and grease used for assembling may leak and stain the packaging. This is in no way detrimental to the product, wipe off the excessive oil/grease with a cloth.

Warning!

Before installing this product, read the Öhlins Owner's Manual. The shock absorber is an important part of your vehicle and will affect the stability.

Shock Absorber for Suzuki V-STROM 650 XT

SU 916

Mounting Instructions

MOUNTING INSTRUCTIONS

⚠ Warning!

It is advisable to have an Öhlins dealer install the shock absorber.

⚠ Warning!

If working on a raised vehicle, ensure it is securely supported so that it will not tip over.

👁 Note!

Before mounting this product clean the vehicle thoroughly.

👁 Note!

When working on this product, always see the Vehicle Service Manual for vehicle specific procedures and important data.

1.
Put the motorcycle on a work stand so that the rear wheel barely touches the ground. Make sure the motorcycle is in a stable position.

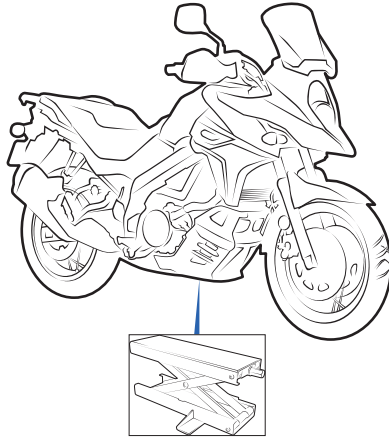

2.
Loosen the screws ① ② on the right side of the motorcycle in order to remove the standard preload adjuster ①.

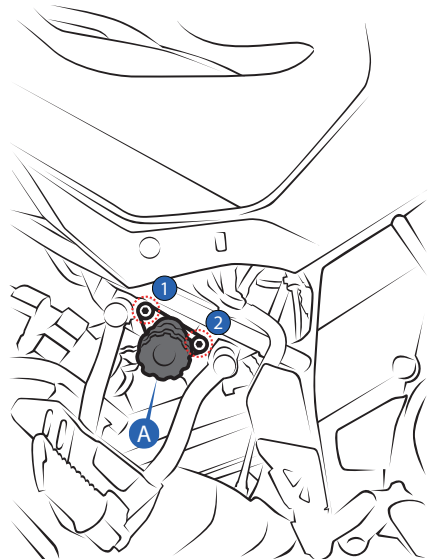

MOUNTING INSTRUCTIONS

3.

Loosen the linkage bolt ① and the mounting bolts ② ③ in order to remove the standard shock absorber.

3.1

Install the ohlins shock absorber with the hose pointing to the right side of the motorcycle.

Tighten the upper and lower mounting bolts at a torque value as specified in the vehicle service manual.

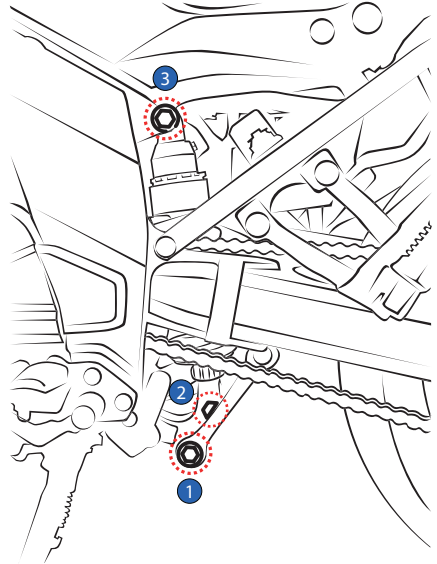

4.

Install the preload adjuster knob ⑥ onto the metal bracket ⑦ as per diagram 4.0.

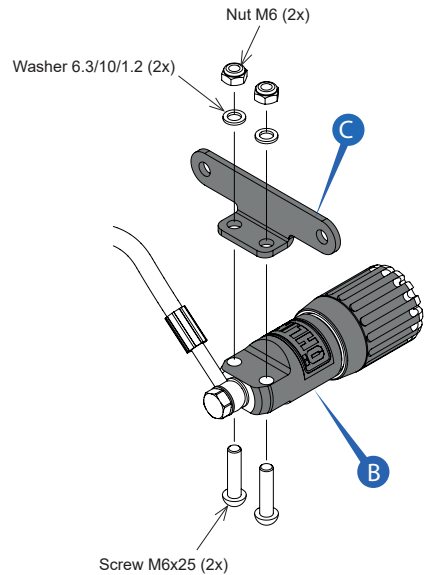

Diagram 4.0

MOUNTING INSTRUCTIONS

5.
Install the metal bracket **C** as per diagram 5.0.

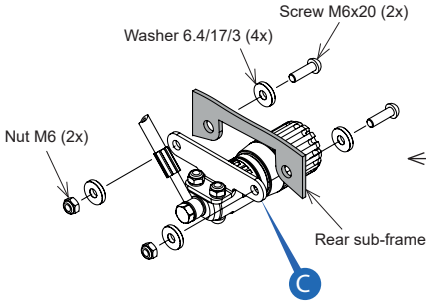
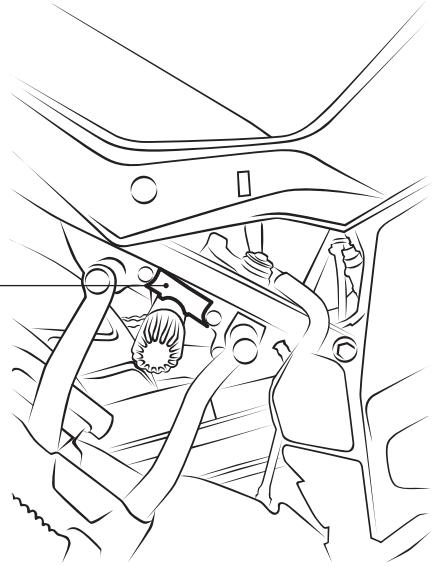

Diagram 5.0



Reverse all the procedure as necessary.

Note!

Lower the vehicle so that the suspension is slightly compressed before tightening the screws.

Caution!

Ensure that all screws are tightened to the correct torque and that nothing fouls or restricts movement of the shock absorber when the suspension is fully compressed or extended.

MOUNTING INSTRUCTIONS

Page intentionally left blank

MOUNTING INSTRUCTIONS

Page intentionally left blank

MOUNTING INSTRUCTIONS

Page intentionally left blank

ADJUSTMENTS

Warning!

Before riding, always make sure that the basic settings made by Öhlins are according to recommended Set-up Data. Read about adjustments and setting up in the Öhlins Owner's Manual before you make any adjustments. Contact an Öhlins dealer if you have any questions about setting up.

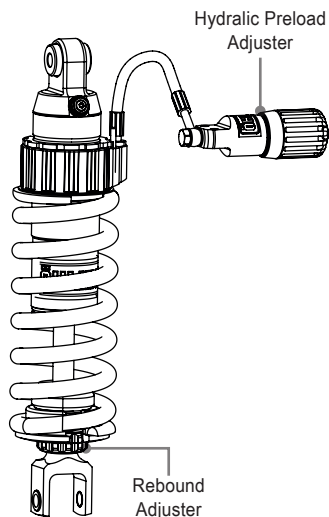

SET-UP DATA

Recommended set-up

Spring Preload..... 14 mm.
Rebound adjuster 14 Clicks

Shock absorber data

Length 340.5 mm.
Stroke 71.5 mm.

Spring

Part No 61111-36
Free spring length... 200 mm.
Spring rate 105 N/mm
Preload adj.range ... [0-8] mm

 Öhlins products are subject to continuous improvement and development, therefore, although these instructions include the most up-to-date information available at the time of printing, minor updates may occur.

To find the latest information contact an Öhlins distributor. Please contact Öhlins if you have any questions regarding the contents in this document.

Part no. MI_SU916_EN_0
Issued 2019-09-30

© Öhlins Asia Co. Ltd. All rights reserved. Any reprinting or unauthorized use without the written permission of Öhlins Racing AB is prohibited.

Öhlins Asia Co. Ltd
700/937 Moo5, Tambol Nongkhaga,
Amphur Phantong, Chonburi Province
20160 Thailand



www.ohlins.com