

Scope of Supply/Bill of Material & Mounting Drawings

Part Number: H-CB500X-04-01-AL / H-CB500X-04-02-AL

Part Description: Rack – HONDA CB500 X

Installation / Parts List / Bill of Material for Mounting

NO.	Description	Quantity	Torque * (N-M)	Remarks **
1	Top Plate	1		
2	Bracket LH	1		
3	Spacer	4		
4	Bracket RH	1		
5	Washer M6	4		
6	Screw M6 X 25	4	9 - 10	Use Liquid Thread Locker
7	Nut M6	4	9 - 10	Use Liquid Thread Locker
SRC Design uses Metric System of Measurement and all dimensions in Millimeters				
* Recommended to use the Torque specified in the table				
** Denotes Usage of Liquid Thread Locker in specified Locations				

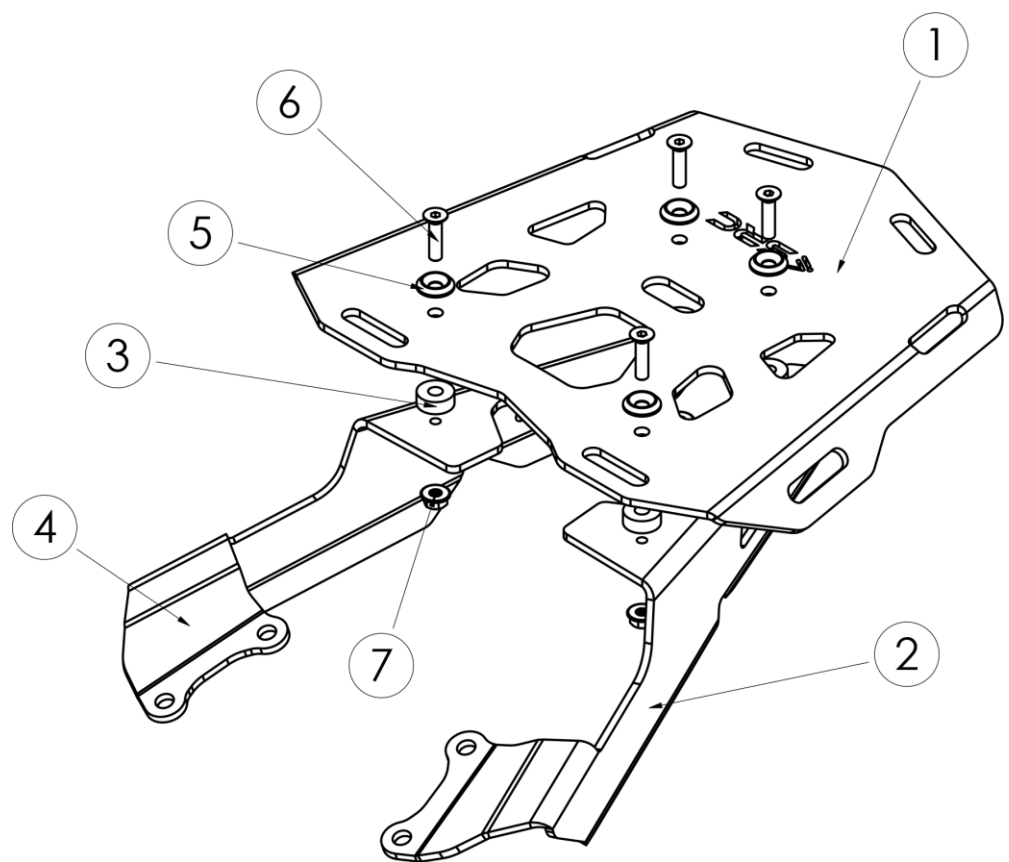
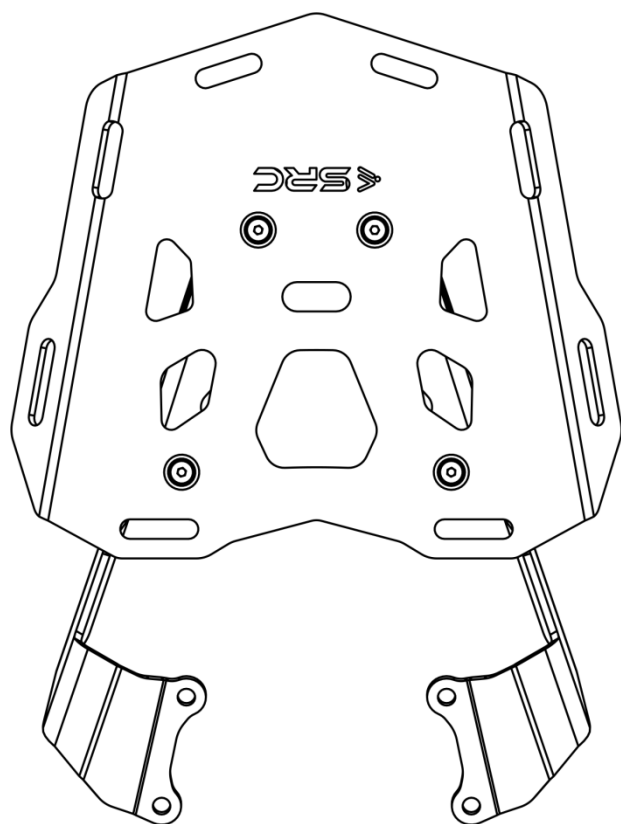

MOUNTING DRAWINGS

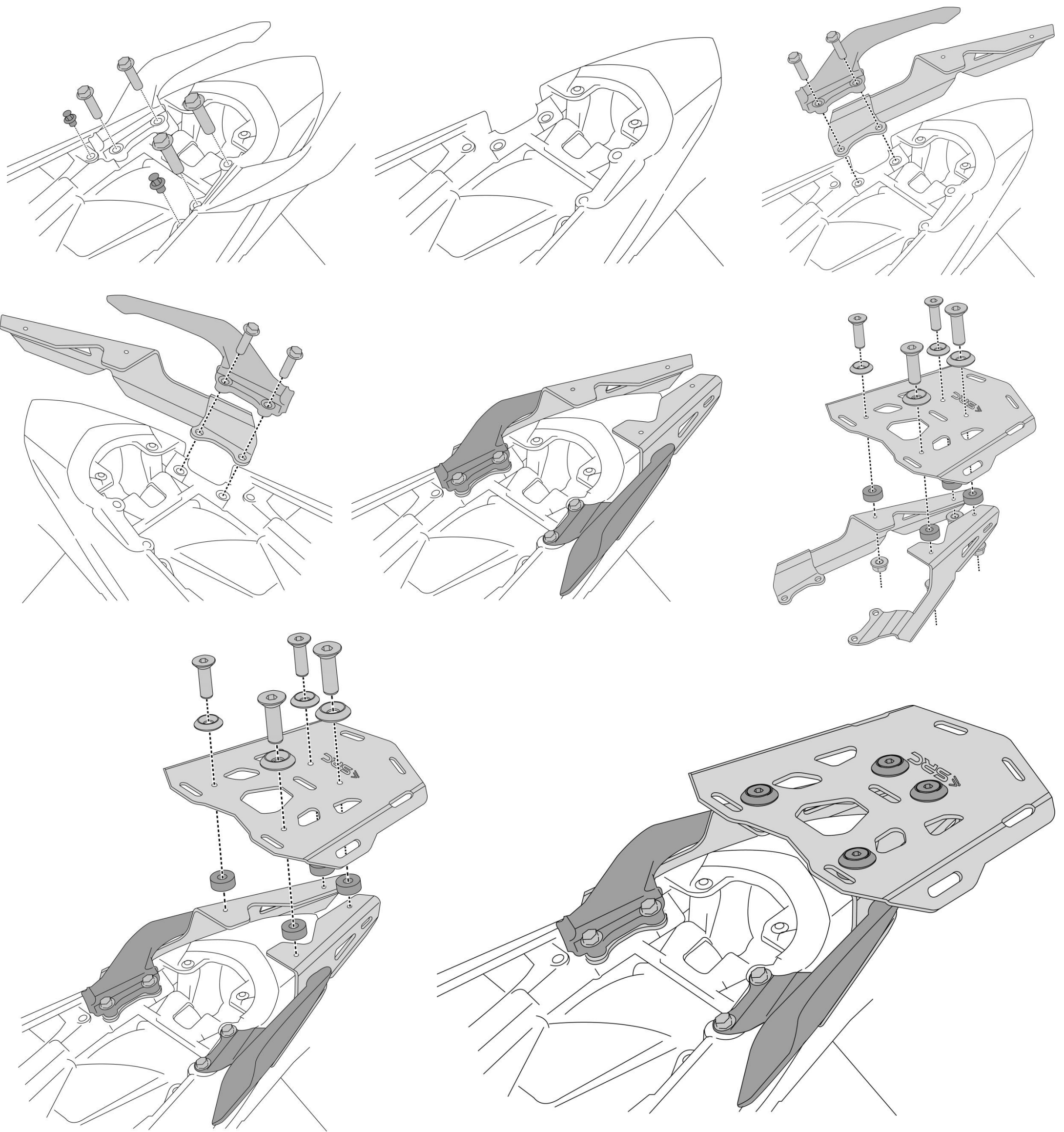

Step 1:

Before starting to mount the Rear Rack, we have to unscrew the Mounting bolts (as shown) of the Side Panel on both sides. Since, SRC Rear Rack Mounting Brackets (LH & RH) takes the same mounting as that of the Side panel; it is the first step in the Mounting process

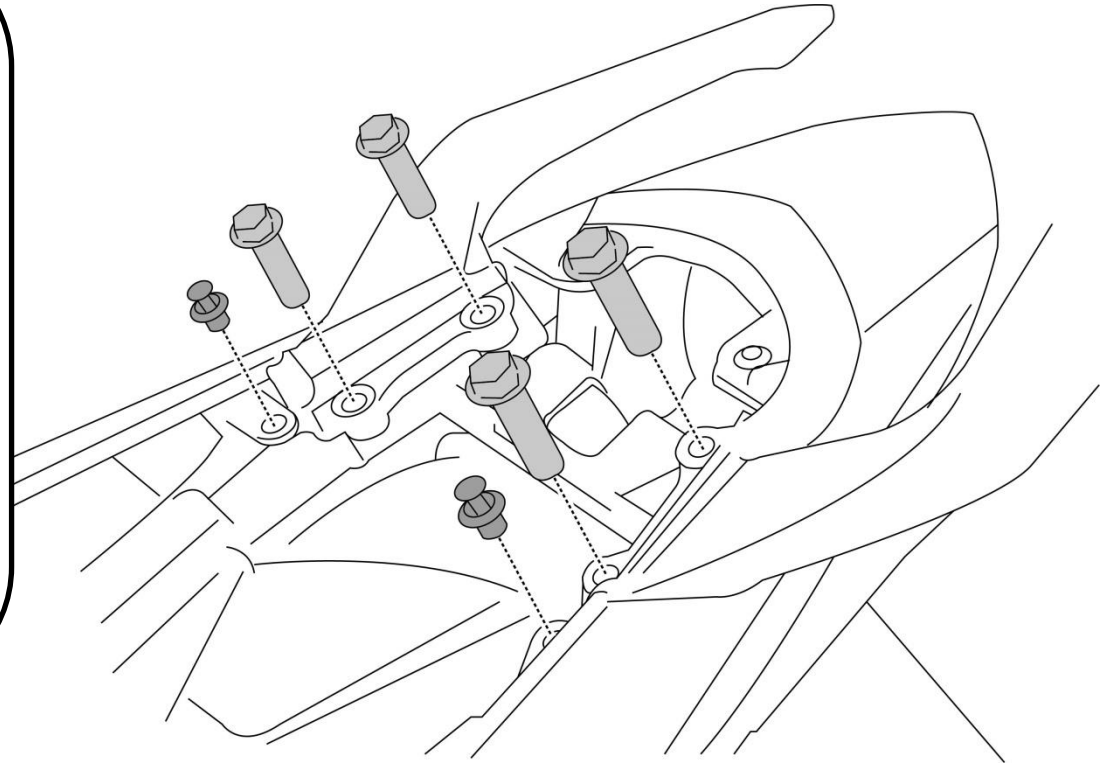

The drawing shown here, is the “As is dismantled condition of the Side panels”

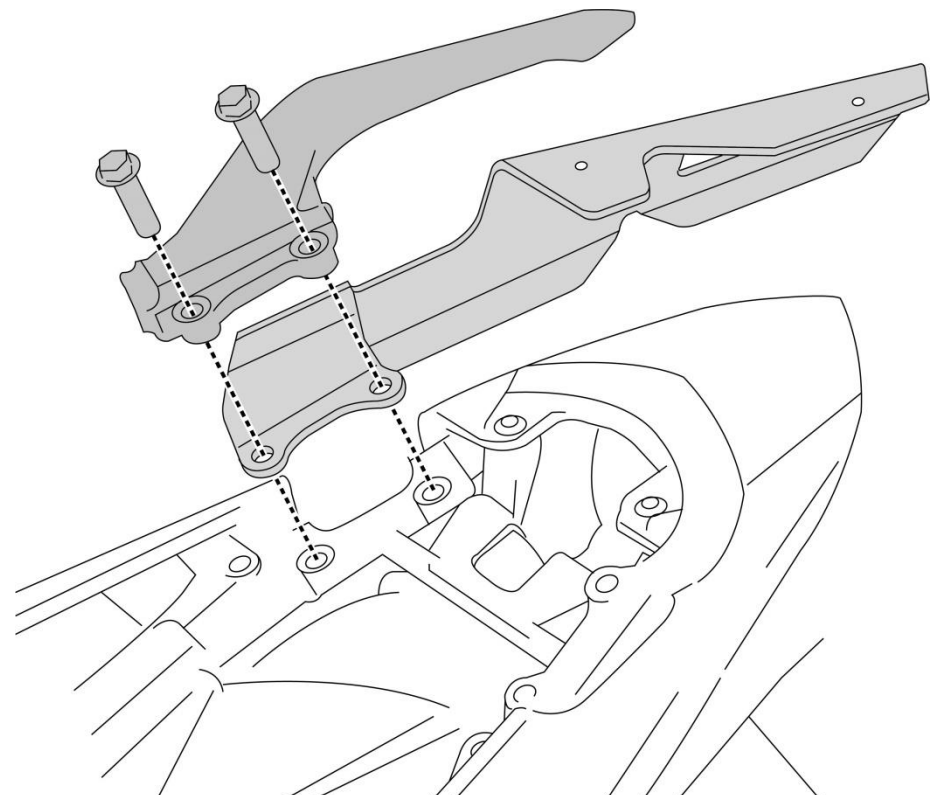
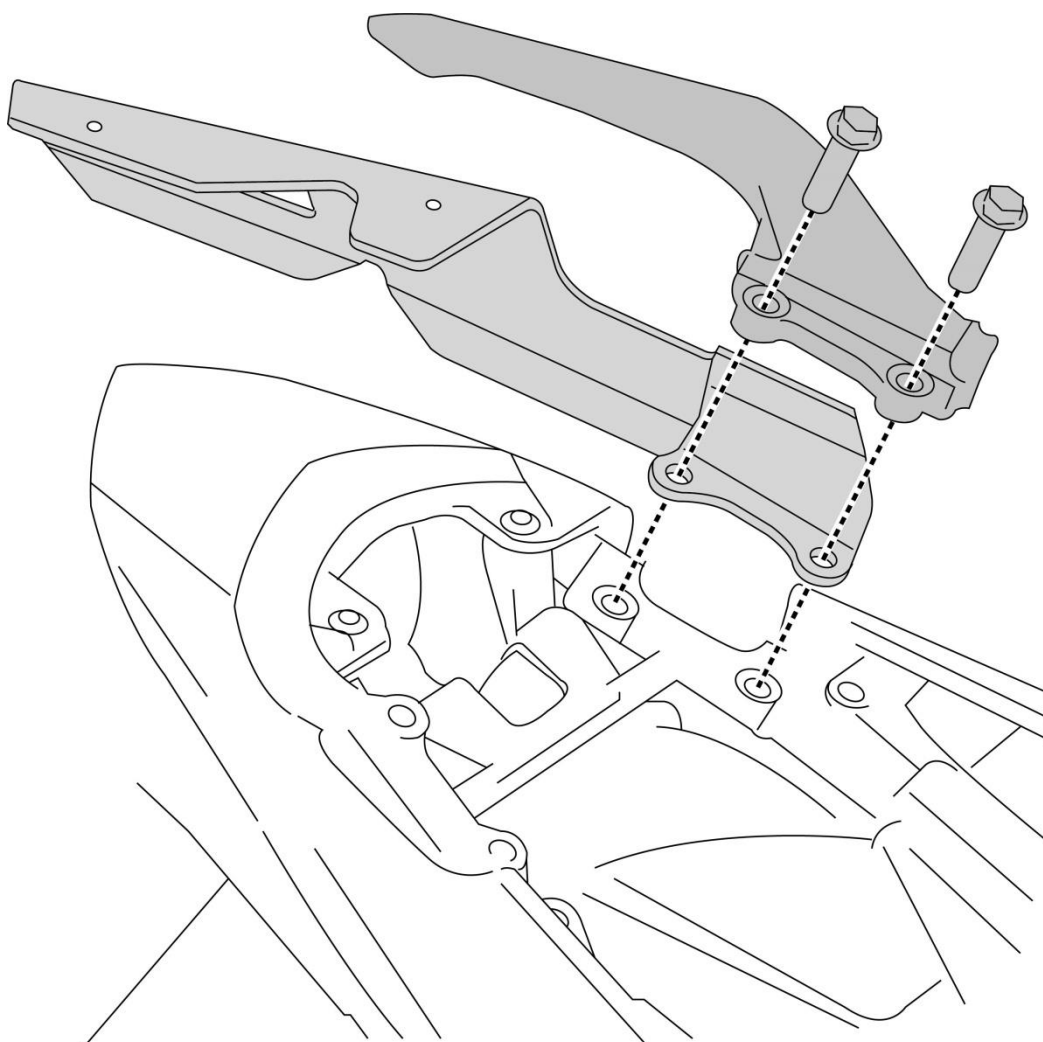
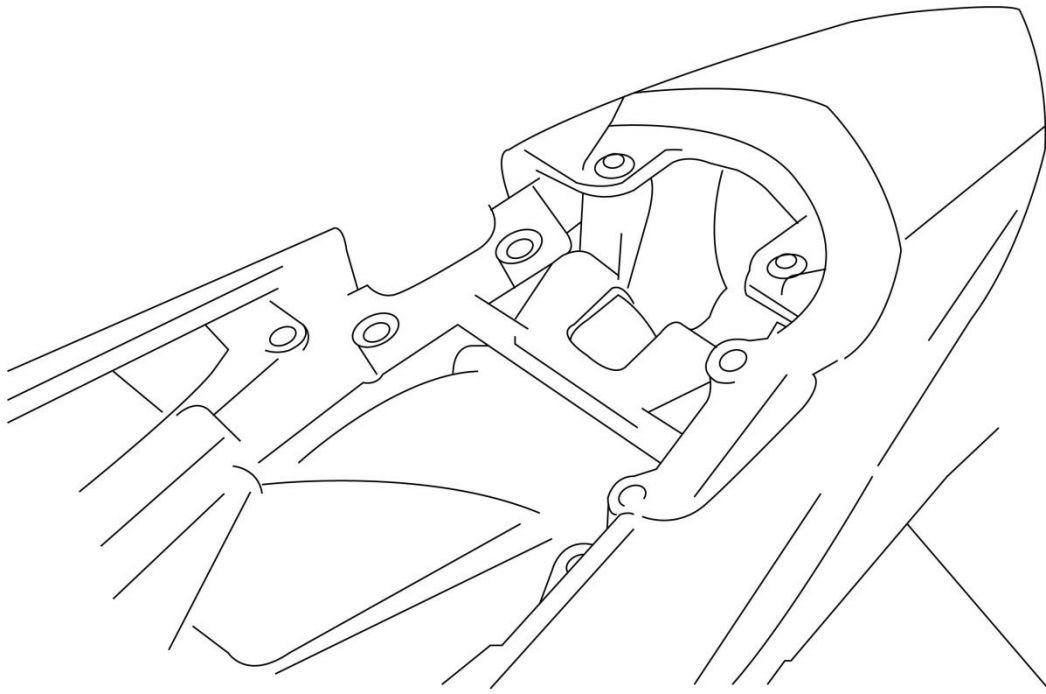

Step 2 & 3:

Orient and align the Bracket LH (2) and Bracket RH (4) in-line with the Side Panel mounting holes, and bring the Side panels exactly in-line with them, and slip-in the Mounting bolts (2 off) on each side and secure the threads

Ensure the Side Panels are flush mounted on top of the Bracket LH & RH, as shown, and the bolts tightened fully

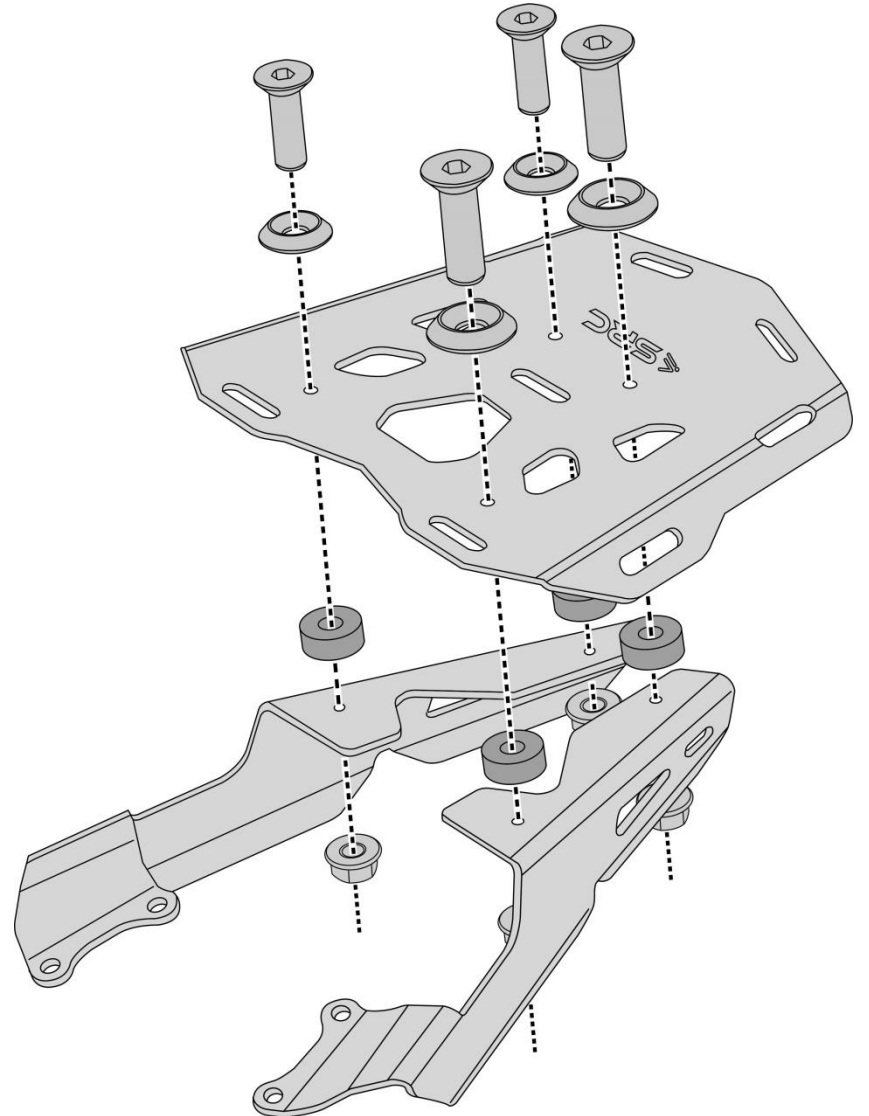
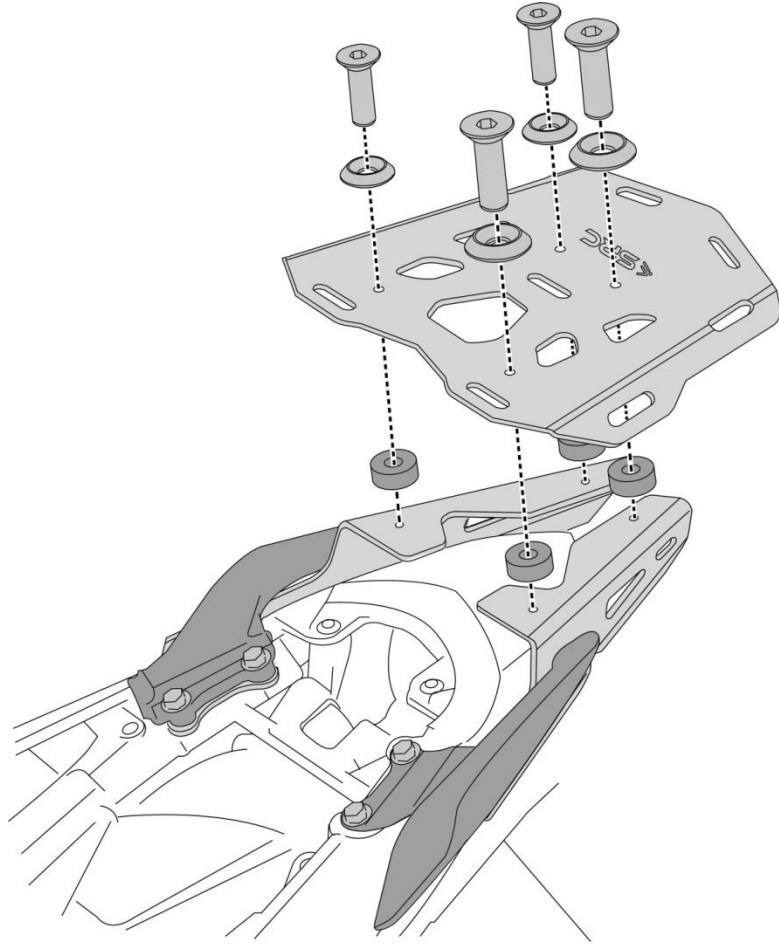
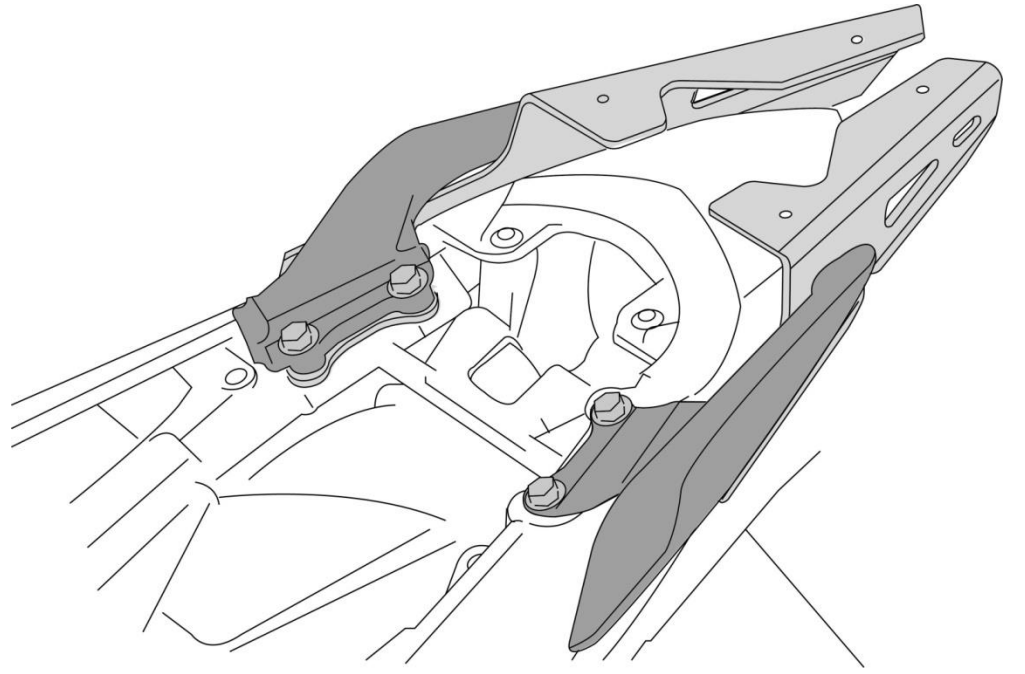

Step 4:

Slip in the Spacer (3) – 4 off in between the Bracket LH/RH and the Rear Rack and slip-in the Washer M6 (6) and Screw M6 x 25 (7) through the Mounting holes in the Rear Rack and Brackets and, secure from the bottom, using the Nuts (M6) (8) – 4 off and tighten it to the torque as shown in the BOM table

Rear Rack as shown “Final Assembled condition”

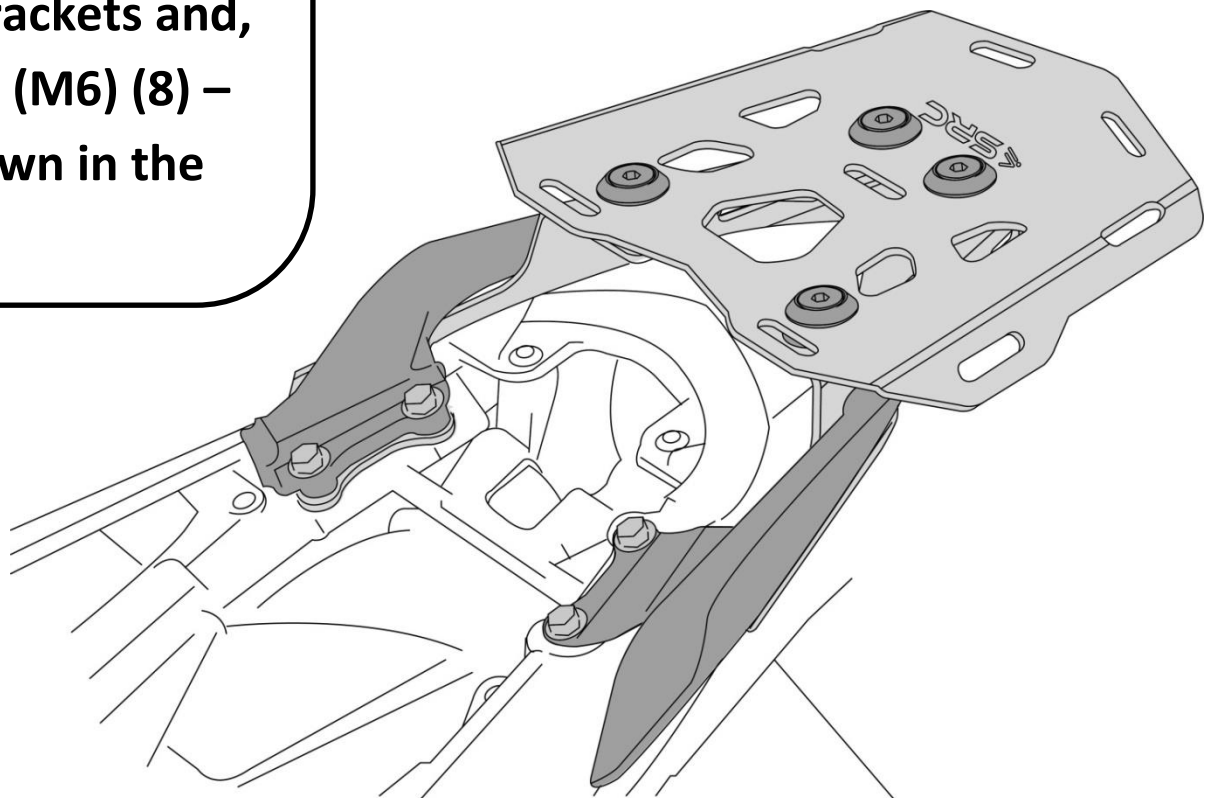

General Instructions

1. We request you to pay attention to the Mounting Instructions in this document and follow the step-by-step procedures.
2. This Mounting Instruction manual is a “Do It Yourself” (DIY) fitment manual of the Accessory part to the Vehicle. We have prepared this based on our experience and knowledge, related to the Vehicle, Part and its functional aspects.
3. SRC cannot guarantee the interchangeability of the parts to any other manufacturer’s accessory part. It is advised to the User, to inspect and ensure the original state of all other Vehicle parts.
4. We request you to bear in mind, that the Installed part can change the driving behaviour and/or the stability during driving or any other dynamic conditions.
5. If you have the appropriate tools and another person to assist you in the mounting, it will help.
6. After Completion of the Mounting and before taking on a First ride, Ensure and Check all functions of the Vehicle. It is always advised to check loosening of the fasteners after the first 50 kilo meters of ride and at regular intervals.
7. We are showing here the Scope of Supply/ Installation/Parts list & BOM from SRC
8. To the maximum extent possible, our design use the current Mounting/Fitment of the Original Equipment, so that Installation of these accessories will not affect the Payload or Function of the Vehicle or the Part on which it is mounted to protect it
9. If any additional modifications are to be done, prior to the fitment of the accessories, it will be explicitly specified in the instruction sheets.