

Scope of Supply/Bill of Material & Mounting Drawings

Part Number: H-CB14-17-01-SL/H-CB14-17-02/H-CB17-17-01-SL/H-CB17-17-02/
H-CB19-17-01-SL/H-CB19-17-02

Part Description: Crash Bar HONDA CB500 X
Applicable to both Stainless Steel and Steel Versions

Installation / Parts List / Bill of Material for Mounting

No.	Description	Quantity	Torque * (N-m)	Remarks **
1	Crash Bar RH	1		
2	Crash Bar LH	1		
3	Slider Guard	2		
4	Housing for Long Bolt	1		
5	Upper Plate	1		
6	Ring	1		
7	Pin Pipe	1		
8	Screw M6 x 15	4	9-10	Use Liquid Thread Locker
9	Screw M8 x 20	1	22-24	Use Liquid Thread Locker
10	Screw M8 x 45	2	22-24	Use Liquid Thread Locker
11	Screw M10 x 60	2	44-46	Use Liquid Thread Locker
12	Screw M10 x 170	1	44-46	Use Liquid Thread Locker
13	Nut M8	2	22-24	Use Liquid Thread Locker
14	Nut M10	1	44-46	Use Liquid Thread Locker
15	Washer M6	4		
16	Washer M8	3		
17	Washer M10	1		
SRC Design uses Metric System of Measurement and all dimensions are in Millimeters				
* Recommended to use the Torque specified in the table				
** Denotes Usage of Liquid Thread Locker in specified locations				

Schematic Drawing

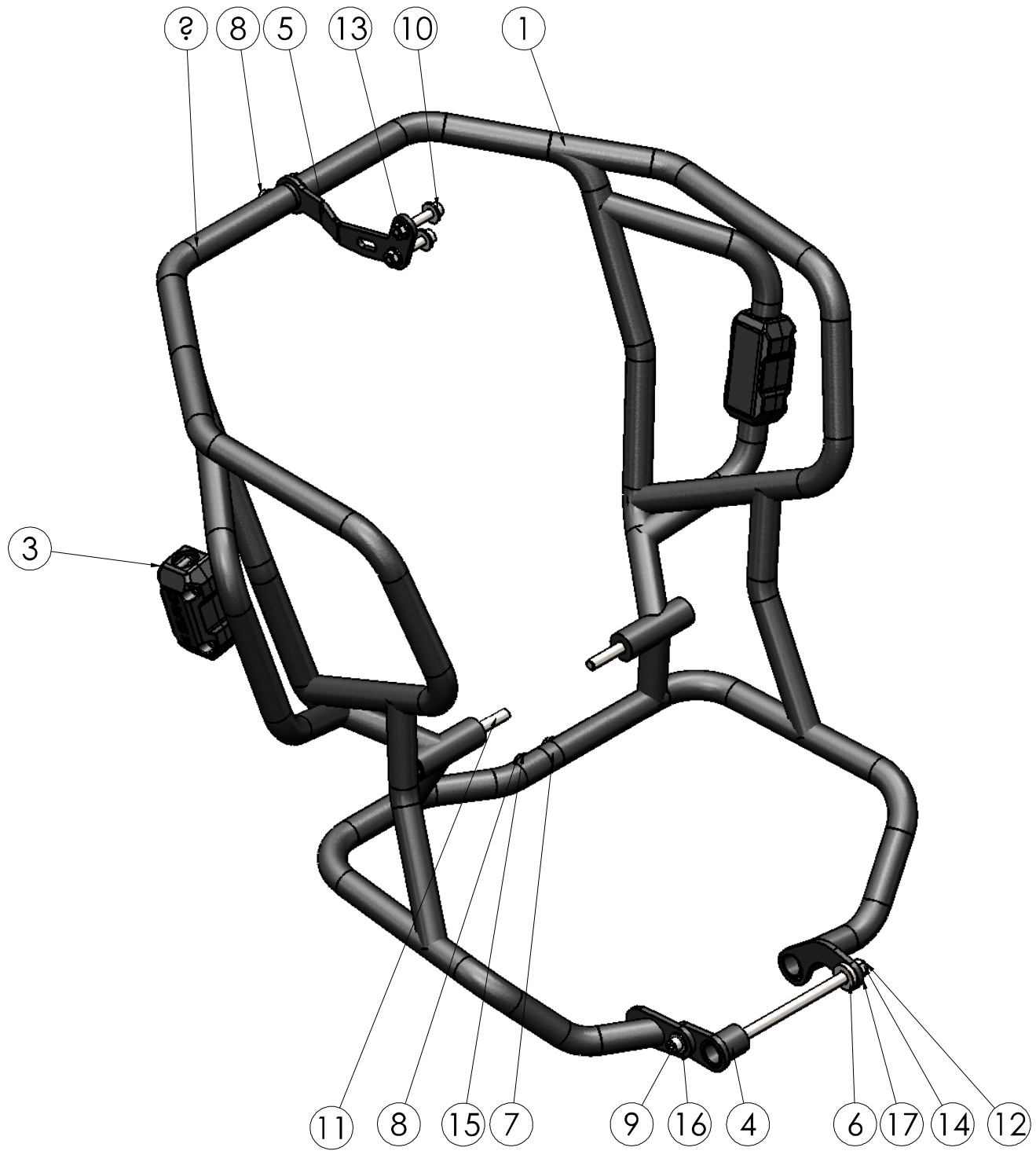

Mounting Drawings

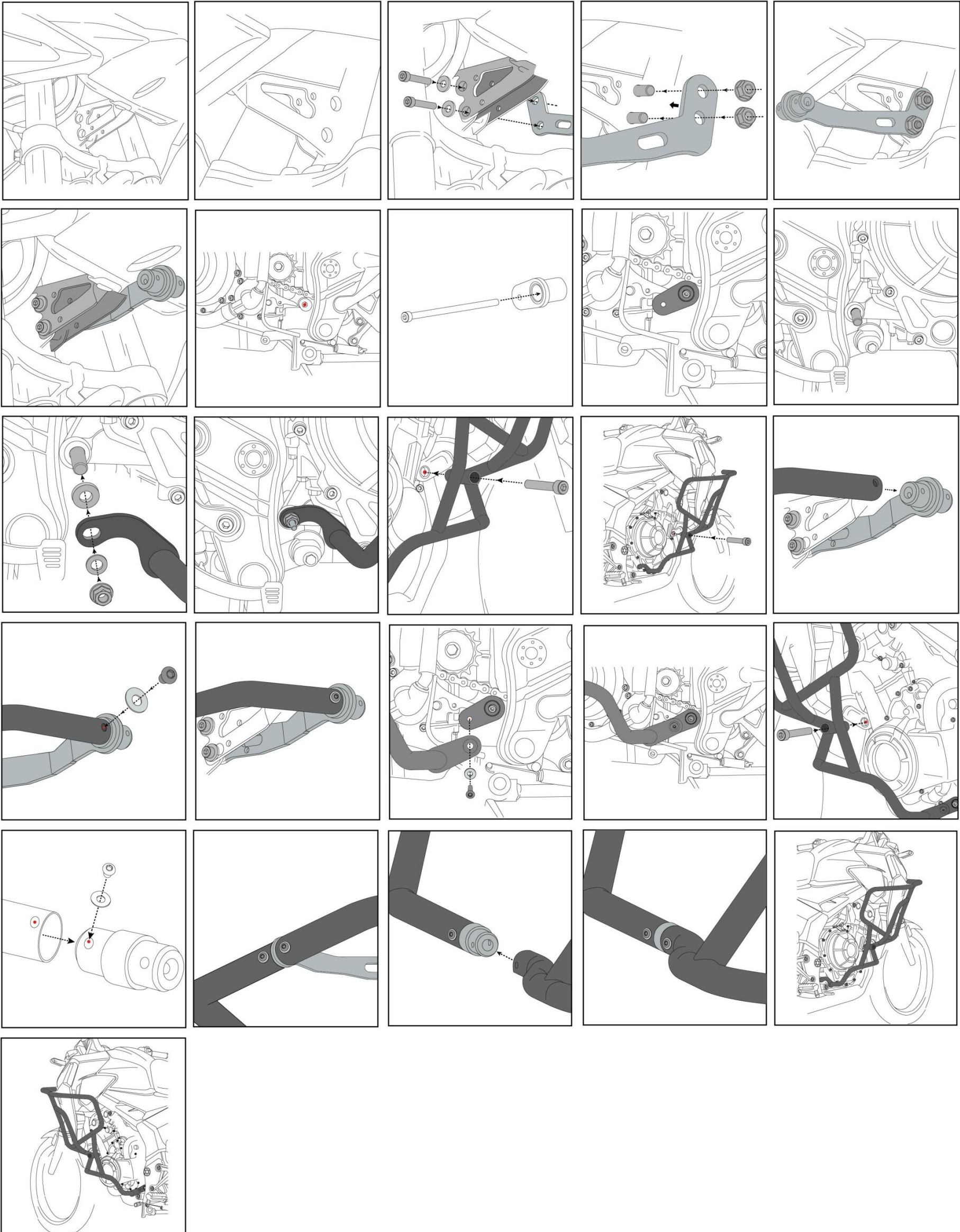

Mounting Drawings

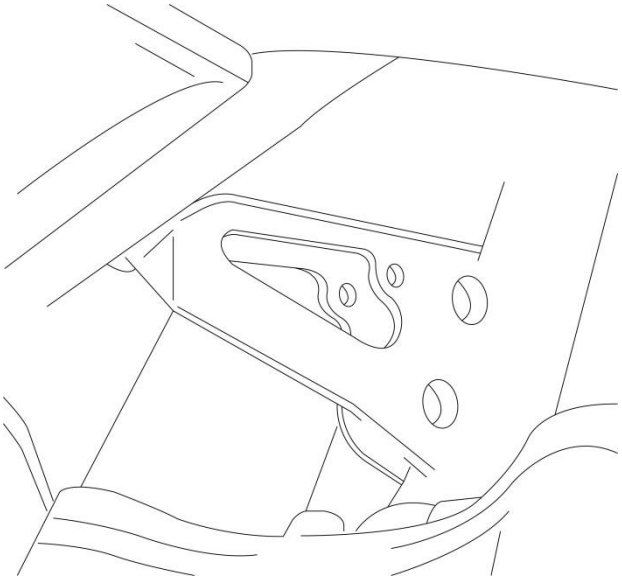
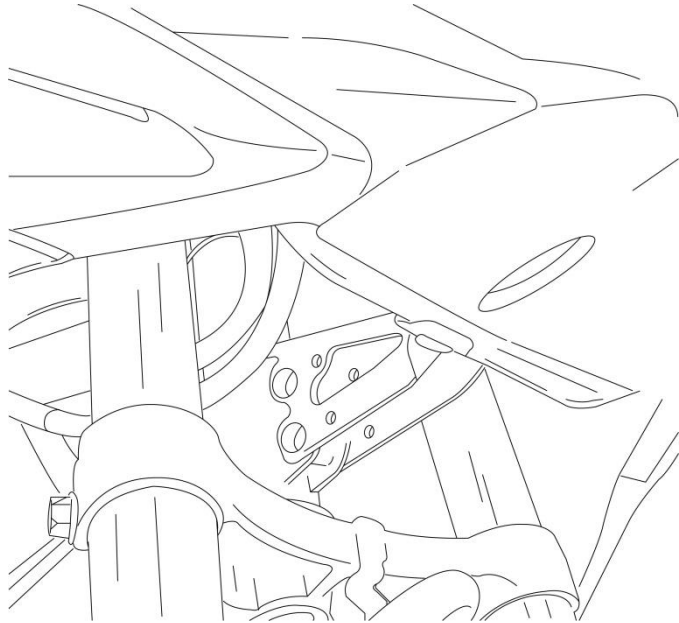

The Mounting Holes for mounting the Upper Plate (5), can be found in-between the front forks and positioned inside, and it is part of the Motorbike Chassis frame.

The drawing to the right shows the two mounting holes, when viewed from the other side.

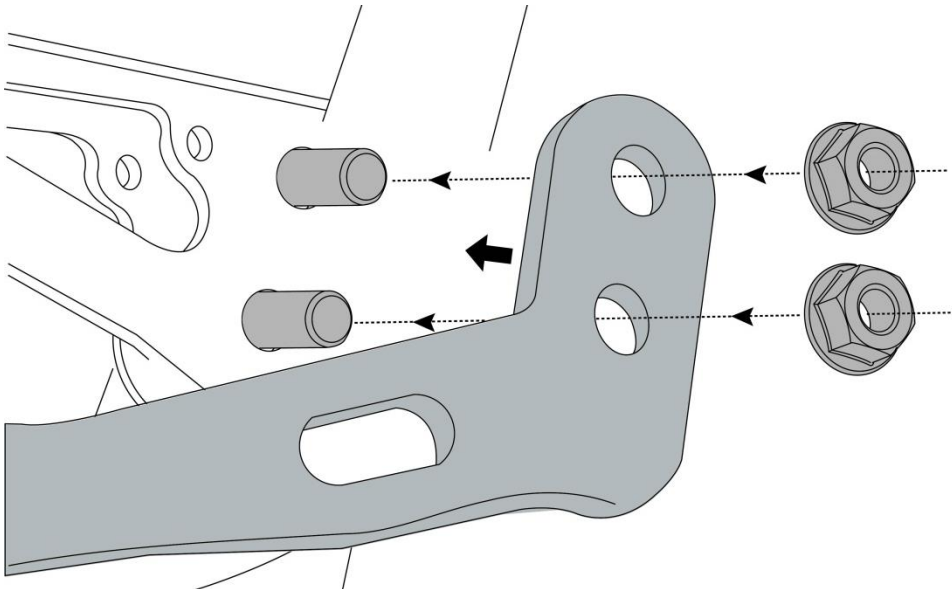
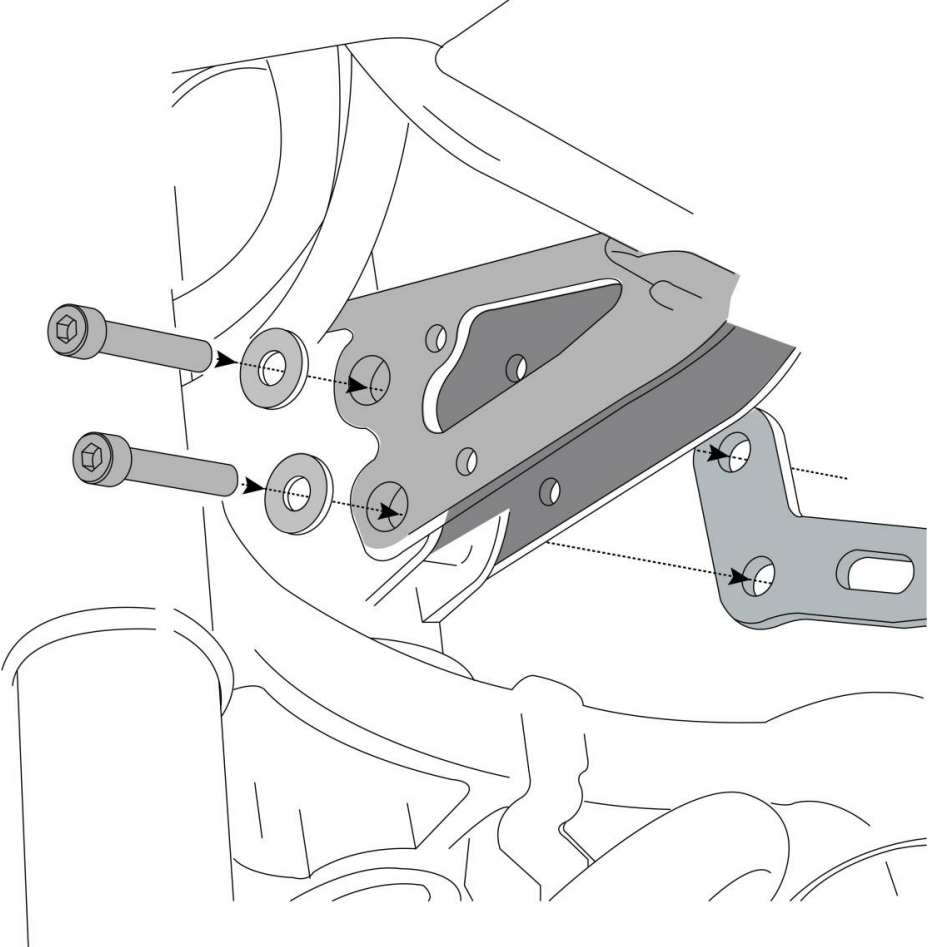

Step 1:

Orient, Mount and Fit the Upper Plate (5) to the Motorbike Chassis frame as shown.

Since the access is limited, Use the Short Hand Tools (Single Ended Spanner or Short Allen Key) to mount this part.

Slide in the Screw M8 x 45 (10) – 2 off, Washer M8 (16) – 2 off as shown, through the Mounting holes in the Chassis bracket and Upper Plate, and secure it by Nut M8 (13) – 2off, from the other side, but do not tighten it fully.

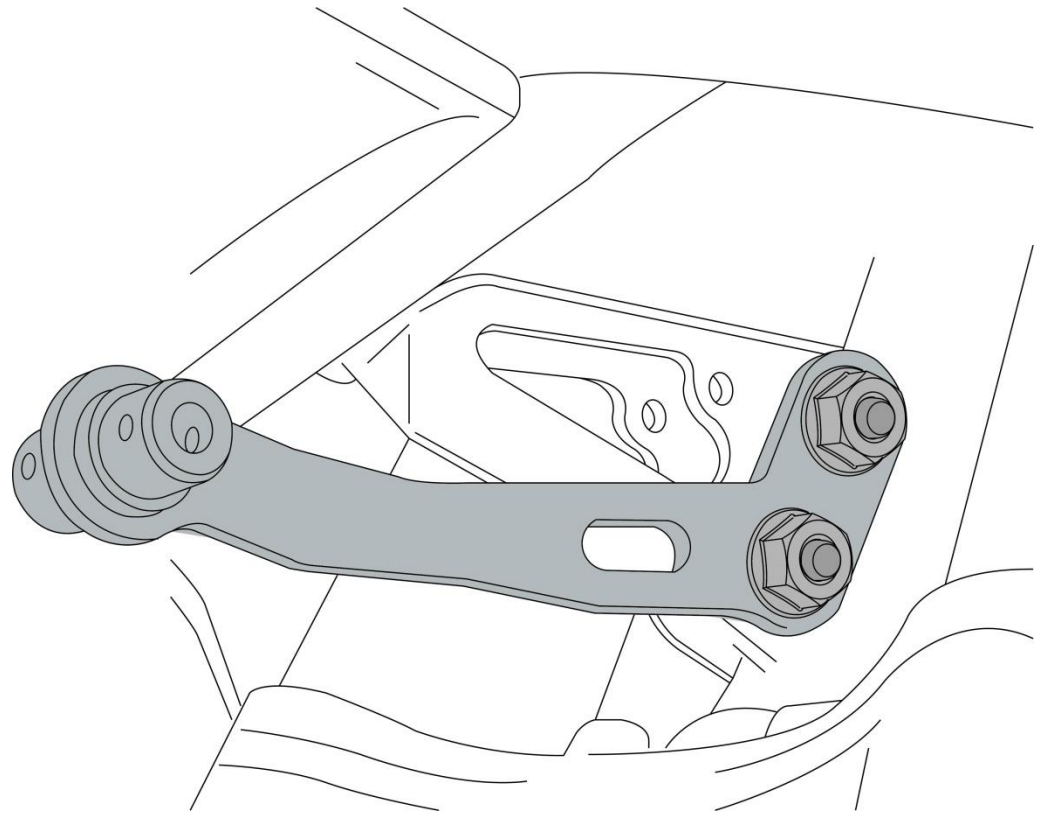
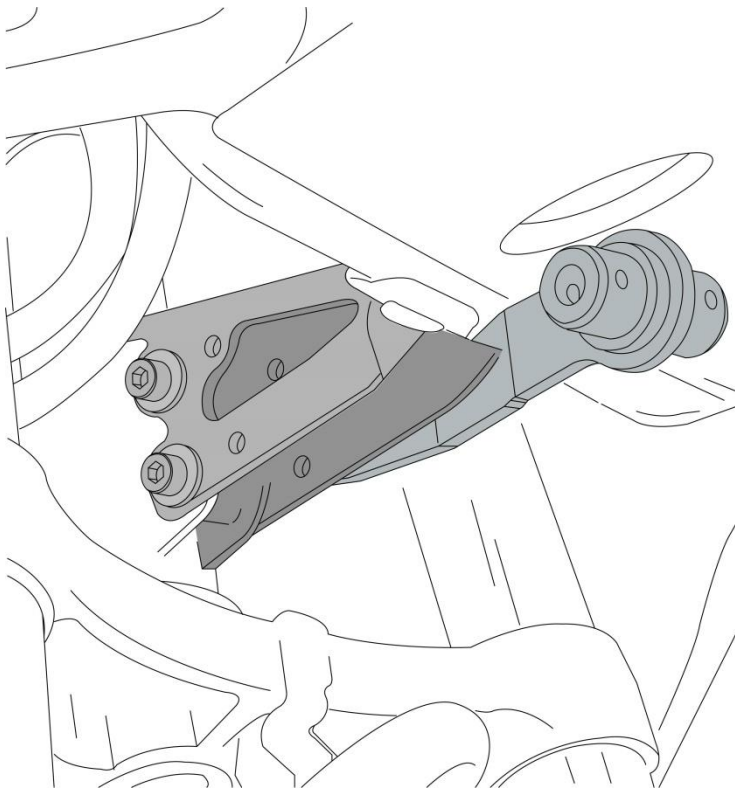

As is Mounted condition of the mounting the Upper Plate is as shown.

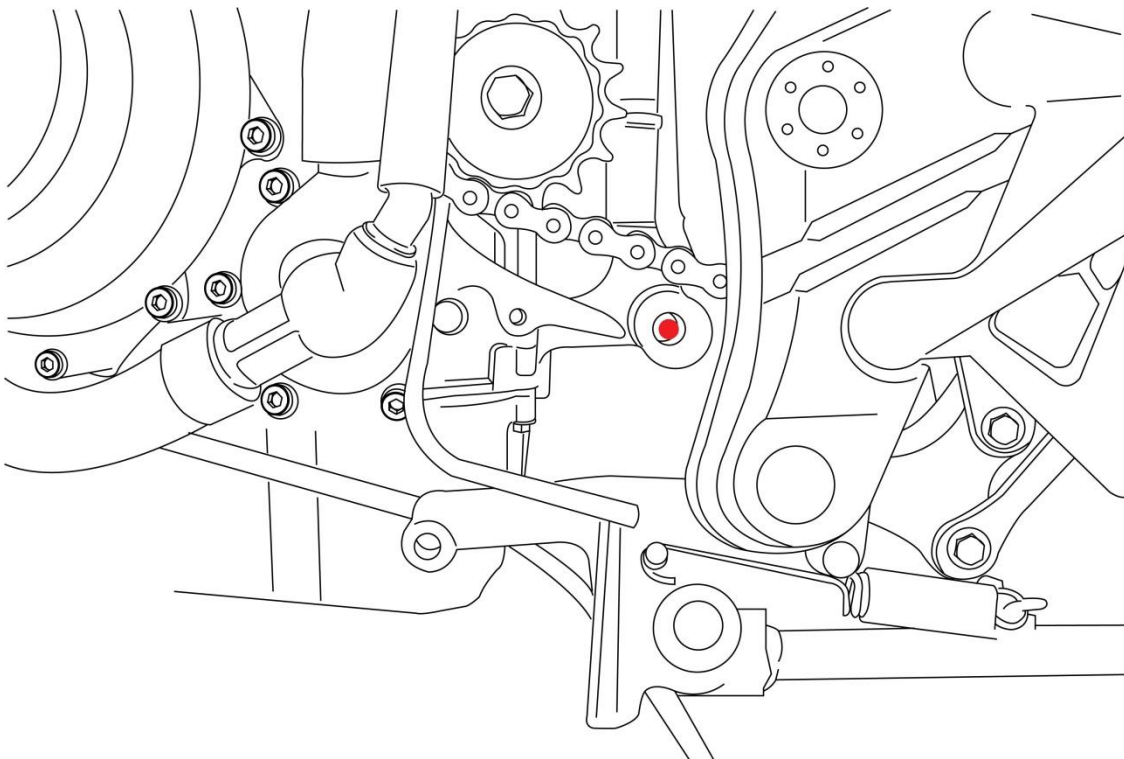

Step 2:

Mounting of the Housing for Long Bolt (4) , Ring (6) and Long Bolt M10 x 170 (12) is by design, to align the bottom side of the Crash Bar to the Motorbike Chassis and to create an axis of balance, for mounting Crash bars from both sides.

The point of mounting is identified in Red colour in the drawing above.

Slide-in the Housing for Long Bolt (4), and Long Bolt M10 x 170 (12), as shown in the drawing on the left side.

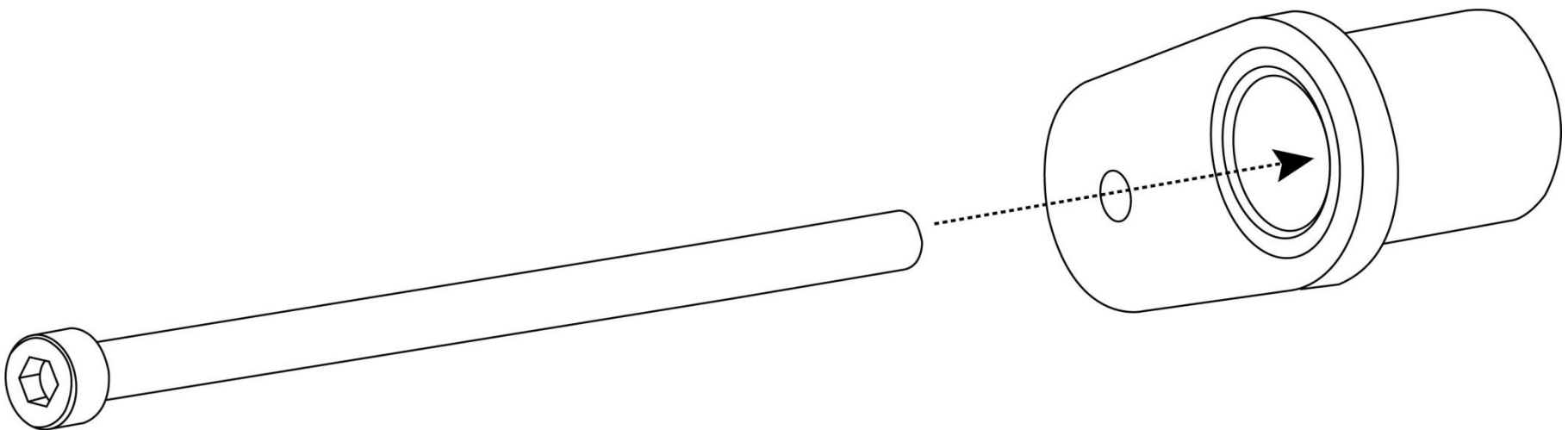

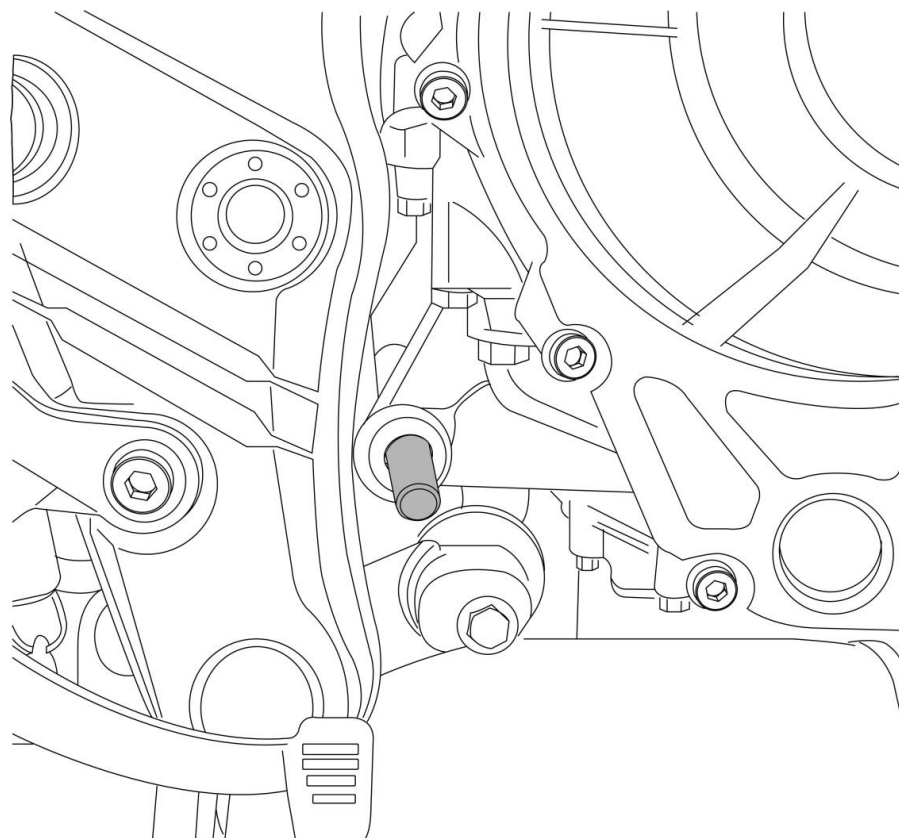
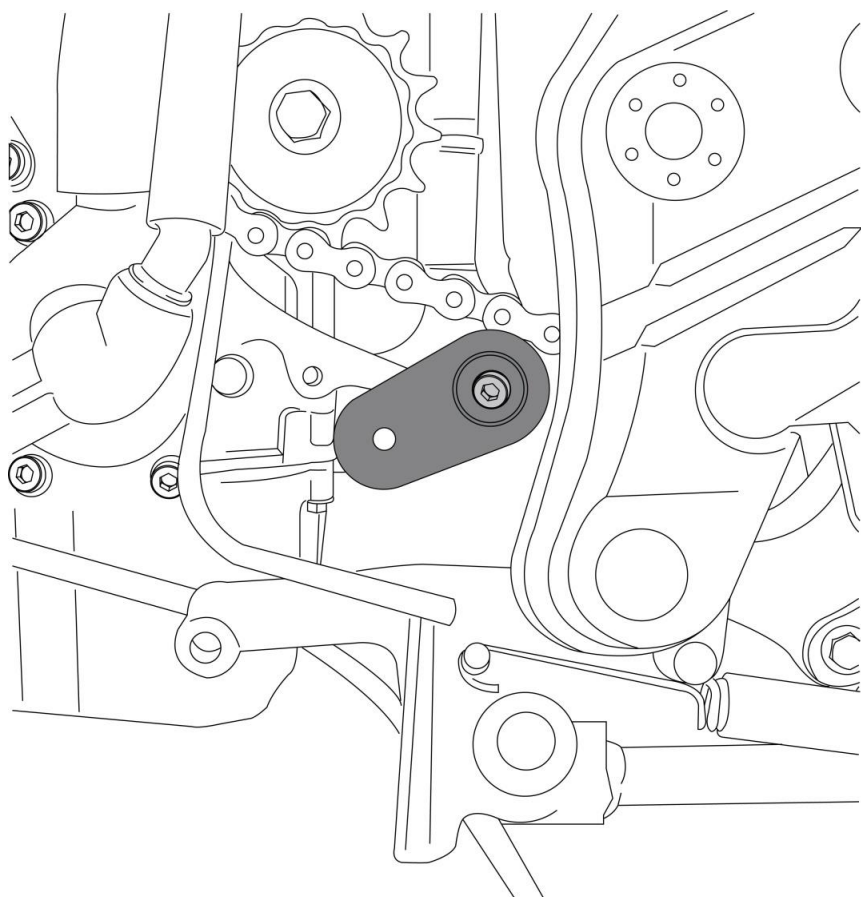

In the subsequent sheets, we will show how the Long Bolt projects outside, for assembling the Ring (6) and fasten it using Washer and Nut.

Projection of the Long Bolt when viewed from the Right Hand side of the Motorbike is shown.

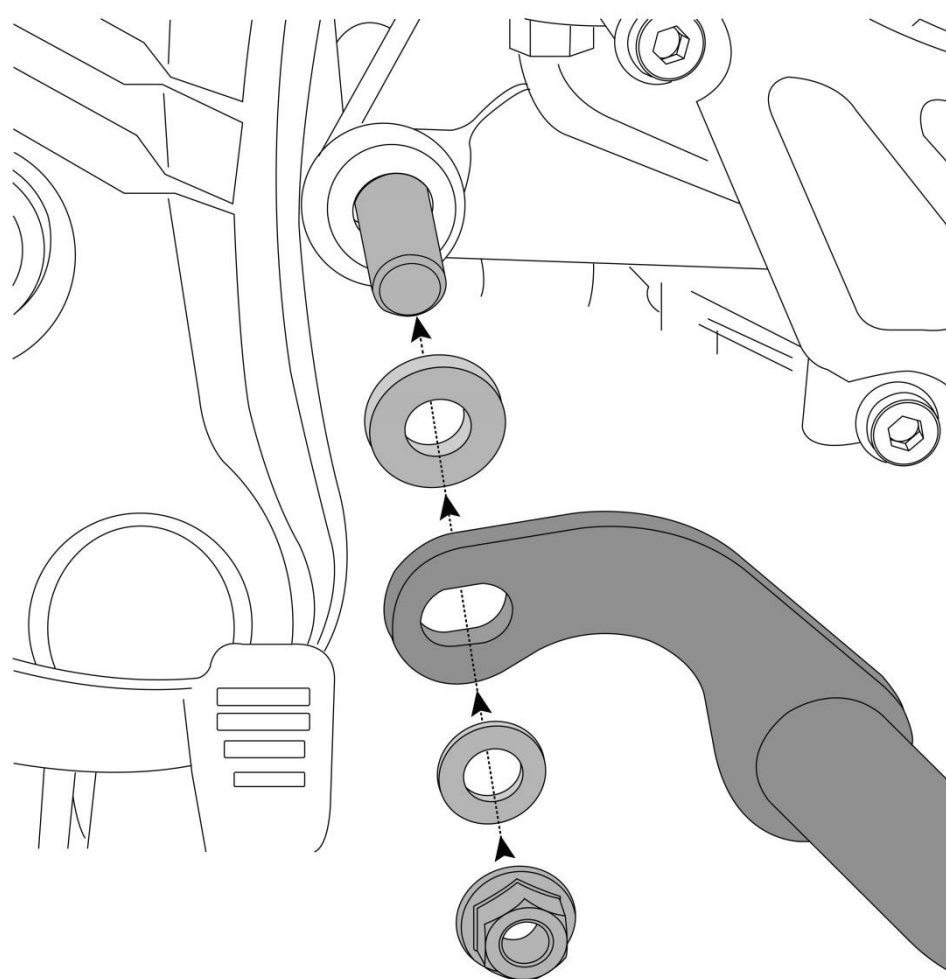

Step 3:

Orient and Align the toe end of Crash Bar RH (1) in-line with the Long Bolt

Slide-in the Ring (6) – 1 off, in front of the toe end of the Crash Bar, and Washer M10 (17) – 1 off and secure the threads in the Long bolt using M10 Nut (17) – 1 off.

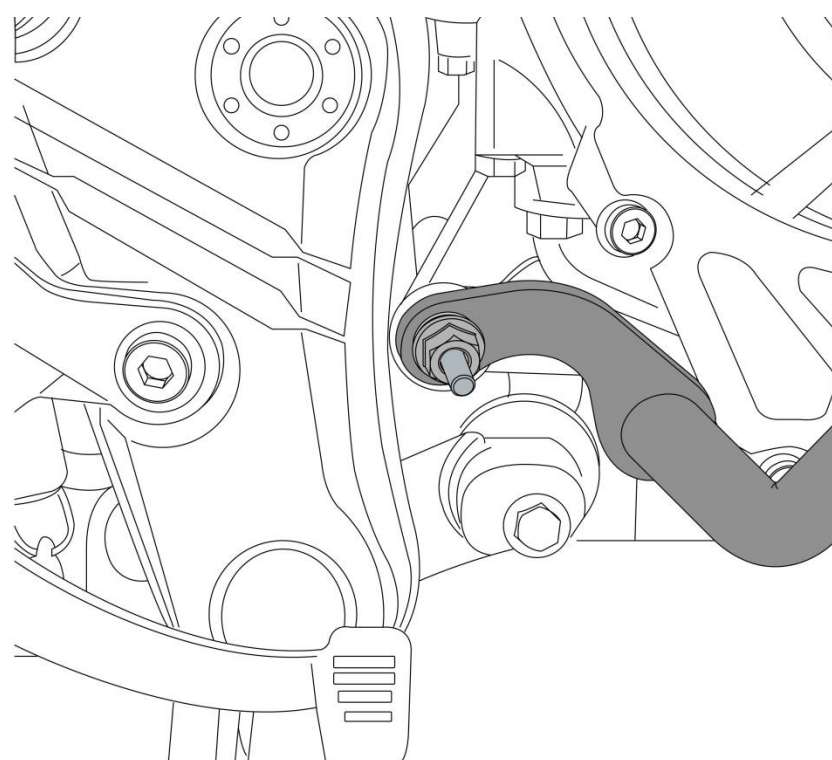

Step 4:

The Steps shown here, is again on the Right Hand Side of the Motorbike and slide-in the Screw M10 x 60 (11),

Secure the threads in the Mounting hole (Identified in Red colour) shown.

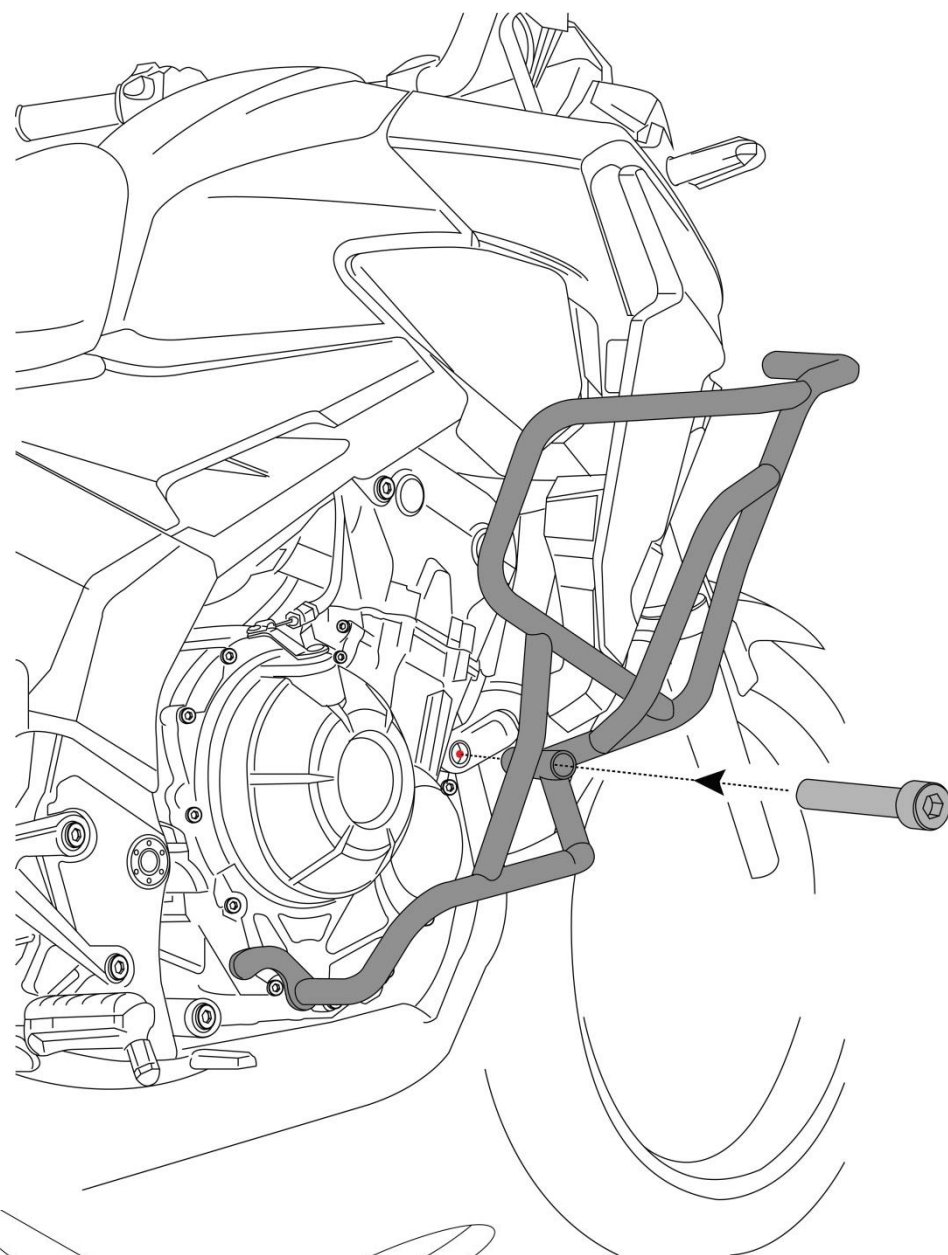
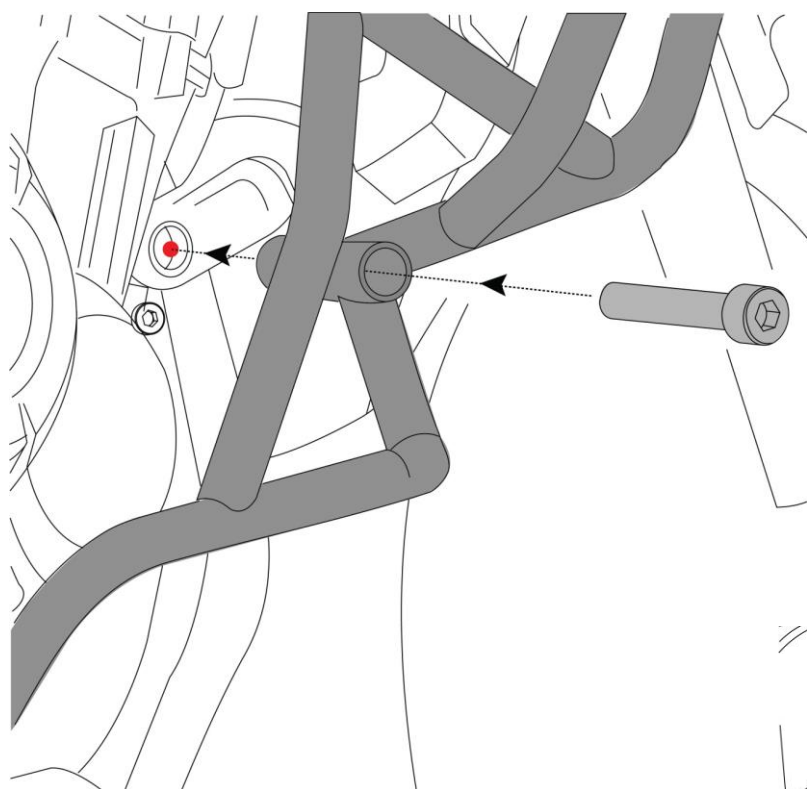

The Upper Plate which was mounted in Step 1, is shown here for clarity, where the Top End of the Crash Bar RH has to be fitted.

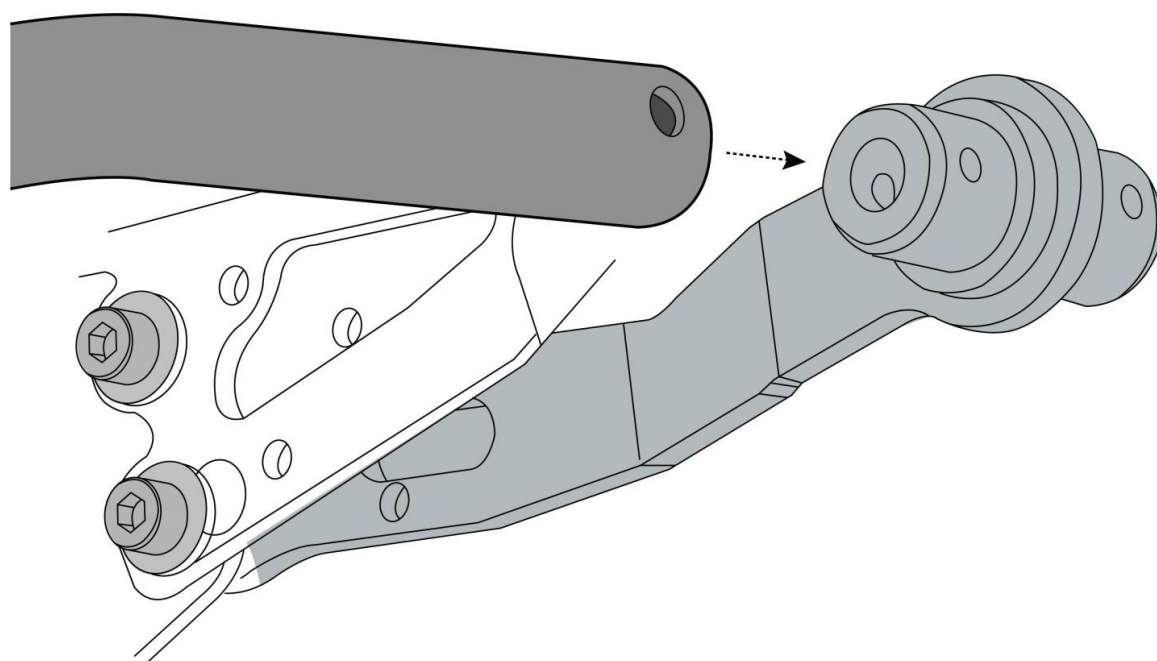
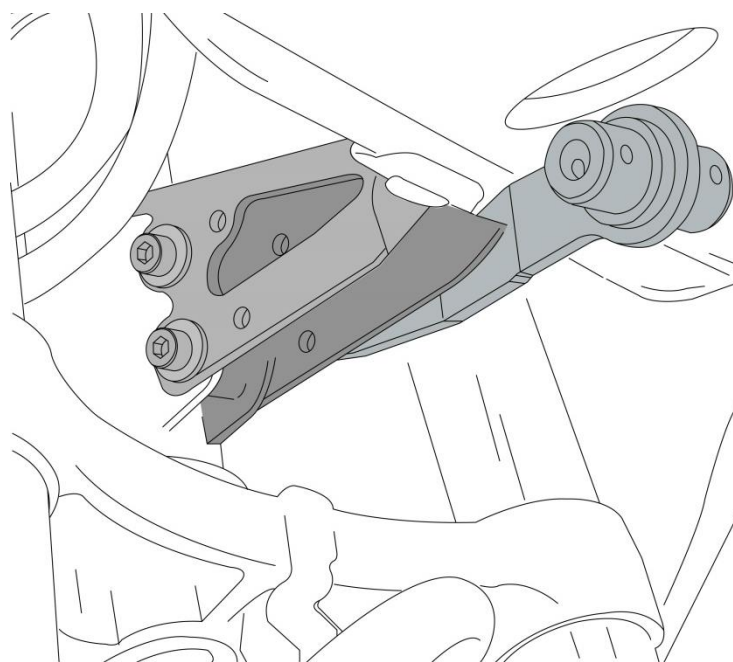

Step 5:

The Top Hollow end of Crash Bar RH, has to be aligned to the Upper Plate (Pin-pipe end), as shown.

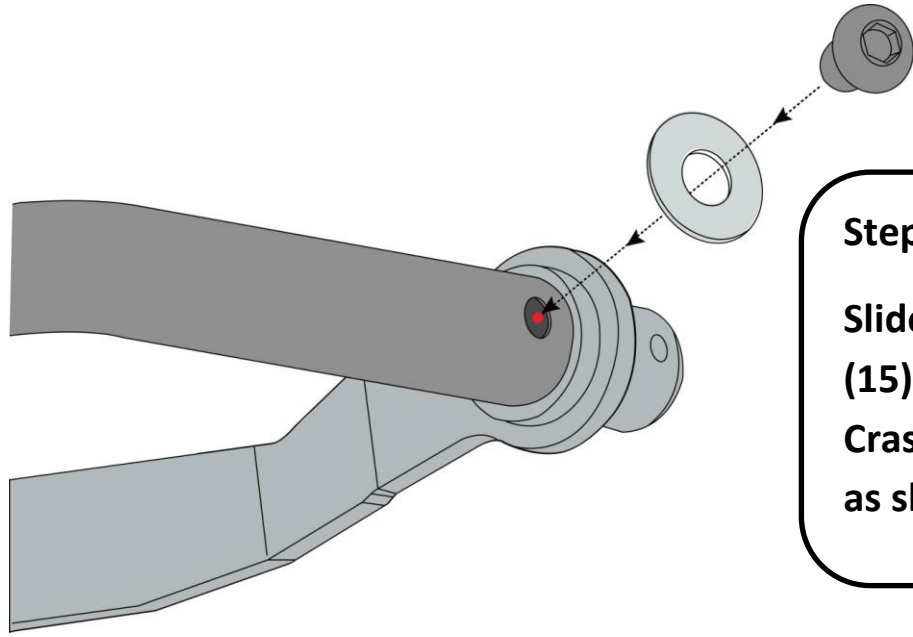

Step 6:

Slide-in Screw M6 x 15 (8) – 1 off and Washer M6 (15) – 1 off through the Mounting hole in the Crash Bar and secure the threads in the Pin-pipe, as shown.

As is mounted condition of Crash Bar RH is as shown in the drawing to the Right.

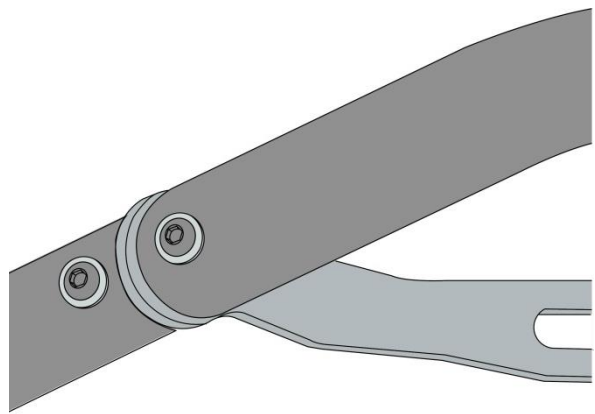
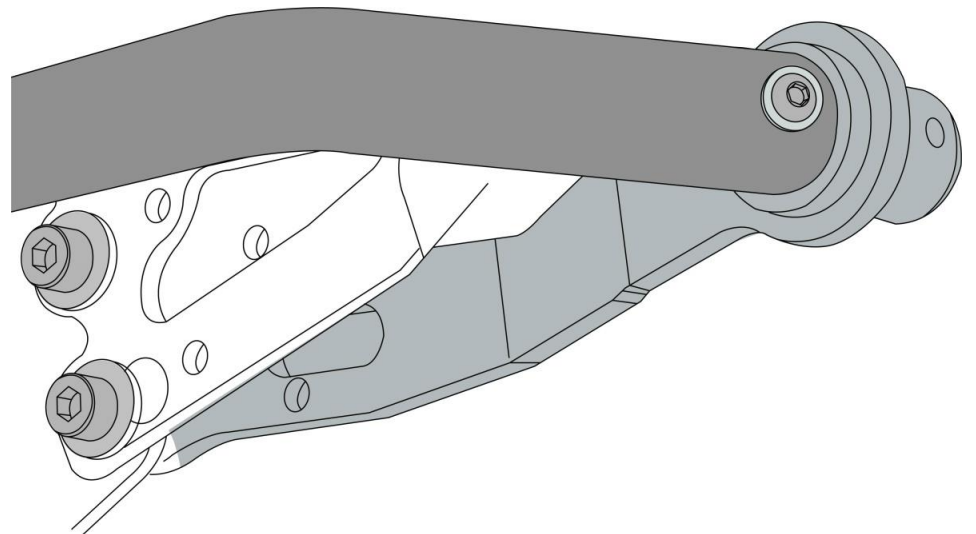

Step 7:

Orient and align the Top end of Crash Bar LH (1), as shown.

Slide-in Screw M6 x 15 (8) – 1 off and Washer M6 (15) – 1 off through the Mounting hole in the Crash Bar and secure the threads in the Pin-pipe,

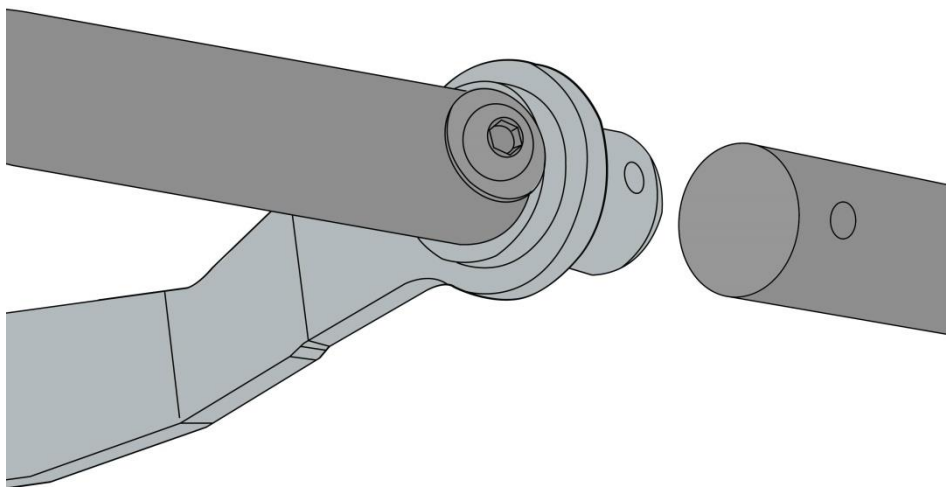

Housing for Long Bolt (4) which was mounted in Step 2 is shown here.

The Toe end of Crash Bar LH (2), has to be fitted to the mounting hole, shown here.

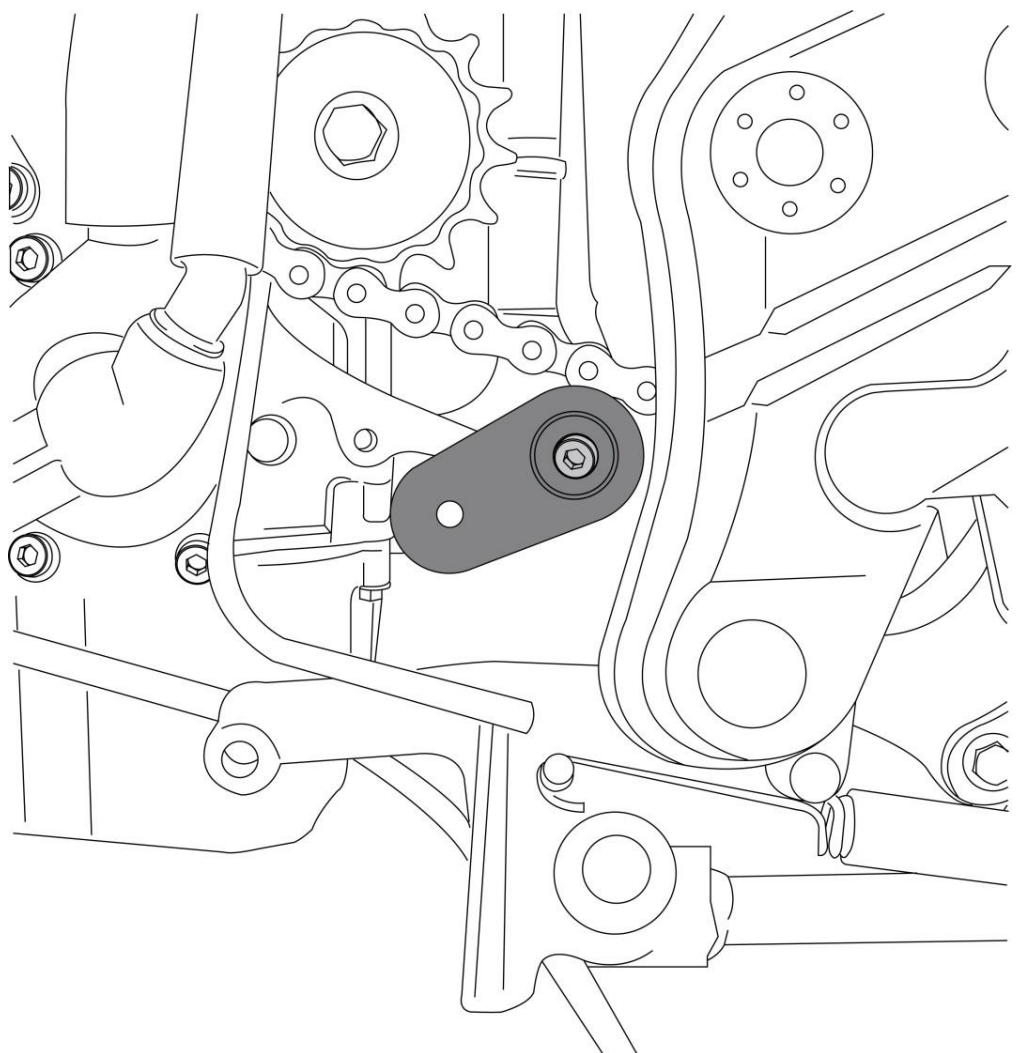

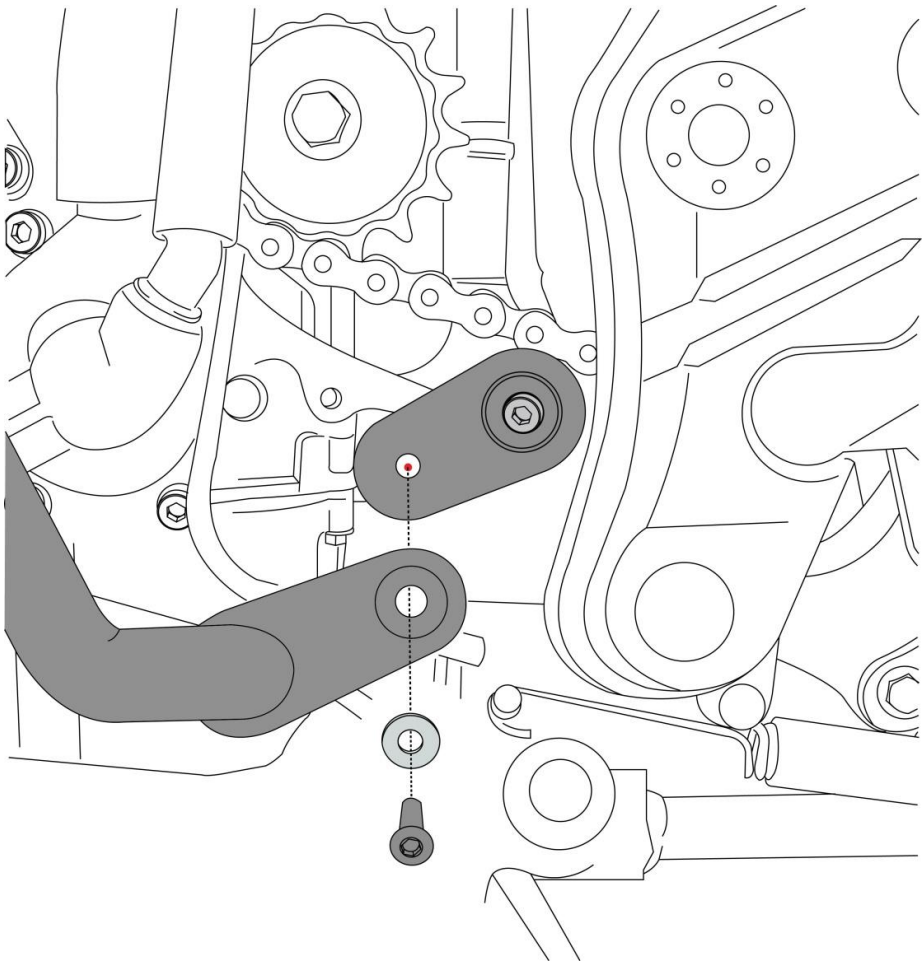

Step 8:

Align the Toe end of Crash Bar LH, as shown, and in-line with the Mounting hole.

Slip-in Screw M8 x 20 (9) – 1 off, and Washer M8 (16) – 1 off and secure the threads in t

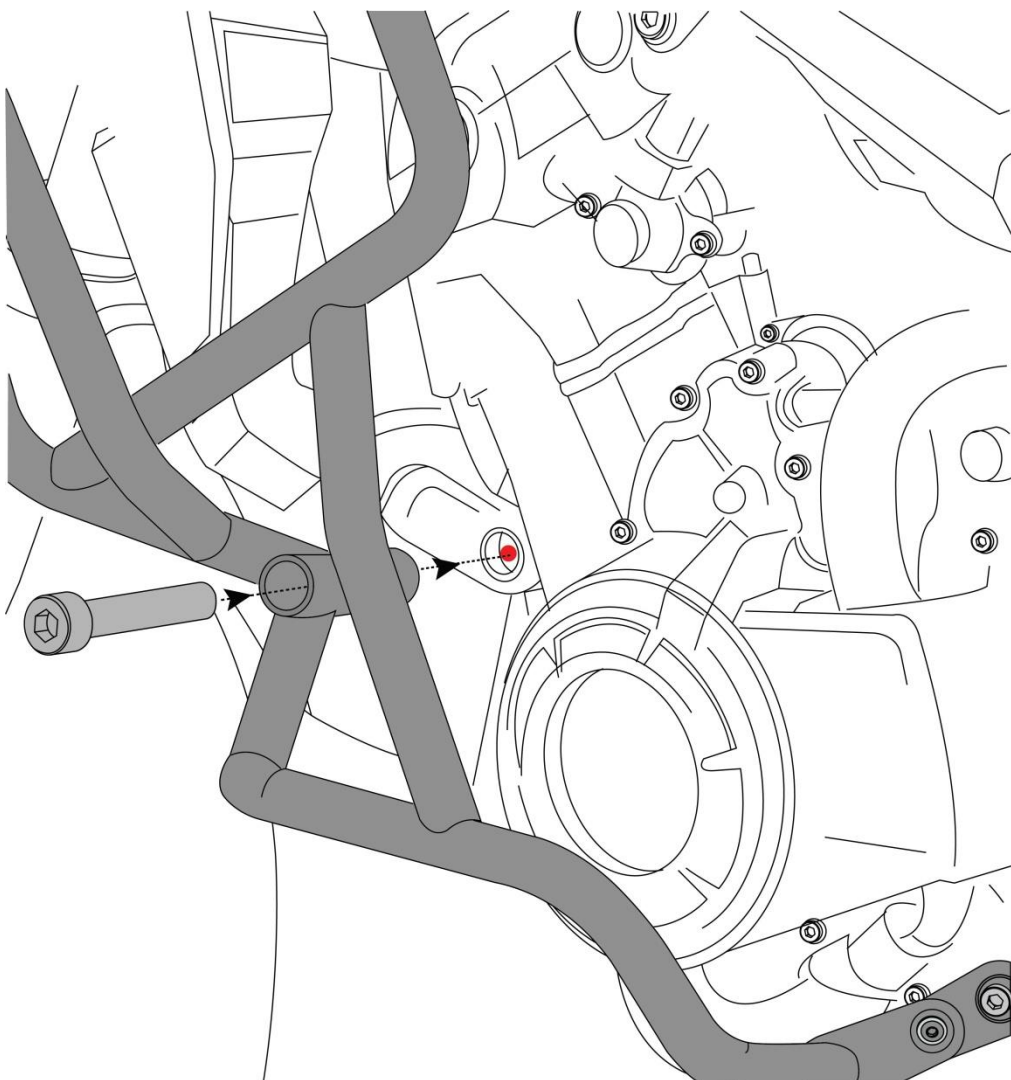
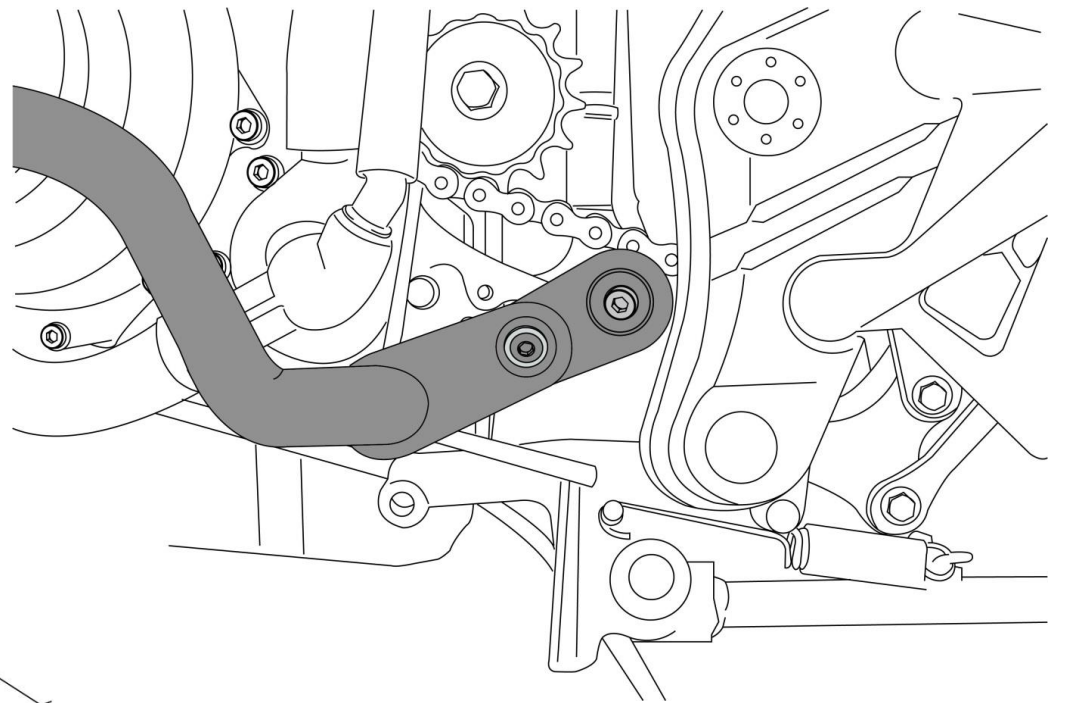

Step 9:

Slide-in the Screw M10 x 60 (11),

Secure the threads in the Mounting hole (Identified in Red colour) shown.

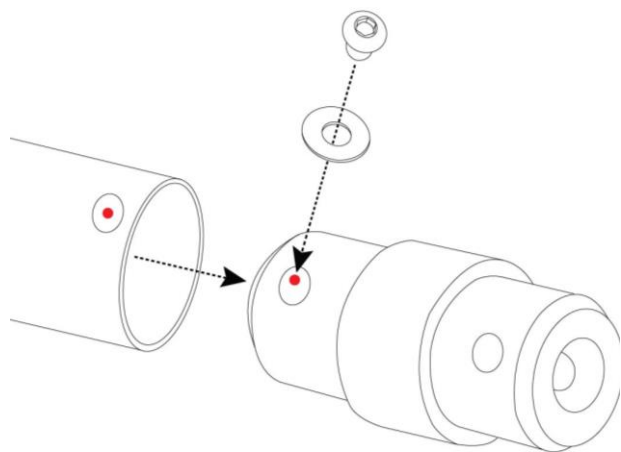

Step 10:

Align the Bottom end of Crash Bar RH, as shown, and slide-in Screw M6 x 15 (8) – 1 off and Washer M6 (15) – 1 off and secure the threads in the Pin-pipe (7).

Step 11:

Align the Bottom end of Crash Bar LH, as shown, and slide-in Screw M6 x 15 (8) – 1 off and Washer M6 (15) – 1 off and secure the threads in the other end of the Pin-pipe.

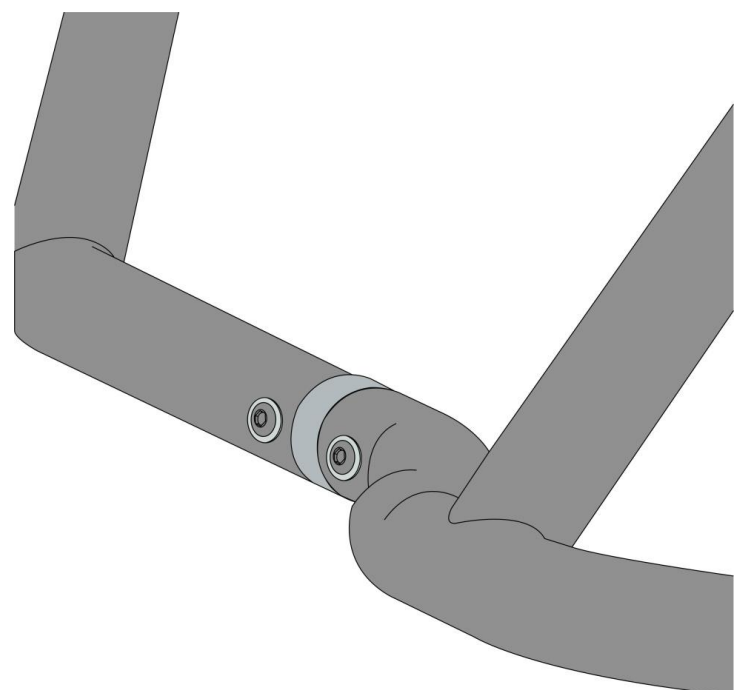

As is Mounted condition of the Crash Bar LH and RH is as shown.

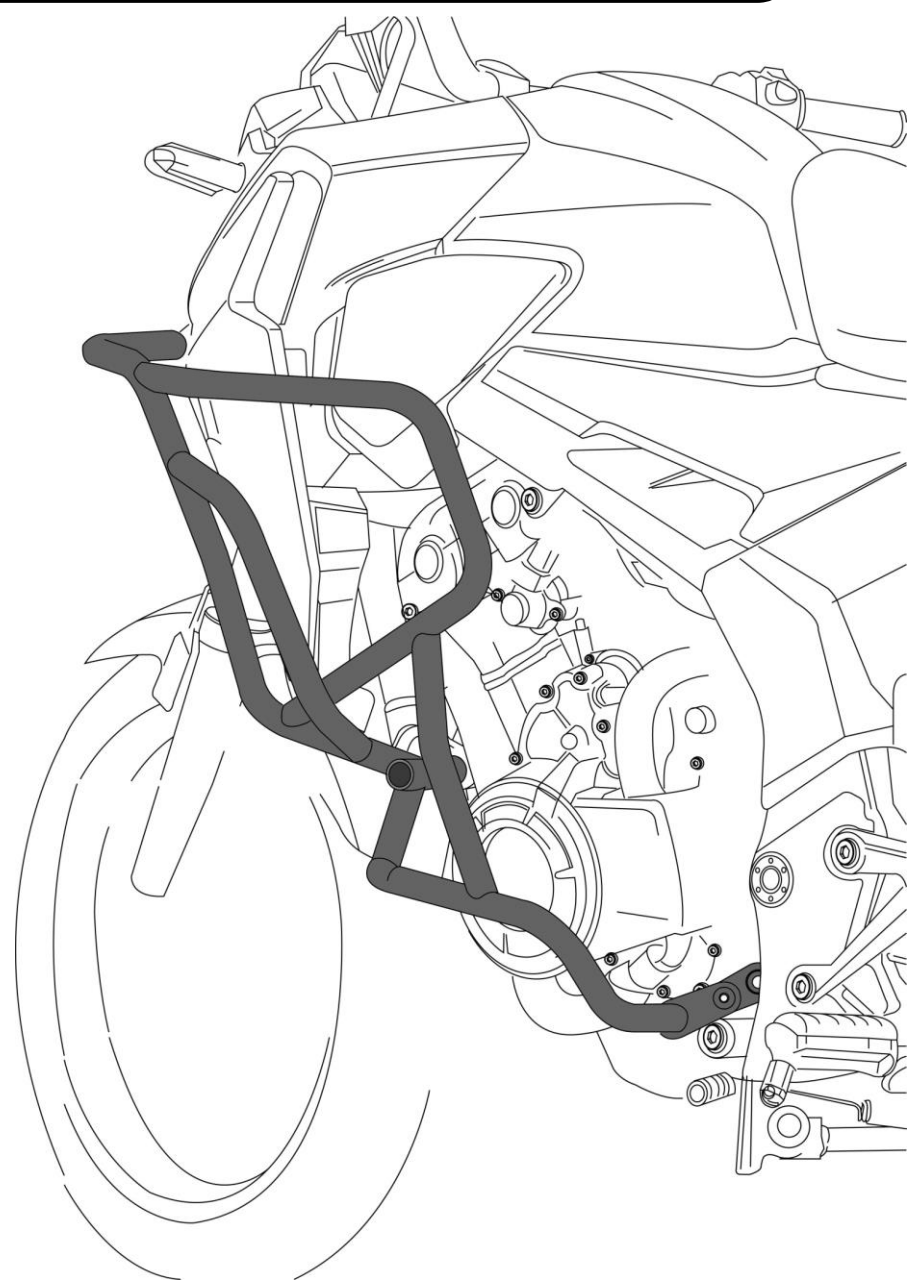
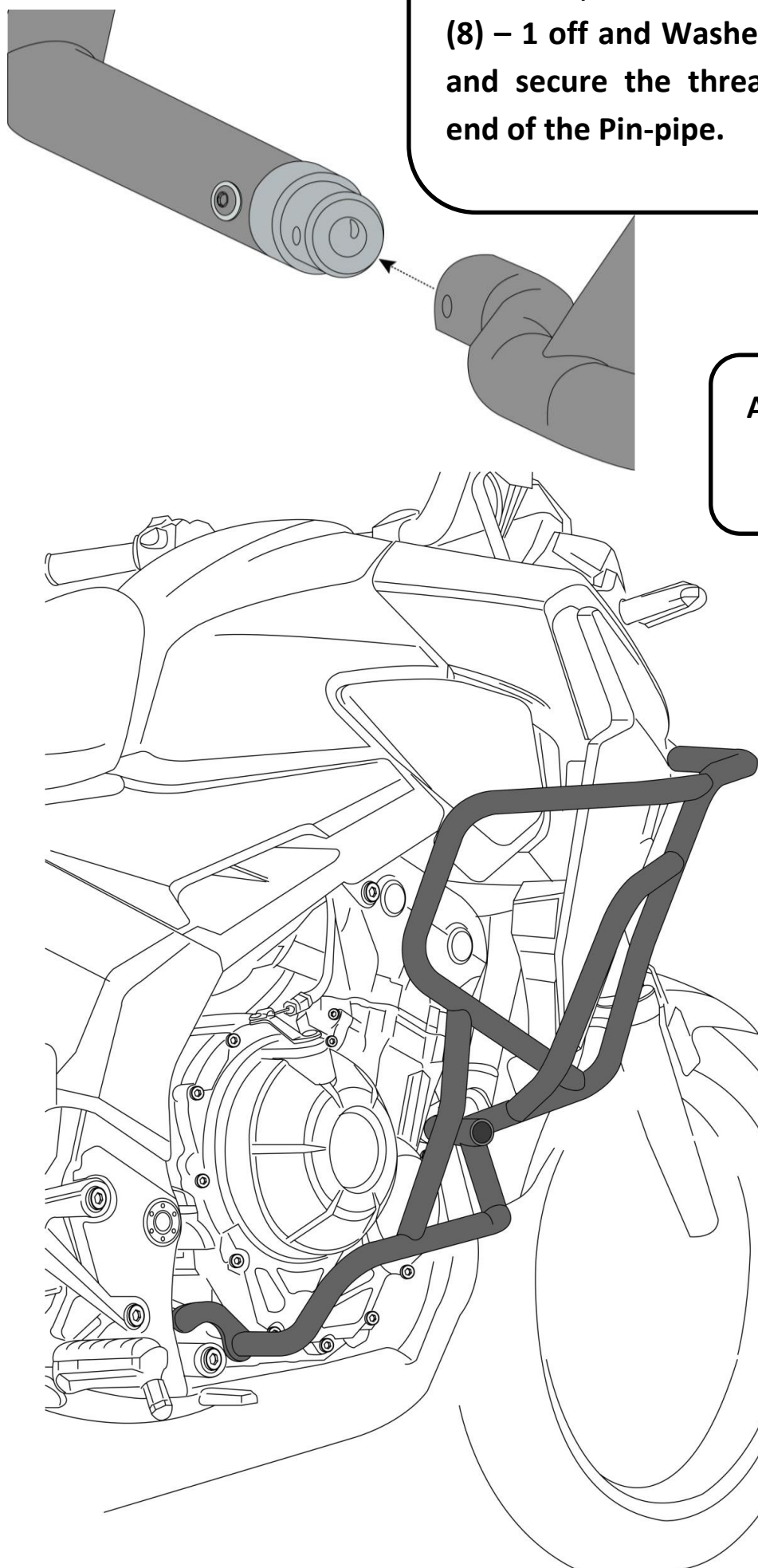

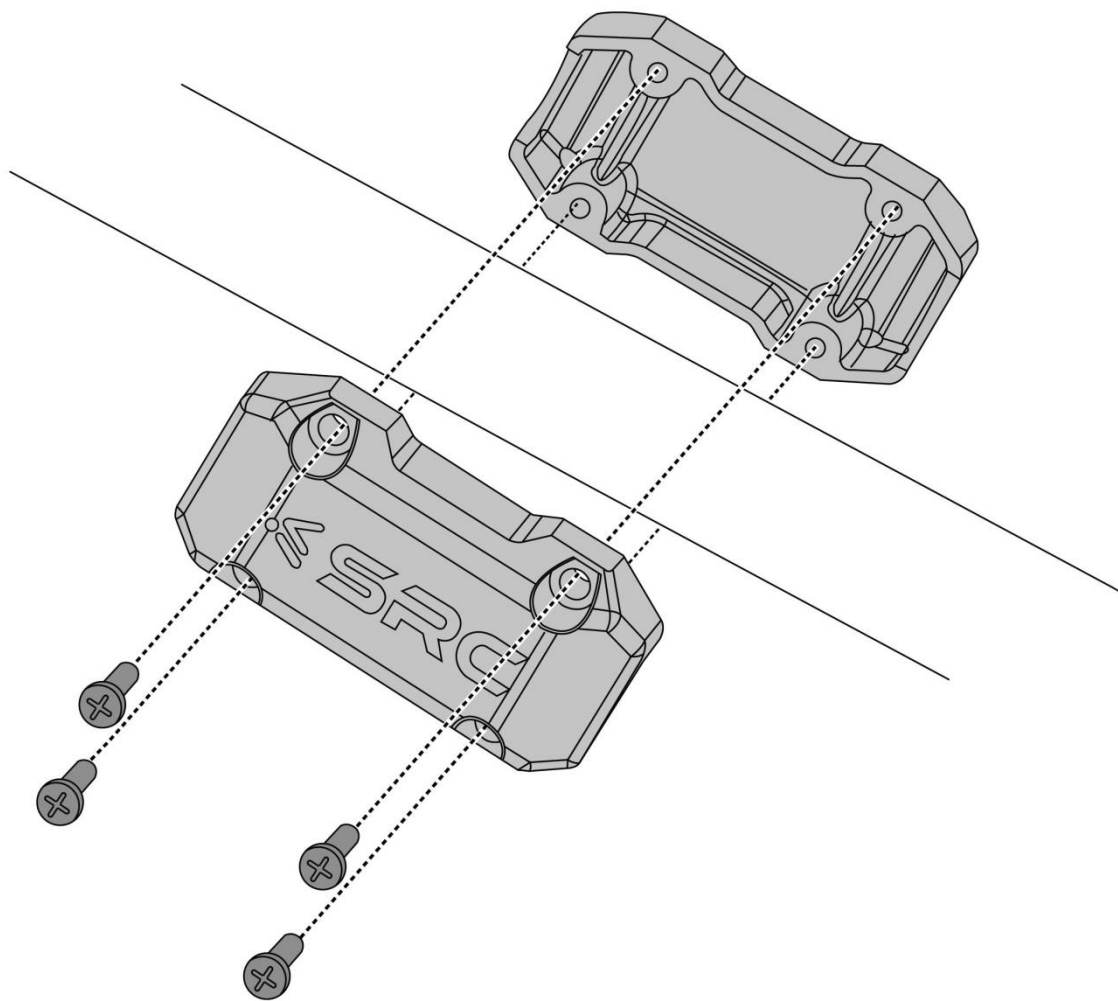

Step 12:

Assemble the Slider Bar on each of the Crash Bar as shown.

Use the Slider Bar as the Virtual Orientation and looking from the front side of the Motorbike, make one final Positioning and Alignment of the Crash bars.

Ensure mounting symmetry of the Slider Bars visually (it must not be offset or shifted visually when seen from the front side and back side).

All Screws can be fully tightened to the torque, as specified in the BOM table.

The installation is completed with this step.



General Information

1. We request you to pay attention to the Mounting Instructions in this document and follow the step-by-step procedures.
2. This Mounting Instruction manual is a “Do It Yourself” (DIY) fitment manual of the Accessory part to the Vehicle. We have prepared this based on our experience and knowledge, related to the Vehicle, Part and its functional aspects.
3. SRC cannot guarantee the interchangeability of the parts to any other manufacturer’s accessory part. It is advised to the User, to inspect and ensure the original state of all other Vehicle parts.
4. We request you to bear in mind, that the Installed part can change the driving behaviour and/or the stability during driving or any other dynamic conditions.
5. If you have the appropriate tools and another person to assist you in the mounting, it will help.
6. To the maximum extent possible, our design use the current Mounting/Fitment of the Original Equipment, so that Installation of these accessories will not affect the Payload or Function of the Vehicle or the Part on which it is mounted to protect it
7. If any additional modifications are to be done, prior to the fitment of the accessories, it will be explicitly specified in the instruction sheets.

The Mounting Instructions can also be downloaded from SRC Website.